









	100 - 240 V~
	50 / 60 Hz
	100 ms
	500 mA max.
	2 x 2,5 mm ²
	-5°C / +45°C
	 PIR
	1000 lux
	12 min.
	8 m - 120°



4 126 02
0 047 04



- x 8 max.
- x 8 μέγ.
- Max. 8 db.
- x 8 máx.
- maks. x 8

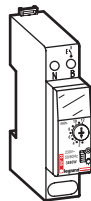
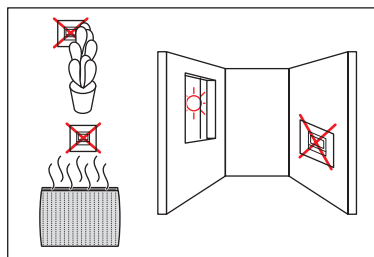
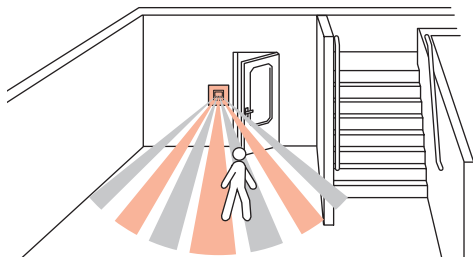
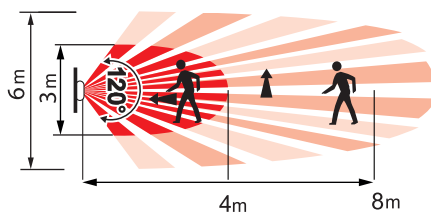
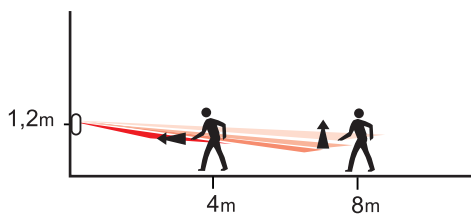
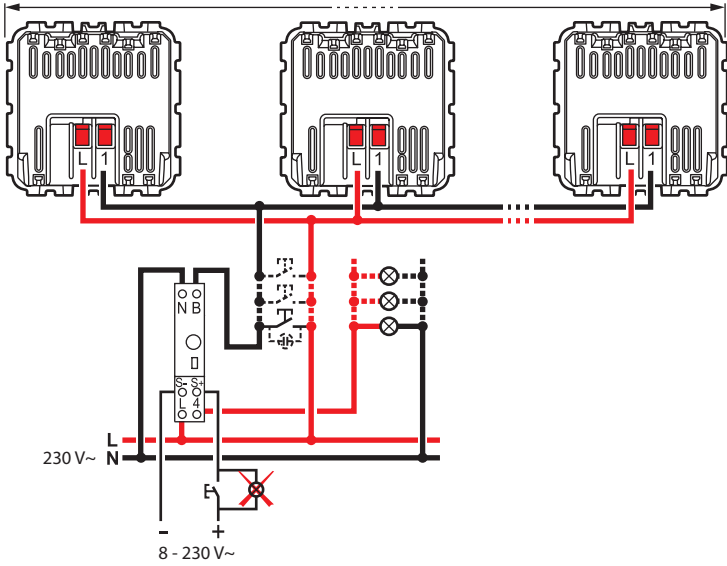

- x 8 max.
- x 8 μέγ.
- Max. 8 db.
- x 8 máx.
- maks. x 8

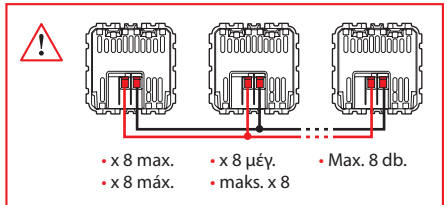
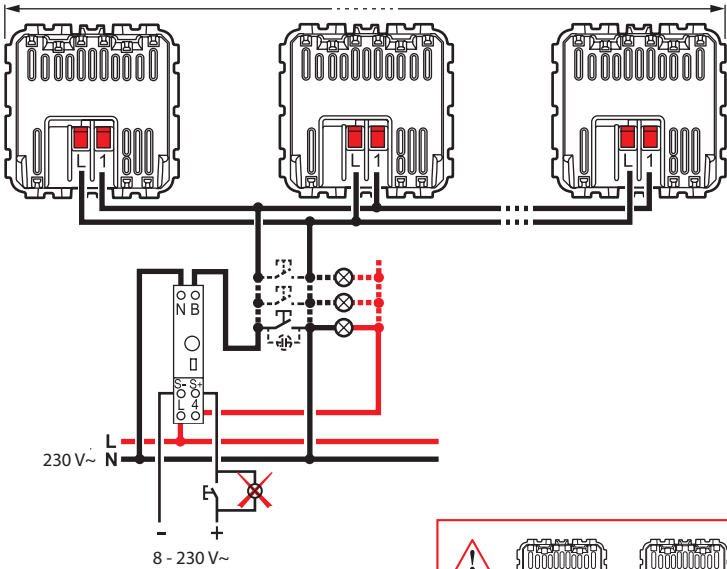



- Le temps réglé sur la minuterie et sur tous les détecteurs doit être égal ($\pm 10\%$)
- The time set on the timer and on all the detectors must be the same ($\pm 10\%$)
- Die in der Zeitschaltuhr und allen Bewegungsmeldern eingestellte Zeit muss gleich ($\pm 10\%$) sein
- El tiempo ajustado en el temporizador y en todos los detectores debe ser igual ($\pm 10\%$)
- O tempo ajustado no temporizador e em todos os detetores deve ser igual ($\pm 10\%$)
- Οι χρόνοι που ρυθμίζονται στο χρονόμετρο και στους ανιχνευτές πρέπει να είναι οι ίδιοι ($\pm 10\%$)
- Czas ustawiony na wyłączniku czasowym oraz na wszystkich czujnikach obecności musi być równy ($\pm 10\%$)
- Az időkapcsolón és az érzékelőkön beállított időknél meg kell egyezniük ($\pm 10\%$)

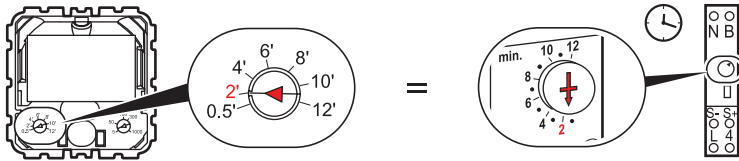

1

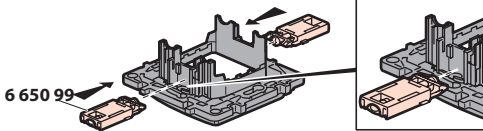

2

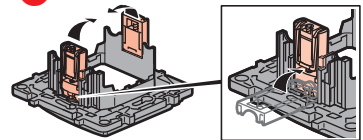

- Auto ON/OFF
- Auto ON/OFF
- Auto EIN/AUS
- Auto ON/OFF

- Auto ON/OFF
- Aut. ON/OFF
- Automatyczne włączanie/wyłączanie
- Automatikus ki-/bekapcsolás

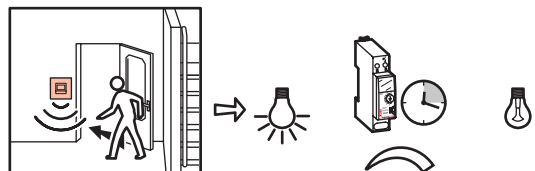
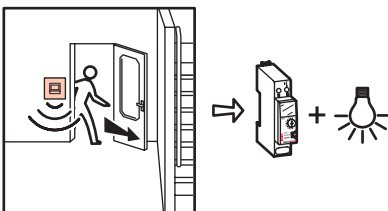

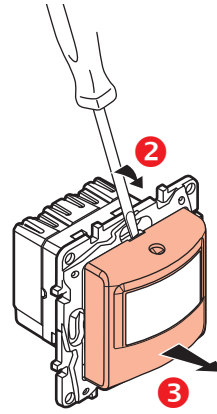
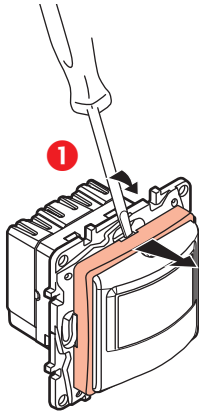

- LED détection/localisation
- Detection/location LED
- Erkennungs-/Lokalisierungs-LED
- LED detección/localización
- LED deteção/localização
- Δίοδος φωτοεκπομπής (LED) ανίχνευσης/εντοπισμού
- Kontrolka LED wykrywania/obecnosci
- Érzékelő/helymeghatározó LED

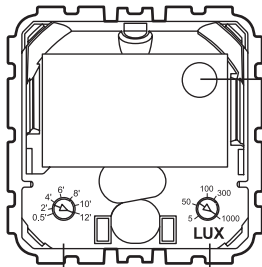

- 0,5 min. • 12 min.
- 0,5 min • 12 min
- 0,5 λεπτά • 12 λεπτά
- 0,5 perc. • 12 perc.

- 5 lux • 1000 lux
- 5 lx • 1000 lx