

THIS COPY IS PROVIDED ON A RESTRICTED BASIS AND IS NOT TO BE USED IN ANY WAY DETRIMENTAL TO THE INTERESTS OF PANDUIT CORP.

PANDUIT PART #	STUD SIZE		DIMENSIONS in. [mm]				
	ENGLISH	METRIC	L ± .03 [0,51]	W ± .01 [0,25]	C ± .02 [0,38]	M ± .03 [0,51]	H ± .01 [0,25]
EV18-6RBK	#6	M3	.76 [19,4]	.26 [6,6]	.25 [6,3]	.39 [10,0]	.15 [3,7]
EV18-8RBK	#8	M4	.82 [20,8]	.31 [8,0]	.28 [7,0]	.39 [10,0]	.17 [4,3]
EV18-10RBK	#10	M5	.82 [20,8]	.31 [8,0]	.28 [7,0]	.39 [10,0]	.21 [5,3]
EV18-14RBK	1/4"	M6	1.06 [26,8]	.46 [11,6]	.43 [11,0]	.39 [10,0]	.25 [6,4]

# NOTES:

1. CULUS LISTED FOR:  
A. 22-18 AWG [0,5-1,0 mm<sup>2</sup>] SOLID OR STRANDED COPPER WIRE  
B. 221°F [105°C] MAX. OPERATING TEMPERATURE  
C. 600V. MAX. BLDG WIRE  
(1000 V. MAX. IN SIGNS, FIXTURES & LUMINAIRES)
2. MATERIAL:  
A. STAMPING: .030" [0,8] THK COPPER, TIN PLATED  
B. HOUSING: VINYL, RED
3. INSTALLATION TOOL: KST-2000A
4. WIRE STRIP LENGTH: 9/32" <sup>+1/32</sup><sub>-0</sub> [6,8mm <sup>+0,8</sup><sub>-0</sub>]
5. SEE [www.panduit.com](http://www.panduit.com) FOR PACKAGE QUANTITIES INDICATED BY PART NUMBER SUFFIX
6. DIMENSIONS IN BRACKETS ARE METRIC EQUIVALENT
7. PARTS ARE RoHS COMPLIANT

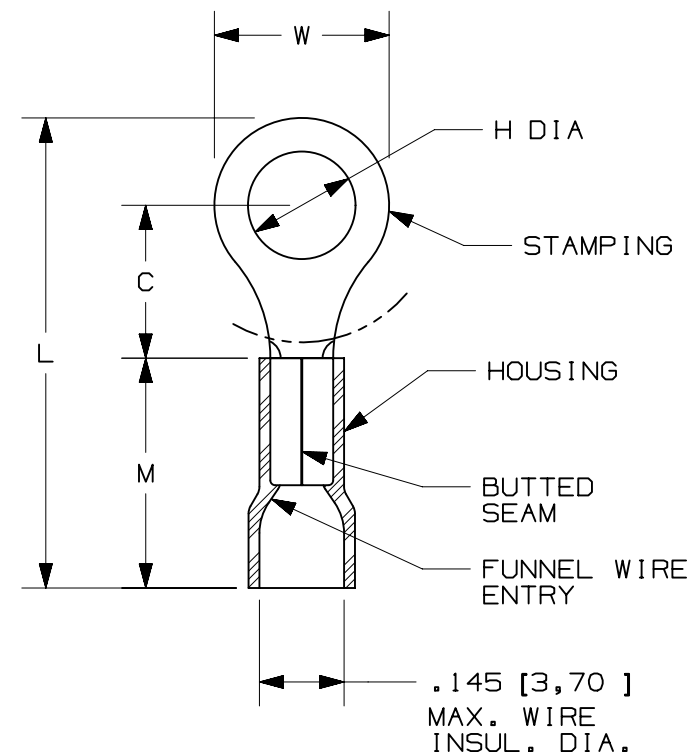

TITLE				<b>STRONGHOLD RING TERMINAL</b>			
				<b>VINYL INSULATED, BUTTED SEAM #22-18 AWG</b>			
				CUSTOMER DRAWING			
ITEM REVISION NAME				02937NED/01			
DATASET FILE NAME				02937NED-DC/01			
UNLESS OTHERWISE SPECIFIED, DIMENSIONAL TOLERANCES ARE: IN [mm]				.x ± .1 [2,54]      .xxx ± .005 [.127] .xx ± .01 [.25]      ANGLES ± 5°			
				THIRD ANGLE PROJECTION			
DRAWN BY				JHNU			
DATE				9/22			
CHK				BDK			
SCALE				N.T.S.			
MATERIAL:				SEE NOTES			
DRAWING NUMBER:				02937NED-DC			
REV				DATE			
BY				CHK			
APR				DESCRIPTION			
ECN				SHEET 1 OF 1			
SIZE				A			