

THIS COPY IS PROVIDED ON A RESTRICTED BASIS AND IS NOT TO BE USED IN ANY WAY DETRIMENTAL TO THE INTERESTS OF PANDUIT CORP.

PANDUIT PART #	WIRE RANGE AWG [mm ²]	TAB SIZE INCH [mm]	HOUSING COLOR	MAX WIRE INSULATION DIA.	DIMENSIONS in. [mm]	
					L ± .03 [0,8]	W ± .01 [0,3]
EDV18-250BK	#22-18 [0,5-1,0]	.250 X .032 [6,3 X 0,8]	RED	.145 [3,7]	.81 [20,5]	.26 [6,6]
*EDV14-250BK	#16-14 [1,5-2,5]	.250 X .032 [6,3 X 0,8]	BLUE	.165 [4,2]	.81 [20,5]	.26 [6,6]

*NOT cULUS LISTED

NOTES:

- cULUS LISTED FOR:
 - STRANDED COPPER WIRE ONLY
 - 167°F (75°C) MAX TEMP RATING
 - 300V MAX VOLTAGE
- MATERIAL:
 - STAMPING: .016" (0.40) THK BRASS, TIN PLATED
 - HOUSING: VINYL
- INSTALLATION TOOLS: KST-2000C
- WIRE STRIP LENGTH 9/32" [6.8mm]
- SEE WWW.PANDUIT.COM FOR PACKAGE QUANTITIES INDICATED BY PART NUMBER SUFFIX
- DIMENSIONS IN BRACKETS ARE METRIC EQUIVALENT
- PARTS ARE RoHS COMPLIANT

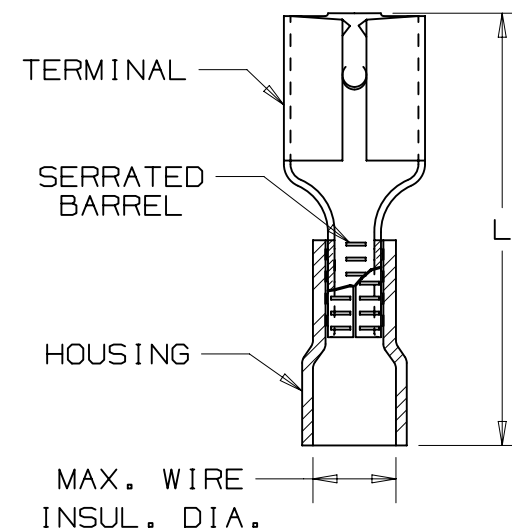
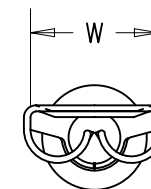

LISTED
19X5
E78522

TITLE STRONGHOLD FEMALE DISCONNECT (250 SERIES) VINYL INSULATED, BUTTED SEAM #22-14 AWG CUSTOMER DRAWING					
ITEM REVISION NAME				02937NDP/01	
DATASET FILE NAME				02937NDP/01	
UNLESS OTHERWISE SPECIFIED, DIMENSIONAL TOLERANCES ARE: IN [mm] .x ± .1 [2.54] .xxx ± .005 [.127] .xx ± .01 [.25] ANGLES ± 5 °				PANDUIT MATERIAL: SEE NOTES	
THIRD ANGLE PROJECTION				DRAWING NUMBER: 02937NDP-DC	
DRAWN BY	DATE	CHK	SCALE	SIZE	
JHNU	9/30/22	BDK	NTS	A	
SHT 1 OF 1					