

- SPECIFICATION**
- STANDARD:
 - UNIT TYPE: MS
 - ORIENTATION: VERTICAL, OU FULL
 - OUTLET QTY & TYPE: (24)C13/C15, (24)C13/C15/C19/C21
 - INPUT VOLTAGE: 200-240/346-415VAC
 - INPUT CURRENT: 20A(16A DERATED)/16A
 - BREAKER QTY & TYPE: NA
 - INPUT PHASE: 3 PHASE WYE, L-N
 - RATED POWER: 11.5/11.0 KVA
 - INPUT PLUG: IEC 60309 3P+N+E 6H 20A/16A (IP44)
 - REGULATORY STANDARD: RoHS COMPLIANT
 - ADDITIONAL:
 - CORD TYPE: 5W 12AWG SOOW & 2.5MM²H07RN-F
 - ACCESSORIES:
 - PRODUCT SAFETY WARNING SHEET

- NOTES**
- PRIMARY DIMENSIONS ARE IN MILLIMETERS, SECONDARY DIMENSIONS IN [INCHES]
 - FOR FULL PRODUCT FUNCTIONLITY REFER TO THE USER MANUAL.

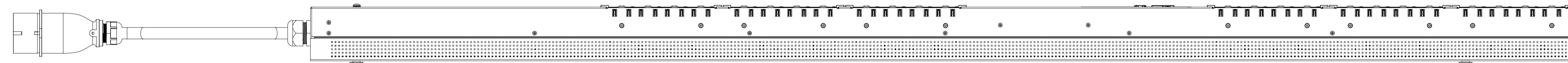

LEFT VIEW

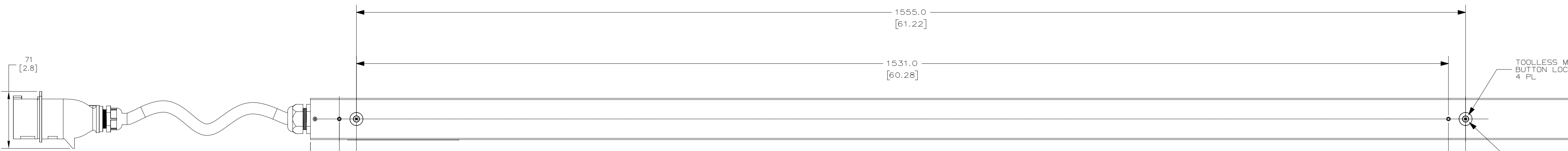

REAR VIEW

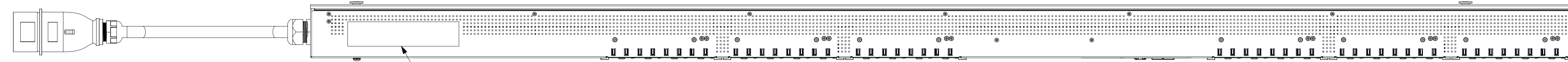

RIGHT VIEW

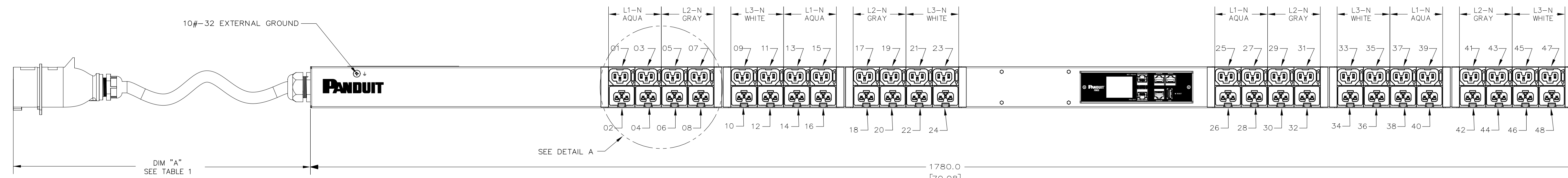

FRONT VIEW

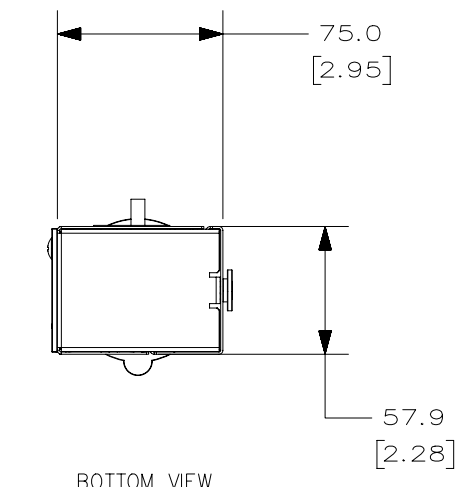

BOTTOM VIEW

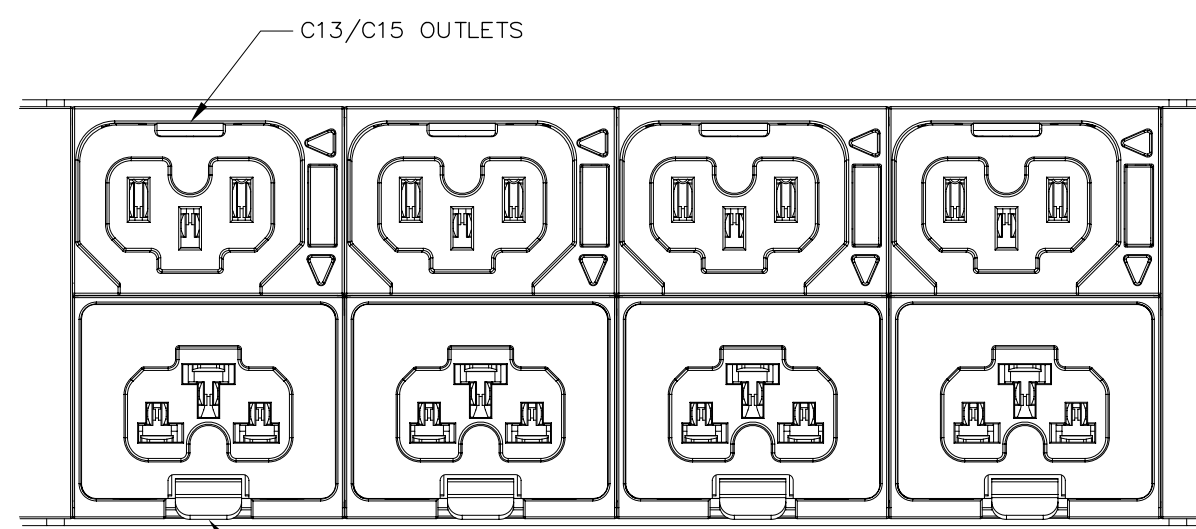

DETAIL A
SCALE 1:1

TABLE 1

| PART NUMBER | DESCRIPTION | DIM A | COLOR (-XX) | SHIPPING WEIGHT (KG) |
|-------------|---|-------------------------------|------------------|----------------------|
| E48E23L | EL2P MS PDU, 20/16AMP, (24)C13/C15, (24)C13/C15/C19/C21, IEC 60309 3P+N+E 6h 20A/16A (IP44) | 3000 +254/-127 [118.1 +10/-5] | BLACK (RAL 9005) | 9.6 |

INPUT PLUG FRONT VIEW

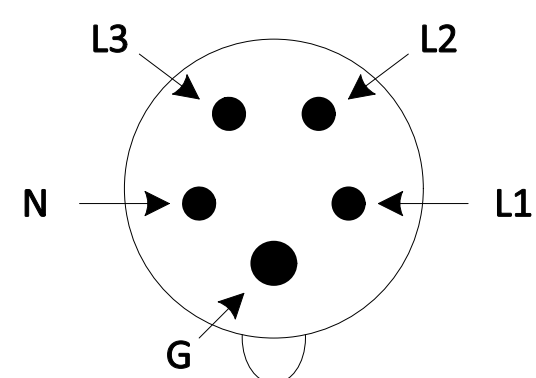

COMPLIANCE LABEL VIEW

PANDUIT
18900 Panduit Drive, 60487, USA
www.panduit.com

SKU #: E48E23L-BLSC
Model #: E2Y016C0
INPUT: 200-240/346-415VAC, WYE, 3Ø, 50/60Hz, 16A(EU), OR 200-240/346-415VAC, WYE, 3Ø, 50/60Hz, 16A(NA)
OUTPUT: C13: 200-240VAC, 10A per outlet
C19: 200-240VAC, 16A per outlet
16A Total(EU) OR 16A Total(NA)

Power Distribution Unit

NOM NYCE FC CE

62368-1 CAN ICES-003(A)/NMB-003(A)

SKU: E48E23L-BLSC
SN: XXXXXXXXXXXX
MAC: XXXXXXXXXXXX

Made in China

| REV | DATE | BY | CHK | APR | DESCRIPTION | ECN | SCALE | SHT | OF | SIZE |
|-----|------------|-----|-----|-----|-----------------------|---------|-------|-----|----|------|
| 00A | 02/20/2025 | LLJ | GLM | MJD | RELEASE TO PRODUCTION | E48E23L | 3:10 | 1 | 1 | D |