

THIS COPY IS PROVIDED ON A RESTRICTED BASIS AND IS NOT TO BE USED IN ANY WAY DETRIMENTAL TO THE INTERESTS OF PANDUIT CORP.

PANDUIT PART #	STUD SIZE		DIMENSIONS in. [mm]					CA9 SERIES CRIMP DIE	CA-800(EZ) SERIES CRIMP DIE
	ENGLISH	METRIC	L ± .04 [1,0]	W ± .01 [0,3]	C ± .02 [0,5]	M ± .04 [1,0]	H ± .01 [0,3]		
PNF10-6R-2K	#6	M3,5	1.06 [26,9]	.38 [9,7]	.31 [7,9]	.88 [22,3]	.15 [3,8]	CD9-3B	CA-800-3
PNF10-8R-2K	#8	M4	1.06 [26,9]	.38 [9,7]	.31 [7,9]	.88 [22,3]	.17 [4,3]		
PNF10-10R-2K	#10	--	1.06 [26,9]	.38 [9,7]	.31 [7,9]	.88 [22,3]	.20 [5,1]		
PNF10-14R-2K	1/4"	M6	1.21 [30,7]	.52 [13,2]	.38 [9,7]	.95 [24,1]	.27 [6,9]		
PNF10-56R-2K	5/16"	M8	1.21 [30,7]	.52 [13,2]	.38 [9,7]	.95 [24,1]	.33 [8,4]		
PNF10-38R-2K	3/8"	--	1.29 [32,8]	.58 [14,7]	.43 [10,9]	1.00 [25,4]	.39 [9,9]		

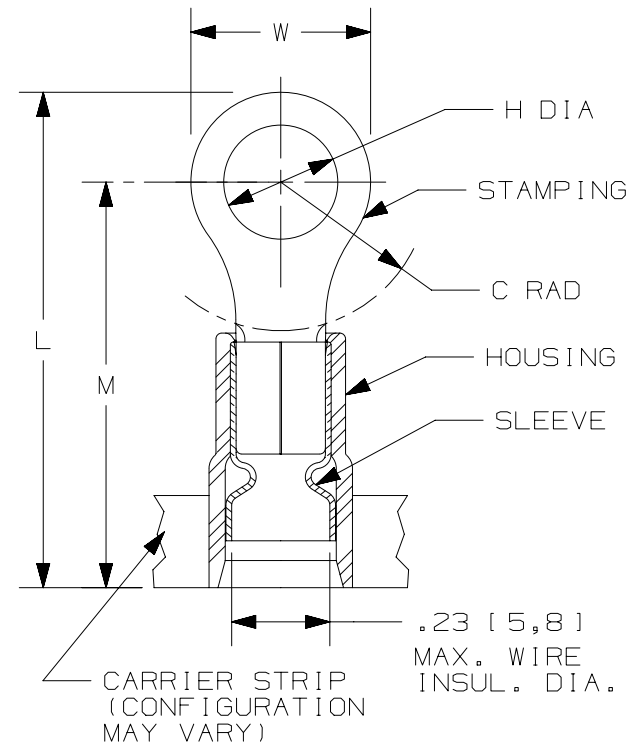

NOTES:

- cULus LISTED FOR:
  - A. #12-10 AWG [4,0-6,0 mm<sup>2</sup>] SOLID OR STRANDED COPPER WIRE
  - B. 221°F [105°C] MAX. OPERATING TEMPERATURE
  - C. 600 V. MAX. VOLTAGE RATING
- VISIT OUR ON-LINE CATALOG AT WWW.PANDUIT.COM FOR A LIST OF CURRENT PARTS APPLICABLE FOR USE WITH THIS PRODUCT.
- MATERIAL:
  - A. STAMPING: .04" [1,0] THK COPPER, TIN PLATED
  - B. HOUSING: NYLON, YELLOW
  - C. SLEEVE: BRASS, TIN PLATED
- DIMENSIONS IN ( ) ARE METRIC.
- WIRE STRIP LENGTH: 11/32" <sup>+1/32</sup> [8,7<sup>+0,8</sup>]

PRESS COMPATIBILITY CHART		
PRESS	CP-871	CP-861
APPLICATOR	CA9 CA-800EZ	CA-800

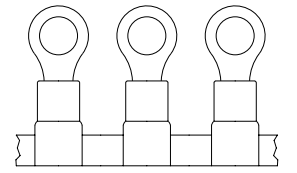

PART NUMBER		SEE TABLE	
TITLE			
RING TERMINALS, 3 PC. NYLON (FUNNEL) INSULATED, #12-10, CONTINUOUS REEL		CUSTOMER DRAWING	
ITEM REVISION NAME		N41143BA/09	
DATASET FILE NAME		N41143BA_DC/09A	
MATERIAL		SEE NOTES	
DRAWN BY		FES	
DATE		-	
CHK		FS	
SCALE		N.T.S	
DRAWING NUMBER		A41143	
SHEET 1 OF 1		A	

REV	DATE	BY	CHK	APR	DESCRIPTION	ECN
09	10/15/25	USR 094325	JSUN	JSUN	REMOVED MILITARY SPEC. REMOVED PMNF6-3R-2K AND PMNF6-5R-2K	022465/00
08	07/14	MBY	JHNU	RGB	REVISED NOTES, MOVED TOOLS TO TABLE, REVISED CERTIFICATION	N41143BA -A41143
07	09.13.12	JBN	LCA	VMB	ADDED METRIC EQUIVALENT. REVISED NOTES.	A41143

A-SIZE CUSTOMER