

# Product End of Life Instructions

## Tesys Tera - Electronic motor relay sensor CTVT, NEMA 10 to





## Potential disassembly risks

This product contains an **Electronic board assembly** and **Spring mechanism**, which are recommended to be treated separately during the End of Life operations.

There are several steps to process the products at the end of life so as to recover components, materials or energy  
**Reuse --> Depollution --> Dismantling --> Shredding**



## End of Life Instructions

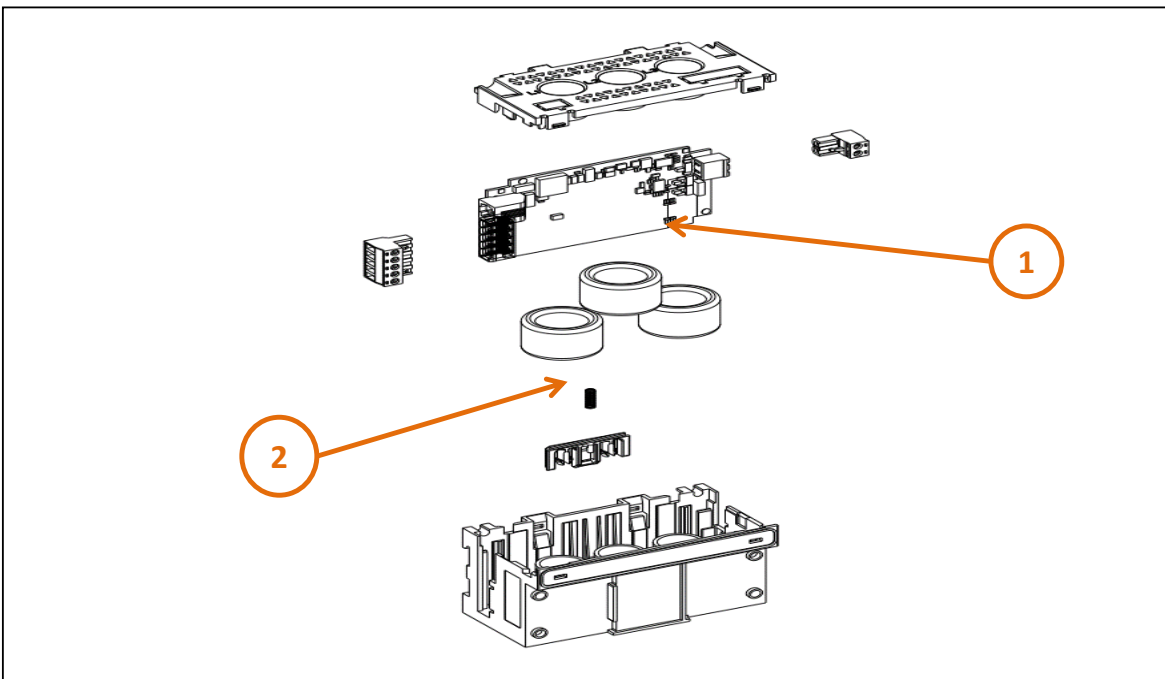

Recommendation	Number on drawing	Component / Material	Weight (in g)	Comment
Potential hazards	1	Tera_HCT_NEMA_PCB	24	Electronic Component
Potential hazards	2	SPRING	2	Metal



## Product description

Manufacturer identification	Schneider Electric Industries SAS
Brand name	Schneider Electric
Product function	TeSys Tera LTMTCTV Sensor Module is for horizontal mounting with Current range from 10 to 100A, Voltage range from 60 to 690VAC and Frequency range from 45 to 65Hz and with current transformers.
Product reference	LTMTCTV100UT
Total representative product mass	283 g
Representative product dimensions	60.5mm x 129.4mm x 82.6mm
Accessories	No
Date of information release	02/2024



## Additional information

Legal information	This product family is in the scope of European Union directive 2012/19/EU on Waste Electrical and Electronic Equipment (WEEE). The product family must be disposed according to the legislation of the country. This document is intended for use by end of life recyclers or treatment facilities. It provides the basic information to assure an appropriate end of life treatment for the components and materials of the product.	
In case of special transportation: transportation method	No	
Recyclability potential	10%	Recyclability rate has been calculated based on REEECY'LAB tool developed by Ecosystem, for components/materials not covered by the tool, data from the "ECO'DEEE recyclability and recoverability calculation method" was taken. If no data was found a conservative assumption was used (0% recyclability).

Schneider Electric Industries SAS

Country Customer Care Center  
<http://www.se.com/contact>

35, rue Joseph Monier

CS 30323

F- 92500 Rueil Malmaison Cedex

RCS Nanterre 954 503 439

Capital social 928 298 512 €

[www.se.com](http://www.se.com)

ENVEOLI2309043\_V1

Published by Schneider Electric

© 2023 - Schneider Electric – All rights reserved

02/2024