

# Product End of Life Instructions

## SPACELOGIC KNX DALI BROADCAST MASTER





## End of Life Instructions

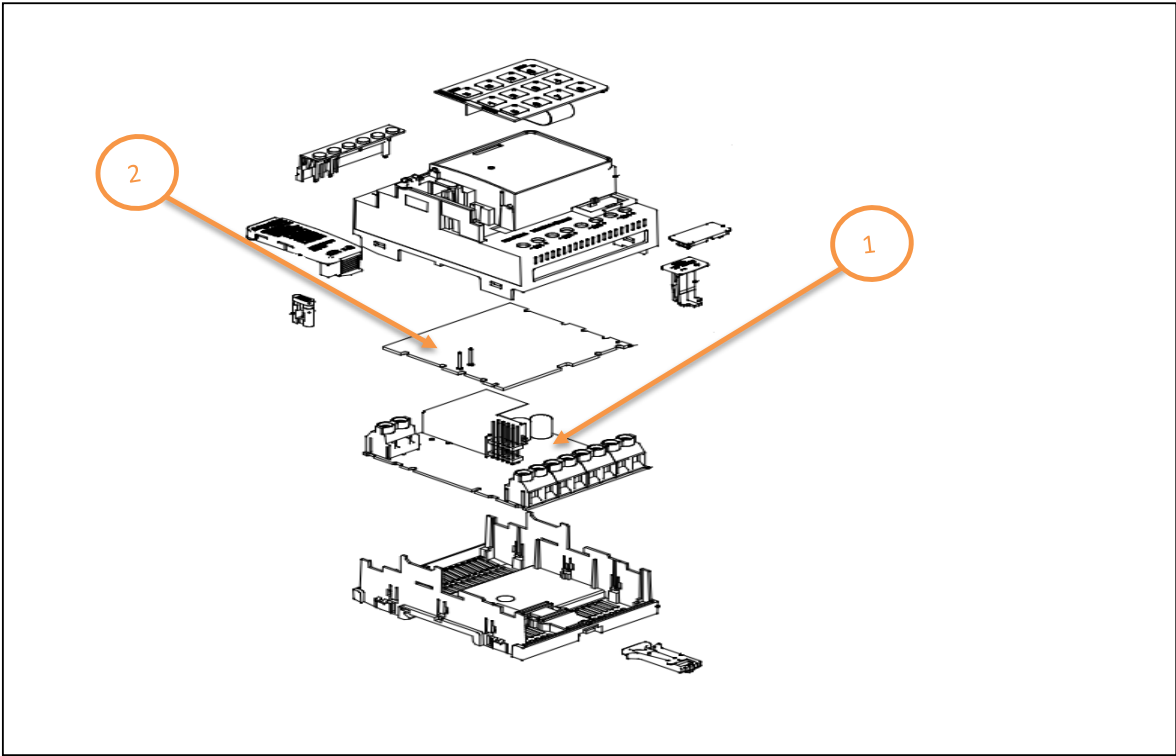

Recommendation	Number on drawing	Component / Material	Weight (in g)	Comment
To be depolluted	1	Electronic Board (Communication) > 10cm <sup>2</sup>	15.2	PCBA - 1
To be depolluted	2	Electronic Board (Communication) > 10cm <sup>2</sup>	17.4	PCBA - 2



## Product description

Manufacturer identification	Schneider Electric Industries SAS
Brand name	Schneider Electric
Product function	The SpaceLogic KNX DALI Broadcast Master is a advanced lighting control device that integrates with KNX systems and DALI technology. It supports 4 channels, enabling the simultaneous control of multiple lighting circuits, making it ideal for efficient and flexible lighting management in building automation.
Product reference	MTN6725-0005S
Total representative product mass	171 g
Representative product dimensions	80mm x 125mm x 157mm
Accessories	KNX bus connecting terminal and shrink tube
Date of information release	03-2025



## Additional information

Legal information	This product family is in the scope of European Union directive 2012/19/EU on Waste Electrical and Electronic Equipment (WEEE). The product family must be disposed according to the legislation of the country. This document is intended for use by end of life recyclers or treatment facilities. It provides the basic information to assure an appropriate end of life treatment for the components and materials of the product.
In case of special transportation: transportation method	No
Recyclability potential	<b>0%</b> The recyclability rate was calculated from the recycling rates of each material making up the product based on REEECY'LAB tool developed by Ecosystem, for components/materials not covered by the tool, data from the EIME database and the related PSR was taken. If no data was found a conservative assumption was used (0% recyclability).

Schneider Electric Industries SAS

Country Customer Care Center

<http://www.se.com/contact>

35, rue Joseph Monier

CS 30323

F- 92500 Rueil Malmaison Cedex

RCS Nanterre 954 503 439

Capital social 928 298 512 €

[www.se.com](http://www.se.com)

ENVEOLI2503007\_V1

Published by Schneider Electric

© 2023 - Schneider Electric – All rights reserved

03-2025