

Product End of Life Instructions

Exiway Smartled Activa Dicube IP65





Potential disassembly risks



End of Life Instructions

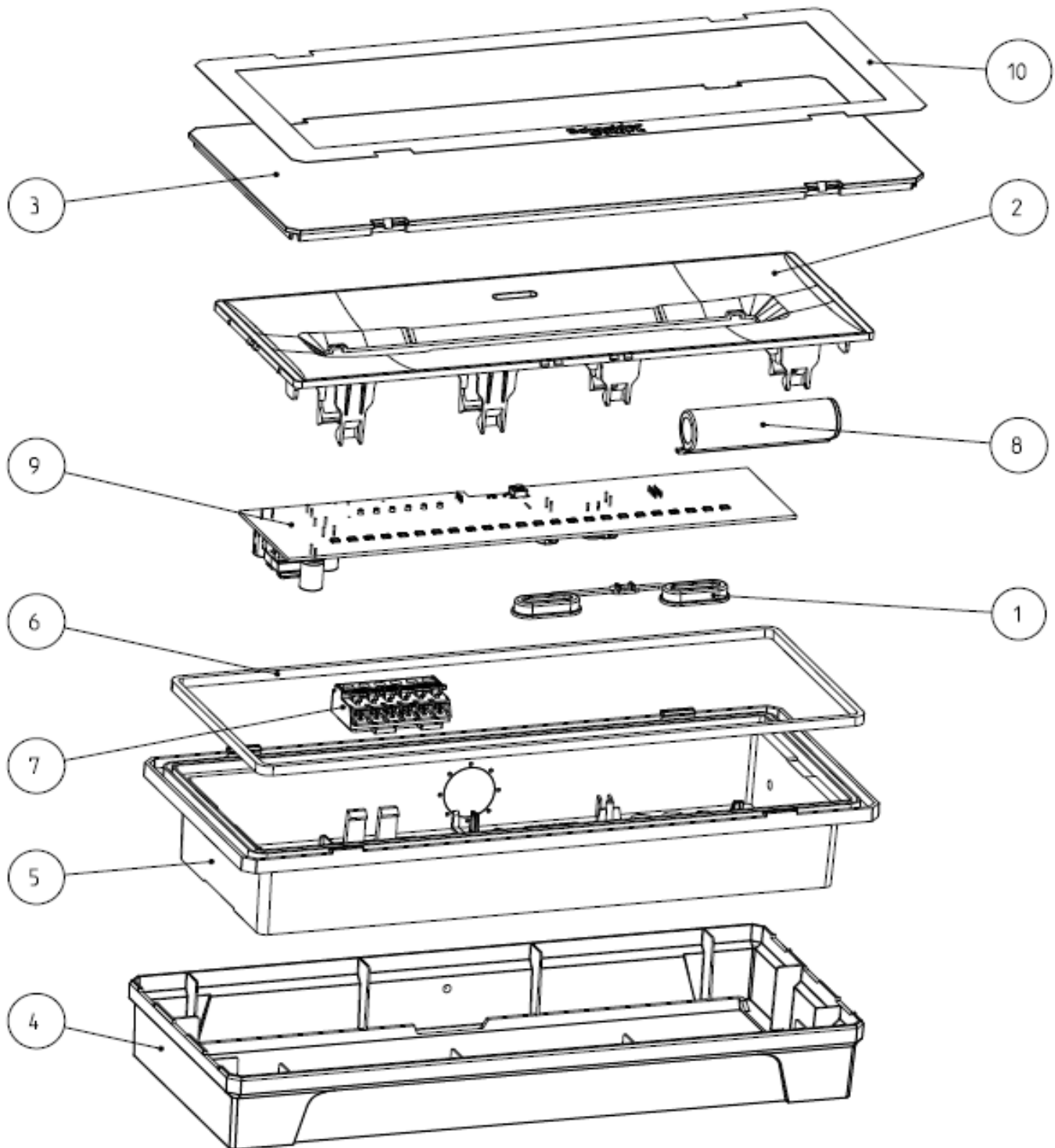

Recommendation	Number on drawing	Component / Material	Weight (in g)	Comment
To be dismantled	1	PE Polyethylene (Caps for IP65)	2.4	
To be dismantled	2	PC (Reflective body to fix PCBA)	74	
To be dismantled	3	PC (Transparent screen)	109	
To be dismantled	4	PC (External frame)	98	
To be dismantled	5	PC (Lamp body)	174	
To be dismantled	6	ABS Acrylonitrile Butadiene Styrene (GASKET)	1.2	
To be dismantled	7	PA66 (Terminal block)	7.95	
To be depolluted	8	Other battery	175	
To be depolluted	8	Capacitors	175	
To be dismantled	10	PE (Transparent film)	0.33	

Product description

Manufacturer identification	Schneider Electric Industries SAS
Brand name	Schnaider Electric
Product function	Non maintained emergency luminaire (EN 60598-2-22) luminaire in which the emergency lighting lamps are energized at all times when normal or emergency lighting is required
Product reference	OVA48529
Additional similar product references	OVA48524 OVA48525 OVA48526 OVA48527 OVA48528
Total representative product mass	770 g
Representative product dimensions	300mm x 127mm x 45,5mm
Date of information release	06/2024



Additional information

Legal information

The product family must be disposed according to the legislation of the country. This document is intended for use by end of life recyclers or treatment facilities. It provides the basic information to assure an appropriate end of life treatment for the components and materials of the product.

Recyclability potential

65%

Recyclability rate has been calculated based on REEECY'LAB tool developed by Ecosystem, for components/materials not covered by the tool, data from the "ECO'DEEE recyclability and recoverability calculation method" was taken. If no data was found a conservative assumption was used (0% recyclability).

Schneider Electric Industries SAS
Country Customer Care Center
<http://www.se.com/contact>
35, rue Joseph Monier
CS 30323
F- 92500 Rueil Malmaison Cedex
RCS Nanterre 954 503 439
Capital social 928 298 512 €

www.se.com

Published by Schneider Electric

ENVEOLI2403006_V1

© 2023 - Schneider Electric – All rights reserved

06-2024