

# Product End of Life Instructions

**ATH230 HVAC 4kW/5HP 200/240V 3PH IP20 Variable Speed Drive**

**Altivar HVAC ATH200**





## Potential disassembly risks

The information provided in this document assumes that the product is completely de-energized and uninstalled (refer to the instructions provided in the appropriate product manuals).

Dismantling/disassembling the product may entail hazards caused by, for example, sharp edges, chemical aggression or ejected parts.

### **▲ WARNING**

#### **HAZARD DUE TO INSUFFICIENT PROTECTION**

- Implement all safety measures required by the applicable regulations and by the processes used to dismantle/disassemble and dispose of the product.
- Use all necessary personal protective equipment such as gloves and goggles.

**Failure to follow these instructions can result in death or serious injury.**

## End of Life Instructions

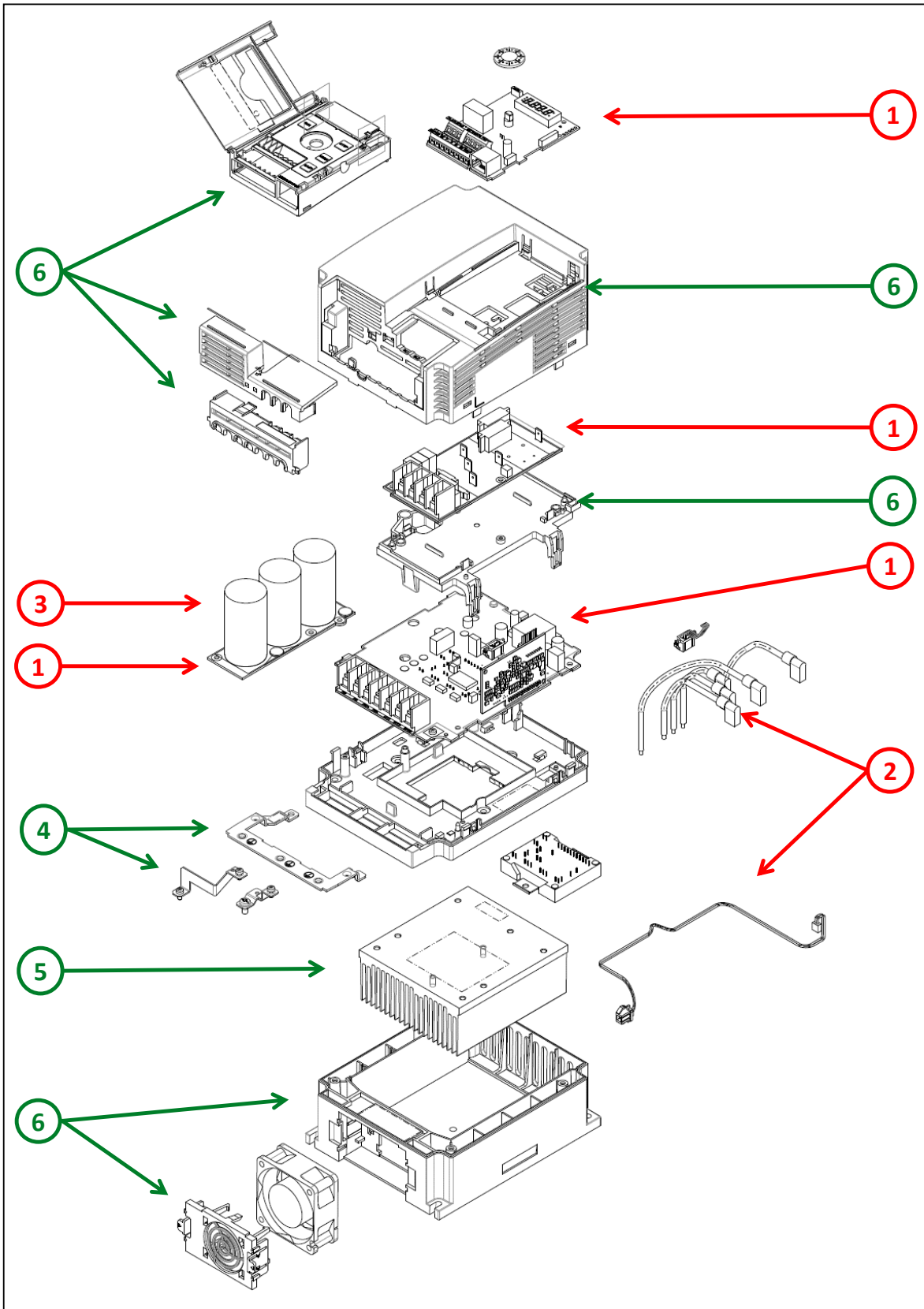

Recommendation	Number on drawing	Component / Material	Weight (in g)	Comment
To be depolluted	1	Electronic Board (Power and Communication) > 10cm <sup>2</sup>	404,1	
To be depolluted	2	Cable (high current)	71,9	
To be depolluted	3	Electrolyte capacitors which size: height > 25 mm, diameter > 25 mm or proportionately similar volume	192,0	
To be dismantled	4	Steel	36,6	Ground Bar - Ground Plate
To be dismantled	5	Aluminium	614,0	Heatsink
To be dismantled	6	PC, ABS-PC, PA, PA6, HDPE, SAN with or without additive, PP+EPDM and PP	656,9	Housing - Chassis - Control Door - Wiring Trap - Fan Support - Filter Support - Control Support - Wiring Cap
Other			224,5	

## Product description

Manufacturer identification	Schneider Electric Industries SAS
Brand name	Schneider Electric
Product function	The main function of the Altivar HVAC ATH200 product range is the speed control and variation of a synchronous and asynchronous motors in compact HVAC machines providing energy efficiency, reliability and safety in optimized control panel.
Product reference	ATH230U40M3
Description of the range	The environmental impacts of this reference product are representative of the impacts of the other products of the range which are developed with a similar technology. This range, Altivar HVAC ATH200, consists of a variable speed drive products designed for Original Equipment Manufacturers (OEMs) that meet pump and fan requirements in compact HVAC machines for 3 Phase synchronous and asynchronous motors from 3 to 4 kW (3 to 5 HP).
Total representative product mass	2200 g
Representative product dimensions	184mm x 140mm x 158mm
Accessories	No accessories needed.
Date of information release	22/10/2025

## Additional information

Legal information	This product family is in the scope of European Union directive 2012/19/EU on Waste Electrical and Electronic Equipment (WEEE). The product family must be disposed according to the legislation of the country. This document is intended for use by end of life recyclers or treatment facilities. It provides the basic information to assure an appropriate end of life treatment for the components and materials of the product.
In case of special transportation: transportation method	No special transportation.
Recyclability potential	<b>65%</b> The recyclability rate was calculated from the recycling rates of each material making up the product based on REEECY'LAB tool developed by Ecosystem, for components/materials not covered by the tool, data from the EIME database and the related PSR was taken. If no data was found a conservative assumption was used (0% recyclability).

*Schneider Electric Industries SAS*

*Country Customer Care Center  
<http://www.se.com/contact>*

*35, rue Joseph Monier  
CS 30323  
F- 92500 Rueil Malmaison Cedex  
RCS Nanterre 954 503 439  
Capital social 928 298 512 €*

[www.se.com](http://www.se.com)

ENVEOLI2506014\_V1

Published by Schneider Electric

© 2023 - Schneider Electric – All rights reserved

10-2025