



**DE** ZUMTOBEL Dreiphasen-Stromschienen-system. Nationale Installationsvorschriften beachten! System entspricht EN 60570.

**EN** ZUMTOBEL three circuit trac system. Please note national installation regulations! System corresponds to EN 60570.

**FR** Système de rails triphasés ZUMTOBEL. La mise en place doit respecter les normes nationales d'installation. Système conforme à la norme EN 60570.

**IT** Sistema con binariotrifase ZUMTOBEL. Fate attenzione alle norme nazionali d'installazione! Il sistema corrisponde a EN 60570.

**NL** ZUMTOBEL driefasen-spanningrail-systeem. Let op nationale installatievoorschriften. Het systeem komt overeen met EN 60570.

**SV** ZUMTOBEL kontaktskensystem 3-fas. Se i övrigt svenska starkströmföreskrifterna. Utförandet motsvarar EN 60570.

**FI** ZUMTOBEL 3-vaihe kosketinkiskojärjestelmä. Huomioikaa myös kansalliset asennusohjeet! Järjestelmä vastaa EN 60570 vaatimuksia.

**ES** Sistema de carriles electrificados trifásicos ZUMTOBEL. Deben observarse las normas nacionales de instalación. El sistema es conforme a EN 60570.

**i**



**IP20**

**DE** Anwendungsbereich: trockene Räume, auch im Handbereich. Montage: an/in Decken und Wänden - auf horizontalen Flächen (jedoch beachten, dass keine Flüssigkeiten in die Schiene gelangen). Freie Schienenenden müssen mit der Abschlussplatte versehen werden.

**EN** Recommended use: in dry rooms (conductors are protected against hand contact. Mounting: on/in ceilings and walls - on horizontal surfaces (ensure however that no liquid gets into the trac). Bare trac ends must be covered with an end plate.

**FR** Domaine d'utilisation: locaux secs compris à portée de la main. Montage: murs et plafonds, en saillie ou en saignée - surfaces horizontales (veuillez à l'absence d'infiltration d'humidité dans les rails. Les extrémités libres des rails doivent être équipées de plaques terminales.

**IT** Campo d'applicazione: ambienti asciutti, protetto contro il contatto accidentale. Montaggio: a/in soffitti e pareti - su superfici orizzontali (fate tuttavia attenzione, che nessun fluido entri nel binario). Le estremità libere del binario devono essere provviste di piastra di chiusura.

**NL** Toepassingsgebied: droge ruimten, ook onder handbereik. Montage: op/in plafonds en wanden, op horizontale vlakken (echter erop letten dat er geen vloeistoffen in de rail kunnen komen). Open railenden moeten met de eindplaatje gesloten worden.

**SV** Användningsomraden: torra rum. Installeras i tak och påväggar. Undvik närhet till vätska. Skenända utan kopplingsdel måste täckas med avsett ändstycke.

**FI** Suositeltavat käyttöolosuhteet: kuivat tilat, asennuskorkeus 1,7 m. Asennus: katto/seinä asennus mahdollinen, myös vaakasuora asennus (varmistaa että kiskoon ei pääse valumaan vettä tms.). Paljaat kiskonpääät on suojattava peitelevyllä.

**ES** Campo de aplicación: zonas secas, también al alcance de la mano. Montaje: sobre/en techos y paredes - sobre superficies horizontales (sin embargo, asegurarse de que no penetren líquidos a los carriles). Los extremos libres de los carriles deben cubrirse con una tapa de cierre.



**DE** Die Montage und Inbetriebnahme darf nur von autorisiertem Fachpersonal durchgeführt werden.

**EN** Installation and commissioning may only be carried out by authorized specialists.

**FR** L'installation et la mise en service doivent obligatoirement être effectuées par des techniciens.

**IT** Montaggio ed avviamento devono essere eseguiti solo da personale specializzato.

**NL** De montage en inbedrijfstelling mogen enkel door erkend vakpersoneel worden uitgevoerd.

**SV** Montringen och idrifttagandet får endast företas av auktoriserad fackpersonal.

**FI** Asennuksen ja käyttöönoton saa tehdä vain auktorisoitu ammattihenkilöstö.

**ES** El montaje y la puesta en marcha sólo puede ser realizado por personal especializado autorizado.





**DE** Warnhinweis: Die Verantwortung für die elektrische, mechanische und thermische Verträglichkeit des Stromschienensystems mit den daran angebrachten Leuchten ist gemäß IEC 60570 vom Nutzer sicherzustellen.  
Die sichere Verwendung von Leuchten mit **Adaptertyp 3T\*, 3A\*, 3X\*** ist in Verbindung mit dem ZUMTOBEL TRACK ADVANCED Schienensystem geprüft und die Eignung dieser Kombination wird zugesichert. Weitergehende Informationen zur fachgerechten Nutzung sind der Produktwebseite zu entnehmen.  
Es ist strengstens verboten, Lösungsmittel, Klebstoffe, Öle, Entfetter oder Reinigungsmittel jeglicher Art mit allen Komponenten des Systems in Kontakt zu bringen.

**EN** Note: The user is responsible for ensuring the electrical, mechanical, and thermal compatibility of the track lighting system with the luminaires attached to it, in accordance with IEC 60570. The safe use of luminaires with adapter types 3T\*, 3A\*, and 3X\* has been tested in conjunction with the ZUMTOBEL TRACK ADVANCED track lighting system, and the suitability of this combination is guaranteed. Further information on proper use can be found on the product website. It is strictly forbidden to use any type of solvent, glue, oil, degreaser or detergent in contact with all components of the system

**FR** Attention: Il incombe à l'utilisateur de s'assurer de la compatibilité électrique, mécanique et thermique du système d'éclairage sur rail avec les luminaires qui y sont raccordés, conformément à la norme IEC 60570.  
L'utilisation en toute sécurité des luminaires équipés des adaptateurs de type 3T\*, 3A\* et 3X\* a été testée avec le système d'éclairage sur rail ZUMTOBEL TRACK ADVANCED, et la compatibilité de cette combinaison est garantie.  
Pour plus d'informations sur l'utilisation correcte, veuillez consulter le site web du produit.  
Il est strictement interdit d'utiliser tout type de solvant, colle, huile, dégraissant ou détergent en contact avec tous les composants du système

**FI** Varoitus: Käyttäjä on vastuussa kiskojärjestelmän ja siihen kytkettyjen valaisimien sähköisestä, mekaanisesta ja termisestä yhteensopivuudesta IEC 60570 -standardin mukaisesti.  
3T\*- ja 3A\*- ja 3X\*-sovittimilla varustettujen valaisimien turvallinen käyttö on testattu yhdessä ZUMTOBEL TRACK ADVANCED -kiskojärjestelmän kanssa, ja tämän yhdistelmän sopivuus on taattu.  
Lisätietoja asianmukaisesta käytöstä löytyy tuotteen verkkosivuilta.  
Minkäänlaisten liuottimien, liimojen, öljyjen, rasvanpoistoaineiden tai pesuaineiden käyttö järjestelmän kaikkien osien kanssa on ehdottomasti kielletty.

**IT** Note bene: L'utente è responsabile di garantire la compatibilità elettrica, meccanica e termica del sistema di illuminazione a binario con gli apparecchi di illuminazione ad esso collegati, in conformità alla norma IEC 60570.  
L'uso sicuro degli apparecchi di illuminazione con adattatori di tipo 3T\*, 3A\* e 3X\* è stato testato in combinazione con il sistema di illuminazione a binario ZUMTOBEL TRACK ADVANCED e l'idoneità di questa combinazione è garantita.  
Ulteriori informazioni sull'uso corretto sono disponibili sul sito web del prodotto.  
È severamente vietato utilizzare qualsiasi tipo di solvente, colla, olio, sgrassante o detergente a contatto con tutti i componenti del sistema.

**NL** Let op: De gebruiker is verantwoordelijk voor het waarborgen van de elektrische, mechanische en thermische compatibiliteit van het railsysteem met de daaraan bevestigde armaturen, conform IEC 60570.  
Het veilige gebruik van armaturen met adaptertypen 3T\*, 3A\* en 3X\* is getest in combinatie met het ZUMTOBEL TRACK ADVANCED railsysteem en de geschiktheid van deze combinatie is gegarandeerd. Meer informatie over correct gebruik is te vinden op de productwebsite.  
Het is ten strengste verboden om oplosmiddelen, lijm, olie, ontvetter of reinigingsmiddel in contact te brengen met alle onderdelen van het systeem

**SV** Advarsel: Användaren ansvarar för att säkerställa att skenbelysningsystemet är elektriskt, mekaniskt och termiskt kompatibelt med de armaturer som är anslutna till det, i enlighet med IEC 60570.  
Säker användning av armaturer med adaptertyperna 3T\*, 3A\* och 3X\* har testats i samband med skenbelysningsystemet ZUMTOBEL TRACK ADVANCED, och lämpligheten av denna kombination garanteras.  
Mer information om korrekt användning finns på produktens webbplats.  
Det är strikt förbjudt att bruke noen form for løsemiddel, lim, olje, avfettingsmiddel eller vaskemiddel i kontakt med alle komponenter i systemet.

**ES** Advertencia: El usuario es responsable de garantizar la compatibilidad eléctrica, mecánica y térmica del sistema de iluminación de riel con las luminarias instaladas, de acuerdo con la norma IEC 60570.  
El uso seguro de luminarias con adaptadores de tipo 3T\*, 3A\* y 3X\* se ha probado junto con el sistema de iluminación de riel ZUMTOBEL TRACK ADVANCED, y se garantiza su idoneidad.  
Para más información sobre el uso correcto, visite el sitio web del producto.  
Está estrictamente prohibido utilizar cualquier tipo de disolvente, pegamento, aceite, desengrasante o detergente en contacto con todos los componentes del sistema.

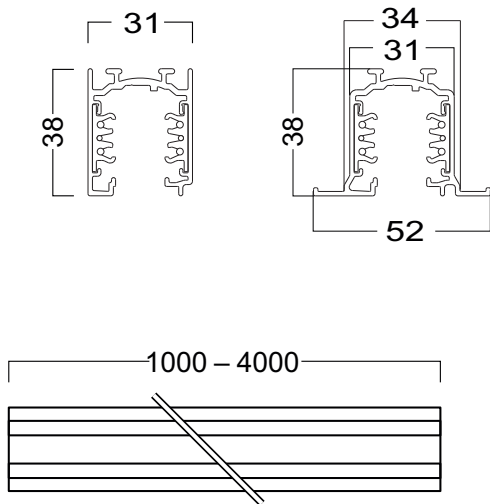
**i**

CODE	DESCRIPTION
42200529	TRACK ADV 3PH+DALI 1000 WH
42200530	TRACK ADV 3PH+DALI 2000 WH
42200531	TRACK ADV 3PH+DALI 3000 WH
42200532	TRACK ADV 3PH+DALI 4000 WH
42200533	TRACK ADV 3PH+DALI 1000 BK
42200534	TRACK ADV 3PH+DALI 2000 BK
42200535	TRACK ADV 3PH+DALI 3000 BK
42200536	TRACK ADV 3PH+DALI 4000 BK
42200537	TRACK ADV 3PH+DALI 1000 AN
42200538	TRACK ADV 3PH+DALI 2000 AN
42200539	TRACK ADV 3PH+DALI 3000 AN
42200540	TRACK ADV 3PH+DALI 4000 AN
42200541	TRACK-R ADV 3PH+DALI 3000 WH
42200542	TRACK-R ADV 3PH+DALI 3000 BK

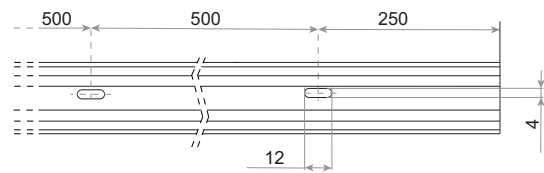
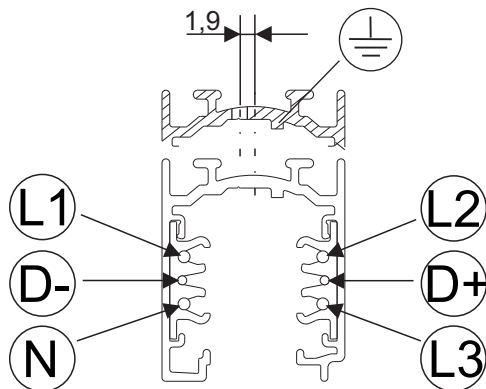
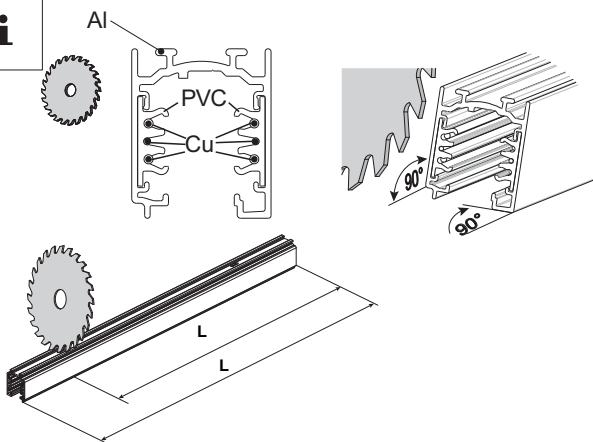
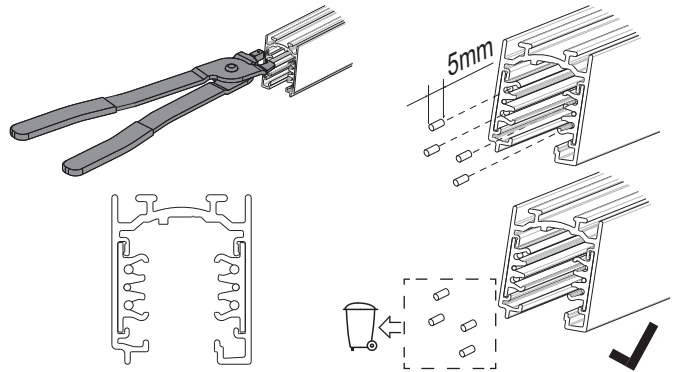
**i****i****42200647** TRACK BASIC/ADV CUTTER

**DE** Bauseitiges Kürzen der Schiene: N- und L-Leiter müssen zurückgeschnitten werden.

**EN** Cut to size of the track on size: N- and L-conductors must be cut back.

**NL** Ter plaatse in te korten rails: N- en L-leider moeten teruggeknipt worden.

**FR** Raccourcissement des rails sur chantier: Les conducteurs actifs et neutre doivent être recoupés.

**SV** Vid kapning av skena: N- och L-ledare måste kapas kortare än skenlängd.

**FI** Kosketinkiskojen katkaisu asennuspaikalla: N- ja L-johtimet on katkaistava erikoistyökallulla.

**IT** Accorciamento del binario sul posto: I conduttori N e L devono essere tagliati alla distanza di sicurezza.

**ES** Corte a la medida de los carriles en obra: deben recortarse los conductos N y L.



**DE** Belastung bei angegebener Befestigungsart.

**SV** Belastning ved angitt fikseringsmåte.

**EN** Carrying load with indicated type of fixing.

**FI** Kantavuusi kiinnitystavastra rippuen.

**FR** Charges maximales en fonction du mode de fixation.

**ES** Carga máxima con el tipo de fijación indicado.

**IT** Carico per il tipo di fissaggio indicato.

**NL** Belasting bij aangegeven montagewijze

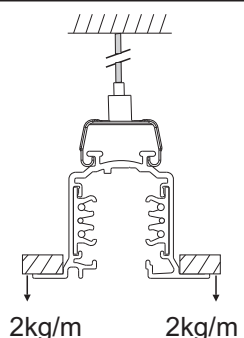

**i**

deflection X [mm/m]	6		4		2	
distance L [mm]	load F [N]	suspension type	load F [N]	suspension type	load F [N]	suspension type
3000	58	SUSP SET/ TUBE/ROD KIT	35	SUSP SET/ TUBE/ROD KIT	12	SUSP SET/ TUBE/ROD KIT
2500	90		70		24	
2000	147		96		45	
1500	-	-	177	-	86	-
1000	-	-	-	-	203	-

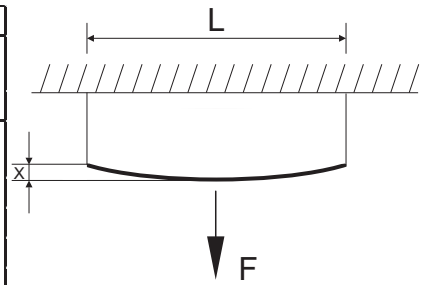
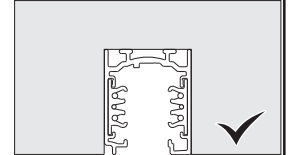
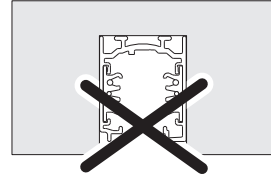
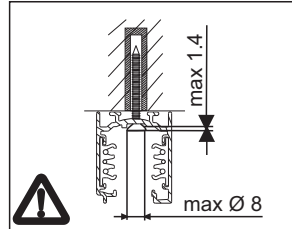
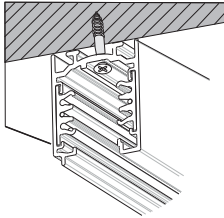
**i****1**

42200638 TRACK BASIC/ADV MOUNT ACC

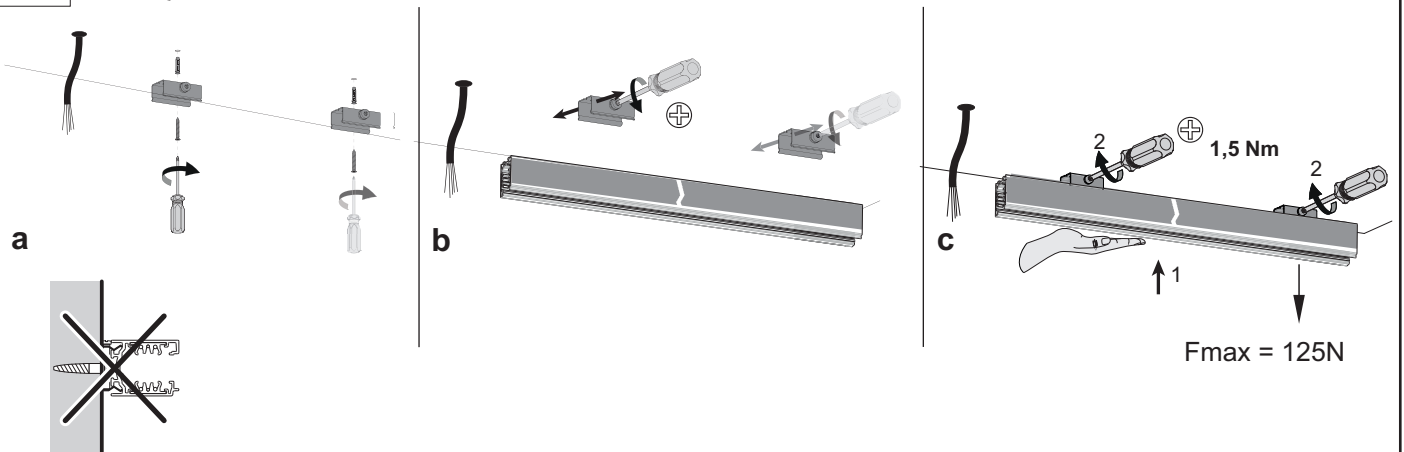
**i**

42200641 TRACK BASIC/ADV PEND TUBE KIT 1200 BK

42200642 TRACK BASIC/ADV PEND TUBE KIT 1200 WH

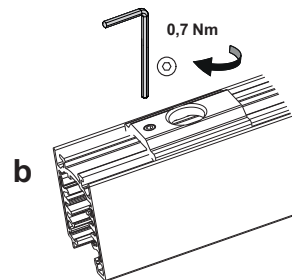
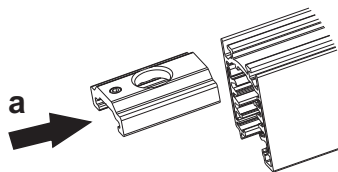
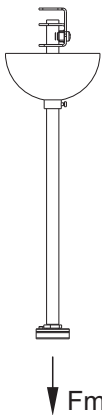
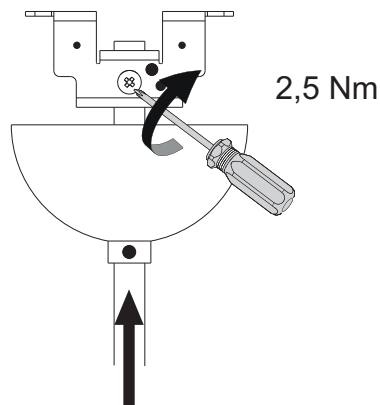
**1**

**i**

42200643	TRACK BASIC/ADV THREADED ROD KIT 1000 BK
42200644	TRACK BASIC/ADV THREADED ROD KIT 1000 WH

**a**

**b** 0,7 Nm

$F_{max} = 125N$

**i**

22173126	TRACK BASIC/ADV SUSP SET 2000
22173127	TRACK BASIC/ADV SUSP SET 5000

**1**

**2**

**a**

**b**

**3**

**a**

**b**

**c**

$F_{max} = 125N$

$F_{max} = 125N$

**i**

60280107	TRACK BASIC/ADV SUSP DOME BK
60280108	TRACK BASIC/ADV SUSP DOME WH

Seil sep. bestellbar / rope can be ordered separately

max. 30°

**1**

**a**

**b**

**c**

60280109  
60280110

**i**

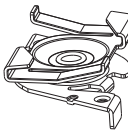

42200639	TRACK BASIC/ADV QUICK FIX BK
42200640	TRACK BASIC/ADV QUICK FIX WH

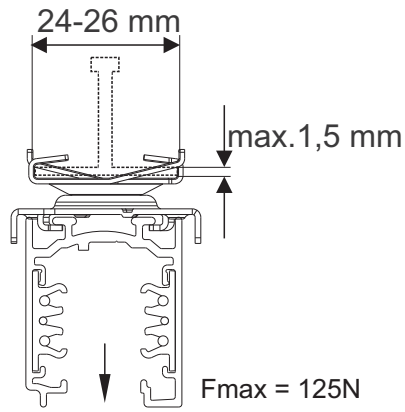

**i**

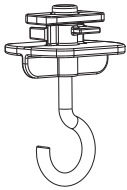

42200646	TRACK BASIC/ADV HOOK WH
----------	-------------------------

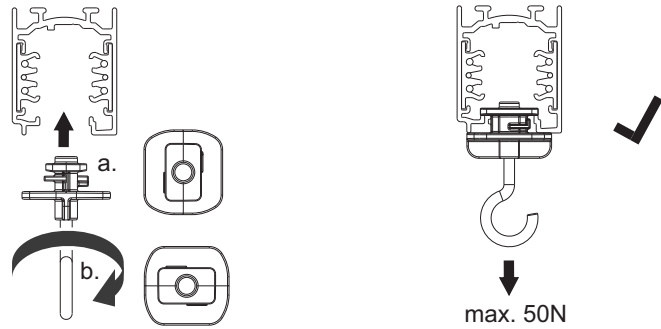

**i**

**CODING**

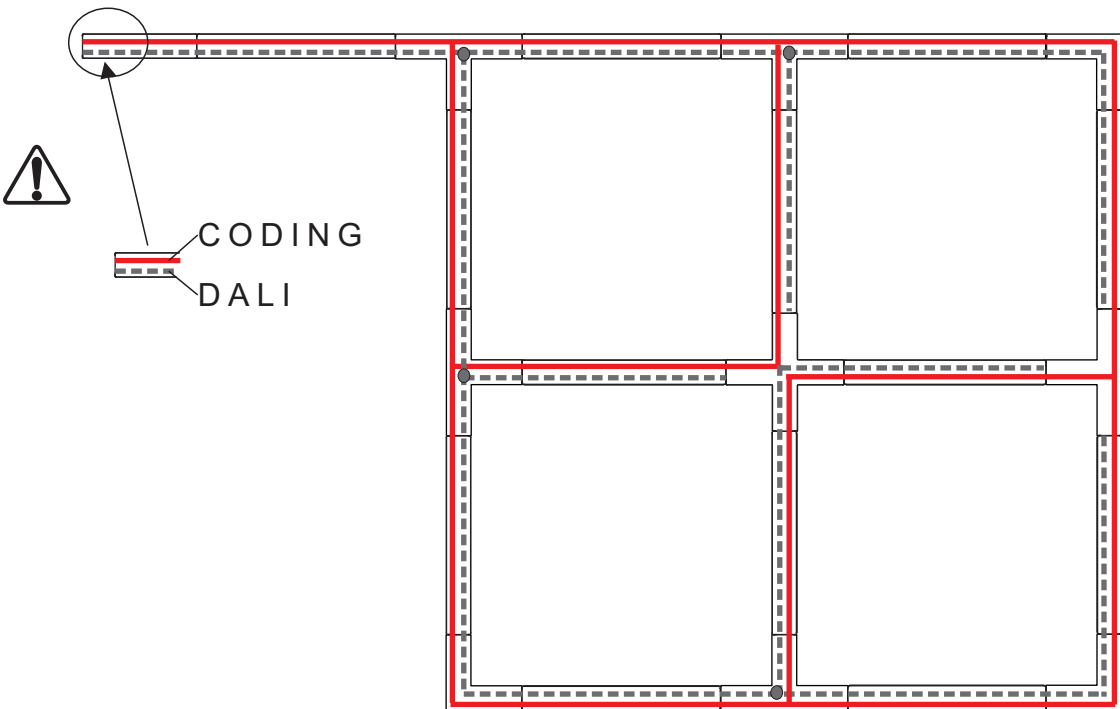
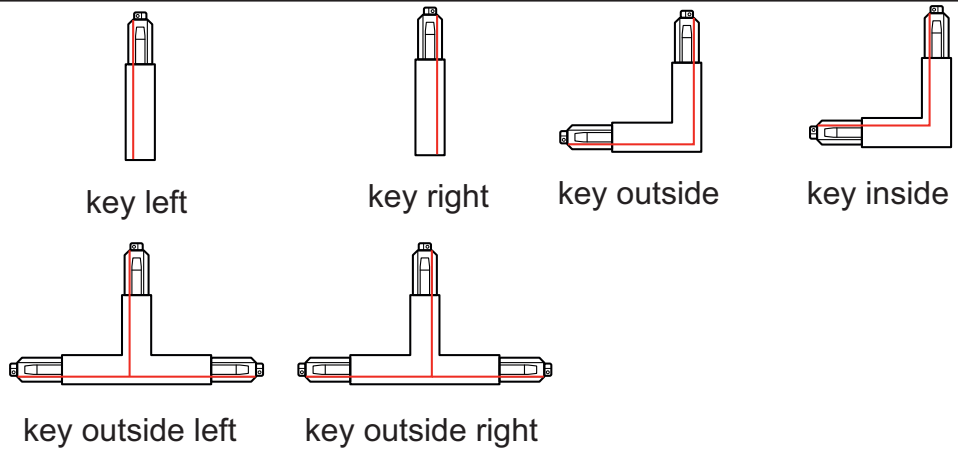
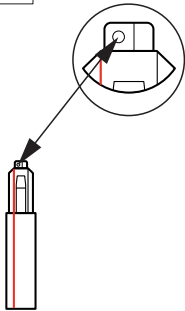

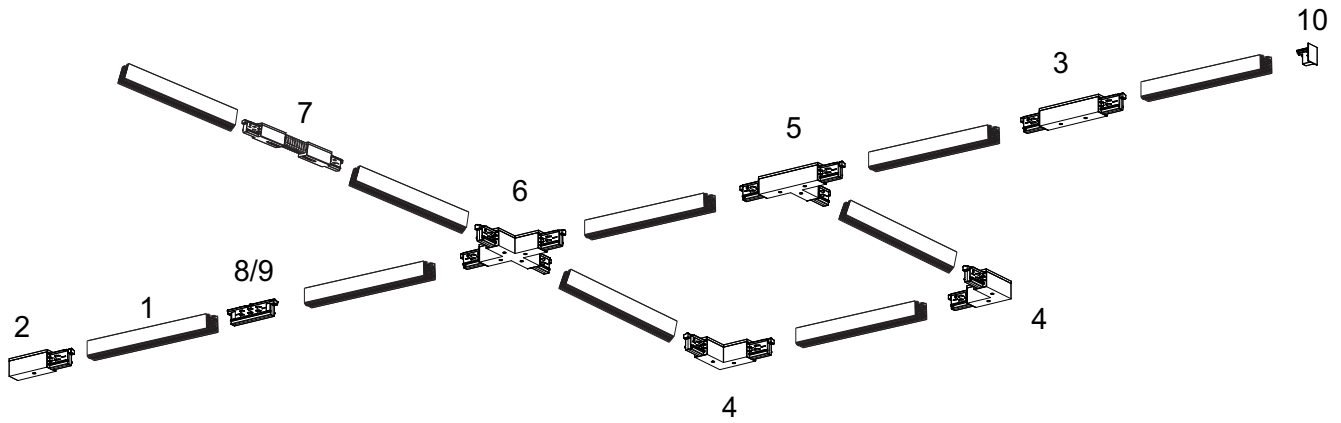

	CODE	DESCRIPTION
1	42200529	TRACK ADV 3PH+DALI 1000 WH
	42200530	TRACK ADV 3PH+DALI 2000 WH
	42200531	TRACK ADV 3PH+DALI 3000 WH
	42200532	TRACK ADV 3PH+DALI 4000 WH
	42200533	TRACK ADV 3PH+DALI 1000 BK
	42200534	TRACK ADV 3PH+DALI 2000 BK
	42200535	TRACK ADV 3PH+DALI 3000 BK
	42200536	TRACK ADV 3PH+DALI 4000 BK
	42200537	TRACK ADV 3PH+DALI 1000 AN
	42200538	TRACK ADV 3PH+DALI 2000 AN
	42200539	TRACK ADV 3PH+DALI 3000 AN
	42200540	TRACK ADV 3PH+DALI 4000 AN
	42200541	TRACK-R ADV 3PH+DALI 3000 WH
	42200542	TRACK-R ADV 3PH+DALI 3000 BK
2	42200544	TRACK ADV 3PH+DALI END FEED R BK
	42200545	TRACK ADV 3PH+DALI END FEED R WH
	42200546	TRACK ADV 3PH+DALI END FEED L BK
	42200547	TRACK ADV 3PH+DALI END FEED L WH
3	42200548	TRACK ADV 3PH+DALI MID FEED BK
	42200549	TRACK ADV 3PH+DALI MID FEED WH
4	42200550	TRACK ADV 3PH+DALI L-CON I BK
	42200551	TRACK ADV 3PH+DALI L-CON I WH
	42200552	TRACK ADV 3PH+DALI L-CON O BK
	42200553	TRACK ADV 3PH+DALI L-CON O WH
5	42200554	TRACK ADV 3PH+DALI T-CON O L BK
	42200555	TRACK ADV 3PH+DALI T-CON O L WH
	42200556	TRACK ADV 3PH+DALI T-CON O R BK
	42200557	TRACK ADV 3PH+DALI T-CON O R WH
6	42200558	TRACK ADV 3PH+DALI X-CON BK
	42200559	TRACK ADV 3PH+DALI X-CON WH
7	42200560	TRACK ADV 3PH+DALI FLEX CON BK
	42200561	TRACK ADV 3PH+DALI FLEX CON WH
8	42200562	TRACK ADV 3PH+DALI ELEC CON BK
	42200563	TRACK ADV 3PH+DALI ELEC CON WH
9	42200634	TRACK BASIC/ADV MECH CON BK
	42200635	TRACK BASIC/ADV MECH CON WH
10	42200636	TRACK BASIC/ADV END CAP BK
	42200637	TRACK BASIC/ADV END CAP WH



ONLY for CROSSIGN, ZUMTOBEL, L3 permanently

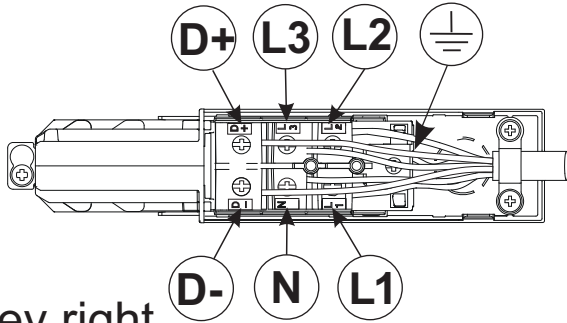
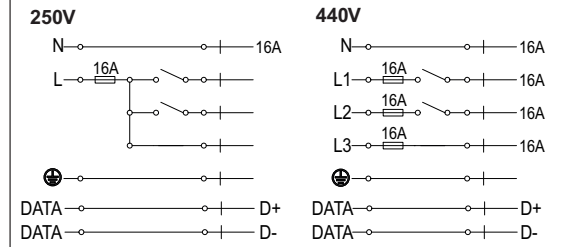
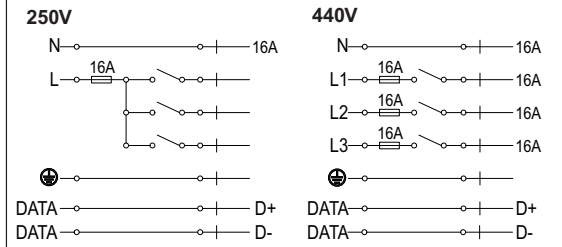

key right

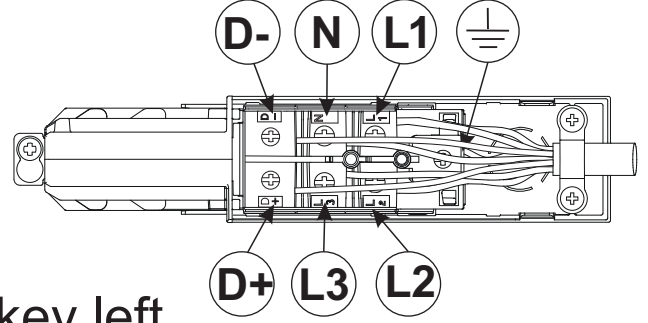

key left

1

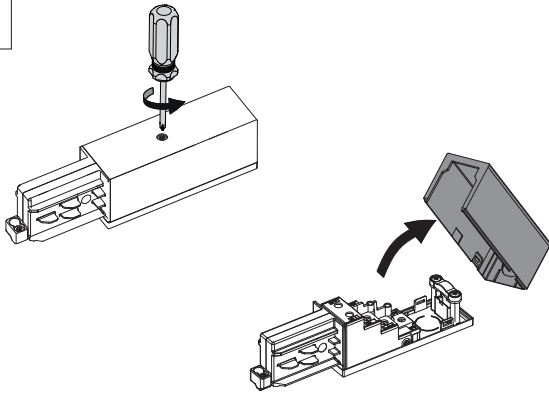

2

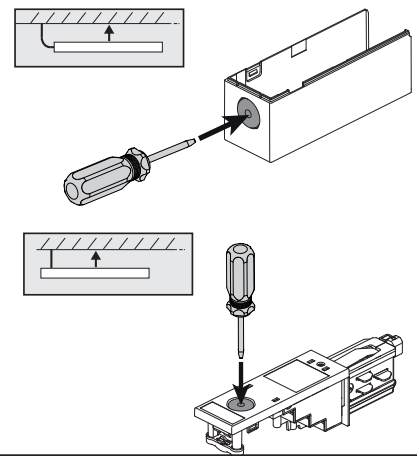

3

7 x 1,5-2,5 mm<sup>2</sup>

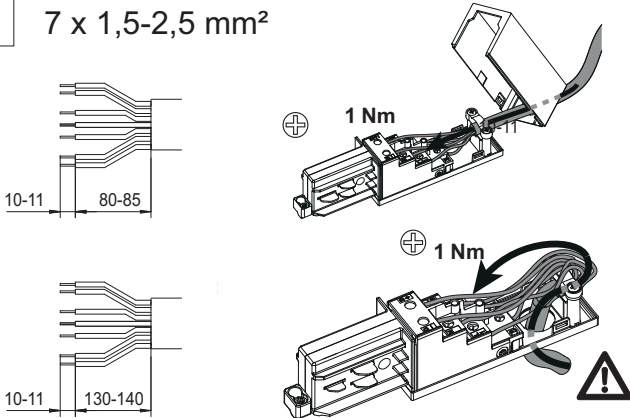

4

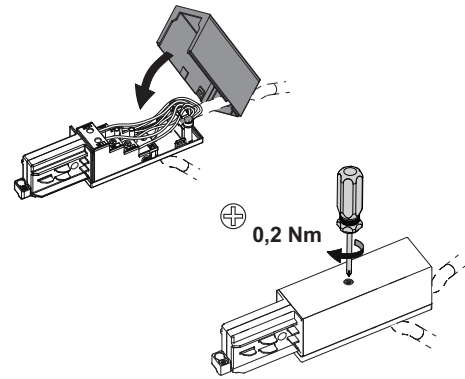

5

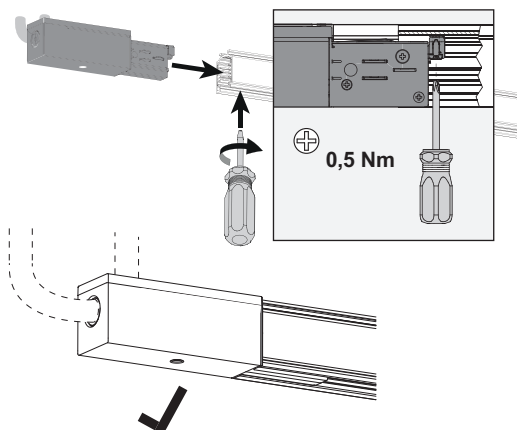

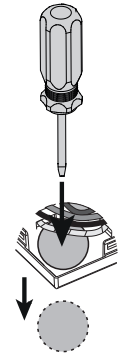
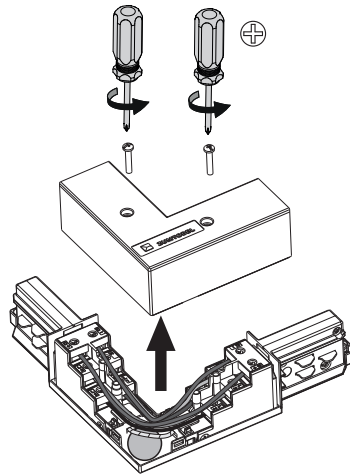
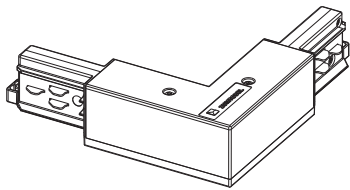
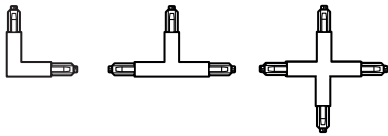
**i****1**

replace Dali 1 mm<sup>2</sup> wire  
with a 1,5mm<sup>2</sup> wire

7 x 1,5 mm<sup>2</sup>

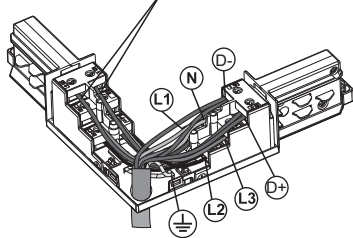
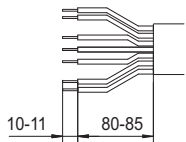
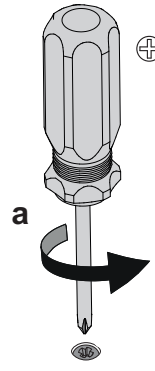
**2**

7 x

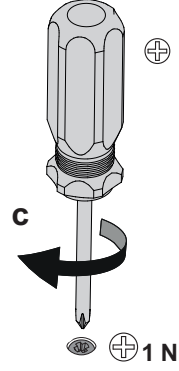

1 Nm

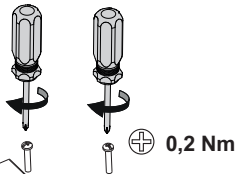
**3**

0,2 Nm

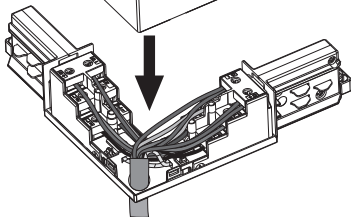
**i**

42200566 TRACK ADV END CAP R-COVER BK

42200567 TRACK ADV END CAP R-COVER WH

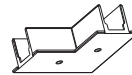

42200572 TRACK ADV L-CON R-COVER BK

42200573 TRACK ADV L-CON R-COVER WH



42200568 TRACK ADV END FEED R-COVER BK

42200569 TRACK ADV END FEED R-COVER WH

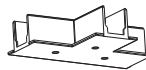

42200574 TRACK ADV T-CON R-COVER BK

42200575 TRACK ADV T-CON R-COVER WH

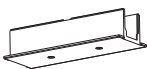

42200570 TRACK ADV MID FEED R-COVER BK

42200571 TRACK ADV MID FEED R-COVER WH



42200576 TRACK ADV X-CON R-COVER BK

42200577 TRACK ADV X-CON R-COVER WH

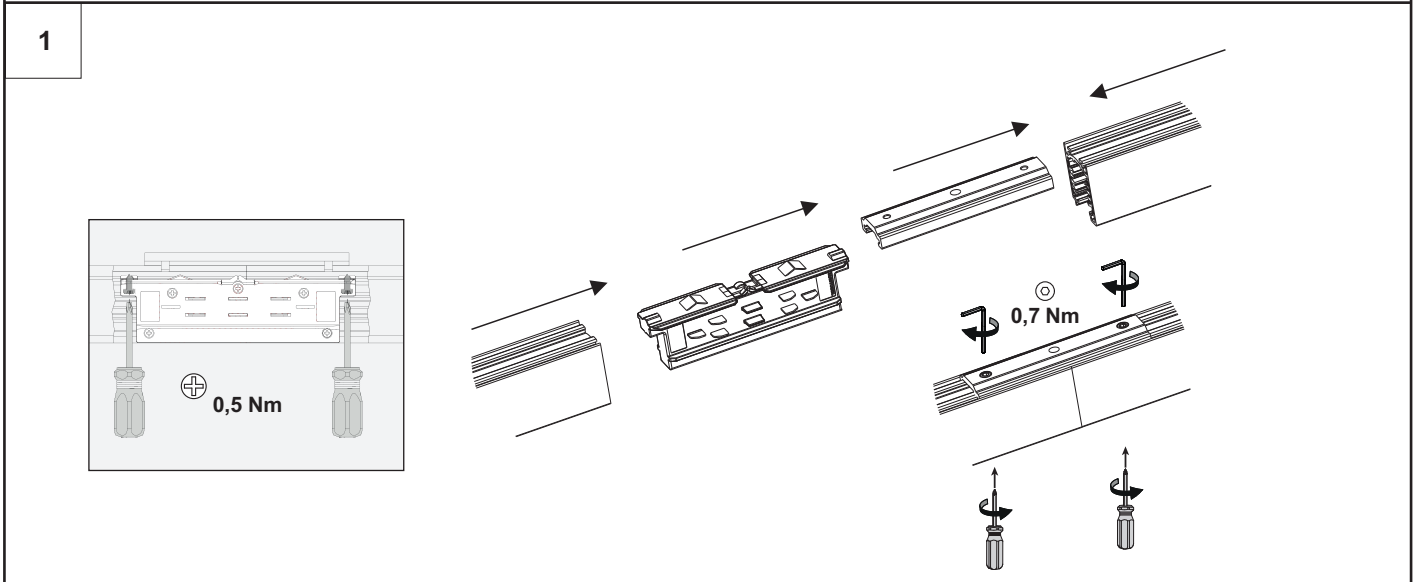
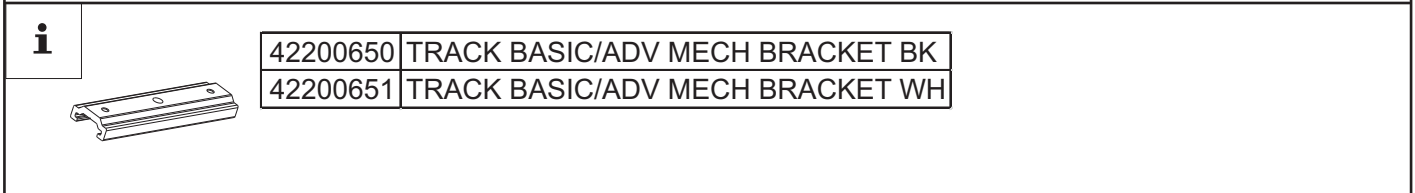
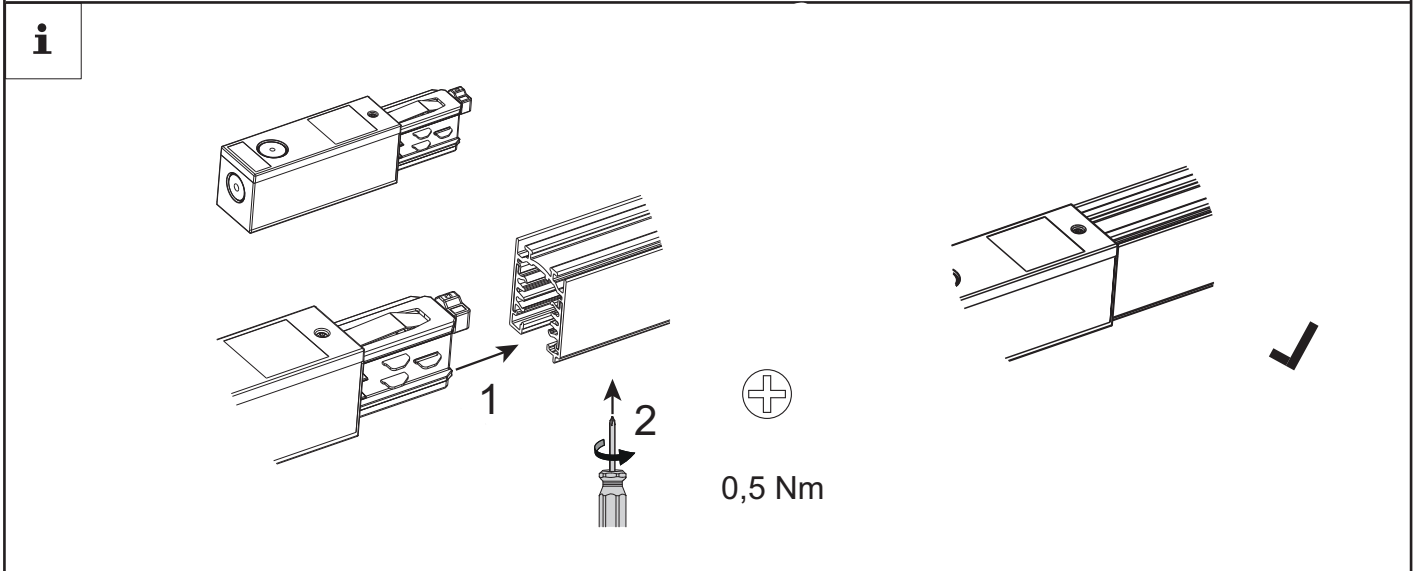
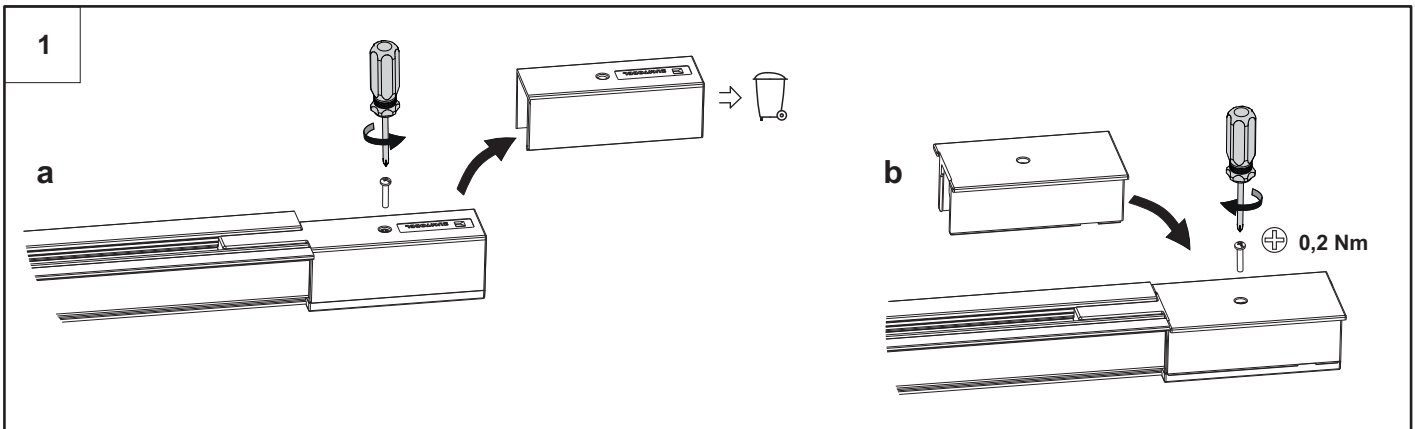

Technische Änderungen vorbehalten. - Specifications subject to change without notice. - Modifications techniques sans préavis.  
 Modificazione tecnica senza preavviso. - Technische wijzigingen voorbehouden.  
 Med forbehold om tekniske endringer. - Oikeudet teknisiin muutoksiin pidätetään. - Modificaciones técnicas sin preaviso.