



DE ZUMTOBEL Dreiphasen-Stromschienensystem. Nationale Installationsvorschriften beachten! System entspricht EN 60570.

FR Système de rails triphasés ZUMTOBEL. La mise en place doit respecter les normes nationales d'installation. Système conforme à la norme EN 60570.

SV ZUMTOBEL kontaktskenskystem 3-fas. Se i övrigt svenska starkströmföreskrifterna. Utförandet motsvarar EN 60570.

EN ZUMTOBEL three circuit trac system. Please note national installation regulations! System corresponds to EN 60570.

IT Sistema con binario trifase ZUMTOBEL. Fate attenzione alle norme nazionali d'installazione! Il sistema corrisponde a EN 60570.

FI ZUMTOBEL 3-vaihe kosketinkiskojärjestelmä. Huomioikaa myös kansalliset asennusohjeet! Järjestelmä vastaa EN 60570 vaatimuksia.

NL ZUMTOBEL driefasen-spanningrail-systeem. Let op nationale installatievoorschriften. Het systeem komt overeen met EN 60570.

ES Sistema de carriles electrificados trifásicos ZUMTOBEL. Deben observarse las normas nacionales de instalación. El sistema es conforme a EN 60570.

i



IP20

DE Anwendungsbereich: trockene Räume, auch im Handbereich. Montage: an/in Decken und Wänden - auf horizontalen Flächen (jedoch beachten, dass keine Flüssigkeiten in die Schiene gelangen). Freie Schienenenden müssen mit der Abschlussplatte versehen werden.

NL Toepassingsgebied: droge ruimten, ook onder handbereik. Montage: op/in plafonds en wanden, op horizontale vlakken (echter erop letten dat er geen vloeistoffen in de rail kunnen komen). Open railenden moeten met de eindplaatje gesloten worden.

EN Recommended use: in dry rooms (conductors are protected against hand contact). Mounting: on/in ceilings and walls - on horizontal surfaces (ensure however that no liquid gets into the trac). Bare trac ends must be covered with an end plate.

SV Användningsomraden: torra rum. Installeras i tak och påväggar. Undvik närhet till vätska. Skenända utan kopplingsdel måste täckas med avsett ändstycke.

FR Domaine d'utilisation: locaux secs compris à portée de la main. Montage: murs et plafonds, en saillie ou en saignée - surfaces horizontales (veuillez à l'absence d'infiltration d'humidité dans les rails. Les extrémités libres des rails doivent être équipées de plaques terminales.

FI Suositeltavat käyttöolosuhteet: kuivat tilat, asennuskorkeus 1,7 m. Asennus: katto/seinä asennus mahdollinen, myös vaakasuora asennus (varmista että kiskoon ei pääse valumaan vettä tms.). Paljaat kiskonpääät on suojattava peitelevyllä.

IT Campo d'applicazione: ambienti asciutti, protetto contro il contatto accidentale. Montaggio: a/in soffitti e pareti - su superfici orizzontali (fate tuttavia attenzione, che nessun fluido entri nel binario). Le estremità libere del binario devono essere provviste di piastra di chiusura.

ES Campo de aplicación: zonas secas, también al alcance de la mano. Montaje: sobre/en techos y paredes - sobre superficies horizontales (sin embargo, asegurarse de que no penetren líquidos a los carriles). Los extremos libres de los carriles deben cubrirse con una tapa de cierre.



DE Die Montage und Inbetriebnahme darf nur von autorisiertem Fachpersonal durchgeführt werden.

NL De montage en inbedrijfstelling mogen enkel door erkend vakpersoneel worden uitgevoerd.



EN Installation and commissioning may only be carried out by authorized specialists.

SV Montringen och idrifttagandet får endast företas av auktoriserad fackpersonal.

FR L'installation et la mise en service doivent obligatoirement être effectuées par des techniciens.

FI Asennuksen ja käyttöönoton saa tehdä vain auktorisoitu ammattihenkilöstö.

IT Montaggio ed avviamento devono essere eseguiti solo da personale specializzato.

ES El montaje y la puesta en marcha sólo puede ser realizado por personal especializado autorizado.



DE Warnhinweis: Die Verantwortung für die elektrische, mechanische und thermische Verträglichkeit des Stromschienensystems mit den daran angebrachten Leuchten ist gemäß IEC 60570 vom Nutzer sicherzustellen.

Die sichere Verwendung von Leuchten mit **Adaptertyp 3T*, 3A*, 3X*** ist in Verbindung mit dem ZUMTOBEL TRACK BASIC Schienensystem geprüft und die Eignung dieser Kombination wird zugesichert. Weitergehende Informationen zur fachgerechten Nutzung sind der Produktwebseite zu entnehmen.

Es ist strengstens verboten, Lösungsmittel, Klebstoffe, Öle, Entfetter oder Reinigungsmittel jeglicher Art mit allen Komponenten des Systems in Kontakt zu bringen.

EN Note: The user is responsible for ensuring the electrical, mechanical, and thermal compatibility of the track lighting system with the luminaires attached to it, in accordance with IEC 60570. The safe use of luminaires with adapter types 3T*, 3A*, and 3X* has been tested in conjunction with the ZUMTOBEL TRACK BASIC track lighting system, and the suitability of this combination is guaranteed. Further information on proper use can be found on the product website. It is strictly forbidden to use any type of solvent, glue, oil, degreaser or detergent in contact with all components of the system

FR Attention: Il incombe à l'utilisateur de s'assurer de la compatibilité électrique, mécanique et thermique du système d'éclairage sur rail avec les luminaires qui y sont raccordés, conformément à la norme IEC 60570. L'utilisation en toute sécurité des luminaires équipés des adaptateurs de type 3T*, 3A* et 3X* a été testée avec le système d'éclairage sur rail ZUMTOBEL TRACK BASIC, et la compatibilité de cette combinaison est garantie. Pour plus d'informations sur l'utilisation correcte, veuillez consulter le site web du produit. Il est strictement interdit d'utiliser tout type de solvant, colle, huile, dégraissant ou détergent en contact avec tous les composants du système

FI Varoitus: Käyttäjä on vastuussa kiskojärjestelmän ja siihen kytkettyjen valaisimien sähköisestä, mekaanisesta ja termisestä yhteensopivuudesta IEC 60570 -standardin mukaisesti. 3T*- ja 3X* -sovittimilla varustettujen valaisimien turvallinen käyttö on testattu yhdessä ZUMTOBEL TRACK BASIC -kiskojärjestelmän kanssa, ja tämän yhdistelmän sopivuus on taattu. Lisätietoja asianmukaisesta käytöstä löytyy tuotteen verkkosivuilta. Minkäänlaisten liuottimien, liimojen, öljyjen, rasvanpoistoaineiden tai pesuaineiden käyttö järjestelmän kaikkien osien kanssa on ehdottomasti kielletty.

IT Note bene: L'utente è responsabile di garantire la compatibilità elettrica, meccanica e termica del sistema di illuminazione a binario con gli apparecchi di illuminazione ad esso collegati, in conformità alla norma IEC 60570.

L'uso sicuro degli apparecchi di illuminazione con adattatori di tipo 3T*, 3A* e 3X* è stato testato in combinazione con il sistema di illuminazione a binario ZUMTOBEL TRACK BASIC e l'idoneità di questa combinazione è garantita.

Ulteriori informazioni sull'uso corretto sono disponibili sul sito web del prodotto.

È severamente vietato utilizzare qualsiasi tipo di solvente, colla, olio, sgrassante o detergente a contatto con tutti i componenti del sistema.

NL Let op: De gebruiker is verantwoordelijk voor het waarborgen van de elektrische, mechanische en thermische compatibiliteit van het railsysteem met de daaraan bevestigde armaturen, conform IEC 60570.

Het veilige gebruik van armaturen met adaptertypen 3T*, 3A* en 3X* is getest in combinatie met het ZUMTOBEL TRACK BASIC railsysteem en de geschiktheid van deze combinatie is gegarandeerd. Meer informatie over correct gebruik is te vinden op de productwebsite.

Het is ten strengste verboden om oplosmiddelen, lijm, olie, ontvetter of reinigingsmiddel in contact te brengen met alle onderdelen van het systeem

SV Advarsel: Användaren ansvarar för att säkerställa att skenbelysningsssystemet är elektriskt, mekaniskt och termiskt kompatibelt med de armaturer som är anslutna till det, i enlighet med IEC 60570.

Säker användning av armaturer med adaptertyperna 3T*, 3A* och 3X* har testats i samband med skenbelysningsssystemet ZUMTOBEL TRACK BASIC, och lämpligheten av denna kombination garanteras.

Mer information om korrekt användning finns på produktens webbplats.

Det er strengt forbudt å bruke noen form for løsemiddel, lim, olje, avfettingsmiddel eller vaskemiddel i kontakt med alle komponenter i systemet.

ES Advertencia: El usuario es responsable de garantizar la compatibilidad eléctrica, mecánica y térmica del sistema de iluminación de riel con las luminarias instaladas, de acuerdo con la norma IEC 60570.

El uso seguro de luminarias con adaptadores de tipo 3T*, 3A* y 3X* se ha probado junto con el sistema de iluminación de riel ZUMTOBEL TRACK BASIC, y se garantiza su idoneidad. Para más información sobre el uso correcto, visite el sitio web del producto.

Está estrictamente prohibido utilizar cualquier tipo de disolvente, pegamento, aceite, desengrasante o detergente en contacto con todos los componentes del sistema.

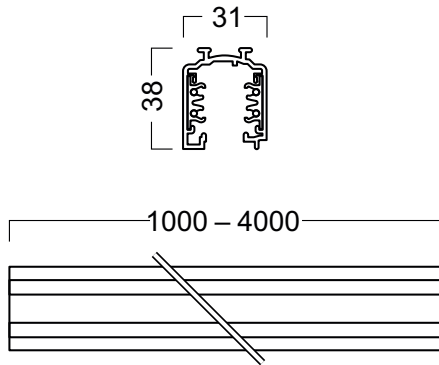
i

42200578	TRACK BASIC 3PH 1000 WH
42200579	TRACK BASIC 3PH 2000 WH
42200580	TRACK BASIC 3PH 3000 WH
42200581	TRACK BASIC 3PH 4000 WH
42200582	TRACK BASIC 3PH 1000 BK
42200583	TRACK BASIC 3PH 2000 BK
42200584	TRACK BASIC 3PH 3000 BK
42200585	TRACK BASIC 3PH 4000 BK
42200586	TRACK BASIC 3PH 1000 AN
42200587	TRACK BASIC 3PH 2000 AN
42200588	TRACK BASIC 3PH 3000 AN
42200589	TRACK BASIC 3PH 4000 AN

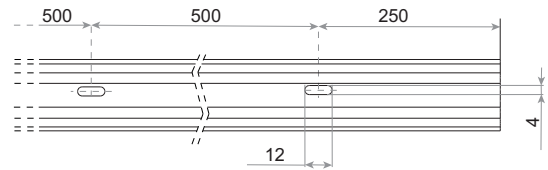
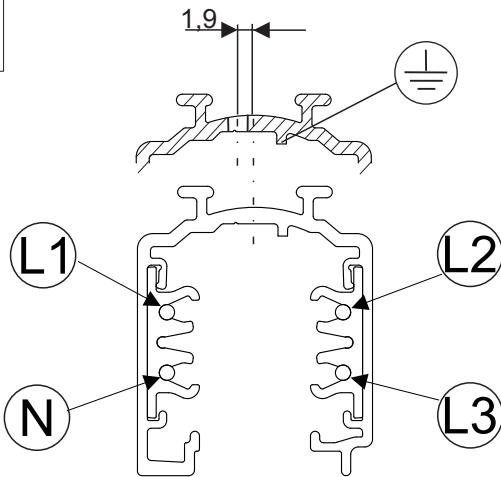
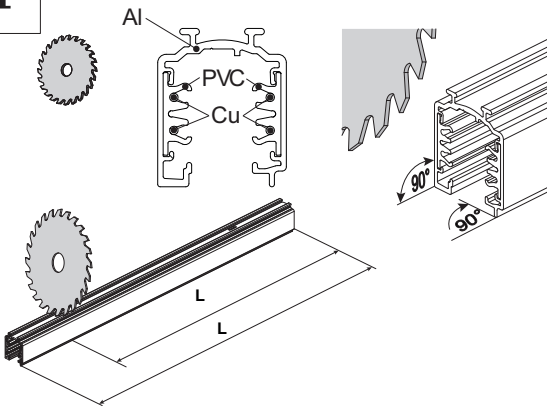
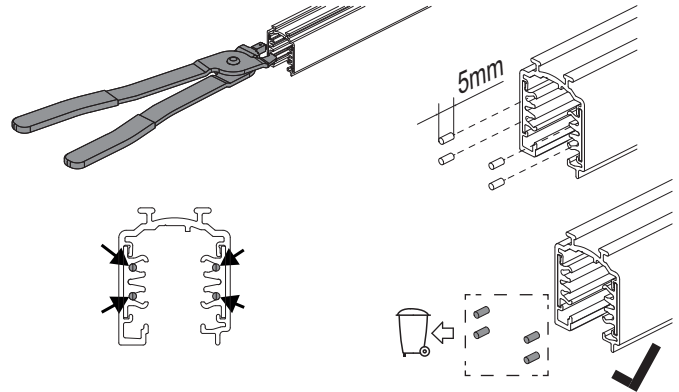
i**i****42200647 TRACK BASIC/ADV CUTTER**

DE Bauseitiges Kürzen der Schiene: N- und L-Leiter müssen zurückgeschnitten werden.

EN Cut to size of the trac on size: N- and L-conductors must be cut back.

NL Ter plaatse in te korten rails: N- en L-leider moeten teruggeknipt worden.

FR Raccourcissement des rails sur chantier: Les conducteurs actifs et neutre doivent être recoupés.

SV Vid kapning av skena: N- och L-ledare måste kapas kortare än skenlängd.

FI Kosketinkiskojen katkaisu asennuspaikalla: N- ja L-johtimet on katkaistava erikoistyökallula.

IT Accorciamento del binario sul posto: I conduttori N e L devono essere tagliati alla distanza di sicurezza.

ES Corte a la medida de los carriles en obra: deben recortarse los conductos N y L.



DE Belastung bei angegebener Befestigungsart.

SV Belastning ved angitt fikseringsmåte.

EN Carrying load with indicated type of fixing.

FI Kantavuus kiinnitystavastra rippuen.

FR Charges maximales en fonction du mode de fixation.

ES Carga máxima con el tipo de fijación indicado.

IT Carico per il tipo di fassagio indicato.

NL Belasting bij aangegeven montagewijze

i

deflection x [mm]	6		4		2	
distance L [mm]	load F [N]	suspension type	load F [N]	suspension type	load F [N]	suspension type
3000	50	SUSP SET/ TUBE/ROD KIT	30	SUSP SET/ TUBE/ROD KIT	10	SUSP SET/ TUBE/ROD KIT
2500	78		50		21	
2000	129		84		39	
1500	235		155		76	
1000	-		-		-	

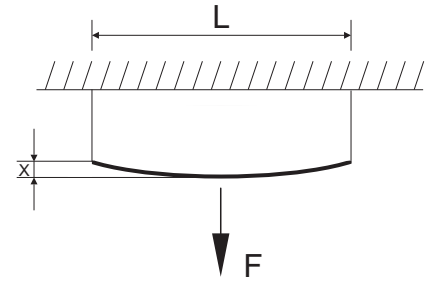
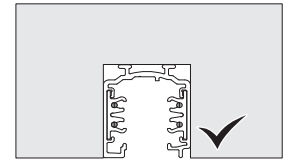
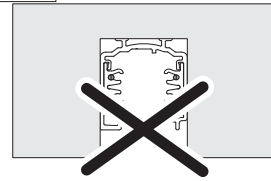
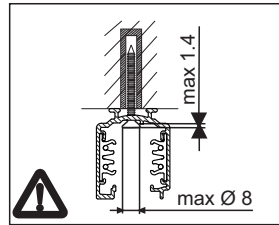
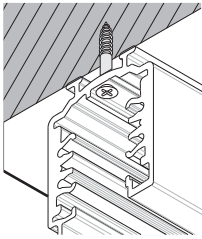
**i****1**

42200638 TRACK BASIC/ADV MOUNT ACC

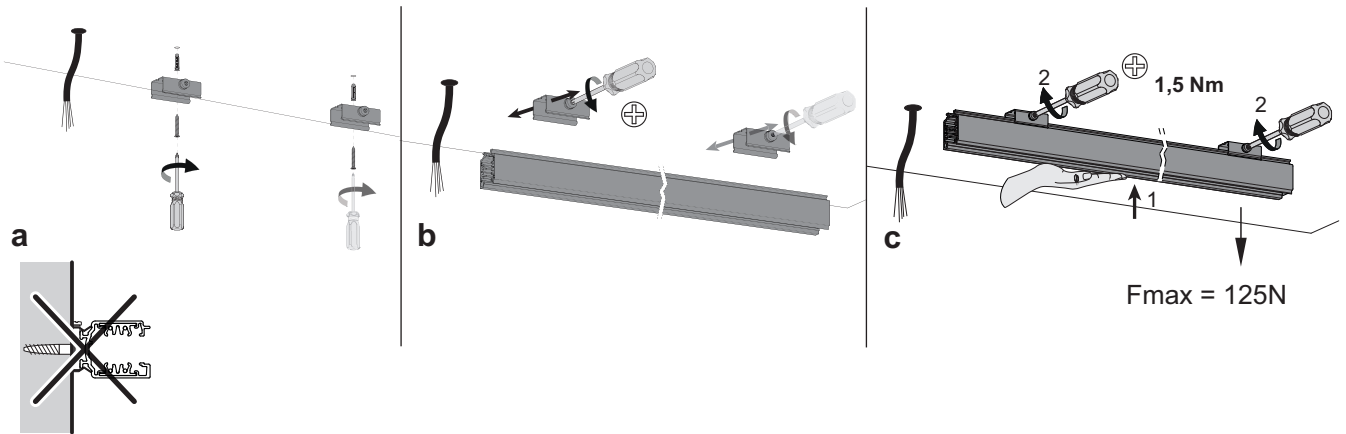
**i**

42200641 TRACK BASIC/ADV PEND TUBE KIT 1200 BK

42200642 TRACK BASIC/ADV PEND TUBE KIT 1200 WH

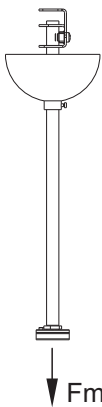
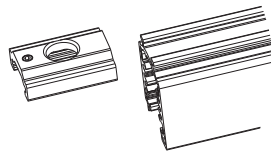
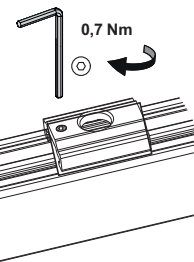
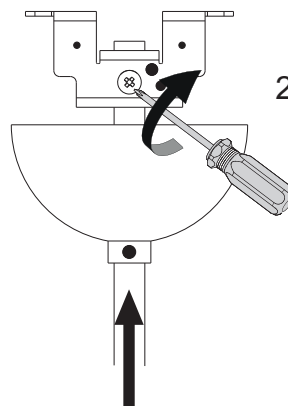
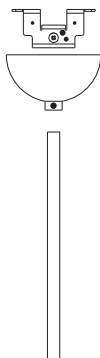
**a****b****1**

i	42200643	TRACK BASIC/ADV THREADED ROD KIT 1000 BK
	42200644	TRACK BASIC/ADV THREADED ROD KIT 1000 WH

$F_{max} = 125N$

a

b 0,7 Nm

i	22173126	TRACK BASIC/ADV SUSP SET 2000
	22173127	TRACK BASIC/ADV SUSP SET 5000

1		2	a	b
----------	--	----------	----------	----------

3	a	b	c
----------	----------	----------	----------

$F_{max} = 125N$

i	60280107	TRACK BASIC/ADV SUSP DOME BK	
	60280108	TRACK BASIC/ADV SUSP DOME WH	

Seil sep. bestellbar / rope can be ordered separately

max. 30°

1		2	
----------	--	----------	--

a

b 60280109
60280110

c

i

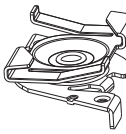

42200639	TRACK BASIC/ADV QUICK FIX BK
42200640	TRACK BASIC/ADV QUICK FIX WH

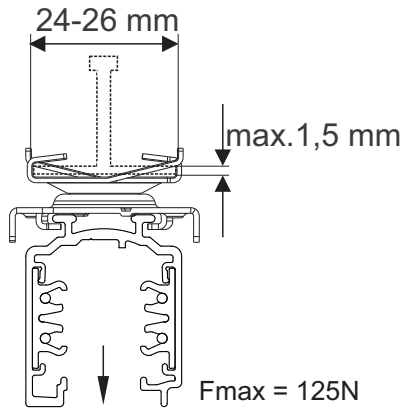

i

42200646	TRACK BASIC/ADV HOOK WH
----------	-------------------------

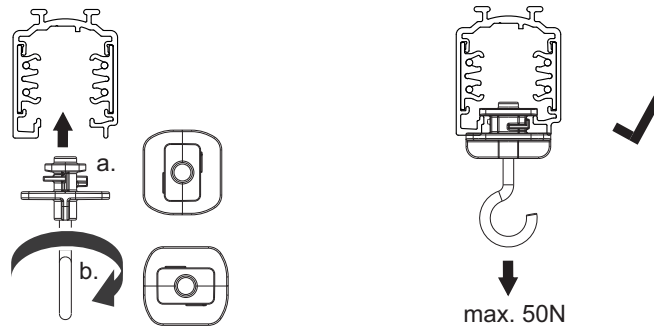
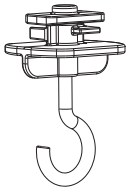

i

CODING

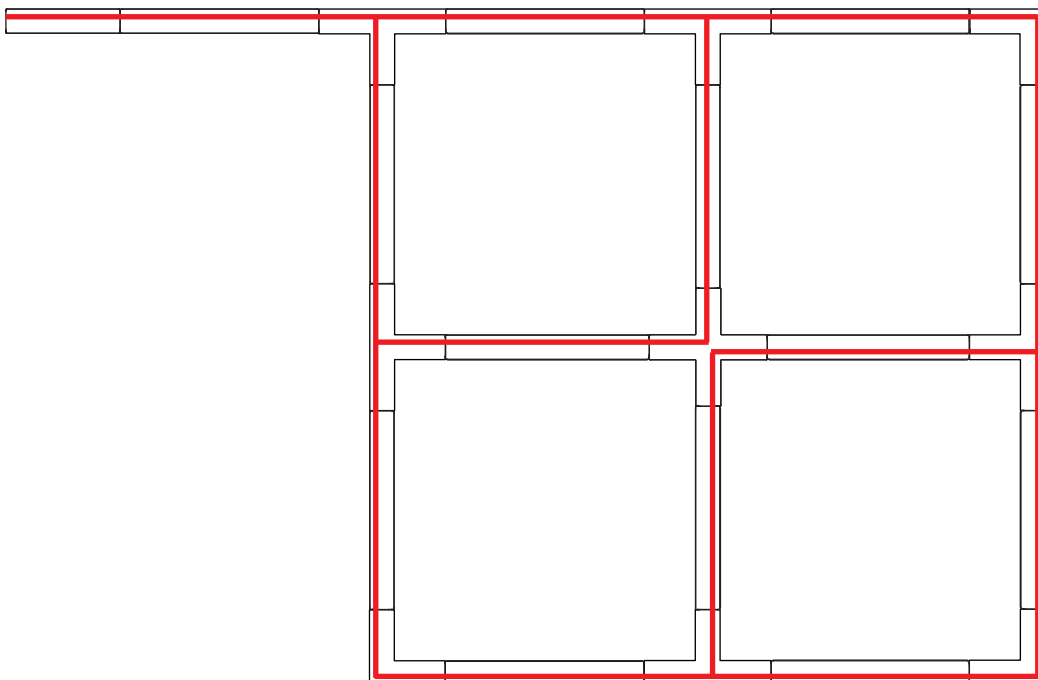
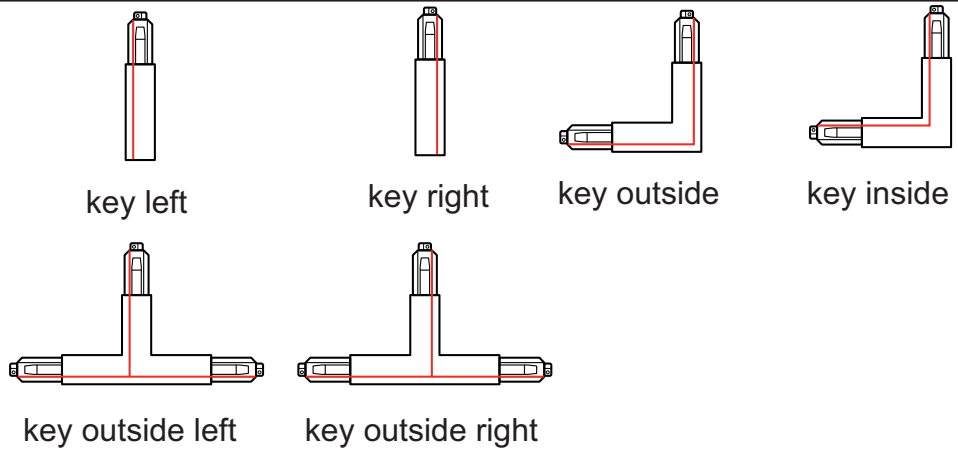
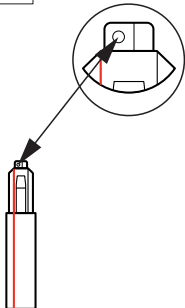

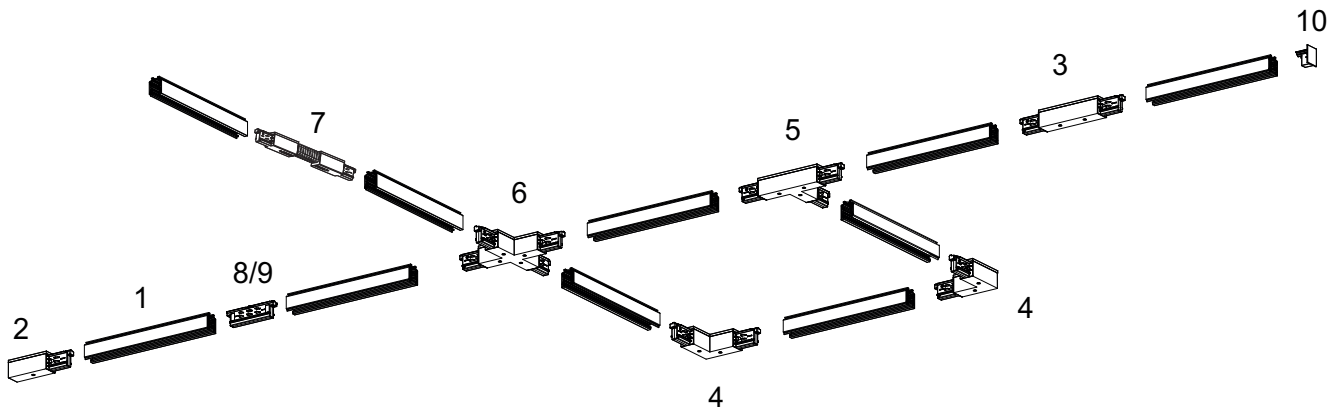

	CODE	DESCRIPTION	
1	42200578	TRACK BASIC 3PH 1000 WH	
	42200579	TRACK BASIC 3PH 2000 WH	
	42200580	TRACK BASIC 3PH 3000 WH	
	42200581	TRACK BASIC 3PH 4000 WH	
	42200582	TRACK BASIC 3PH 1000 BK	
	42200583	TRACK BASIC 3PH 2000 BK	
	42200584	TRACK BASIC 3PH 3000 BK	
	42200585	TRACK BASIC 3PH 4000 BK	
	42200586	TRACK BASIC 3PH 1000 AN	
	42200587	TRACK BASIC 3PH 2000 AN	
	42200588	TRACK BASIC 3PH 3000 AN	
	42200589	TRACK BASIC 3PH 4000 AN	
	2	42200590	TRACK BASIC 3PH END FEED R BK
		42200591	TRACK BASIC 3PH END FEED R WH
42200592		TRACK BASIC 3PH END FEED L BK	
42200593		TRACK BASIC 3PH END FEED L WH	
3	42200594	TRACK BASIC 3PH MID FEED BK	
	42200595	TRACK BASIC 3PH MID FEED WH	
4	42200596	TRACK BASIC 3PH L-CON I BK	
	42200597	TRACK BASIC 3PH L-CON I WH	
	42200598	TRACK BASIC 3PH L-CON O BK	
	42200599	TRACK BASIC 3PH L-CON O WH	
5	42200600	TRACK BASIC 3PH T-CON O L BK	
	42200601	TRACK BASIC 3PH T-CON O L WH	
	42200602	TRACK BASIC 3PH T-CON O R BK	
	42200603	TRACK BASIC 3PH T-CON O R WH	
6	42200604	TRACK BASIC 3PH X-CON BK	
	42200605	TRACK BASIC 3PH X-CON WH	
7	42200606	TRACK BASIC 3PH FLEX-CON BK	
	42200607	TRACK BASIC 3PH FLEX-CON WH	
8	42200608	TRACK BASIC 3PH ELEC CON BK	
	42200609	TRACK BASIC 3PH ELEC CON WH	
9	42200634	TRACK BASIC/ADV MECH CON BK	
	42200635	TRACK BASIC/ADV MECH CON WH	
10	42200636	TRACK BASIC/ADV END CAP BK	
	42200637	TRACK BASIC/ADV END CAP WH	

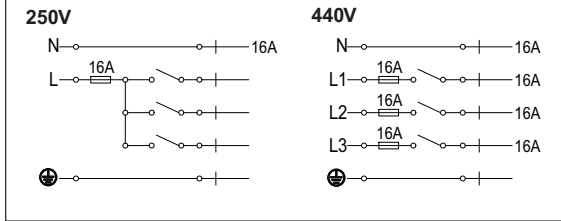

ONLY for CROSSIGN, ZUMTOBEL, L3 permanently

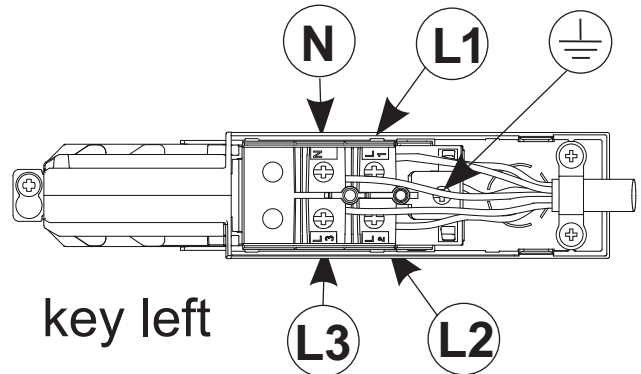
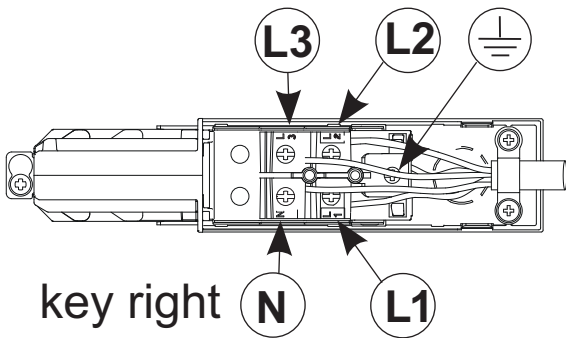
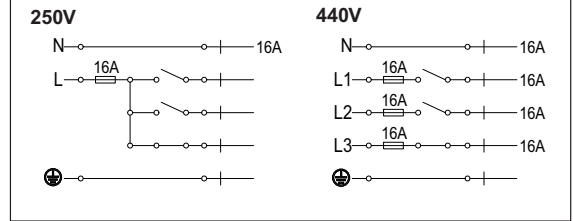

1

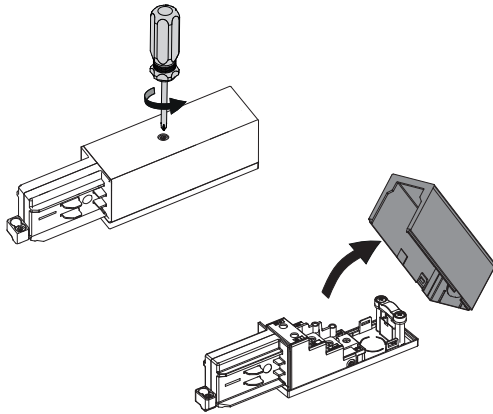

2

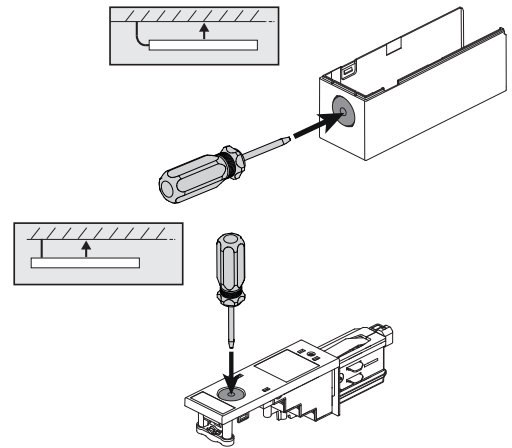

3

5 x 1,5-2,5 mm²

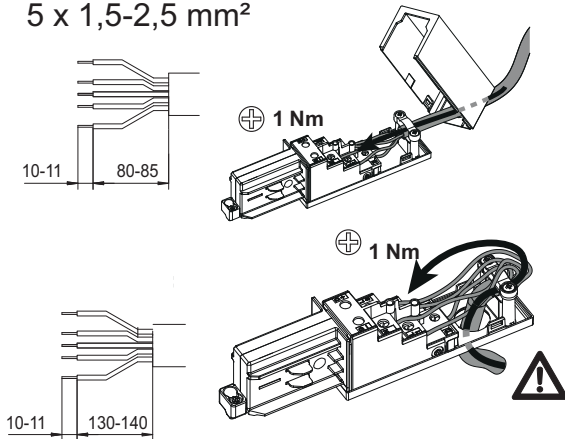

4

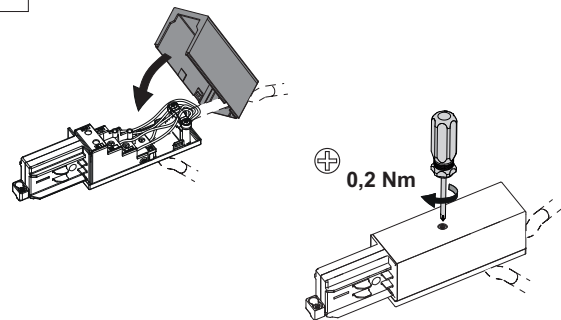

5

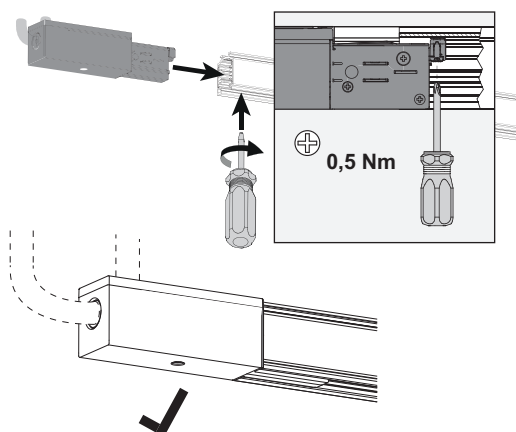

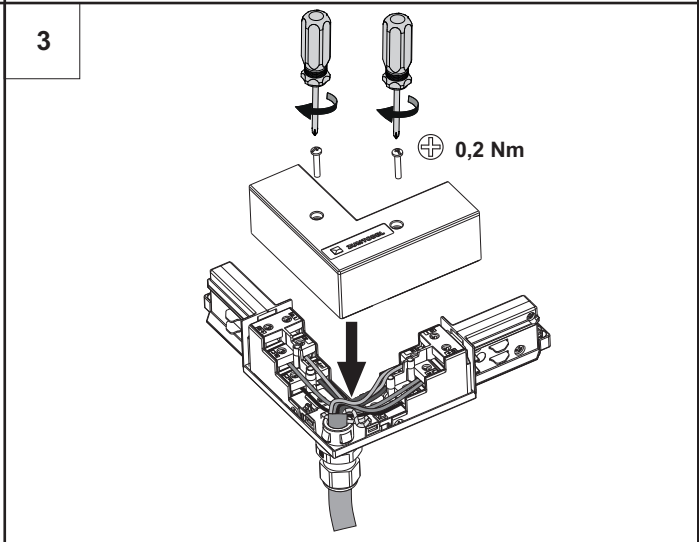
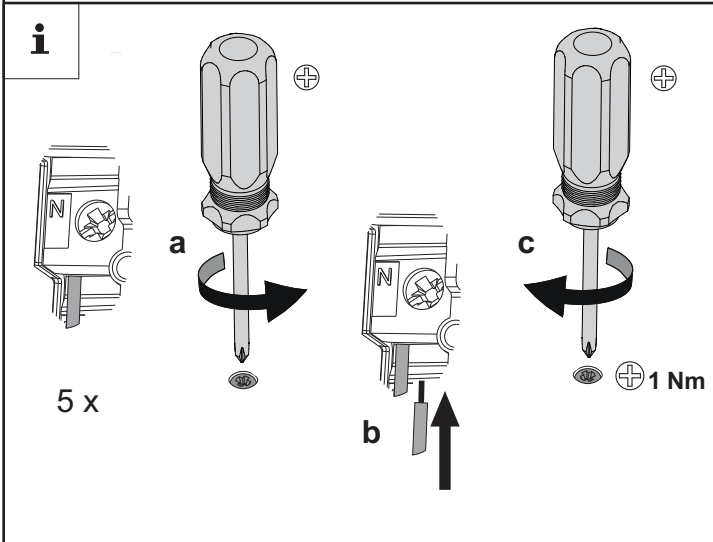
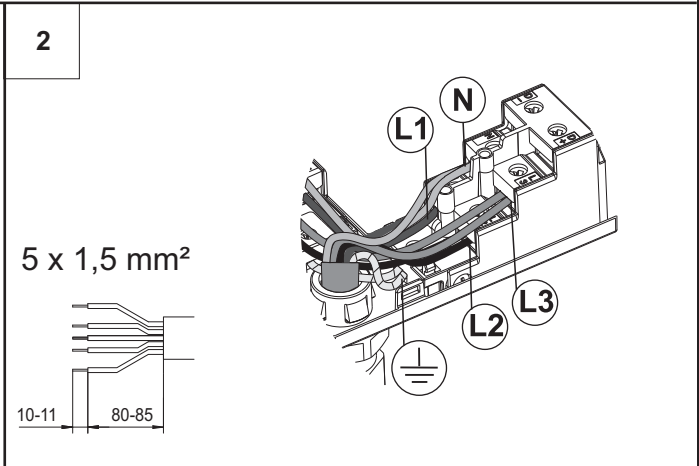
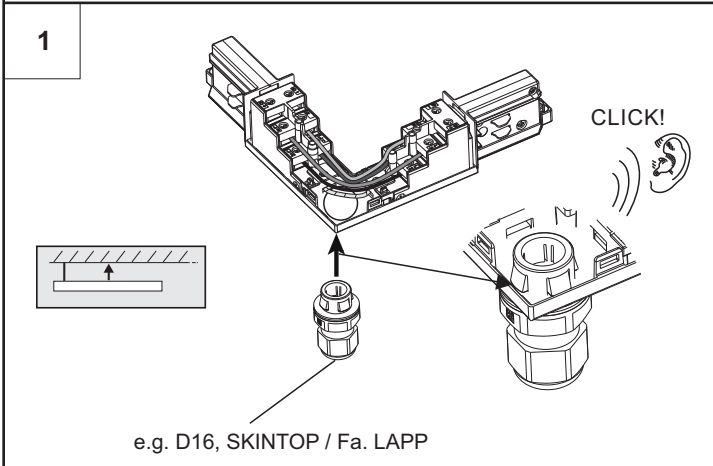
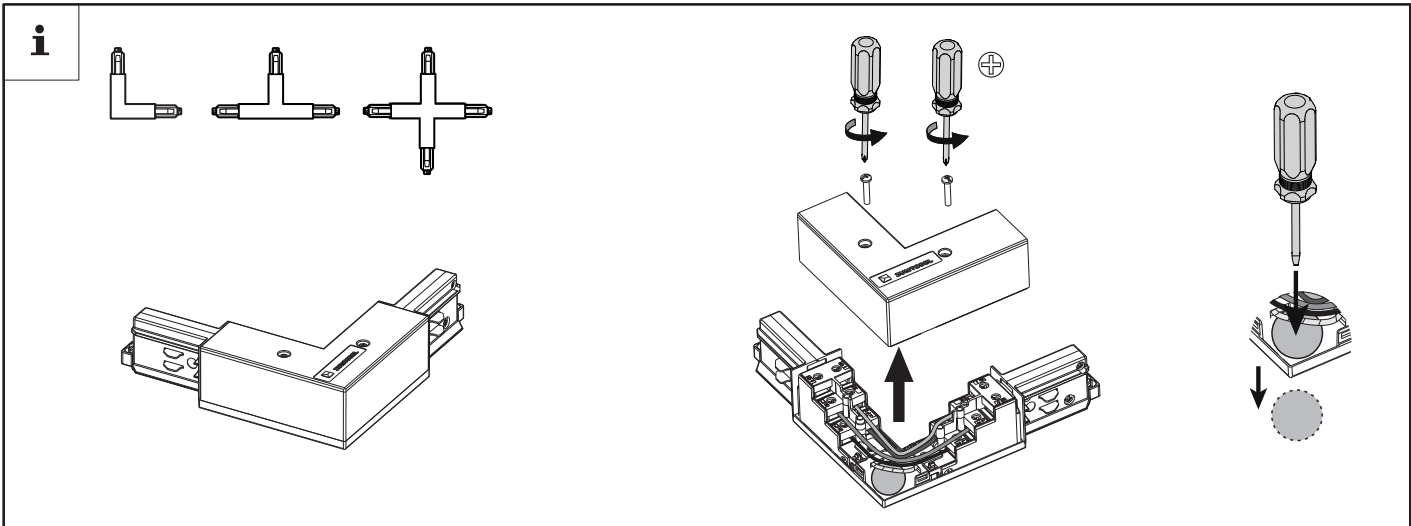

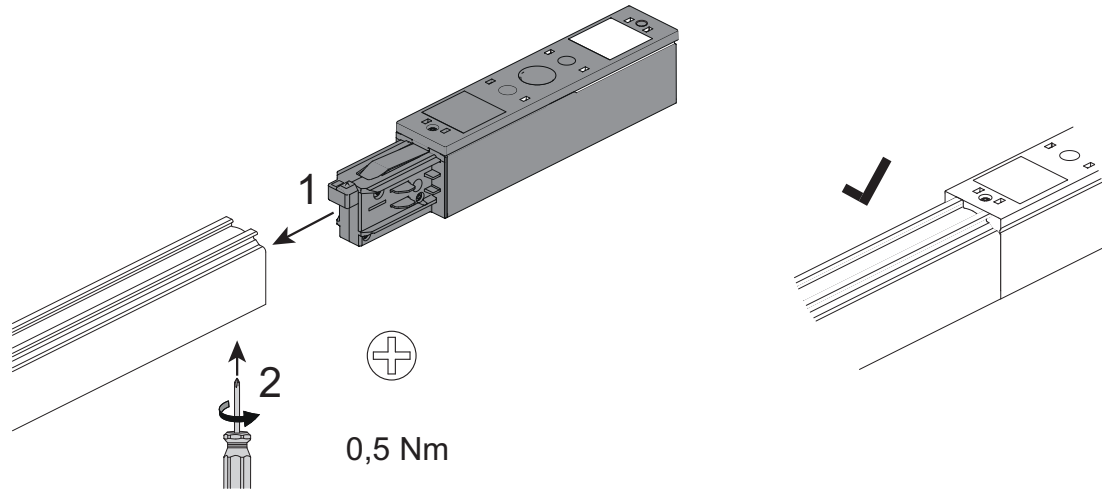
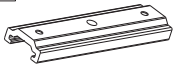
i**i**

42200650	TRACK BASIC/ADV MECH BRACKET BK
42200651	TRACK BASIC/ADV MECH BRACKET WH

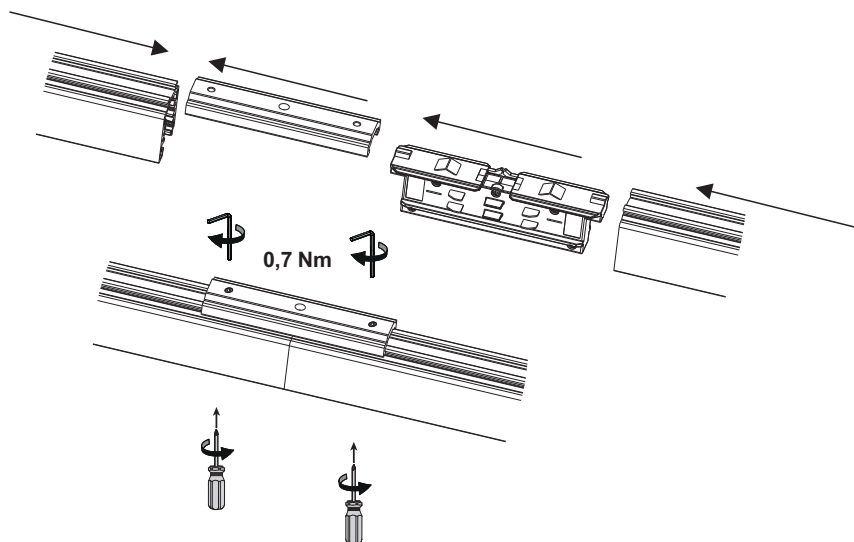
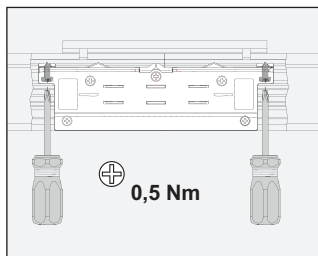
1

Technische Änderungen vorbehalten. - Specifications subject to change without notice. - Modifications techniques sans préavis.
 Modificazione tecnica senza preavviso. - Technische wijzigingen voorbehouden.
 Med forbehold om tekniske endringer. - Oikeudet teknisiin muutoksiin pidätetään. - Modificaciones técnicas sin preaviso.