

40026574

Instructions de montage originales 21/03/23 PVA

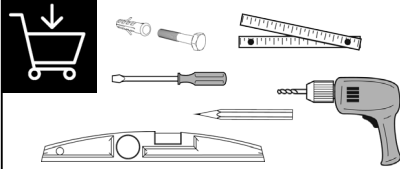

Purgeur à jet orientable: Serrez modérément le purgeur sur le radiateur pour faire étanchéité à l'aide du joint torique (15 Nm max).

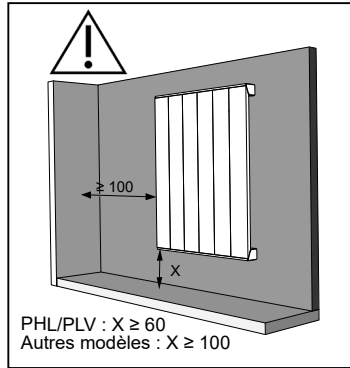
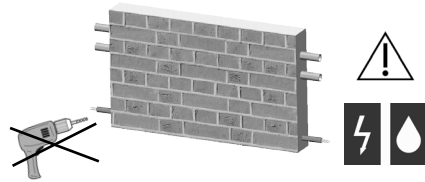

PHL/PLV : X ≥ 60
Autres modèles : X ≥ 100

PLV - PLVD (CVD1E)

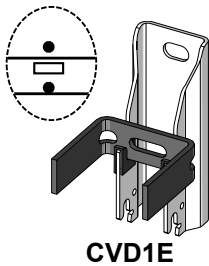
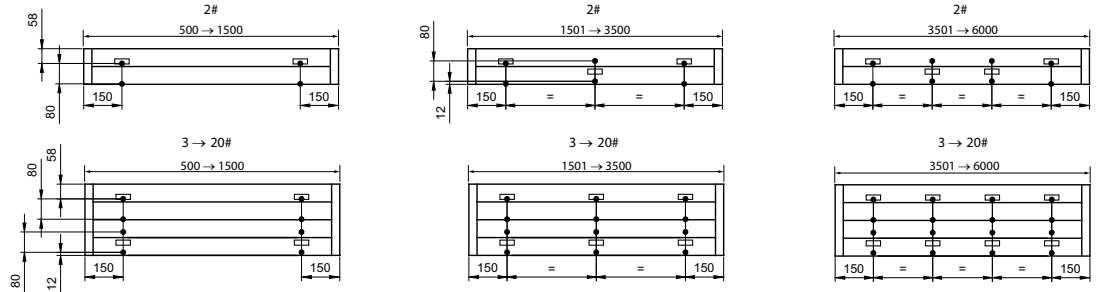

CVD1E

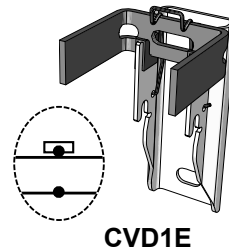
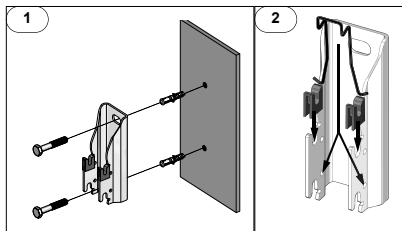

CVD1E

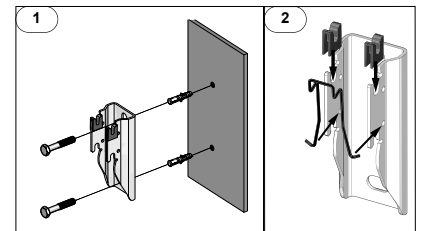

PLH - PLHD (CVD1E)

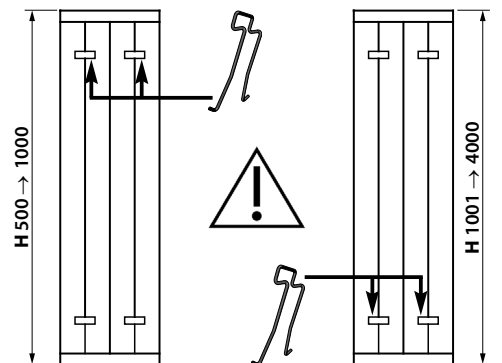
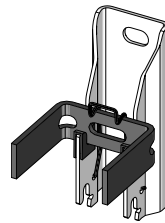
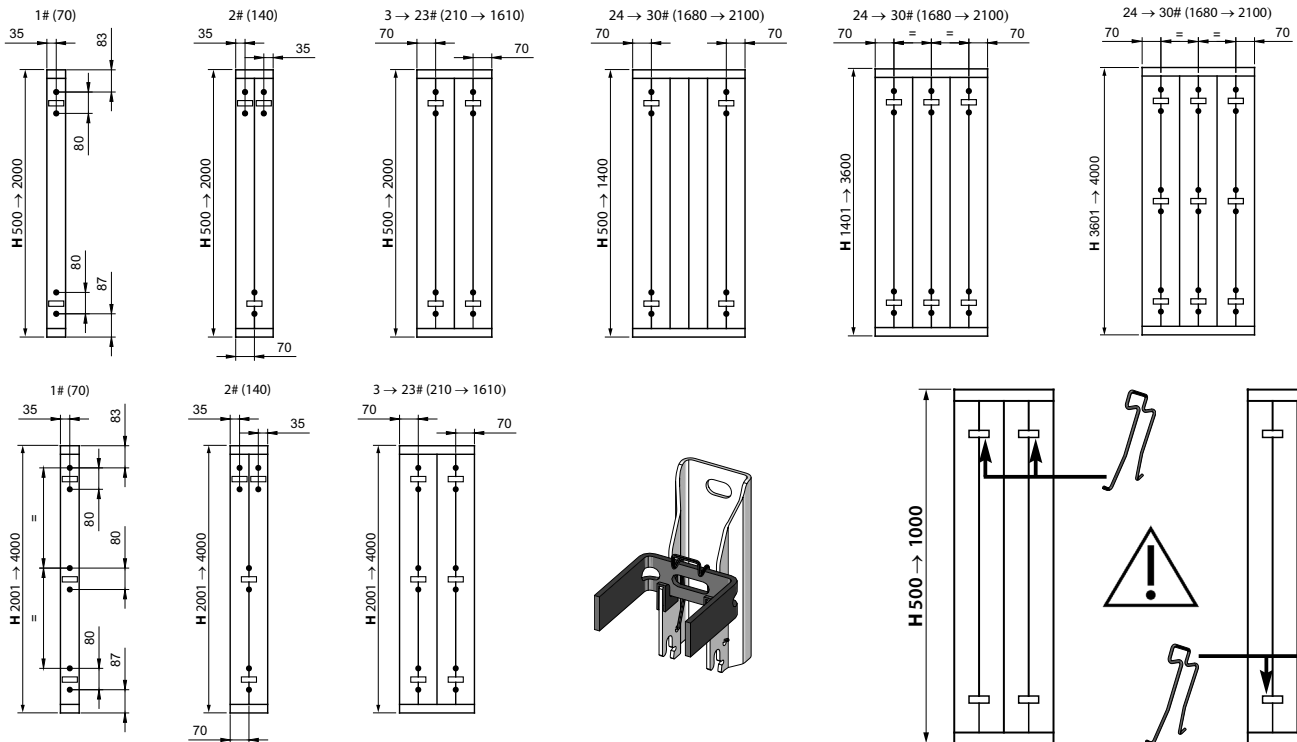

PLV - PLH : CVD2E
si raccordement avec
robinetterie intégrée
(code Vxxx)

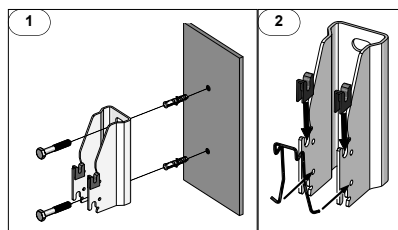

≠

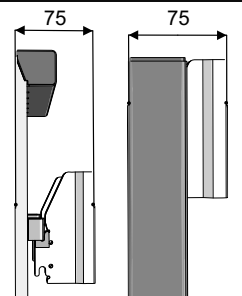
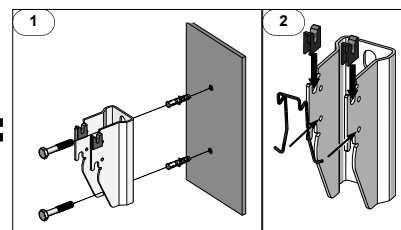

PLVL (CVD0E)

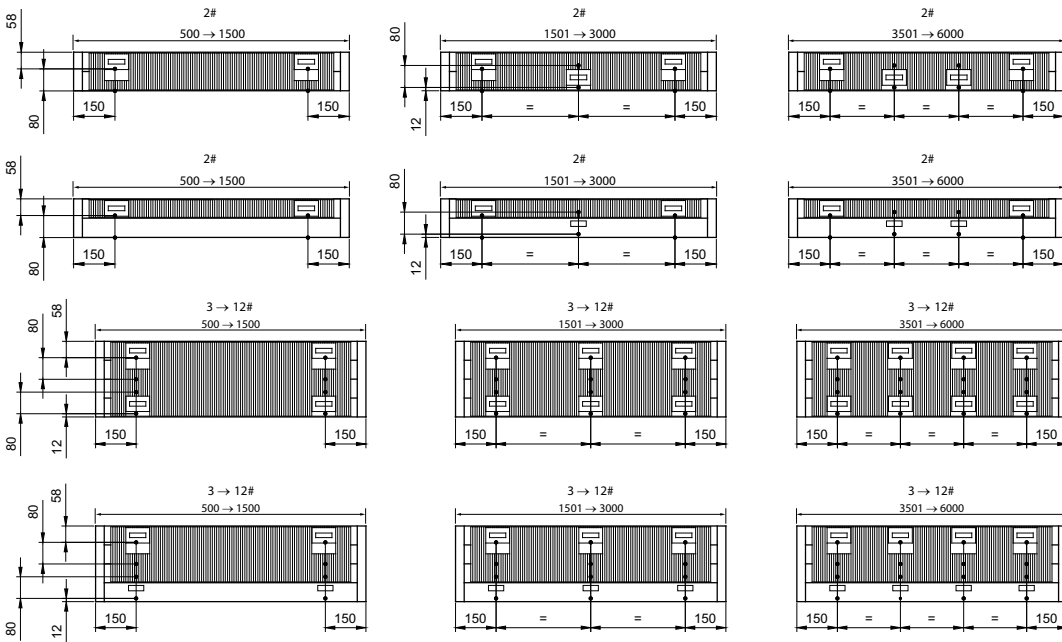

PLHL

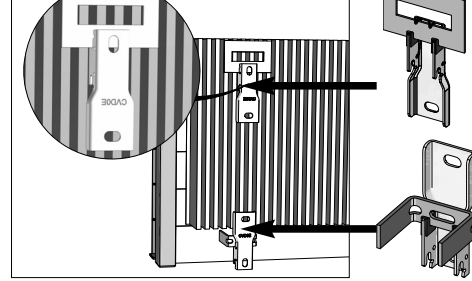
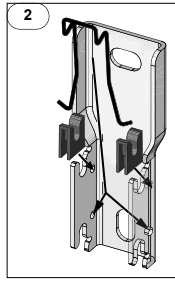
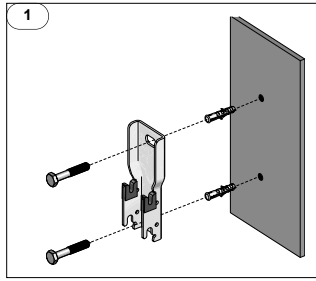
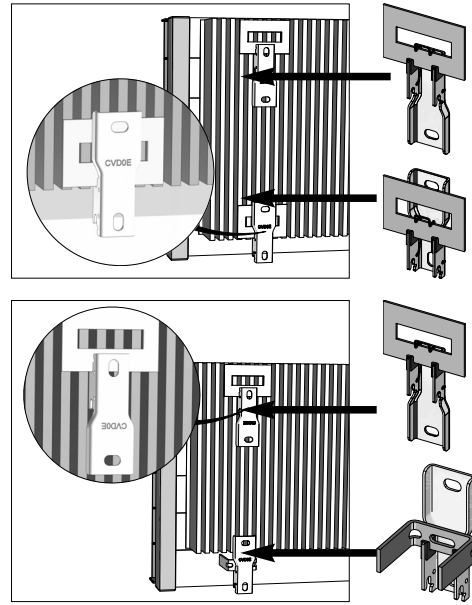
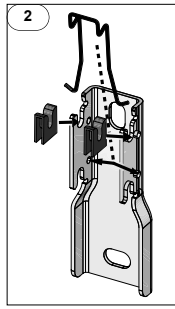
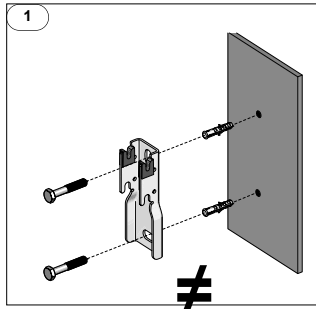
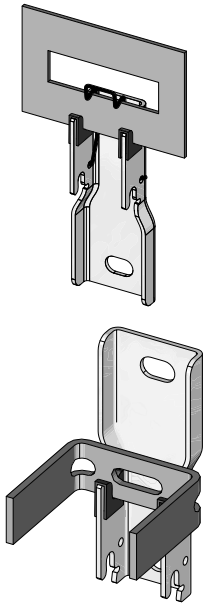
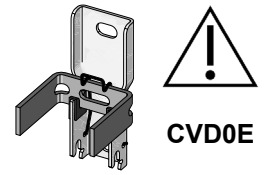
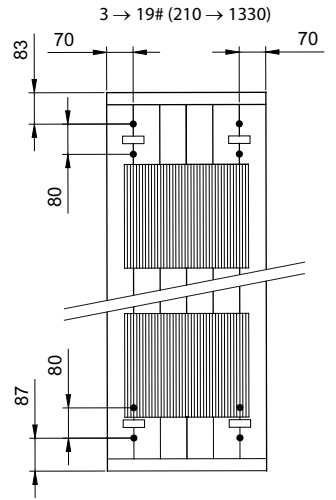

PLV
PLVL
PLVD
PLVLD
PLVLLD
1#

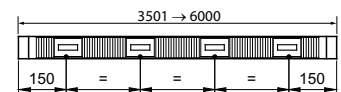
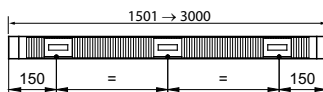
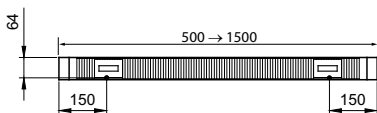
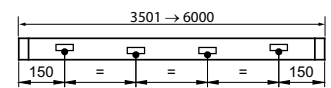
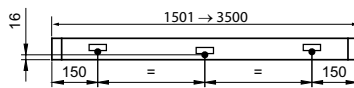
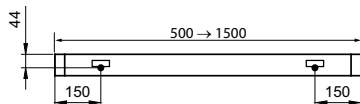
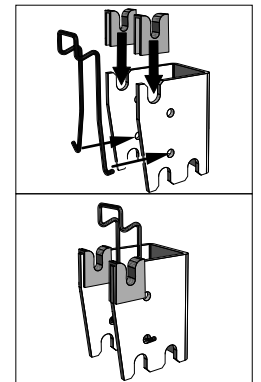
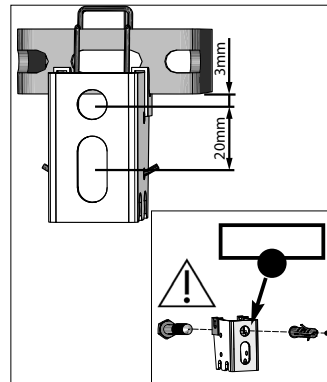
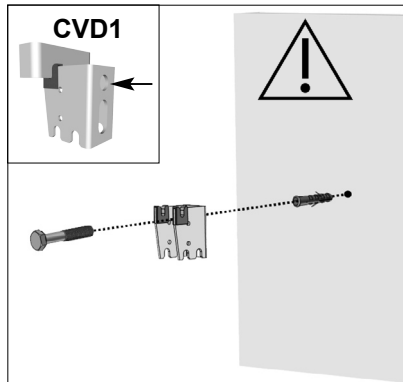

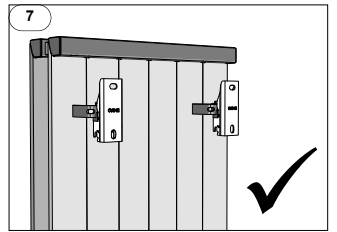
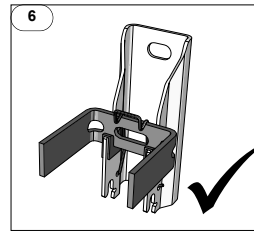
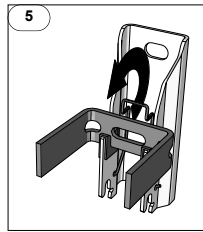
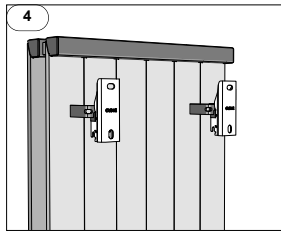
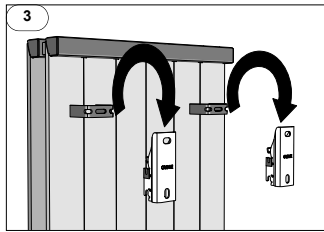

Les cotes précédemment indiquées correspondent à des appareils standards.
 Pour tout autre type de fabrication (notamment raccordement avec robinetterie intégrée), vous devrez mesurer la position exacte des fixations sur l'appareil pour déterminer vos points de perçage.

Toujours vérifier avant perçage la position des fixations sur l'appareil !

Appareils avec pieds

Instructions de montage originales 21/03/23 PVA

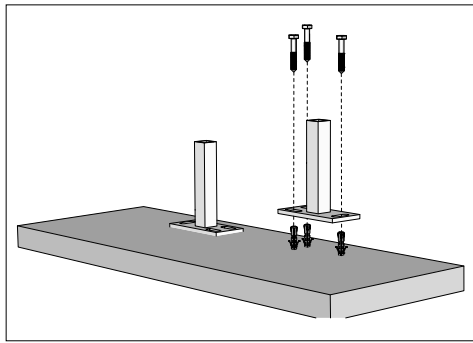
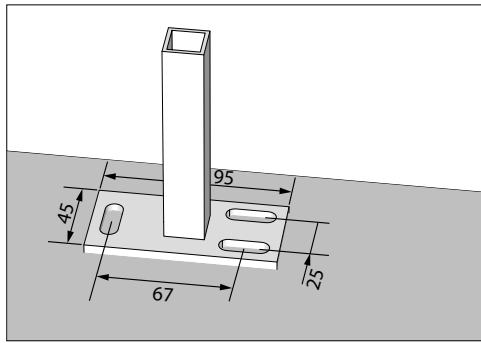
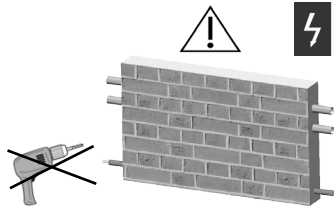
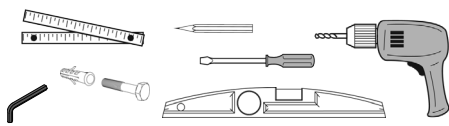

Option WFV115 à la commande :

[Fixation murale CVDE obligatoire si hauteur appareil > 630 mm]

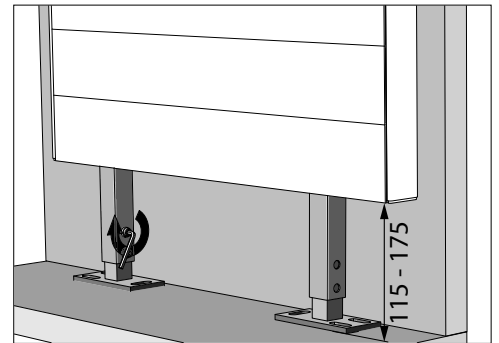
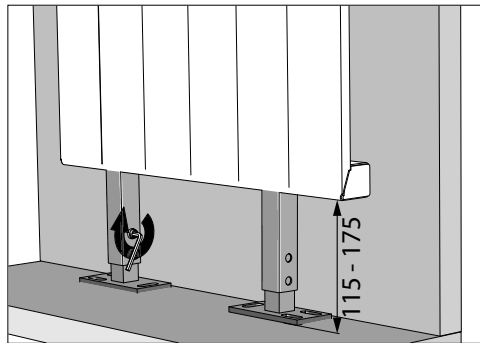

Option WFF115 à la commande :

[Fixation murale CVDE obligatoire si hauteur appareil > 630 mm]

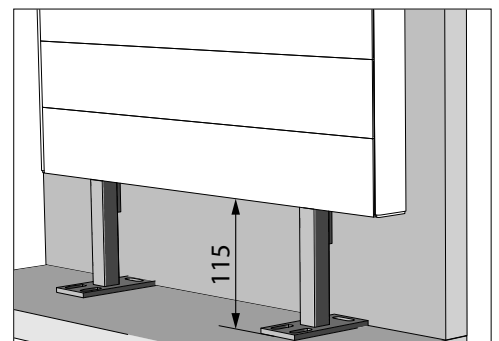
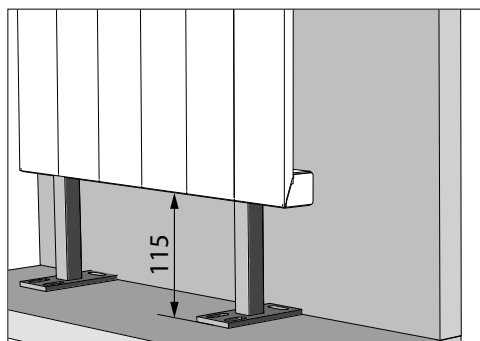

Accessoires



KPV

Fixation murale
CVD
obligatoire

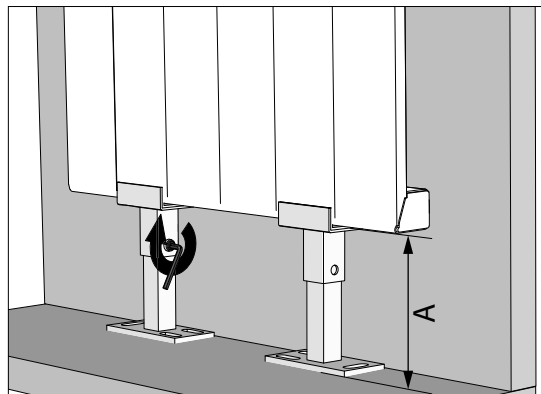
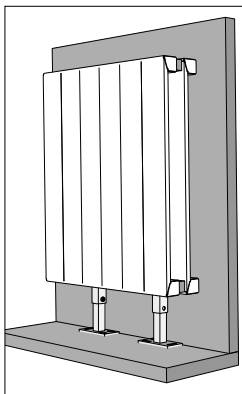
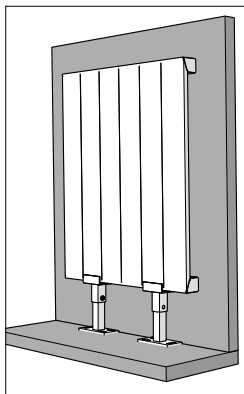

Réf. (PNI)	Couleur	A
109011	Blanc	90 mm
109019	Teinte	90 mm
109021	Blanc	100 mm
109029	Teinte	100 mm
109031	Blanc	115 mm
109039	Teinte	115 mm

Réf. (PNI)	Couleur	A
109041	Blanc	150 mm
109049	Teinte	150 mm
109051	Blanc	210 mm
109059	Teinte	210 mm

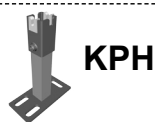

KPH

Fixation murale
CVD
obligatoire

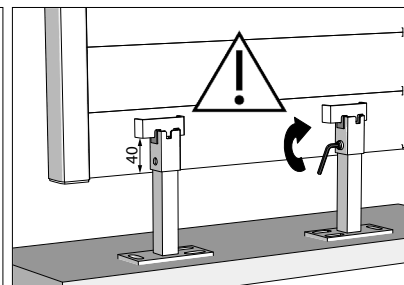
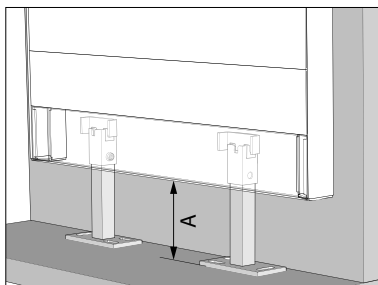
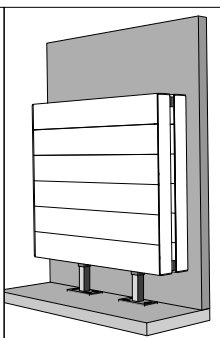
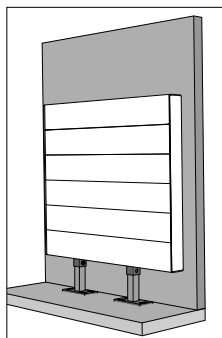

Réf. (PNI)	Couleur	A
108011	Blanc	50 mm
108019	Teinte	50 mm
108021	Blanc	70 mm
108029	Teinte	70 mm
108031	Blanc	85 mm
108039	Teinte	85 mm

Réf. (PNI)	Couleur	A
108041	Blanc	115 mm
108049	Teinte	115 mm
108051	Blanc	180 mm
108059	Teinte	180 mm

Accessoire

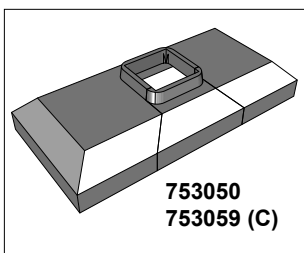

753050
753059 (C)

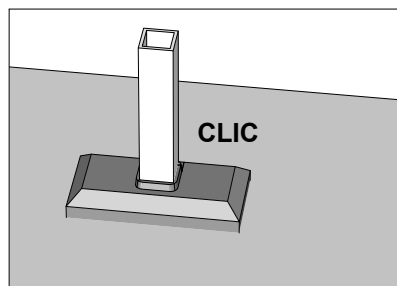
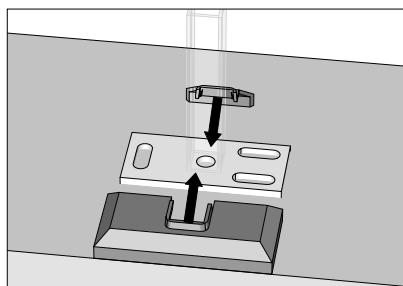
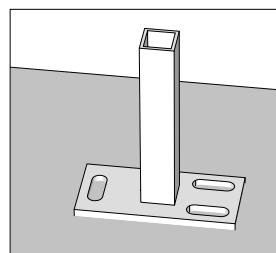
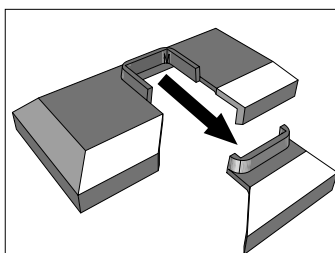

FR

Cet appareil
et ses accessoires
se recyclent



Points de collecte sur www.quefairedemesdechets.fr
Privilégiez la réparation ou le don de votre appareil !



FR

NOTICES

