

CSBU

Universal Structural Attachment

UL Approved when used with 1", 1-1/4", 1-1/2" or 2" (DN25, DN32, DN40, DN50) NPS Schedule 40 brace pipe.

*Part Number	*Article Number	Fastener Diameter		Brace		UL® Load Rating
		Inch	mm	Inch	mm	lbs. (N)
CSBU1	404500	1/2	13	1 - 2 Pipe	25 - 50 Pipe	2,045 (9,096)
CSBU2	404501	3/4	19	1 - 2 Pipe	25 - 50 Pipe	

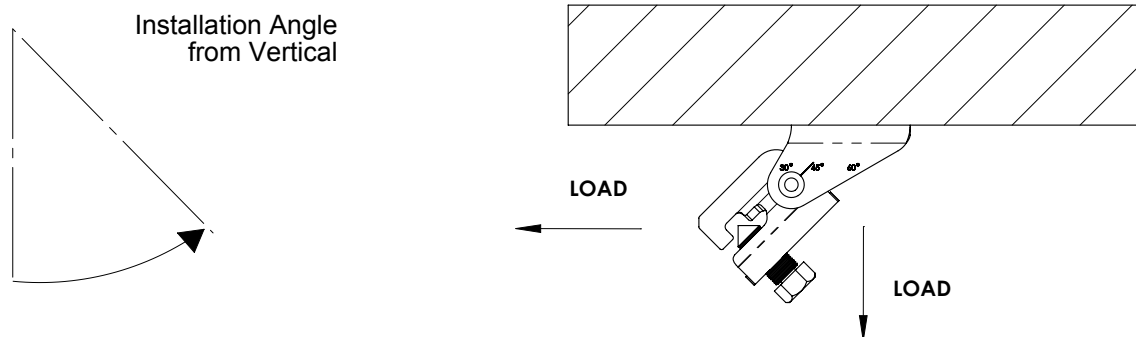

FM® Approved when used with 1", 1-1/4", 1-1/2" or 2" (DN25, DN32, DN40, DN50) NPS Schedule 40, GB/T 3091, EN 10255 (Heavy), or JIS G3454 brace pipe.

*Part Number	*Article Number	Brace Member	Fastener Diameter		FM® Horizontal Load Ratings lbs (N)			
					Installation Angle			
			Inch	mm	30° - 44°	45° - 59°	60° - 74°	75° - 90°
CSBU1	404500	SCHEDULE 40 STEEL PIPE	1/2	13	1,690 (7,517)	2,210 (9,831)	2,660 (11,832)	3,090 (13,745)
		1" EMT CONDUIT**			530 (2,357)	911 (4,052)	1,108 (4,928)	1,223 (5,440)
		1" RIGID CONDUIT			1,690 (7,517)	2,210 (9,831)	2,660 (11,832)	3,090 (13,745)
CSBU2	404501	SCHEDULE 40 STEEL PIPE	3/4	19	1,480 (6,583)	2,290 (10,186)	2,860 (12,722)	3,090 (13,745)
		1" EMT CONDUIT**			530 (2,357)	911 (4,052)	1,108 (4,928)	1,223 (5,440)
		1" RIGID CONDUIT			1,480 (6,583)	2,290 (10,186)	2,860 (12,722)	3,090 (13,745)

Sway Brace assemblies are intended to be installed in accordance with NFPA-13 and the manufacturer's installation instructions. The required type, number, and size of fasteners used for the structure attachment fitting shall be in accordance with NFPA-13.

*Part numbers and article numbers are for EG only. Other coatings available.

Contact customer service for availability.

**Listed capacities do not account for compression/tension limits due to EMT conduit length.

Weaker components within overall design shall control the application.

EMT conduit must adhere to ANSI C-80.3 with a minimum yield strength of 30ksi.

Do not install set screw into the conduit weld seam.

WARNING:

1. nVent products shall be installed and used only as indicated in nVent product instruction sheets and training materials. Instruction sheets are available at www.nVent.com and from your nVent customer service representative.
2. nVent products must never be used for a purpose other than the purpose for which they were designed or in a manner that exceeds specified load ratings.
3. All instructions must be completely followed to ensure proper and safe installation and performance.
4. Improper installation, misuse, misapplication or other failure to completely follow nVent's instructions and warnings may cause product malfunction, property damage, serious bodily injury and/or death, and void your warranty.
5. Products that are manufactured using spring steel components shall be used only in a non-corrosive indoor environment.
6. All pipe supports, hangers, intermediate components and structural attachments must ONLY be used as described herein and are NEVER to be used for any other purpose.

NOTE: All load ratings are for static conditions and do not account for dynamic loading such as wind, water or seismic loads, unless otherwise noted.

The customer is responsible for:

- a. Conformance to all governing codes.
- b. The integrity of structures to which the products are attached, including their capability of safely accepting the loads imposed, as evaluated by a qualified engineer.
- c. Using appropriate industry standard hardware as noted above.

SAFETY INSTRUCTIONS:

All governing codes and regulations and those required by the job site must be observed. Always use appropriate safety equipment such as eye protection, hard hat, and gloves as appropriate to the application.

nVent, nVent CADDY, nVent ERICO Cadweld, nVent ERICO Critec, nVent ERICO, nVent ERIFLEX, and nVent LENTON are owned by nVent or its global affiliates. All other trademarks are the property of their respective owners. nVent reserves the right to change specifications without prior notice.

TECHNICAL SUPPORT:
www.nVent.com

CFS543_F

1 OF 2

© 2016-2020 nVent All Rights Reserved



Installation Steps

#1

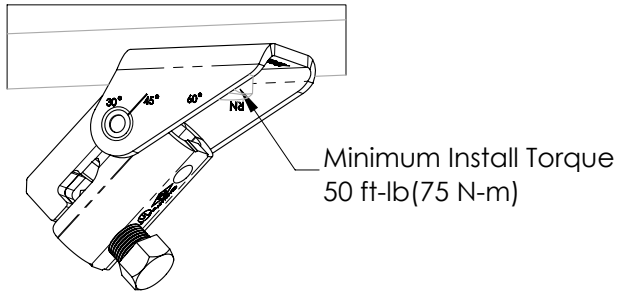

#2

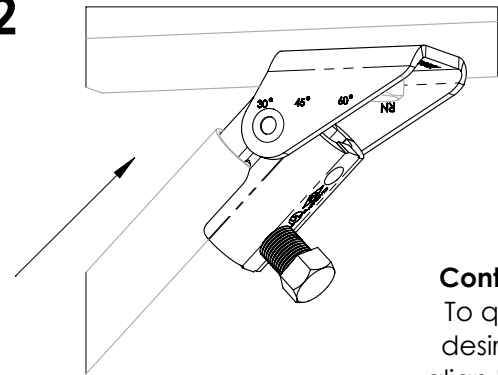

Contractor Tip:
To quickly get
desired angle,
align brace pipe
with angle gauge.

#3

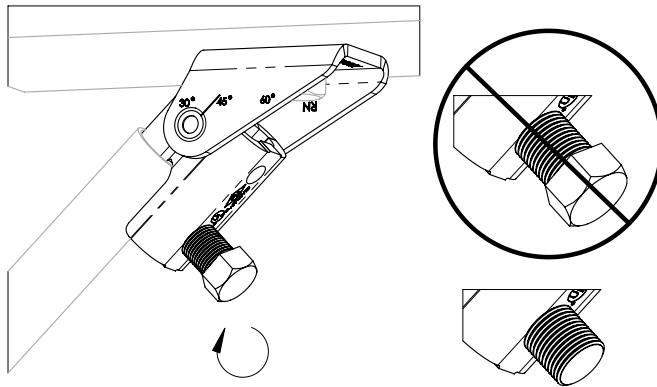

Vertical Mount
45°

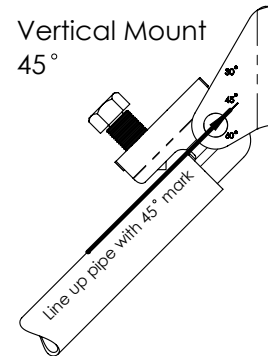

Horizontal Mount
30°

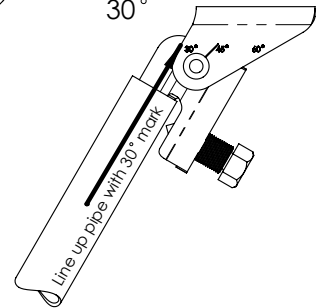

#4

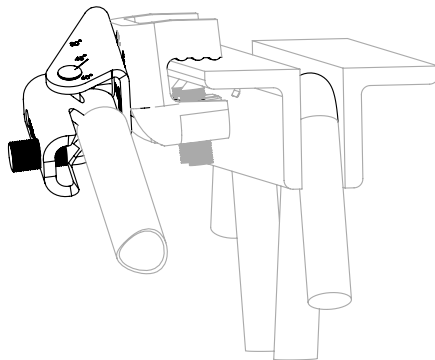

CSBU WITH CSBS1/CSBS2

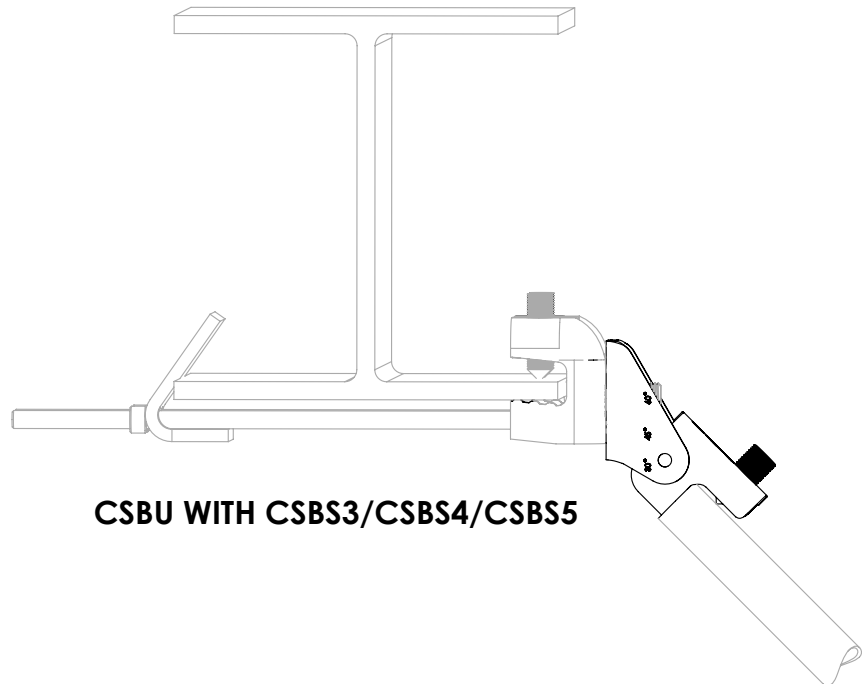

CSBU WITH CSBS3/CSBS4/CSBS5

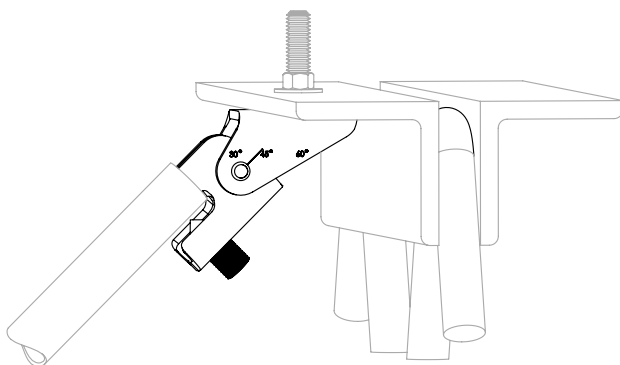

**CSBU WITH DIRECT
BOLTING TO STRUCTURE**