

# LECV

## Lightning Event Counter

### 1. Battery Installation / Replacement

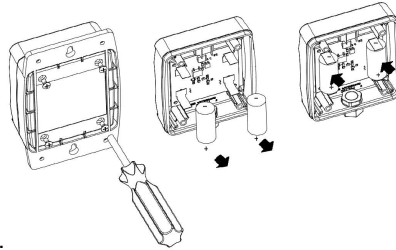

### 2. Time Setting

- Press any button to display screen.
- Press OK twice to initiate the time / date setting process. The number being adjusted will blink starting with the left position. Time setting will be first (Hour-Minute-Second).
- Press set button.



- The up/down arrows will adjust settings. Pressing OK will advance the blinking number.
- Once time has been set, continue to press OK to advance to date setting (Day-Month-Year).
- CLr will clear the events in memory. By default, this option is set to "No". To clear memory, change the Y to N with the arrows.

### 3. Reading LECV

- Press any button to see the number of lightning strikes registered.
- Press up/down arrows to see the date & time of the registered lightning strike.



### 4. General Instructions

- Average battery life is 5 years.
- Inspect annually.
- Unit must be oriented with the vent down to insure proper moisture protection.
- A label is available on the back side of the unit to record installation date.

### 5. Mounting Adapters

- Mounting options for use with different LPS Series down conductor systems:



ERICORE  
Conductor

Tape  
Conductor

Round or Stranded  
Conductor

### 6. Testing LECV

- LECV can be tested using LEC-Tester.
- Press LECV OK button & LEC-Tester Test button simultaneously to register a count.

#### WARNING:

- nVent products shall be installed and used only as indicated in nVent product instruction sheets and training materials. Instruction sheets are available at [www.nVent.com](http://www.nVent.com) and from your nVent customer service representative.
- nVent products must never be used for a purpose other than the purpose for which they were designed or in a manner that exceeds specified load ratings.
- All instructions must be completely followed to ensure proper and safe installation and performance.
- Improper installation, misuse, misapplication or other failure to completely follow nVent's instructions and warnings may cause product malfunction, property damage, serious bodily injury and/or death, and void your warranty.

#### SAFETY INSTRUCTIONS:

All governing codes and regulations and those required by the job site must be observed. Always use appropriate safety equipment such as eye protection, hard hat, and gloves as appropriate to the application.

nVent, CADDY, ERICO CADWELD, ERICO CRITEC, ERICO, ERIFLEX, and LENTON are owned by nVent or its global affiliates. All other trademarks are the property of their respective owners. nVent reserves the right to change specifications without prior notice.