

PRODUCT PRESENTATION

- **Monitored**
- **Mortice**
- **High corrosion resistance**
- **Delivered with armature plate**
- **No mechanical wear**
- **Ease of installation**
- **Recommended for exterior use**
- **Fail safe** (Door unlocked when power off)
- **Holding force** : 300kg
- **Built-in varistor** : Built-in electronic protection to eliminate back EMF



- **Dimensions (L x W x D)**: 228 x 38 x 27mm
- **Armature plate dimensions (L x W x D)**: 185 x 38 x 11mm
- **Power supply**: 12/24V dc
- **Consumption**: 480 mA with 12V dc
240 mA with 24V dc

WEEE & RoHS

CE Certification

IP42



Do not connect the magnetic lock without the PCB.

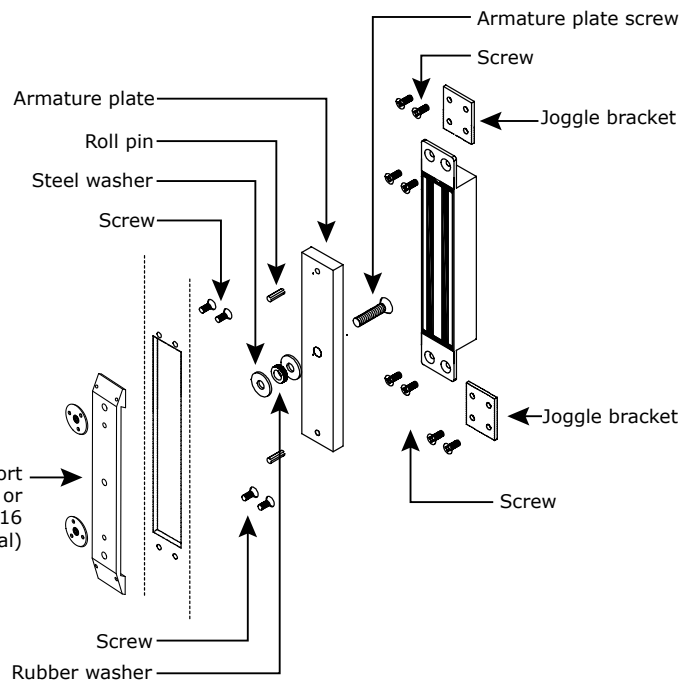

PACKAGE CONTENT

Magnetic lock	Armature plate	5x16 Roll pin	M5X8 Srew	Steel washer	Rubber washer
1	1	2	8	2	1
M8x35 Screw	M8x25 Screw	Cap nut	Joggle bracket	Manual	
1	1	1	2	1	

MOUNTING RECOMMENDATIONS

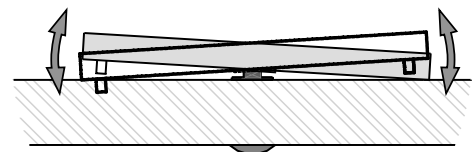

Armature plate

- It is vital that the magnetic lock and armature plate are securely fixed to their supports.
- The magnetic lock and the armature plate must be aligned.
- The armature plate must be mounted "floating" around the central mounting screw to compensate for any misalignment of the door

OPTIONAL ACCESSORIES

References	AMCCHANFR16 AMCHHANFR20
Description	Armature mounting plate

ELECTRICAL CONNECTIONS

12V dc default setup

Terminal block	Correspondence
+	12 or 24V dc
-	- 0 V
NC	Normally closed
C	COM
NO	Normally open

Voltage selection jumpers

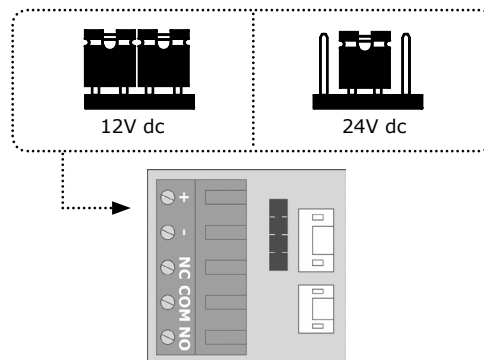

Recommended power supplies



The N.O./N.C. signal only switches when the door is closed with the electromagnetic lock powered

IMPORTANT NOTE

Check the jumper position before connecting the lock to the input current. A wrong position could damage the lock. This type of damage is not covered by the warranty.

CDVI FRANCE + EXPORT
31, av. du Général Leclerc
93500 PANTIN - France
Phone +33 (0)1 48 91 01 02
www.cdvi.com

CDVI UK
[UNITED KINGDOM - IRELAND]
Phone +44 (0)1628 531300
www.cdvi.co.uk

CDVI BENELUX
[BELGIUM - NETHERLAND - LUXEMBOURG]
Phone +32 (0) 56 73 93 00
www.cdvi.belux.com

CDVI IBÉRICA
[SPAIN - PORTUGAL]
Phone +34 (0)935 390 966
www.cdviberica.com

CDVI TAIWAN
Phone +886 (0)42471 2188
www.cdvichina.cn

CDVI MAROC
Phone +212 (0)5 22 48 09 40
www.cdvi.ma

CDVI SWEDEN
[SWEDEN - DENMARK - NORWAY FINLAND]
Phone +46 (0)31 760 19 30
www.cdvi.se

CDVI AMERICAS
[CANADA - USA]
Phone +1 (450) 682 7945
www.cdvi.ca

CDVI SUISSE
Phone +41 (0)21 882 18 41
www.cdvi.ch

CDVI ITALIA
Phone +39 0321 90 573
Fax: +39 0321 90 8018
www.cdvi.it

CDVI CHINA
Phone +86 (0)10 84606132/82
www.cdvichina.cn

CDVI POLSKA
Phone +48 12 659 23 44

PRÉSENTATION DU PRODUIT

- **Encastrée**
 - **Signal**
 - **Résistance à la corrosion**
 - **Livrée avec contre-plaque**
 - **Pas d'usure mécanique**
 - **Facilité d'installation**
 - **Préconisée en extérieur**
 - **Libère l'accès en cas de coupure de courant**
 - **Force de rétention : 300 kg**
 - **Varistance incorporée : Protection électronique intégrée contre l'effet de self**
- 

10 YEAR WARRANTY
- **Dimensions (L x l x P): 228 x 38 x 27mm**
 - **Dimensions contre-plaque (L x l x P): 185 x 38 x 11mm**
 - **Alimentation: 24 ou 48V DC**
 - **Consommation: 480 mA en 12V DC
240 mA en 24V DC**

IP42 DEEE & RoHS CE Certification CE

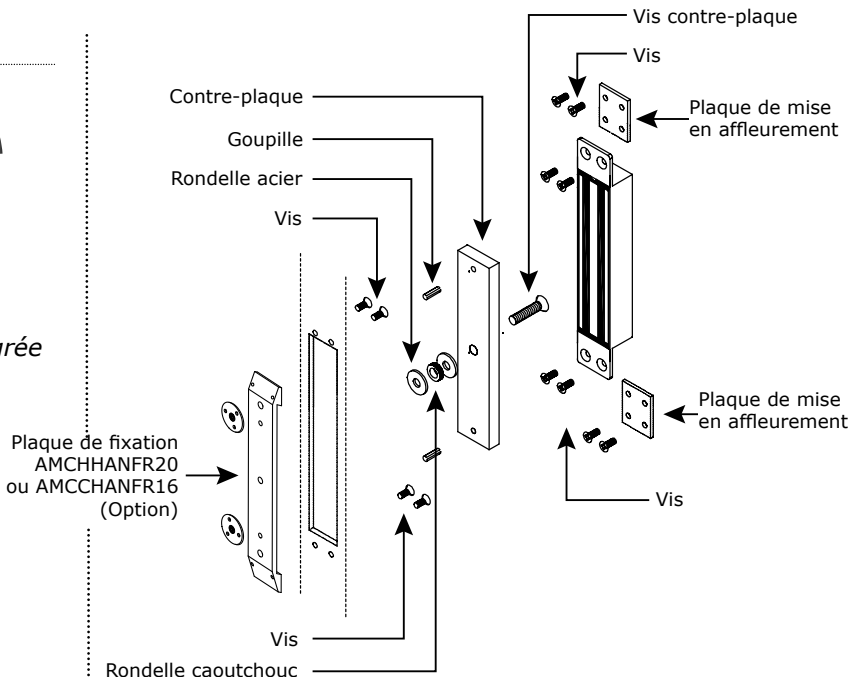

ÉLÉMENTS INCLUS

Ventouse encastrée	Contre-plaque	Goupille 5x16	Vis M5X8	Rondelle acier	Rondelle caoutchouc
1	1	2	8	2	1
Vis M8x35	Vis M8x25	Écrou borgne	Plaque de mise en affleurement	Notice	
1	1	1	2	1	

RECOMMANDATIONS DE MONTAGE

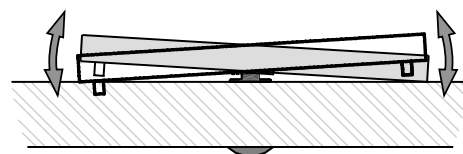

Contre-plaque

- Il est vital de fixer solidement la ventouse et la contreplaque sur leurs supports.
- La ventouse et la contre-plaque doivent être impérativement alignées.
- La contre-plaque doit être montée "flottante" autour de la vis centrale de montage pour compenser un mauvais alignement de la porte.

ACCESSOIRES EN OPTION

Références	AMCCHANFR16 AMCCHANFR20
Description	Pour contreplaque

Voltage selection jumpers

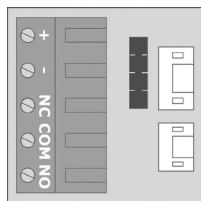
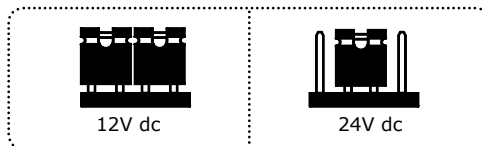

Alimentations recommandées



ADC335



ADC612S

RACCORDEMENTS

12V DC par défaut

Terminal block	Correspondance
+	12 ou 24V DC
-	- 0 V
NF	Normalement fermé
C	COM
NO	Normalement ouvert

Le signal NO/NC commute uniquement lorsque la porte est fermée et la ventouse est sous tension. Le contact NF est alors actif

IMPORTANT NOTE

Vérifier la position du cavalier avant de brancher la ventouse à la tension d'entrée. Un position incorrecte peut endommager la ventouse. Ce type de dommage n'est pas couvert par la garantie

CDVI FRANCE + EXPORT
31, av. du Général Leclerc
93500 PANTIN - France
Phone +33 (0)1 48 91 01 02
www.cdvi.com

CDVI UK
[UNITED KINGDOM - IRELAND]
Phone +44 (0)1628 531300
www.cdvi.co.uk

CDVI BENELUX
[BELGIUM - NETHERLAND - LUXEMBOURG]
Phone +32 (0) 56 73 93 00
www.cdviBenelux.com

CDVI IBÉRICA
[SPAIN - PORTUGAL]
Phone +34 (0)935 390 966
www.cdviberica.com

CDVI TAIWAN
Phone +886 (0)42471 2188
www.cdvichina.cn

CDVI MAROC
Phone +212 (0)5 22 48 09 40
www.cdvi.ma

CDVI SWEDEN
[SWEDEN - DENMARK - NORWAY FINLAND]
Phone +46 (0)31 760 19 30
www.cdvi.se

CDVI AMERICAS
[CANADA - USA]
Phone +1 (450) 682 7945
www.cdvi.ca

CDVI SUISSE
Phone +41 (0)21 882 18 41
www.cdvi.ch

CDVI ITALIA
Phone +39 0321 90 573
Fax: +39 0321 90 8018
www.cdvi.it

CDVI CHINA
Phone +86 (0)10 84606132/82
www.cdvichina.cn

CDVI POLSKA
Phone +48 12 659 23 44