



ALARM BATTERY LITHIUM 7.2V / 13Ah

BATTERIE SYSTEME ALARME LITHIUM 7.2V / 13Ah

MAIN INFORMATION / INFORMATIONS GÉNÉRALES

BRAND NAME	MARQUE	NX
TECHNOLOGY	TECHNOLOGIE	Lithium
TYPE	TYPE	BATLI02
NOMINAL VOLTAGE*	TENSION NOMINALE*	7.2V
NOMINAL CAPACITY*	CAPACITE NOMINALE*	13 Ah
MAX CONTINUOUS DISCHARGE CURRENT	COURANT DE DECHARGE MAX	2000mA
PULSE CURRENT CAPABILITY	COURANT IMPULSION MAX	3000mA
WEIGHT	POIDS	250g
OPERATING TEMPERATURE	TEMPÉRATURE D'UTILISATION	-55 TO 85°C



CHARGE / DISCHARGE CURVES COURBES DE CHARGE / DÉCHARGE

Discharge characteristics of different loads at room temperature

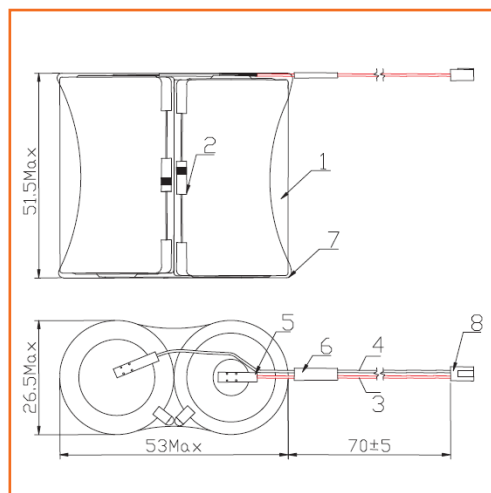
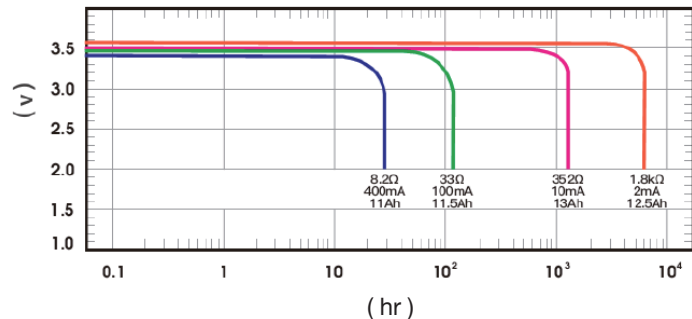

Different discharge current and discharge capacity characteristics

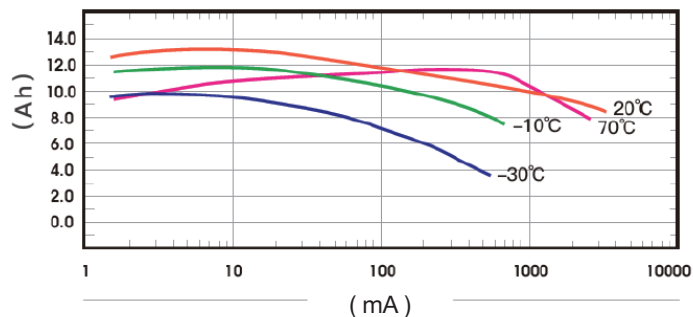

Characteristics of voltage platform at different temperatures

