

INSTALLATION INSTRUCTIONS FOR THE MANUAL CALL POINT

TO TEST

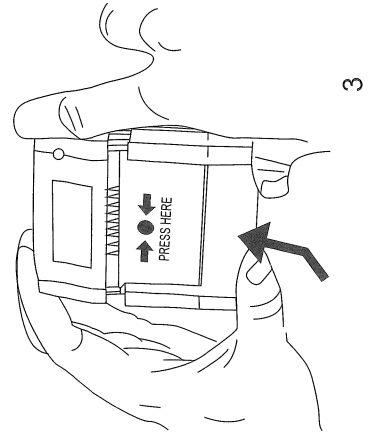

TO REPLACE RESETTABLE ELEMENT

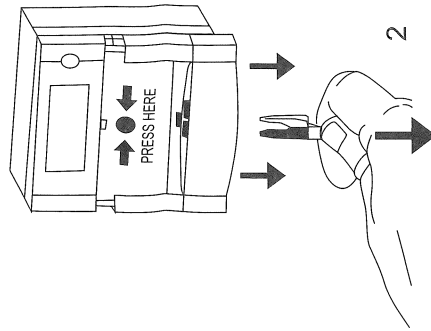
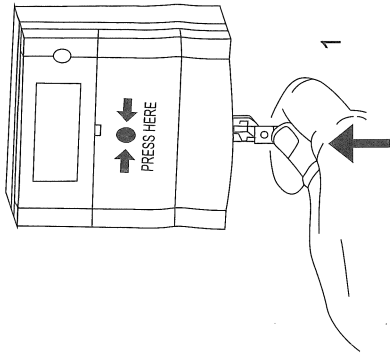
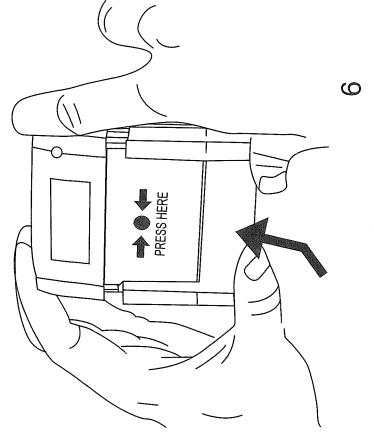
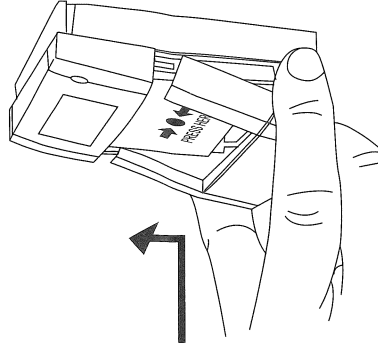
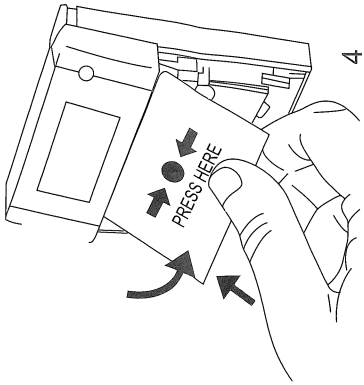
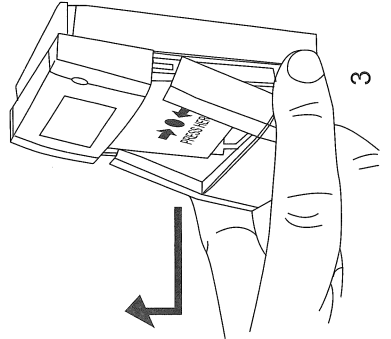
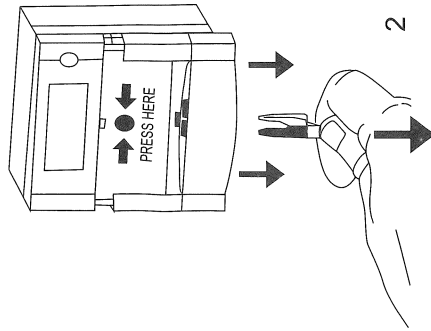
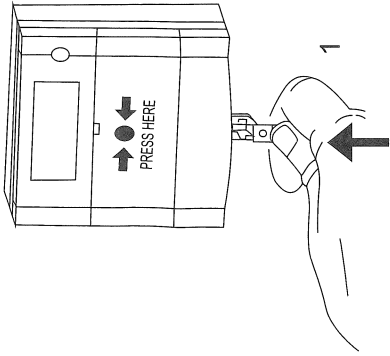

TO RESET

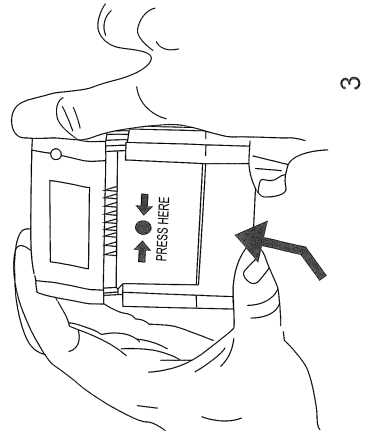
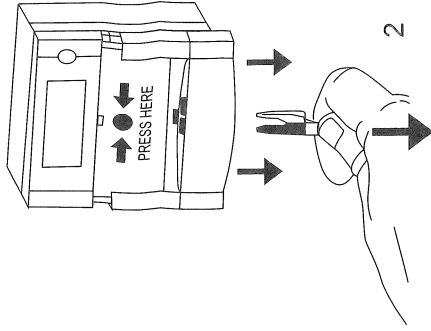
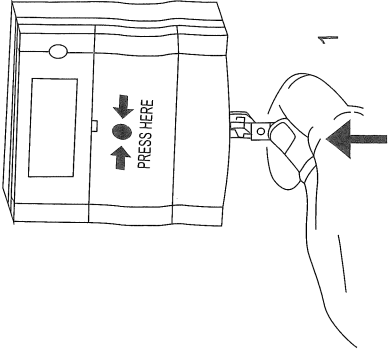

INSTALLATION INSTRUCTIONS FOR THE MANUAL CALL POINT

CONNECTION DETAILS	X(R)A	X(R)AB	X(R)C	X(R)CB

CONNECTION DETAILS	(R)S	CONNECTION DETAILS	X(R)D

X—COLOR
(R) — RESISTANCE
A,C,D,L,S,T—RELAY OUTPUT
EG:R470A=X,RED 470R.
transparent cover optional

RELAY OUTPUT	DESCRIPTION
A	SINGLE POLE WITH RESISTANCE
C	SINGLE POLE WITH RESISTANCE WITH LED, WITH ADDRESS CODE
D	DPDT
L	LED SINGLE POLE WITH RESISTANCE WITH LED
S	SSINGLE POLE
T	TRIPLE POLE

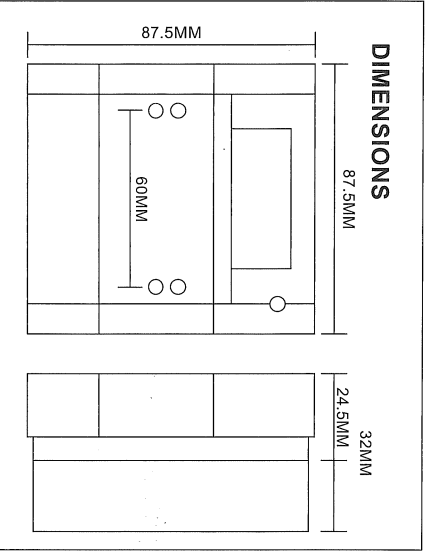

PUSH FIT CONNECTOR
After wiring the terminal connector, plug into the appropriate position, see connection details(left).

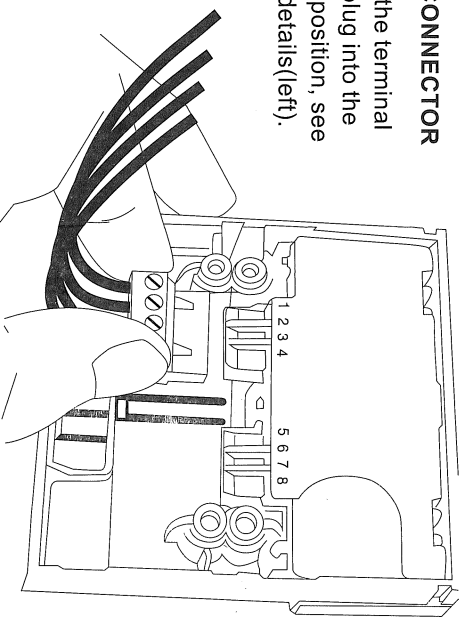

TECHNICAL DATA

- 30VDC Max
- 2A Max
- IP24D
- 110/160G
- 30°C to 70°C