

05/18 IL03801020Z

T0(3)-.../E, T0(3)-.../EZ T0(3)-.../E/SVB, T0(3)-.../EA/SVB

	T0...	T3...
	1 x 0.75 - 1.5mm ² 2 x 0.75 - 1.5mm ²	1 x 0.75 - 4.0mm ² 2 x 0.75 - 4.0mm ²
	1 x 1.0 - 2.5mm ² 2 x 1.0 - 2.5mm ²	1 x 1.0 - 6.0mm ² 2 x 1.0 - 6.0mm ²
tightening torque	1 Nm (8.85 lb-in) AWG18 - AWG14	1.6 Nm (14.16 lb-in) AWG14 - AWG10 2 Nm (17.7 lb-in)

T0(3)-.../E

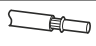
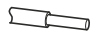
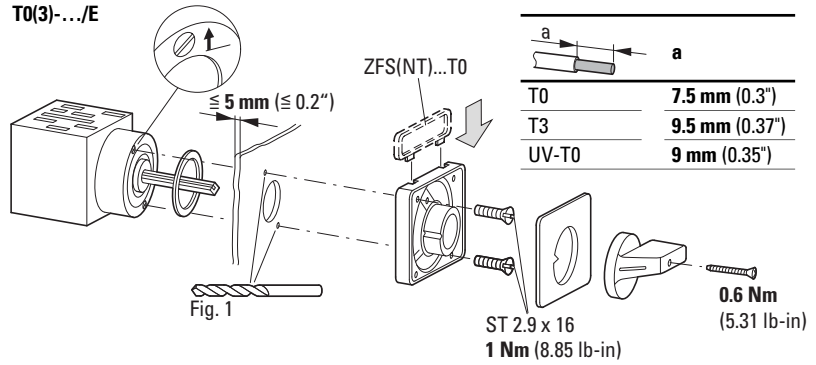

Fig. 1

ST 2.9 x 16
1 Nm (8.85 lb-in)

0.6 Nm
(5.31 lb-in)

UL/CSA:

Suitable For Use As Motor Branch Circuit Disconnecting Means With Suffix SVB. Break All Lines.

Short Circuit Withstand
10 kA RMS SYM 600 V AC
Max Fuse T0... - 20 A Class J
T3... - 40 A Class J

Standard Short Circuit
5 kA RMS SYM 600 V AC
Max Fuse T0... - 50 A
T3... - 40 A
Max Cir. Bkr. T0... - 50 A
T3... - 125 A

Switch or enclosure must be padlockable if used as a Motor Branch Circuit Disconnecting means.

T0(3)-.../EZ/OFS
T0(3)-.../EZ

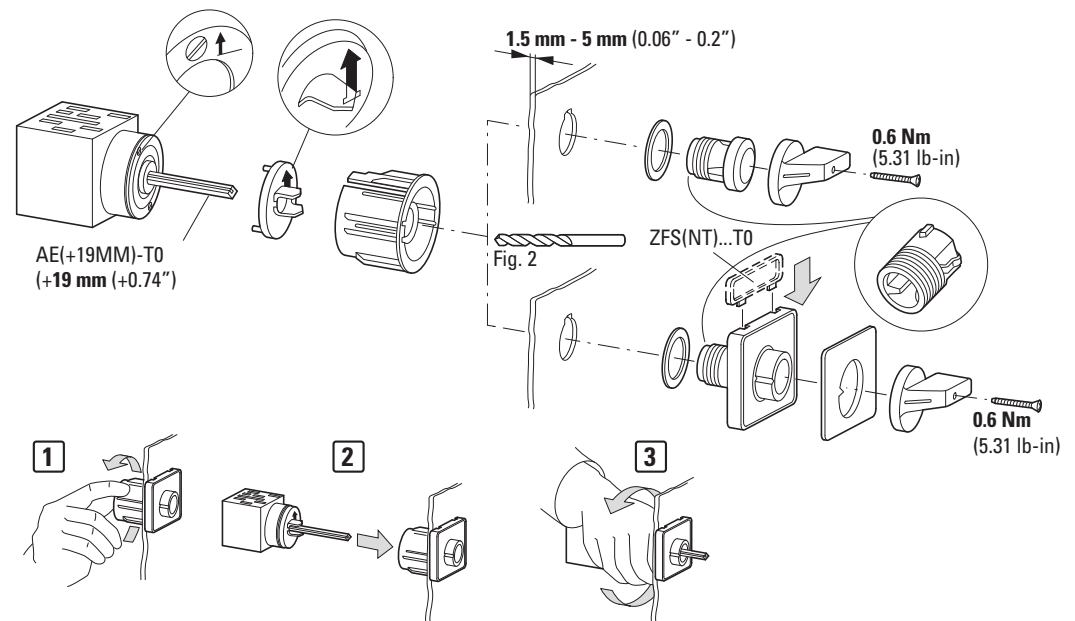

AE(+19MM)-T0
(+19 mm (+0.74"))

Fig. 2

ZFS(NT)...T0

0.6 Nm
(5.31 lb-in)

0.6 Nm
(5.31 lb-in)

Fig. 1

→ ≠ 1 : 1

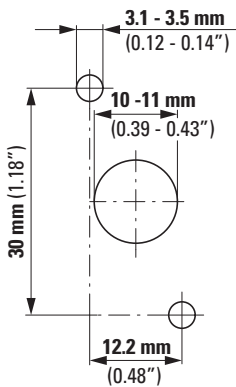
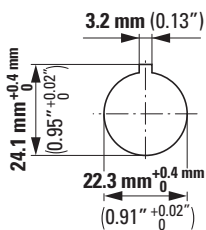

Fig. 2

→ ≠ 1 : 1



T0(3)-.../E/SVB

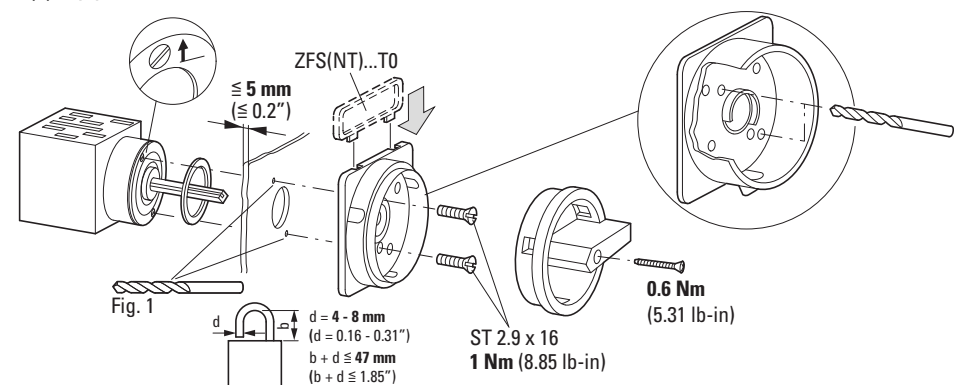

Fig. 1

d = 4 - 8 mm
(d = 0.16 - 0.31")
b + d ≤ 47 mm
(b + d ≤ 1.85")

ST 2.9 x 16
1 Nm (8.85 lb-in)

0.6 Nm
(5.31 lb-in)

T0(3)-.../EA/SVB

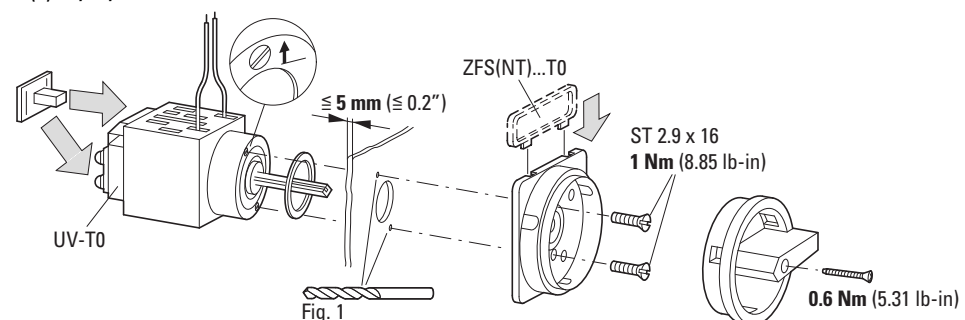
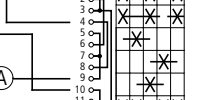
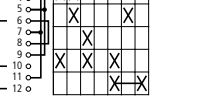
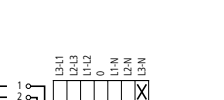
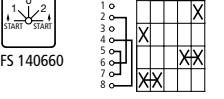
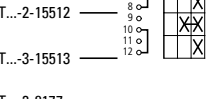
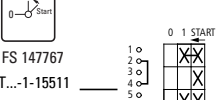
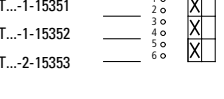
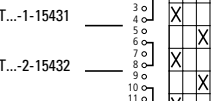
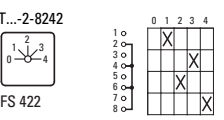
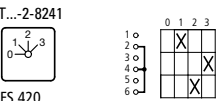
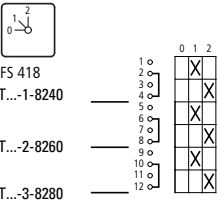
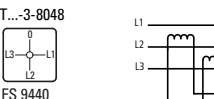
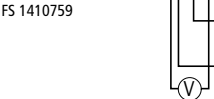
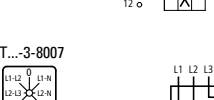
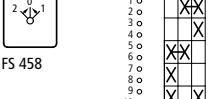
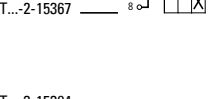
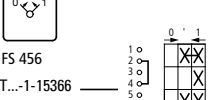
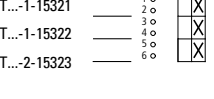
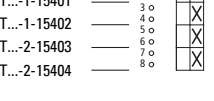
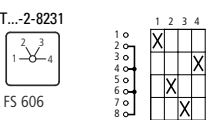
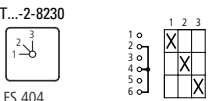
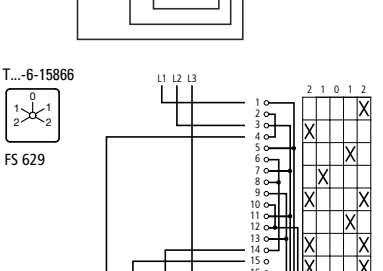
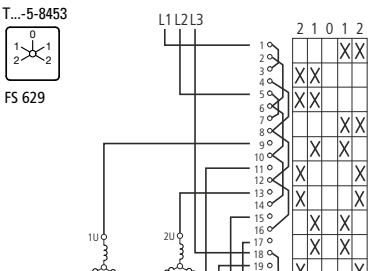
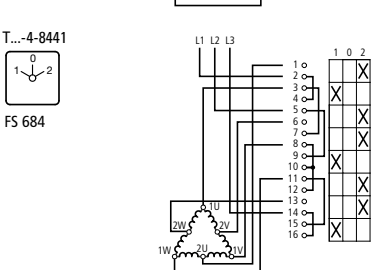
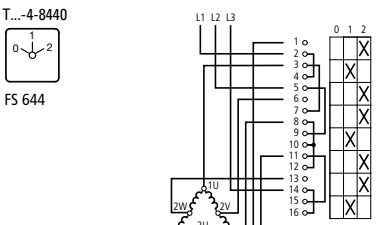
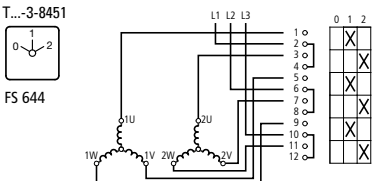
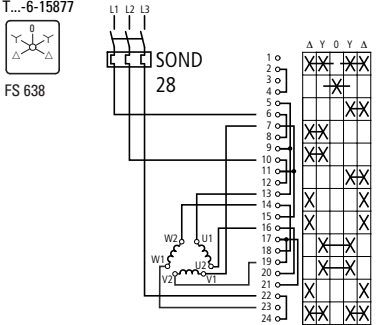
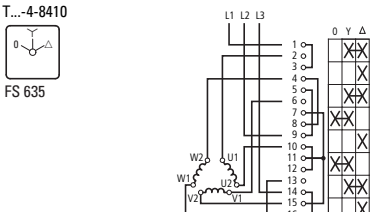
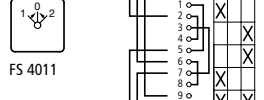
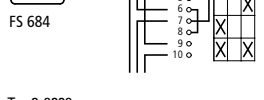
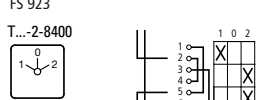
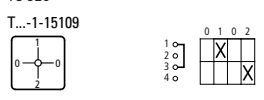
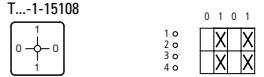
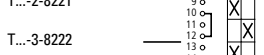
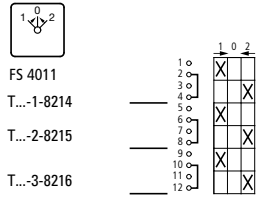
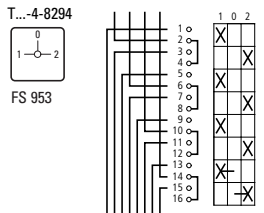
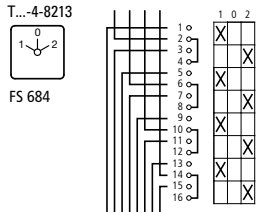
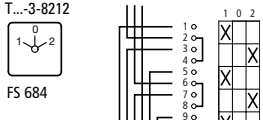
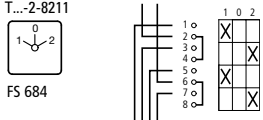
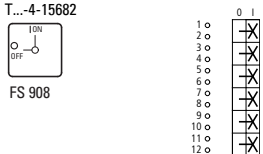
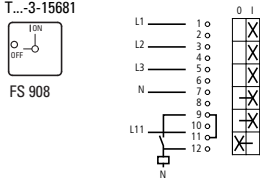
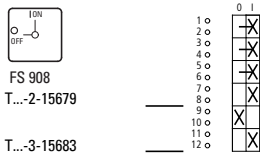
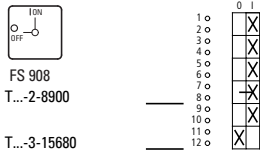
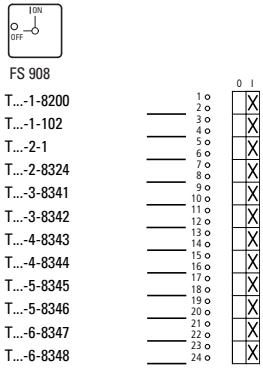

Fig. 1

ST 2.9 x 16
1 Nm (8.85 lb-in)

0.6 Nm (5.31 lb-in)



05/18 IL03801020Z