



GHG 293



GHG 292

Technical data

Ex-control switch Typ 292 without and Typ 293 with measuring instrument

	with GHG 29 Switch	with GHG 28 Switch
Marking accd. to 2014/34/EU	Ⓢ II 2 G Ex ed ia IIC T5/T6 Ⓢ II 2 D Ex tD A21 IP66 T80 °C	Ⓢ II 2 G Ex ad ia IIC T5/T6 Ⓢ II 2 D Ex tD A21 IP66 T80 °C
EC-Type Examination Certificate	PTB 99 ATEX 1163	PTB 99 ATEX 1163
IECEX Certificate of Conformity	IECEX BKI 07.0011	IECEX BKI 07.0011
Marking accord. to IECEx	Ex ed ia IIC T5 or T6 Ex tD A21 IP66 T49 °C	Ex ed ia IIC T5 or T6 Ex tD A21 IP66 T49 °C
Permissible ambient temperature	-20 °C up to +40 °C -55 °C up to +47 °C (T6) ... +55 °C (T5) Option	
Rated voltage	max. 500 V	max. 690 V
Rated current	16 A	20 A
Rated current with gold contact points	0.4 A	
Overload range (Type 293 only)	10 fold - 25 sec. 25 fold - 4 sec. 50 fold - 1 sec. indicated 1 : 1.5	
Measuring range (type only 293)	max. 0 - 25 A direct / n / 1A	
Accuracy (type 293 only)	Class 2.5	
Movement (type 293 only)	Moving iron	
Rated making-/rated breaking capacity accd. EN 60947-5-1	AC-15: $U_e$ 230 V / $I_e$ 6 A $U_e$ 400 V / $I_e$ 4 A DC-13: $U_e$ 24 V / $I_e$ 2 A $U_e$ 230 V / $I_e$ 0.3 A	AC-15: $U_e$ 230 V / $I_e$ 8 A $U_e$ 400 V / $I_e$ 6 A DC-13: $U_e$ 24 V / $I_e$ 6 A $U_e$ 230 V / $I_e$ 0.4 A
Connecting terminals	2 x 0.5 - 2.5 mm <sup>2</sup> or 1 x 1.0 - 6.0 mm <sup>2</sup>	
Degree of protection accd. to EN 60529	IP66	
Cable glands/Gland plates/Enclosure drilling	1 x M25 cable gland <sup>1) 2)</sup>	
Dimensions (L x W x H)	GHG 292 GHG 293	170 x 110 x 129 mm 225 x 110 x 129 mm
Weight	GHG 292 GHG 293	approx. 1.10 kg (1 level) approx. 1.25 kg (2 level) approx. 1.40 kg (3 level) approx. 1.90 kg (1 level) approx. 2.05 kg (2 level) approx. 2.20 kg (3 level)
Enclosure material	glass-fibre reinforced polyester	
Enclosure colour	black	

<sup>1)</sup> Brass flange for metal entries available on request

<sup>2)</sup> Control switches with direct indicating measuring instruments in the standard version are delivered with 2 looping terminals and PE terminal as well as M32 and M25 cable entries.

## Ex-control switch GHG 292 and GHG 293



GHG 292



GHG 293

### 4 Ordering code for control switch (Code 2) Code A - B1 - B2 - C - D - E - E2 - F<sup>1)</sup>

Code            **A**            **B1 B2**    **C**    **D**    **E**    **E2**    **F<sup>1)</sup>**

Order No.      **GHG 29\_**    -    -    -    -    -    -    -

Code	Component		Code	
A	Control switch		GHG 292	
	Control switch with measuring instrument		GHG 293	
Code	Switching system		Code	
B1	spring – engaging – spring		4	
	engaging – engaging – engaging		5	
	engaging – engaging		6	
	spring – engaging – engaging		7	
	engaging – engaging – spring		8	
Code	Contact	code for silver contact points	Contact	silver contact points
B2		062		034
		062		037
		065		049
		061		023
		063		019
		067		033
		011		024

Other versions as well as gold contact points are available on request.

Code	Inscription (labels)	Code	Inscription (labels)	Code
C	0	I	001	0
	I	II	002	AUS
	STOP	START	003	AUS
	HAND	AUTO	004	ÖRTLICH
	SENKEN	HEBEN	005	START
	REMOTE	LOCAL	006	OFF
	I	0	007	HAND
	AUS	BETRIEB	008	0
	AUS	0	009	MAN
	AUF	0	010	START
	Entriegelt	0	011	HEBEN
	OUT	OF	012	OFF
	LOCAL	REMOTE	013	AUS
	STOP	0	014	HAND
	HAND	0	015	ON
	AUF	AUS	016	I
	HAND	AUS	017	II
				III
				018
				019
				020
				021
				022
				023
				024
				025
				026
				027
				028
				029
				030
				031
				032
				033



Ordering code for control switch (Code 2) Code A - B1 - B2 - C - D - E1 - E2 - F

Code	Component		Code	
D	none	<input type="checkbox"/>	0	
	centre	<input type="checkbox"/>	1	
	left	<input type="checkbox"/>	2	
	right	<input type="checkbox"/>	3	
Code	Movement		Code	
E1	Direct connection		01	
	CT connection 1 /A		02	
	Connection 0 - 20/24 mA (scale 0-100% / 120%)		05	
	Connection 4 - 20/24 mA (scale 0-100% / 120%)		06	
	Moving-coil connection 0 - 20/24 mA (scale 0-100% / 120%)		07	
	Moving-coil connection 4 - 20/24 mA (scale 0-100% / 120%)		08	
Code	Measuring range/Scale	Code	Measuring range/Scale	Code
E2	0 - 1	002	0 - 75 /112.5 A	013
	0 - 2.5 / 3.75 A 2)	003	0 - 100 / 150 A	014
	0 - 5 / 7.5 A 2)	004	0 - 150 / 225 A	015
	0 - 10 / 15 A 2)	005	0 - 200 / 300 A	016
	0 - 15 / 22.5 A	006	0 - 250 / 375 A	017
	0 - 20 / 30 A 2)	008	0 - 300 / 450 A	018
	0 - 30 / 45 A	009	0 - 400 / 600 A	019
	0 - 40 / 60 A	010	0 - 500 / 750 A	020
	0 - 50 / 75 A	011	0 - 600 / 900 A	021
	0 - 60 / 90 A	012	0 - 100% / 150%	031
	Code	Built-in components	Description	
	F1	Entry type	entry direct in enclosure	GEH
entry via plastic flange			FLK	
entry via metal flange			FLM	
F2	Entry element	only threaded entry	BO	
		screw plug	SV	
		cable entry moulded plastic	GK	
		cable entry moulded metal <sup>2)</sup>	GM2)	
		cable entry with plug	GV	
F3	Size	M12, M16, M20, M25, M32, M40	M1 Ø ..	
		Ø21, Ø26		
F4	Number	number of entries	..	

<sup>1)</sup> The code will represent only a selected part of configuration.

<sup>2)</sup> Only available with metal flange

## Ex-control switch GHG 292 and GHG 293



GHG 292



GHG 293

### 4 Example for ordering code (Code 2)

Control switch with silver contact points, Switching system „5“, Circuit „063“,  
Labels „HAND-0-AUTO“, can be locked at „0“,  
Measuring instrument AM72 for CT connection „n/1A“, Scale „0 - 50/75 A“,  
Cable gland 1 x threaded entry M25 on bottom direct entry.

**Code A B1 B2 C D E1 E2 F1 F2 F3 F4**  
GHG 293 / 5 / 063 / 015 / 1 / 2 / 011 / GEH / BO / M25 / 1

### Ordering details

Switching system	Circuit	Code	Labels	Order No.
<b>Control switch Typ 292 with silver contact points</b>				
<b>Version with padlocking facility in „0“-, or position „right (Code 3)“; cable gland 1 x M25 bottom.</b>				
6		062	0 I	GHG 292 1000 R0001
6		065	0 I	GHG 292 1000 R0002
4		067	0 I	GHG 292 1000 R0003
8		067	0 I	GHG 292 1000 R0004
4		037	0 I	GHG 292 2000 R0002
8		037	0 I	GHG 292 2000 R0003
5		024	I 0 II	GHG 292 2000 R0004
5		023	HAND OFF AUTO	GHG 292 2001 R0001

Switching system	Circuit	Code	Labels	Order No.
<b>Control switch with measuring instrument type 293 with silver contact points. Version with padlocking facility in „0“-, or position „left“; measuring instrument AM 72 for CT connection n/1A, Scale 0 - 100/150 %. 1 x M32 bottom.</b>				

6		062	0 I	GHG 293 1000 R0001
6		065	0 I	GHG 293 1000 R0002



Accessories

Type	Application	Fixing method	OU	Order No.
<b>Mounting plate for type 292</b>				
Size 2	wall mounting	snap on	1	GHG 610 1953 R0104
Size 2	pipe clamp	snap on	1	GHG 610 1953 R0105
Size 2	trellis-work mounting	snap on	1	GHG 610 1953 R0106
Size 4	wall mounting	snap on *	1	GHG 610 1953 R0128
Size 4	trellis-work mounting	snap on *	1	GHG 610 1953 R0128
Size 4	pipe clamp	snap on *	1	GHG 610 1953 R0132
<b>Mounting plate for type 293</b>				
Size 3	wall mounting	snap on	1	GHG 610 1953 R0118
Size 3	pipe clamp	snap on	1	GHG 610 1953 R0110
Size 3	trellis-work mounting	snap on	1	GHG 610 1953 R0118
Size 5	wall mounting	snap on *	1	GHG 610 1953 R0128
Size 5	trellis-work mounting	snap on *	1	GHG 610 1953 R0128
Size 5	pipe clamp	snap on *	1	GHG 610 1953 R0132
Plug-in fastener for CEAG modules with 5.5 mm and 11 mm fixing elements 4 pieces			10	GHG 610 1953 R0041

\*snap-on with snap-on mounting 5.5 mm

Dimension drawing

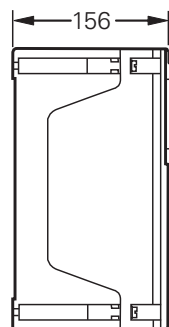
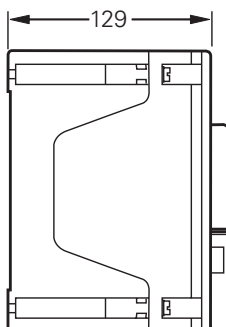
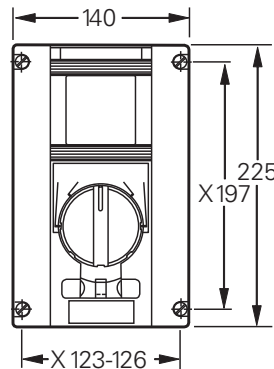
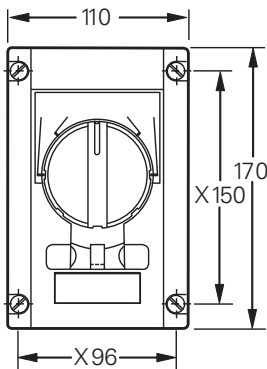

GHG 292

GHG 293

X = fixing dimensions

Dimensions in mm