

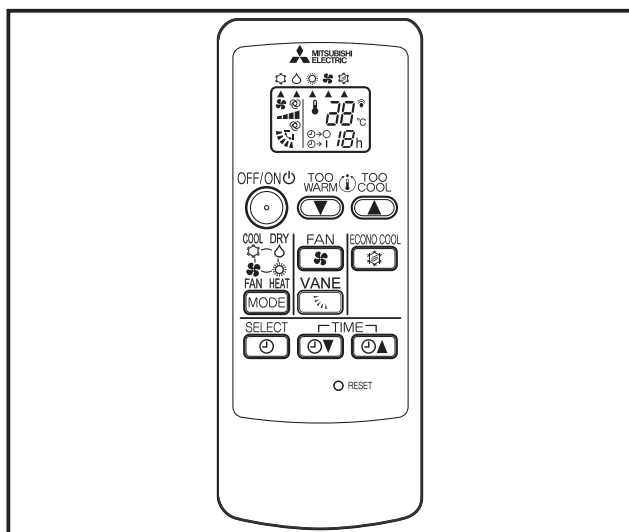

Figure



Descriptions

Wireless remote controller for M series.

Applicable Models

- MSY-TP35VF
- MSY-TP50VF

Specifications

Power	DC 3V (AAA battery 2pcs)
Usage environment	0 ~ 40°C

Dimensions

Unit : mm

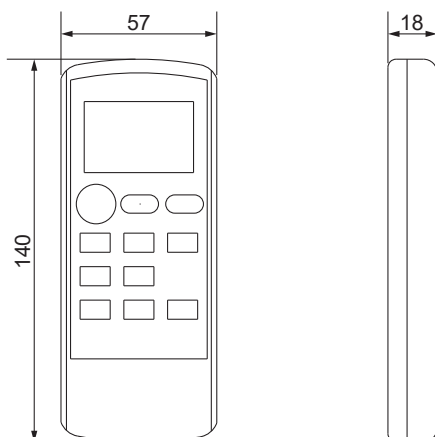

How to Use / How to Install

PREPARATION BEFORE OPERATION

Remote controller

Operation display section
Signal transmitting section
Distance of signal : About 6 m
Beep(s) is (are) heard from the indoor unit when the signal is received.

Remote controller holder

- Install the remote controller holder in a place where the signal can be received by the indoor unit.

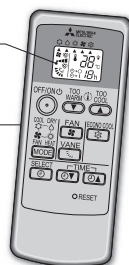
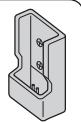

Installing the remote controller batteries

1. Remove the back lid.
2. Insert the negative pole of AAA alkaline batteries first.
3. Install the back lid.
4. Press RESET.

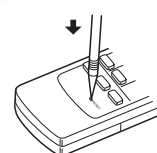
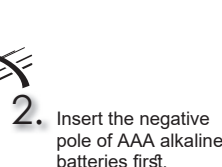
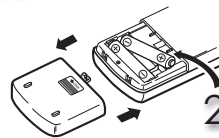

Note:

- Make sure the polarity of the batteries is correct.
- Do not use manganese batteries and leaking batteries. The remote controller could malfunction.
- Do not use rechargeable batteries.
- Replace all batteries with new ones of the same type.
- Batteries can be used for approximately 1 year. However, batteries with expired shelf lives last shorter.
- Press RESET gently using a thin instrument. If the RESET button is not pressed, the remote controller may not operate correctly.

OPTIONAL PARTS

INDOOR UNIT

Note:

Selecting installation location:

- Where it is easy to operate and easily visible.
- Where children cannot touch it.
- Select a position about 1.2 m above the floor and check that signals from the remote controller are surely received by the indoor unit from that position ('beep' or 'beep beep' receiving tone sounds). After that, attach remote controller holder to a pillar or wall and install wireless remote controller.
- In rooms where inverter type fluorescent lamps are used, the signal from the wireless remote controller may not be received.

Before operation:

Insert the power supply plug into the power outlet and/or turn the breaker on.