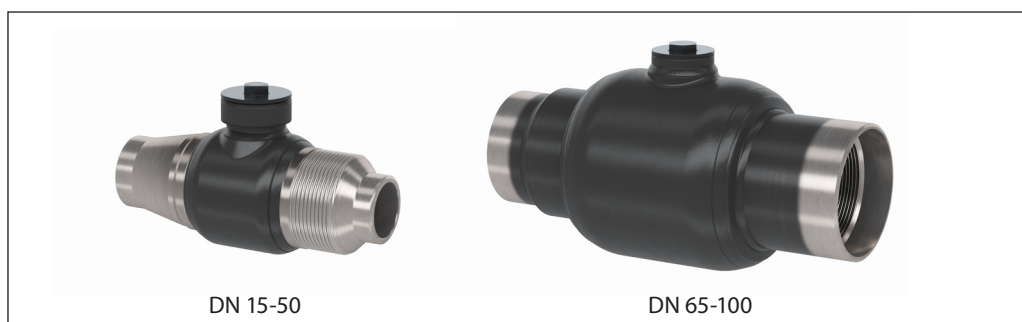

Data sheet

JIP™ hot tap ball valves

Description

**Application:**

Danfoss JIP™ hot tap ball valves are designed for extensions of district heating systems and other closed loop water systems, where the water is treated to avoid internal corrosion.

With Danfoss JIP™ hot tap ball valves new connections and maintenance of the district heating network can be done while the system is fully operational. This saves time and eliminates interruptions for the users.

Having a fully welded body, the valves meet the requirements for valves used in district heating and district cooling systems and offer the highest degree of security.

Features:

- External stem hexagon on all dimensions
- Position indicator of the ball on the stem
- 90 degree end stop
- New plug construction
- The valves are maintenance free
- Standard and OEM versions

Main data:

- DN 15-100 mm
- k_{vs} 11-2.300 m³/h
- PN 25/40 bar
- Temperature: 0 ... 180°C
- Medium: Circulation water / glycolic water up to 50%
- Min. storage and transport temperature: -40°C



Approvals and norms:

- 100% final inspection. Leak and shell tests as well as dimension and functionality tests are performed on each and every valve according to applicable standard (EN 12266 part 1 P10-P11-P12 & part 2 F20).
- PED 2014/68/EU module H1
- Danfoss A/S is certified according to ISO 9001, ISO 14001 and ISO 45001
- Hot tapping machine are TUV. A.366 – 16 approved.

Ordering

Hot tap JIP-WW and tool boxes
T = 0 ... 180 °C

Standard version

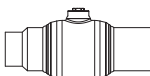
Picture	DN (mm)	Kvs (m³/h)	Hole saw diameter (mm)	PN (bar)	Code No.	Hot tapping machine (DN 15-100 mm)	Adapter Box	
	15/20	11	Ø 15	40	065N0050	 065N1000	065N1003	065N1002
	25*	90	Ø 24		065N0051			
	32	52	Ø 24		065N0052			
	40*	235	Ø 40		065N0053			
	50	184	Ø 40		065N0054			
	65	200	Ø 48	25	065N0055		065N1004	
	80	470	Ø 65		065N0056			
	100	640	Ø 79		065N0057			

OEM version

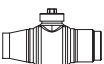
Picture	DN (mm)	Kvs (m ³ /h)	Hole saw diameter (mm)	PN (bar)	Code No.	Hot tapping machine (DN 15-100 mm)	Adapter
	20*	50	Ø 19	40	065N0070	065N1000	065N1022
	25	34	Ø 19		065N0071		065N1023
	40	96	Ø 32		065N0072		

* Full bore design

Data sheet

JIP™ hot tap ball valves



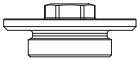

Spare Parts for hot tap valves

Top plug for packing box



Picture	Valve size (mm)	Code No.
	15	065N0010
	20	
	25	065N0011
	32	
	40	
	50	065N0012
	65	
	80-100	065N0013

Note: Packaging contains 10 pcs

Spare parts for hot tap tool box

Picture	Description	Details	Code No.
	JIP-HTT Accessory box	Shaft opening pin (5 pcs) Accessory box Pilot Drills (90 mm and 2 pcs 120 mm) Allen key 3, 4 and 5mm Extension socket Gear fastening screw Chip magnet Drill Holder for Hole Saws > 30 and < 32 mm	065N1008
	JIP-HTT Sealing set (for machine)	Ret.Ring for Upper/Lower Bearing Upper/Lower PTFE-Bearing Base sealing Lip and shaft sealings Jr. Thrust Bearing Jr. Thrust retaining ring O-ring upper bearing	065N1007
	JIP-HTT Sealing adapters set DN 20-100	Sealing adapter DN20-100 mm (8 pcs) Chip Magnet Shaft opening pin (5 pcs)	065N1020
	JIP-HTT Pilot drill normal (95mm)	5 pieces set of drills 95 mm	065N1009
	JIP-HTT Pilot drill short (83mm)	5 pieces set of drills 83 mm	065N1010
	JIP-HTT Tool set	Allen keys - 3, 4 and 5 mm Special wrench (2 pccs) Chip Magnet Shaft opening pin (5 pcs) Pipe wrench 13 mm	065N1006

Spare parts for **standard** version

Picture	Description	Valve size	Hole saw diameter	Code No.
	JIP-HTT Hole saw	DN 15/20	Ø15	065N8020
		DN 25/32	Ø24	065N8012
		DN 40/50	Ø40	065N8013
		DN 65	Ø48	065N8093
		DN 80	Ø65	065N8014
		DN 100	Ø79	065N8097
	JIP-HT adapters	DN 15/20	-	065N7980
		DN 25	*JIP HTT adapter DN 32 +JIP-HTT adapter reduction socket DN 25	-
		DN 32	-	065N7981
		DN 40	*JIP HTT adapter DN 50 +JIP-HTT adapter reduction socket DN 40	-
		DN 50	-	065N7982
		DN 65	-	065N7983
		DN 80	-	065N7984
	JIP-HT adapter reduction sockets	DN 100	-	065N7985
		DN 25	JIP-HT adapter socket DN 25	065N7986
		DN 40	JIP-HT adapter socket DN 40	065N7987

* For the sizes DN 25 as well as for DN40 reduction sockets have to be added to adapter of the next size

Data sheet

JIP™ hot tap ball valves

Spare parts for hot tap tool box (continuous)

Spare parts for OEM version

Picture	Description	Valve size	Hole saw diameter	Code No.
	JIP-HTT Hole saw	DN 20	Ø19	065N8086
		DN 25		
		DN 40	Ø32	065N8089

Technical data

Nominal diameter	DN	15/20	25	32	40	50	65	80	100
Nominal pressure	PN	40					25		
Temp range	°C	0-180							
Medium		Circulation water / glycolic water up to 50 %							

Design and material:

JIP Hot tap

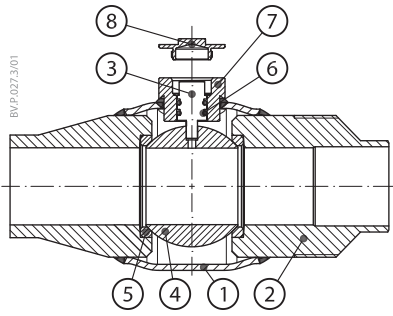

1	Valve body	*Weldable mild steel 20#
2	Welding ends	
3	Valve stem	Stainless steel
4	Ball	
5	Seat rings	Carbon reinforced PTFE
6	O-rings	EPDM
7	Packing box	*Weldable mild steel 20#
8	Plug	

* According to the GB/T8163. Or equivalent mild steel in accordance with CE-PED

Hot tapping tool design

1. Metabo drilling machine with mounted reduction gear as a part of Hot tapping tool box DN 15-100 code 065N1000 / Manual Jr-Ratchet drive as a part of the Hot tapping adapter tool box DN 15-32 code 065N1021
2. Feeding wheel
3. Feed Extension Socket
4. Adjusting Handle
5. Tool body
6. Base Shaft
7. Shaft Extension
8. Drill holder
9. Hole Saw
10. Pilot Drill
11. Pressure Gauge
12. Shut off valve
13. Hot tap Ball valve

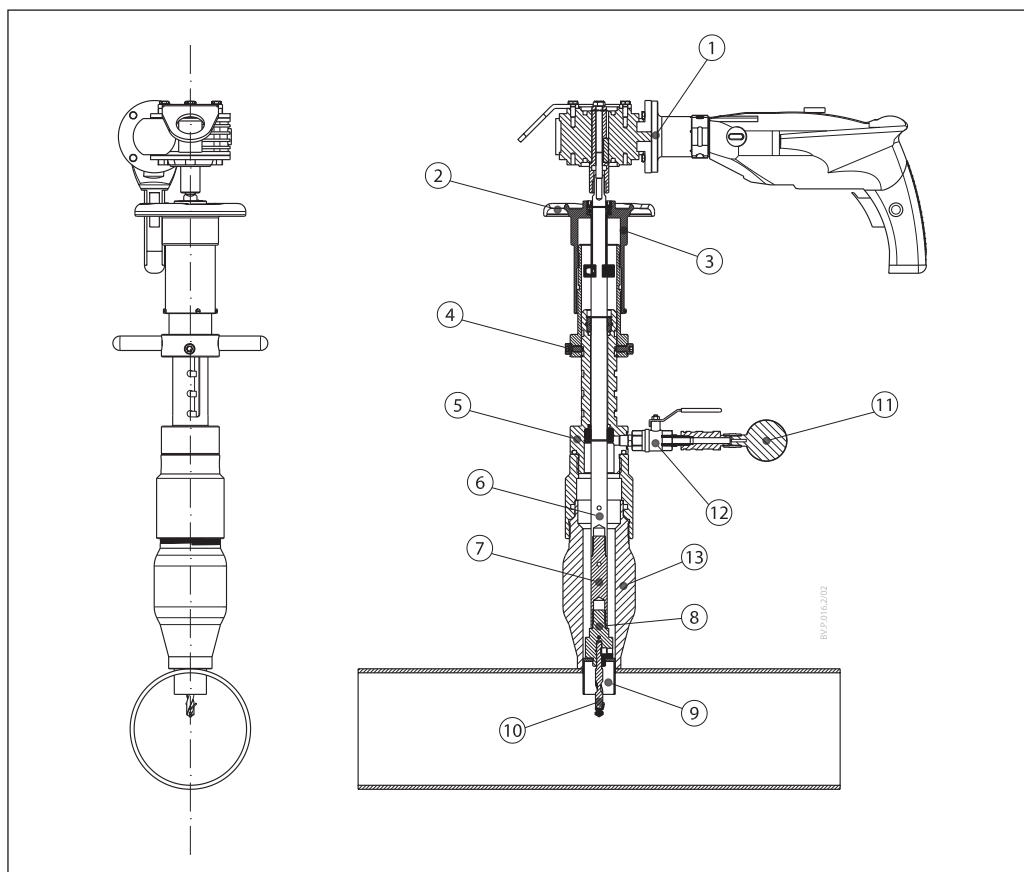

Toolbox design and parts

1. Metabo drilling machine with mounted reduction gear
2. Feed device
3. Base Shaft
4. Extension shaft
5. Special shaft DN 20
6. Pressure Monitoring Set 40 bar
7. Cutting paste
8. Sealant lubricant
9. Wrench
10. Accessory box
11. Pressure relief hose
12. Pipe wrench

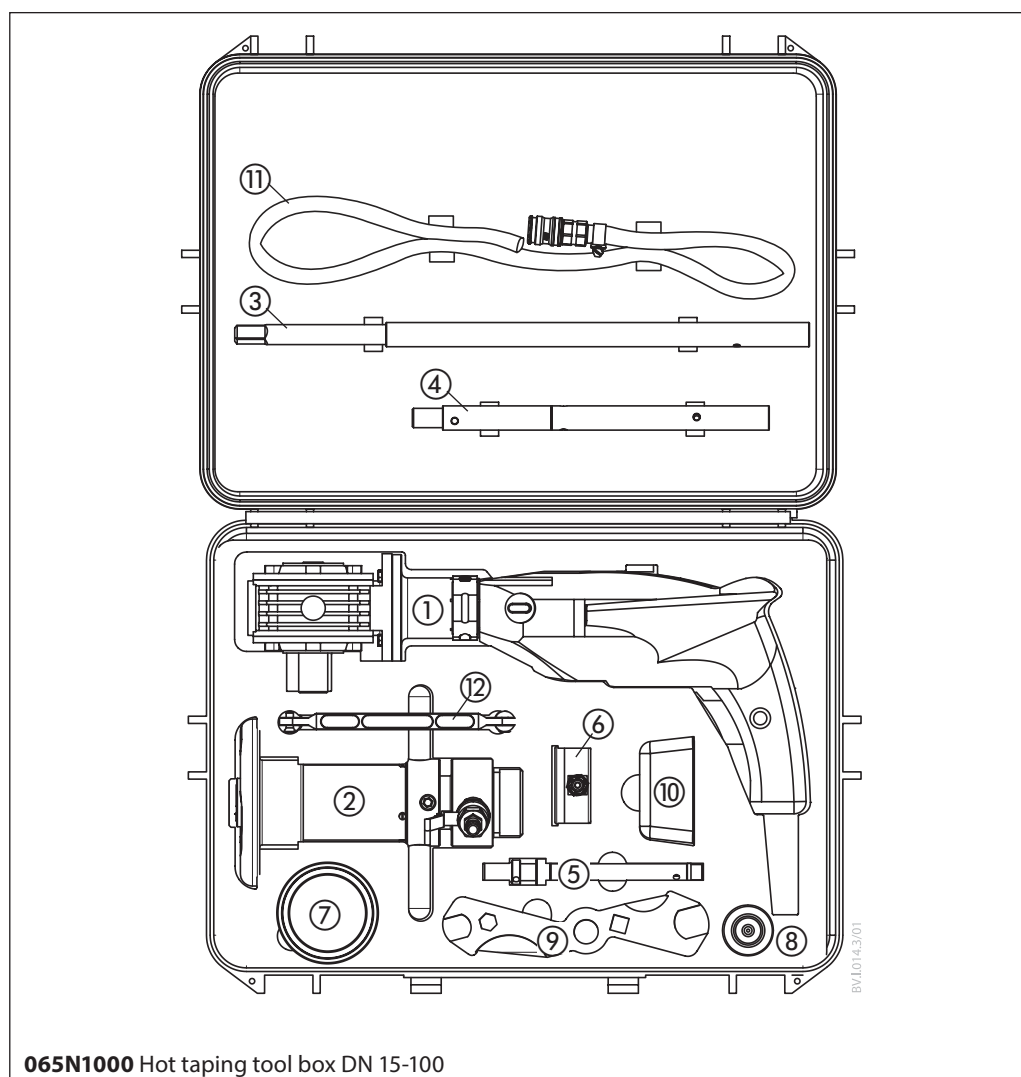

Toolbox design and parts

1. Adapter socket DN 25/40
2. Allen key set
3. Adapter DN 15/20
4. Adapter DN 32
5. Allen key set
6. Spare sealing set
7. Pilot Drills
8. Adapter DN 100
9. Hole Saw HSS 15-100mm
10. Screwdriver 6mm
11. Adapters DN 50-80

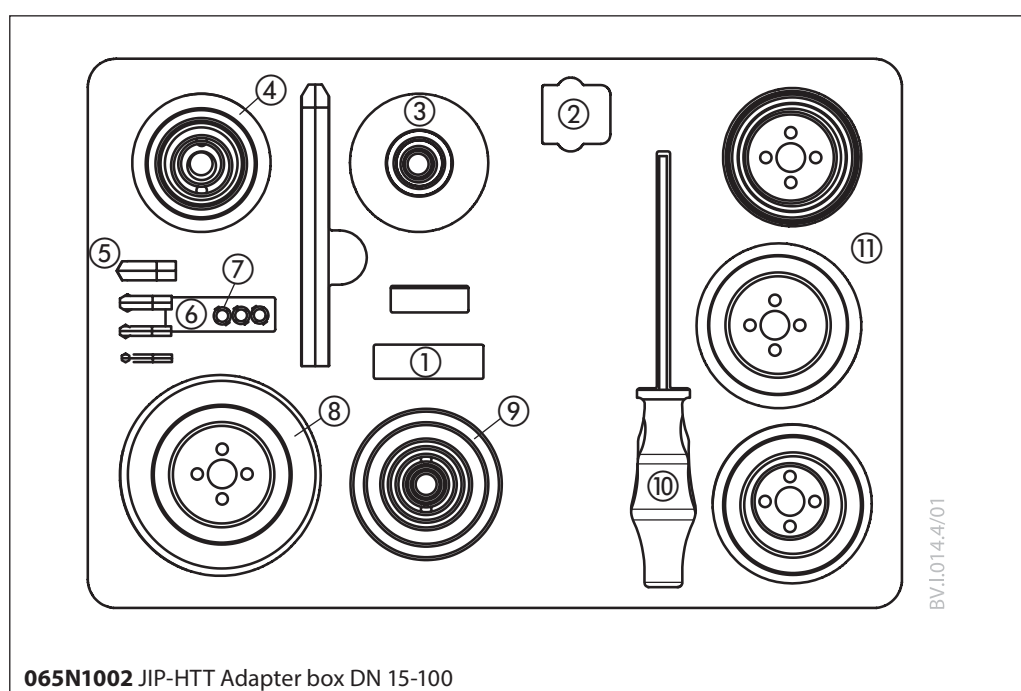

Toolbox design and parts

1. Adapter DN 15/20
2. Adapter socket DN 25
3. Adapter DN 32
4. Adapter socket DN 40
5. Adapter DN 50
6. Hole saws DN 15-DN 50
7. Screwdriver 6 mm
8. Spare sealing set
9. Pilot Drills HM normal and short
10. Allen key set 2.5-10 mm

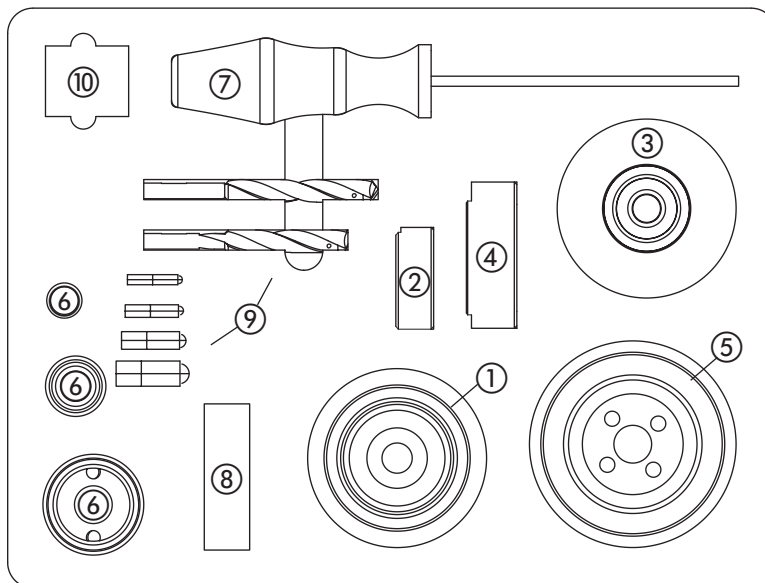

065N1003 JIP-HTT Adapter box DN 15-50

Toolbox design and parts

1. Adapter DN 65
2. Adapter DN 80
3. Adapter DN 100
4. Hole saws DN 65-DN 100
5. Spare sealing set
6. Allen key 14 mm
7. Allen key set 2.5-10 mm
8. Screwdriver 6 mm
9. Pilot Drills HM normal and short

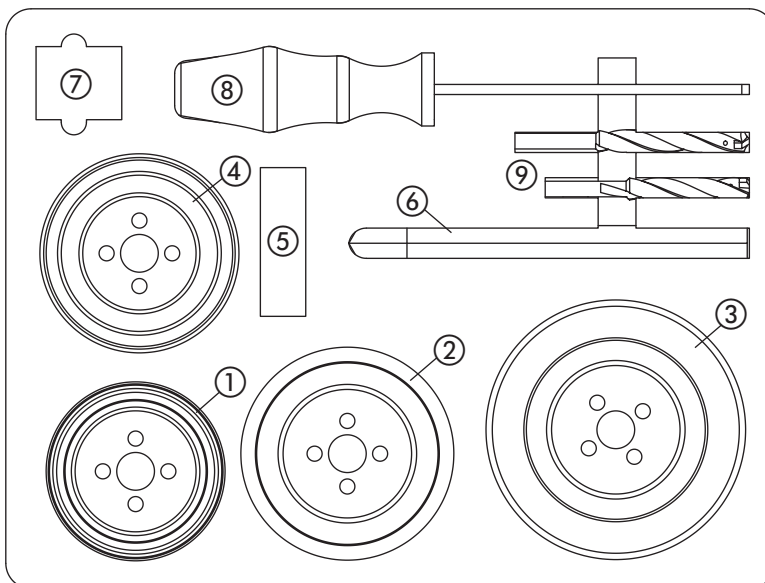

065N1004 JIP-HTT Adapter box DN 65-100

Toolbox design and parts

1. Feed device
2. Base Shaft
3. Extension shaft
4. Special shaft DN 20
5. Pressure Monitoring Set 40 bar
6. Cutting paste
7. Sealant lubricant
8. Wrench
9. Accessory box
10. Pressure relief hose
11. Pipe wrench
12. Jr-Ratchet drive
13. Drill turning socket ½" 10 mm HEX
14. Adapter sealing set
15. Adapter DN 32
16. Adapter DN 20
17. Adapter DN 25
18. Jr. Pilot drill D14
19. Hole saws DN 15-DN 32

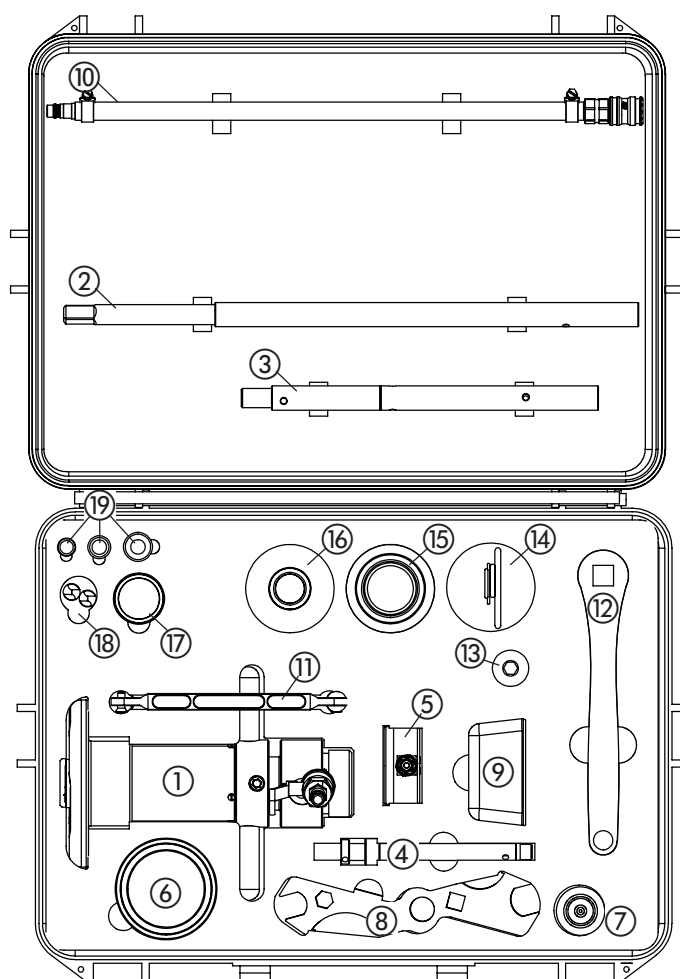

***065N1021** Hot taping adapter tool box DN 15-32

*Hot tap-manual ratchet driven machine toolbox for valves DN 15/20-32 with included adapters

Pressure drop/flow diagram

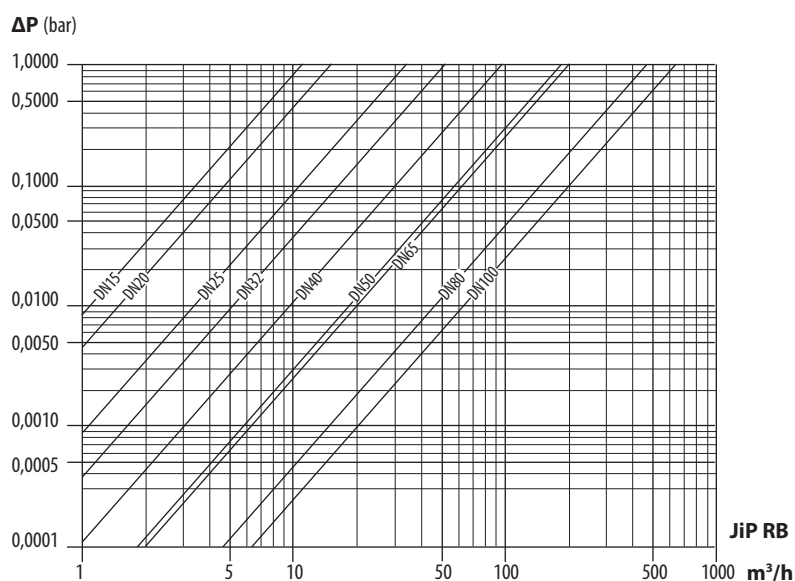

Pressure/temperature diagram

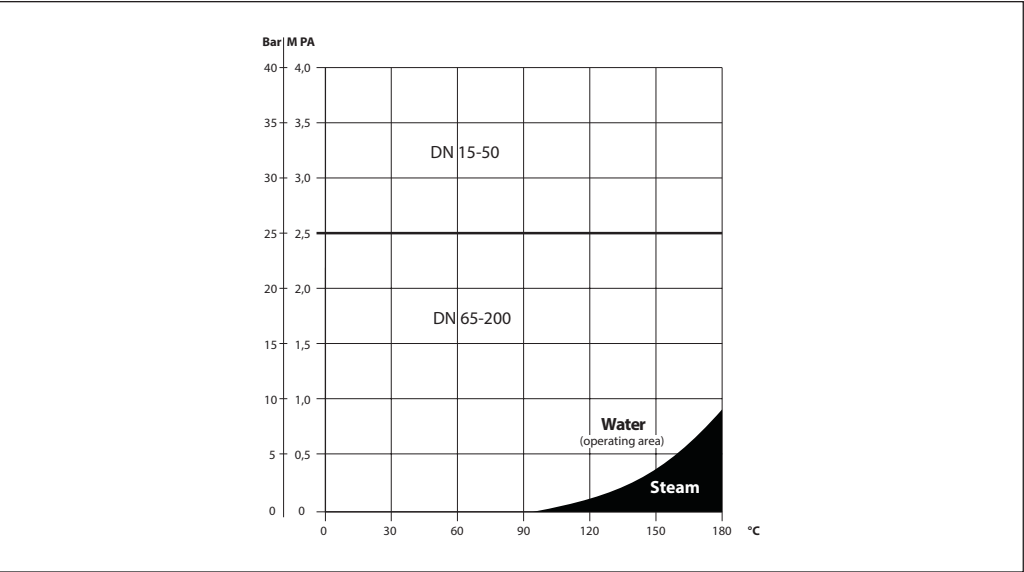

Dimensions
JIP hot tap

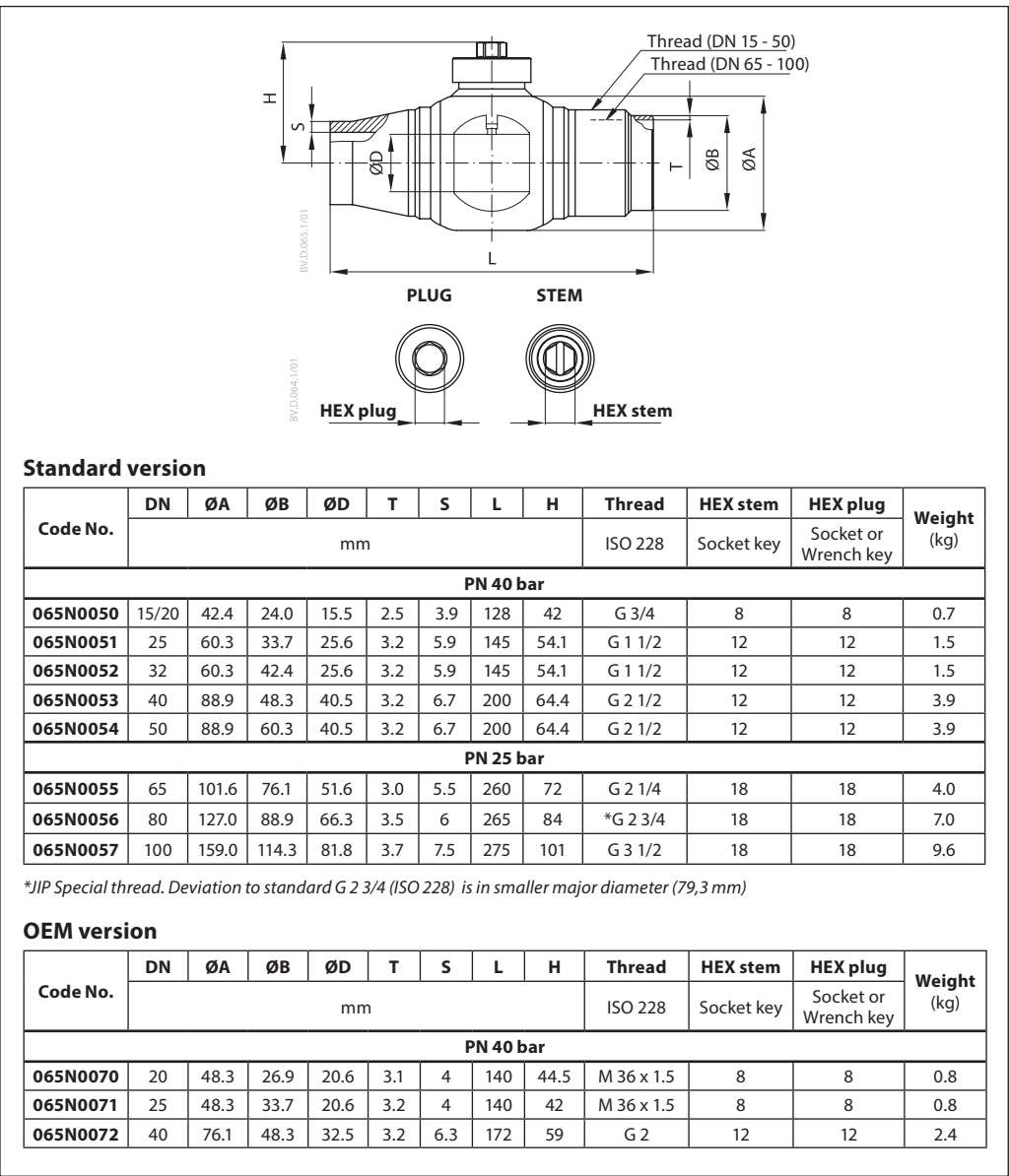



Danfoss A/S

Climate Solutions • danfoss.com • +45 7488 2222

Any information, including, but not limited to information on selection of product, its application or use, product design, weight, dimensions, capacity or any other technical data in product manuals, catalogues descriptions, advertisements, etc. and whether made available in writing, orally, electronically, online or via download, shall be considered informative, and is only binding if and to the extent, explicit reference is made in a quotation or order confirmation. Danfoss cannot accept any responsibility for possible errors in catalogues, brochures, videos and other material. Danfoss reserves the right to alter its products without notice. This also applies to products ordered but not delivered provided that such alterations can be made without changes to form, fit or function of the product.

All trademarks in this material are property of Danfoss A/S or Danfoss group companies. Danfoss and the Danfoss logo are trademarks of Danfoss A/S. All rights reserved.