

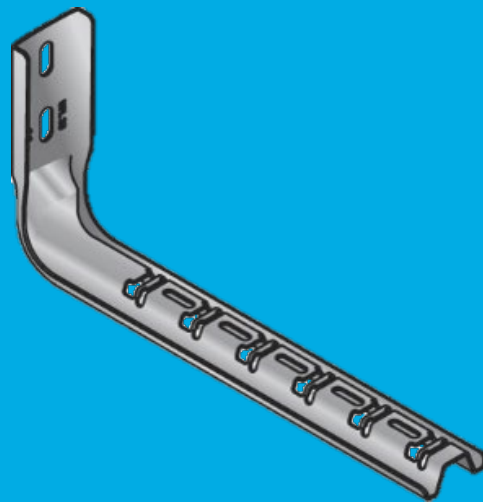



NIEDAX

GAMME S100U



- La gamme S100U UFL est un système universel pour chemins de câbles en tôle et en fil
- Fixation sans boulons pour les chemins de câbles en fil
- Fixation murale ou plafond directe
- Fixation des consoles sur rail **S100U** ou **STRUT 41**
- Breveté

RAILS S100U AU METRE

		Désignation	Code	Masse kg/ml	Ep. mm
SZ	1	S100U 1M SZ	747107	1.190	2.00
	2	S100U 2M SZ	747110	1.190	2.00
	3	S100U 3M SZ	747111	1.190	2.00



SZ: acier galvanisé à chaud avant fabrication en continu selon NF EN 10 346 (S220 GD/Z).

RAILS S100U A LA PIECE

		Désignation	Code	Masse kg/p	Ep. mm
SZ	1	S100U 200 SZ	747101	0.230	2.00
	1	S100U 250 SZ	747102	0.280	2.00
	1	S100U 350 SZ	747103	0.390	2.00
	1	S100U 450 SZ	747104	0.490	2.00
	1	S100U 550 SZ	747105	0.610	2.00
	1	S100U 650 SZ	747106	0.750	2.00

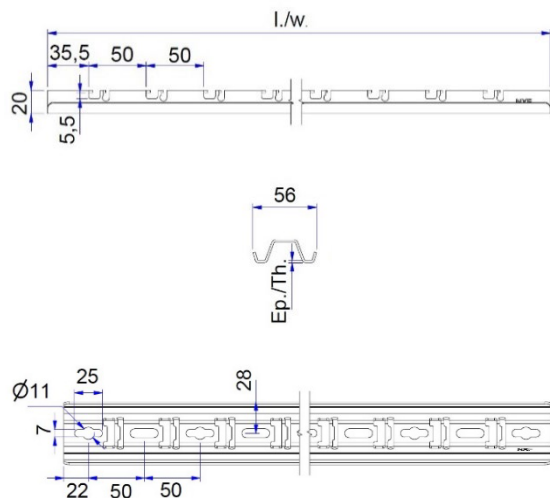
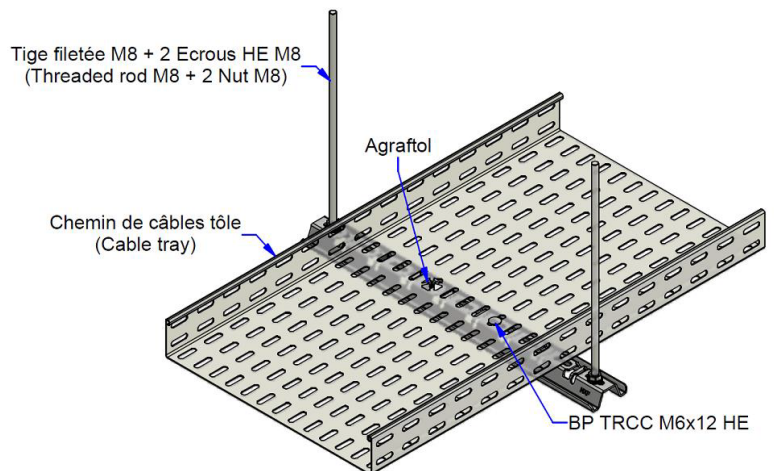
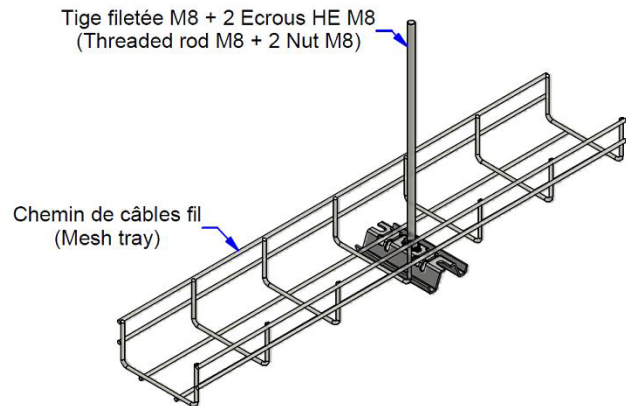

BALANCELLES S100U

		Désignation	Code	Masse kg/p	Ep. mm	L. mm
SZ	10	BALANCELLE S100U 100 SZ	747201	0.260	2.00	204
	10	BALANCELLE S100U 150 SZ	747202	0.320	2.00	254
	10	BALANCELLE S100U 200 SZ	747203	0.380	2.00	304
	10	BALANCELLE S100U 300 SZ	747204	0.500	2.00	404
	10	BALANCELLE S100U 400 SZ	747205	0.620	2.00	504
	10	BALANCELLE S100U 500 SZ	747206	0.740	2.00	604
	10	BALANCELLE S100U 600 SZ	747207	0.860	2.00	704

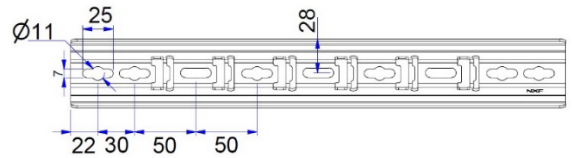
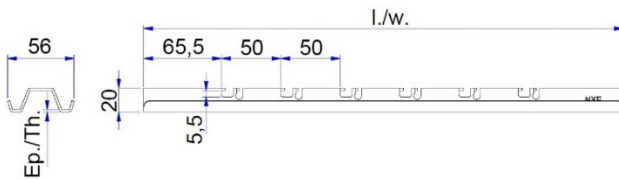
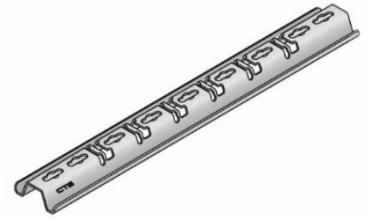

Tige filetée M8 + 2 Ecrous HE M8
(Threaded rod M8 + 2 Nut M8)

Chemin de câbles fil
(Mesh tray)

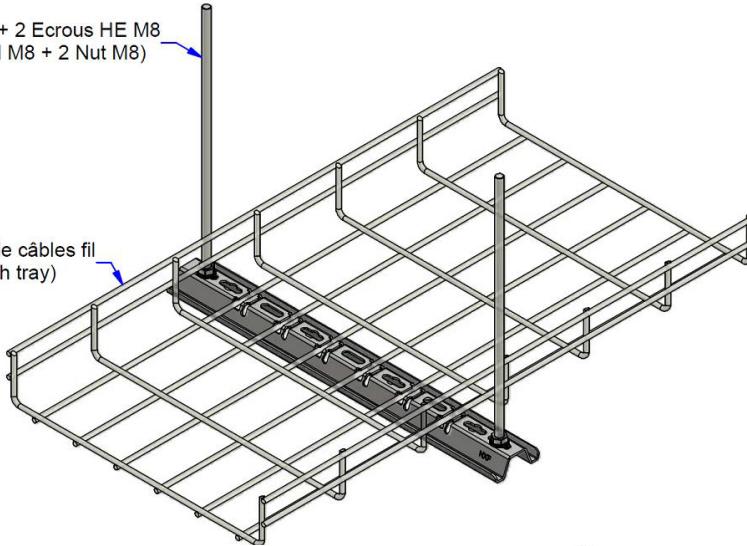

Tige filetée M8 + 2 Ecrous HE M8
(Threaded rod M8 + 2 Nut M8)

Chemin de câbles tôle
(Cable tray)

Agrafitol

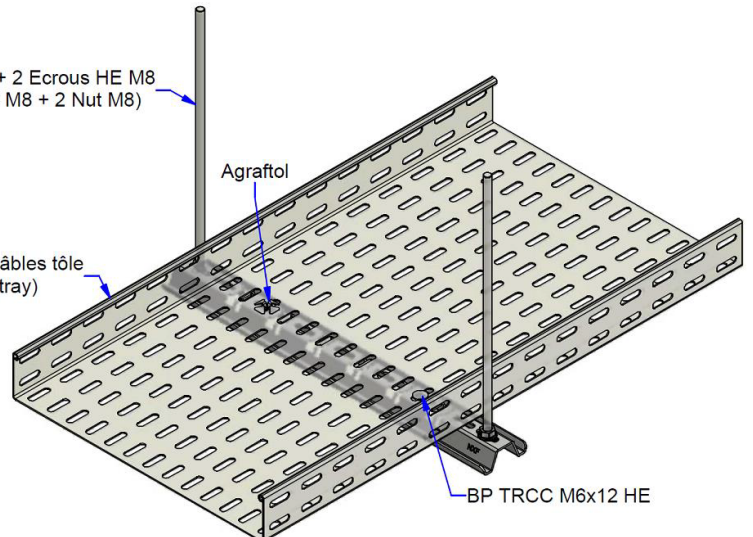

BP TRCC M6x12 HE

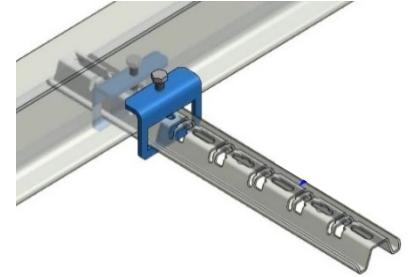
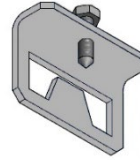
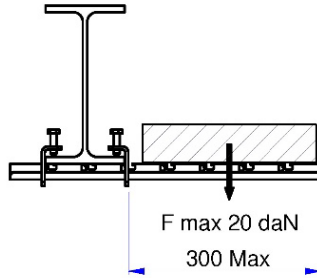

CRAPAUD S100U

	 p	Désignation	Code	Masse kg/p	Ep. mm
SZ	50	CRAPAUD S100U SZ	677790	0.133	4.00

CONSOLES UFL

	 p	Désignation	Code	Masse kg/p	Ep. mm	H. mm	l. mm	L. mm	 daN
SZ	20	UFL-10 SZ	747001	0.320	2.00	120	100	165	130
	20	UFL-15 SZ	747002	0.380	2.00	120	150	215	108
	20	UFL-20 SZ	747003	0.430	2.00	120	200	265	86
	20	UFL-25 SZ	747004	0.560	2.00	170	250	315	75
	20	UFL-30 SZ	747005	0.600	2.00	170	300	365	64

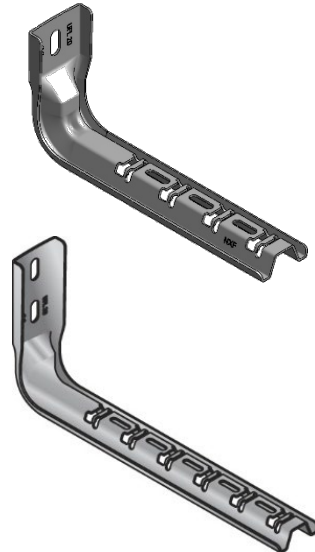

- Pour montage mural, sur **rail S100U** ou sur **rail STRUT 41**
- Fixation des dalles perforées par **TRCC M6x12** (EZ 648001) ou **AGRAFTOL** (555160)
- Verrouillage du **chemin de câbles fil** à l'aide d'un **tournevis**
- l.mm : largeur admissible du chemin de câbles ou longueur utile de la console

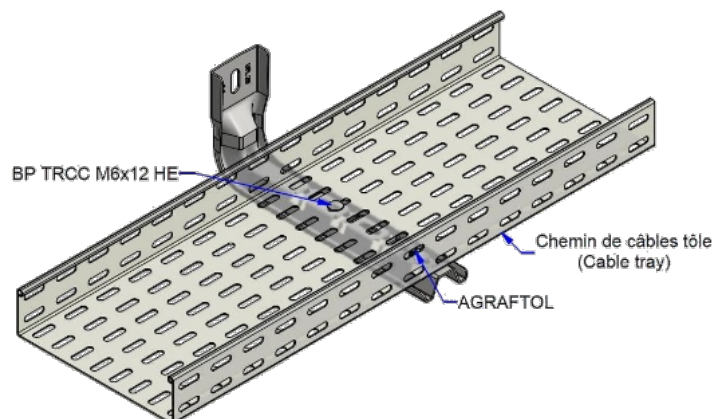
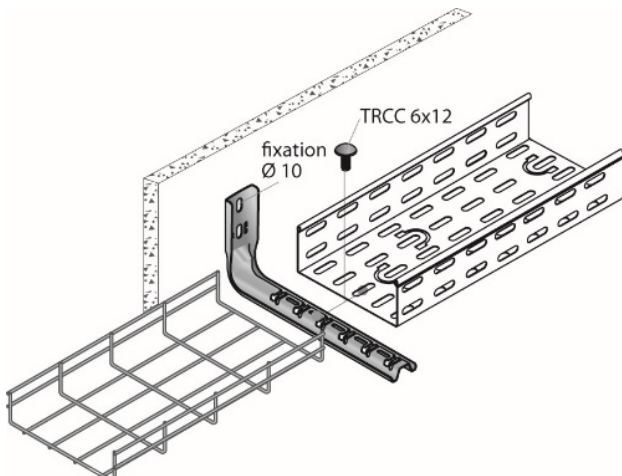
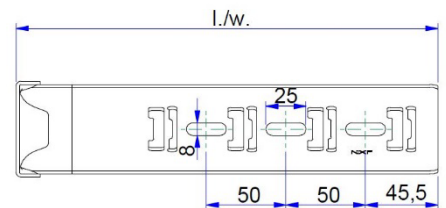
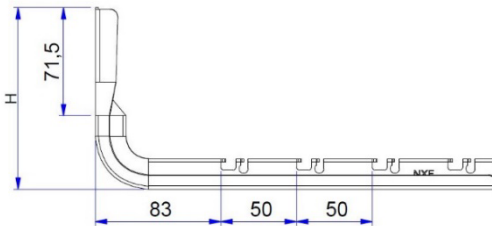
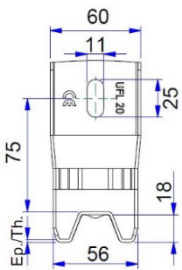



CLAME S100U

	 p	Désignation	Code	Masse kg/p
SZ	50	CLAME S100U SZ	552113	0.018

Recommandée pour des montages de :

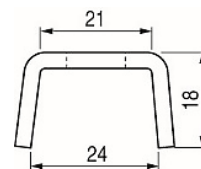
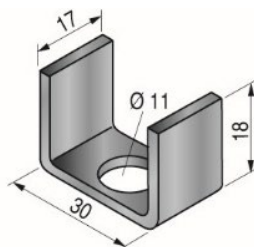
- **Rails S100U** au sol ou mural
- **Consoles UFL** en dos de pendentif



CONSOLES UFLP

	 p	Désignation	Code	Masse kg/p	Ep. mm	H. mm	l. mm	L. mm	 daN
SZ	20	UFLP-10 SZ	747030	0.310	2.00	120	100	165	130
	20	UFLP-15 SZ	747031	0.370	2.00	120	150	215	108
	20	UFLP-20 SZ	747032	0.460	2.00	120	200	265	86
	20	UFLP-25 SZ	747033	0.550	2.00	170	250	315	75
	20	UFLP-30 SZ	747034	0.600	2.00	170	300	365	64

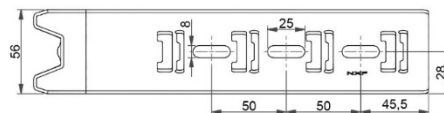
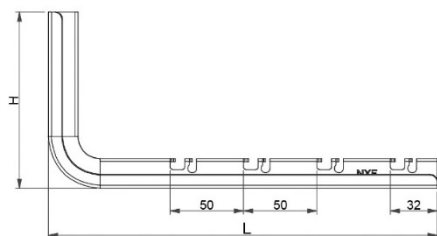
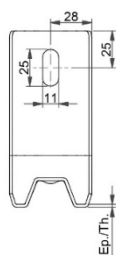
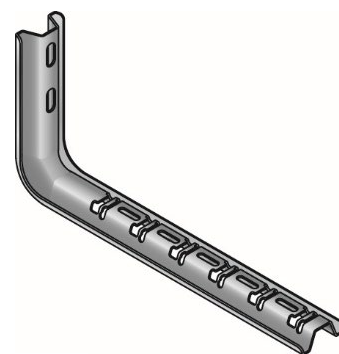
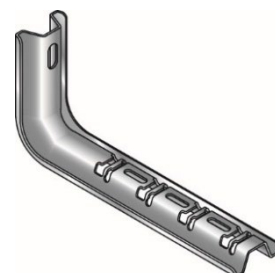
- Pour montage direct sans clame sur Pendentif ou **Rail S100U**
- Fixation des dalles perforées par **TRCC M6x12** (EZ 648001) ou **AGRAFTOL** (555160)
- Verrouillage du chemin de câbles fil à l'aide d'un tournevis
- l.mm : largeur admissible du chemin de câbles ou longueur utile de la console
- L.mm : longueur totale de la console

CONTREVENTEMENT UFCO

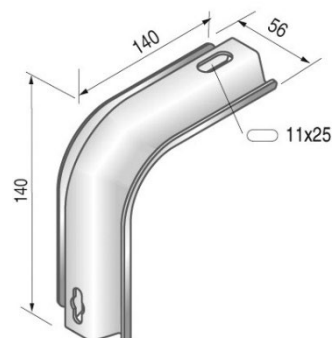
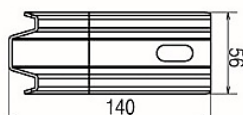
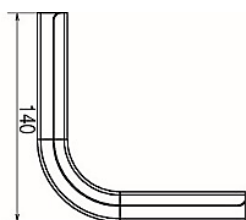
	 p	Désignation	Code	Masse kg/p	Ep. mm	H. mm	L. mm
SZ	20	UFCO SZ	747040	0.320	2.00	140	140



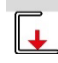

PENDARDS UFL

	 p	Désignation	Code	Masse kg/p	Ep. mm	l. mm	L. mm	 daN/m
SZ	20	UFL-40 SZ	747006	0.710	2.00	400	465	50
	20	UFL-50 SZ	747007	0.860	2.00	500	565	40
	20	UFL-60 SZ	747008	0.950	2.00	600	665	30

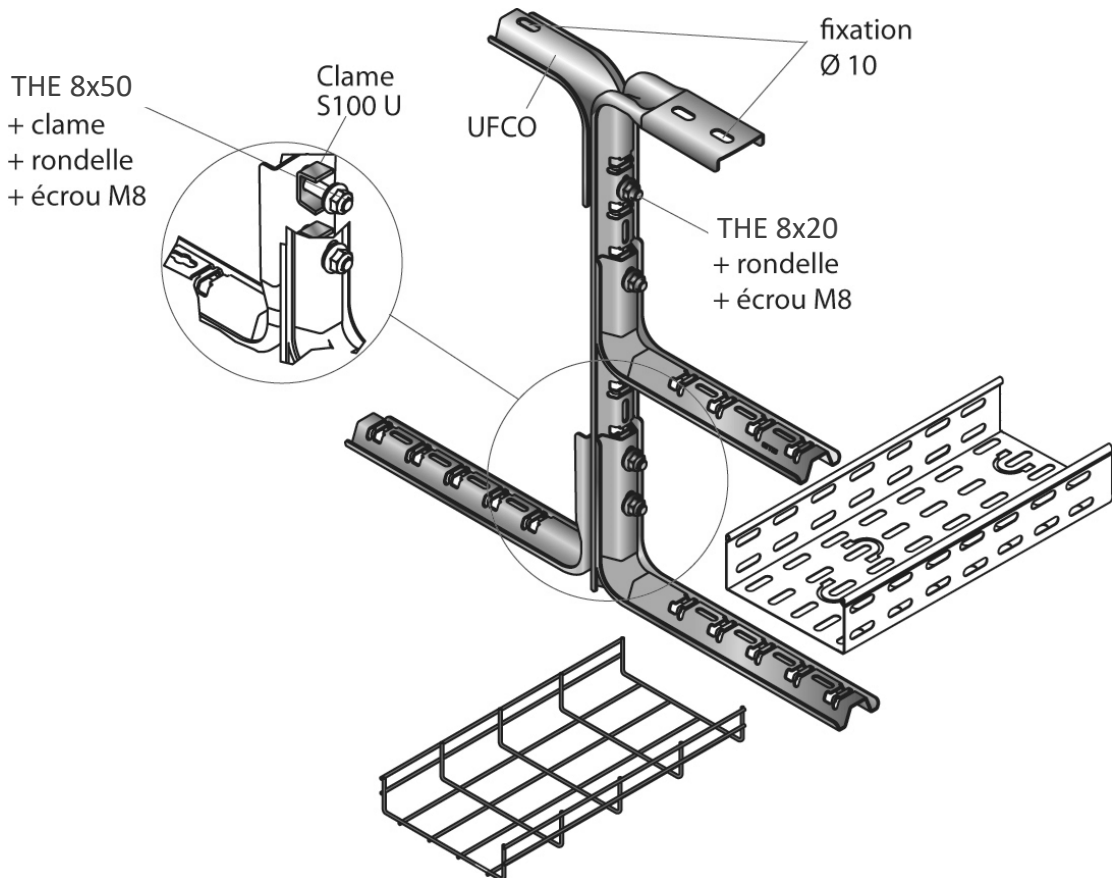
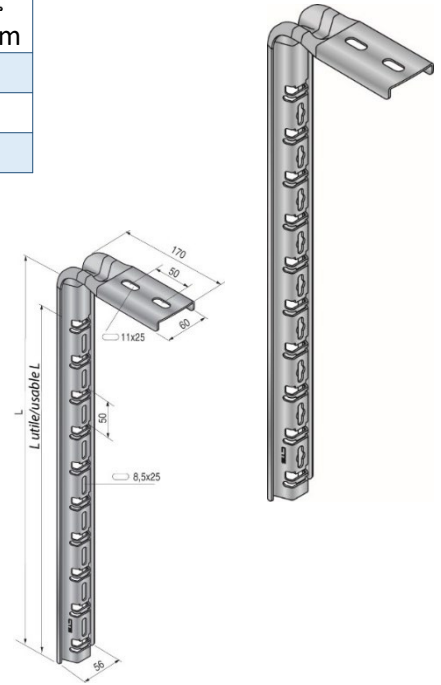
- l.mm : longueur utile du pendard
- L.mm : longueur totale du pendard



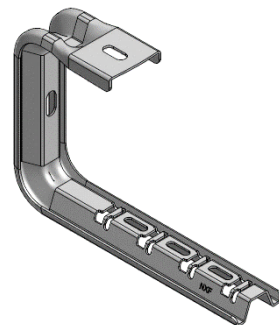

SUPPORTS UFC – HAUTEUR 185

		p	Désignation	Code	Masse kg/p	Ep. mm	l. mm	L. mm	
									daN/m
SZ	20	UFC-10	120x185x100 SZ	747010	0.530	2.00	100	165	122
	20	UFC-15	120x185x150 SZ	747011	0.600	2.00	150	215	100
	20	UFC-20	120x185x200 SZ	747012	0.670	2.00	200	265	81
	20	UFC-25	120x185x250 SZ	747013	0.800	2.00	250	315	65
	20	UFC-30	120x185x300 SZ	747014	0.850	2.00	300	365	50
	20	UFC-40	120x185x400 SZ	747015	0.960	2.00	400	465	40

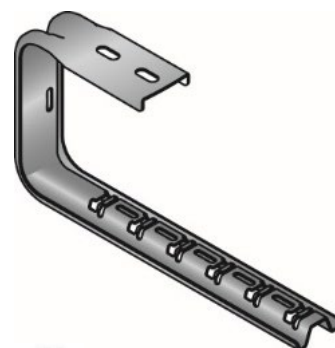
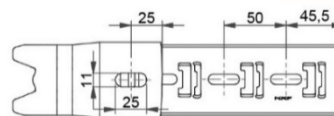
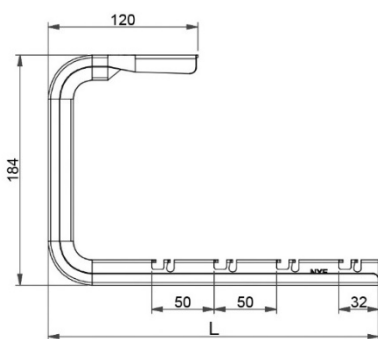
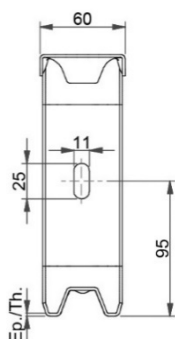

- Fixation des dalles perforées par **TRCC M6x12** (EZ 648001) ou **AGRAFTOL** (555160)
- l.mm : largeur admissible du chemin de câbles ou longueur utile de la console
- L.mm : longueur totale de la console

SUPPORTS UFCC – HAUTEUR 185

		p	Désignation	Code	Masse kg/p	Ep. mm	l. mm	L. mm	
									daN/m
SZ	20	UFCC-10	120x135x100 SZ	747016	0.480	2.00	100	165	122
	20	UFCC-15	120x135x150 SZ	747017	0.530	2.00	150	215	100
	20	UFCC-20	120x135x200 SZ	747018	0.590	2.00	200	265	81
	20	UFCC-25	170x135x250 SZ	747019	0.710	2.00	250	315	65
	20	UFCC-30	170x135x300 SZ	747020	0.770	2.00	300	365	50
	20	UFCC-40	170x135x400 SZ	747021	0.880	2.00	400	465	40

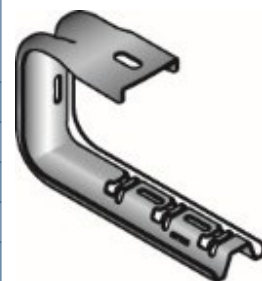

- Fixation des dalles perforées par **TRCC M6x12** (EZ 648001) ou **AGRAFTOL** (555160)
- l.mm : largeur admissible du chemin de câbles ou longueur utile de la console
- L.mm : longueur totale de la console

