

PANELS

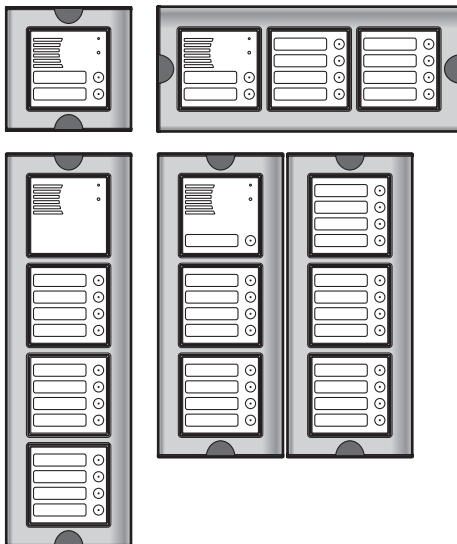

DOOR PHONE SYSTEMS



VIDEO DOOR PHONE SYSTEMS

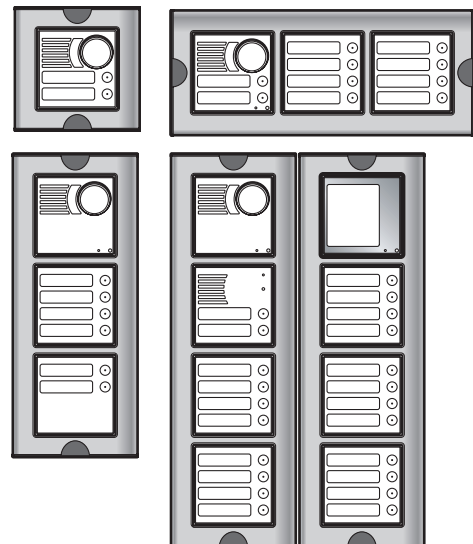

Download from:
www.urmetdomus.com
Technical Manuals area
MT101-013_sec.2a.pdf

	Section	Pag.
SINTHESI PANELS		
SINTHESI PANELS		
ELECTRICAL AND MECHANICAL SPECIFICATIONS	2a	3
CONFIGURATION	2a	3
TECHNICAL SPECIFICATIONS OF THE MODULES	2a	3
DOOR UNIT SET-UP MODULES	2a	3
Door units	2a	4
BUTTON MODULES	2a	5
Call button contact separation	2a	5
Name tag light	2a	5
Name tag replacement	2a	6
SPECIAL MODULES.....	2a	6
REPERTORY MODULES Ref. 1145/50	2a	6
BLANK MODULES Ref. 1145/59	2a	6
SINTHESI CAMERA UNIT MODULES	2a	6
Technical specifications.....	2a	6
Coax camera unit	2a	6
FLUSH-MOUNTING BOXES.....	2a	9
JOINING FLUSH-MOUNTING BOXES	2a	10
FRAMES AND MODULE HOLDERS	2a	10
Module holder installation	2a	10
Frame installation	2a	10
Horizontal holder and frame installation	2a	11
FLUSH-MOUNTED PANEL ACCESSORIES.....	2a	11
Wall cover frame.....	2a	11
Rain hood with wall cover frame.....	2a	12
WALL-MOUNTED PANEL ACCESSORIES.....	2a	13
Case and hood with frame and module holder	2a	13
GATE SEMI-FLUSHED PANEL ACCESSORIES	2a	14
Case and hood for semi-flushed gate installation with frame and module holder	2a	14
Gate pillar installation	2a	14
CONVERSATION PRIVACY DEVICE FOR "1+1" WIRE SYSTEMS Ref. 1145/74	2a	15
Conversation privacy device insertion	2a	15
CONVERSATION PRIVACY DEVICE FOR "4+n" WIRE SYSTEMS Ref. 5330/60	2a	15
SINTHESI PANEL INSTALLATION.....	2a	15
Flush-mounted version	2a	15
DIMENSIONS.....	2a	18
4+n WIRE DOOR PHONE SYSTEMS - EXAMPLES OF MODULAR CONSTRUCTIONS WITH VARIOUS CAPACITIES.....	2a	19
1+1 WIRE DOOR PHONE SYSTEMS - EXAMPLES OF MODULAR CONSTRUCTIONS WITH VARIOUS CAPACITIES.....	2a	25
B&W COAX VIDEO DOOR PHONE SYSTEMS - EXAMPLES OF MODULAR CONSTRUCTIONS WITH VARIOUS CAPACITIES ..2a	2a	30
B&W 5-WIRE VIDEO DOOR PHONE SYSTEMS - EXAMPLES OF MODULAR CONSTRUCTIONS WITH VARIOUS CAPACITIES ..2a	2a	36
COLOUR COAX VIDEO DOOR PHONE SYSTEMS - EXAMPLES OF MODULAR CONSTRUCTIONS WITH VARIOUS CAPACITIES ..2a	2a	42
COLOUR CAMERA 5-WIRE SYSTEMS - EXAMPLES OF MODULAR CONSTRUCTIONS WITH VARIOUS CAPACITIES	2a	49

SINTHESI PANELS

The module consists of anodised aluminium profile modular elements which can be fitted in specific frames.

The innovative feature of this system consists in the possibility of vertical or horizontal installation. Furthermore, the flush-mounting boxes can be coupled by means of shims to create various panel types and configurations with a small number of components. The advantage of needing to stock fewer components is relevant for both wholesalers and installers.

Module installation is simple thanks to the pre-wired connections on the modules and system terminal boards on extractable carriages.

Sinthesi panels may be used in the following system types:

- 4+n wire door phone systems;
- 1+1 wire door phone systems;
- B&W and colour coax video door phone systems;
- B&W and colour 5-wire video door phone systems.

ELECTRICAL AND MECHANICAL SPECIFICATIONS

Front width of one row with frame: **125 mm**
 Front projection from wall: **0.8 mm**
 Flush mounting box depth: **45 mm**

Front module finish: **anodised aluminium**
 Urmet brand: **on module holder frame**

Button body: **Ø 10.5 mm**
 Total button stroke: **3 mm**
 Idle button stroke: **1 mm**
 Isolation voltage between contacts: **50 V eff**
 Max. button cut-off current: **2 A eff**

Name tag dimensions:

with single button: **67 x 12.5 mm**
 Tag and button light: **LED**
 Tag protection: **self-extinguishing polycarbonate**
 Max. wire cross-section area for button and light terminals: **1.5 mm²**
 Degree of protection: **IP42 as per CEI 70.1 standard**
 Corrosion: **as per DIN 5342/64 standard**
 Test duration: **16 hours**
 Test temperature range: **35°C**

CONFIGURATION

The following installations are possible:

- **flush-mounting**
- **wall-mounting**

The system consists of the following parts:

- **modules**
- **flush-mounting box with fairleads**
- **module holder and frame**
- **accessories**

TECHNICAL SPECIFICATIONS OF THE MODULES

Assemble the various modules by fitting them in the specific columns in the module holders.

The following module versions are available:

- **Door unit set-up**
- **With buttons only**
- **Special (blank or repertory)**
- **With camera**

The modules have a natural anodised aluminium front panel.

Each module may be clipped onto the module holder for perfect alignment with the outer frame without the need for screws or tools. The buttons and name tags are backlit by LED in modules with call buttons.

The Sinthesi includes both single and double modules. Module dimensions are:

Single module: 90 x 90 mm

Double module: 90 x 180 mm (5-wire video door phone systems only)

The front part can be opened in all modules to facilitate operations. The frame must be removed for this purpose.

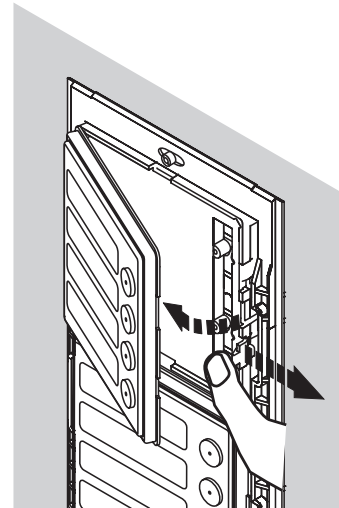

DOOR UNIT SET-UP MODULES

The following configurations of door unit set-up modules (i.e. modules without voice signal processing device) are available:

- without call buttons **Ref. 1145/20**
- with call buttons **Ref. 1145/21**
- with 2 call buttons (*) **Ref. 1145/22**
- with 1 double call button **Ref. 1145/32**
- with 2 double call buttons (*) **Ref. 1145/34**

(*) for use in 4+n wire door phone systems and coax video door phone systems only.

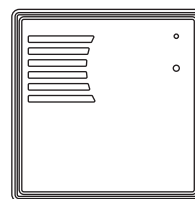

Ref. 1145/20

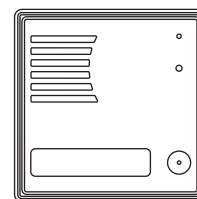

Ref. 1145/21

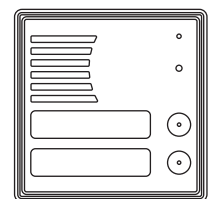

Ref. 1145/22

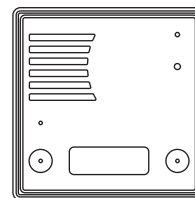

Ref. 1145/32

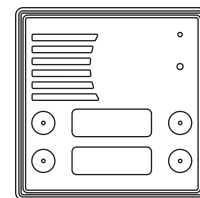

Ref. 1145/34

DESCRIPTION OF TERMINALS

Models Ref. 1145/21 - Ref. 1145/22

- ⊖ ~12 } Name tag lighting LED power
- ⊖ ~0 }
- ⊖ U2 Call button 2 (Ref. 1145/22 only)
- ⊖ U1 Call button
- ⊖ G/T Call button common
- ⊖ G/T2 Call button contact 2 (Ref. 1145/22 only)

Models Ref. 1145/32 - Ref. 1145/34

<input type="checkbox"/>	U1	} Call buttons
<input type="checkbox"/>	U2	
<input type="checkbox"/>	U3	} Call buttons (Ref. 1145/34 only)
<input type="checkbox"/>	U4	
<input type="checkbox"/>	G/T	Call button common
<input type="checkbox"/>	~12	} Name tag lighting LED power
<input type="checkbox"/>	~0	

Note: obviously, module Ref. 1145/20 is without terminals because it contains no electrical devices.

DOOR UNITS

DOOR UNIT FOR "4+N" WIRE SYSTEMS Ref. 1145/500

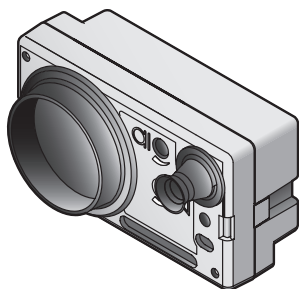

The amplified door unit Ref. 1145/500 is commonly fitted in Synthesi modular panels in 4+n door phone systems, coax video door phone systems with colour camera or retrofitted systems with Kombi camera.

User call feedback is provided on the door unit by means of a LED: the LED lights up on the door unit set-up panel only if the door phone or video door phone has picked up the call.

The Ref. 1145/500 device is clipped onto the back on the module by means of specific clips. No tools are required for this operation. The door unit occupies the space of two buttons (half a module). Consequently, Ref. 1145/500 can be fitted in:

- door unit set-up module without buttons **Ref. 1145/20**
- door unit set-up module with 1 single button **Ref. 1145/21**
- door unit set-up module with 2 single buttons **Ref. 1145/22**
- door unit set-up module with 1 double button **Ref. 1145/32**
- door unit set-up module with 2 double buttons **Ref. 1145/34**

DESCRIPTION OF TERMINALS

<input type="checkbox"/>	1 A	Electronic voice out (from speaker to door phone)
<input type="checkbox"/>	1	Traditional voice out (from speaker to door phone)
<input type="checkbox"/>	+	Door unit power positive
<input type="checkbox"/>	2	Voice in (from microphone to door phone)
<input type="checkbox"/>	L	Call feedback LED in (connect to panel button common)
<input type="checkbox"/>	-	Door unit power negative

IMPORTANT

Terminal "L" for call feedback cannot be used when the door unit is fitted in traditional call buttons (12V ~ on buzzer).

Note: use terminal "1A" in systems with Mod. 1131, 1132 and 1133 (Atlantico) door phones and terminal "1" for Mod. 1130 door phones.

DOOR UNIT FOR "1+1" WIRE SYSTEMS Ref. 1145/67

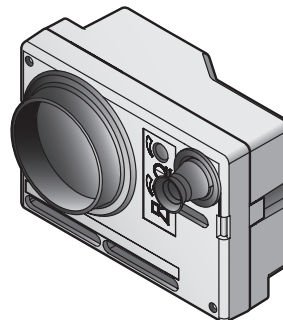

Fit door unit Ref. 1145/67 in the panel for speak-and-listen service in "1+1" wire door phone systems.

The Ref. 1145/67 device is clipped onto the back on the module by means of specific clips. No tools are required for this operation. The door unit occupies the space of three buttons (3/4th of a module). Consequently, Ref. 1145/67 only can be fitted in:

- door unit set-up module without buttons **Ref. 1145/20**
- door unit set-up module with 1 single button **Ref. 1145/21**
- door unit set-up module with 1 double button **Ref. 1145/32**

DESCRIPTION OF TERMINALS

<input type="checkbox"/>	PS	Tone generator output
<input type="checkbox"/>	1/~	Door unit power earth
<input type="checkbox"/>	5	(Electrical lock emergency relay control)
<input type="checkbox"/>	~	Door unit power
<input type="checkbox"/>	3	Call buzzer for 1130 door phones
<input type="checkbox"/>	2	Electrical lock control
<input type="checkbox"/>	SN	Video power on control signal
<input type="checkbox"/>	F	Voice
<input type="checkbox"/>	1	Conversation privacy device earth
<input type="checkbox"/>	C1	Conversation privacy button 1
<input type="checkbox"/>	4	Conversation privacy device power
<input type="checkbox"/>	C2	Conversation privacy button 2

AMPLIFICATION REGULATION

All door units have two integrated circuits for external and internal amplification and an electret microphone (transmitting unit). Amplification in the two directions may be adjusted by means of two potentiometers which can be accessed after removing the extractable front panel.

Transmission levels are calibrated at the factory. For this reason, they should only be adjusted when absolutely necessary (e.g. to eliminate Larsen feedback). In these cases, turn the volume adjustment potentiometer outwards to avoid worsening acoustic balance.

To adjust external volume:

- turn the potentiometer shown clockwise to turn the volume up and anticlockwise to turn it down (⌚).

To adjust internal volume:

- turn the potentiometer shown clockwise to turn the volume up and anticlockwise to turn it down (⌚).

BUTTON MODULES

The following module versions are available:

- with 1 button

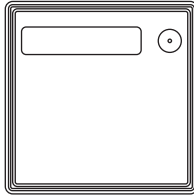

Ref. 1145/11

- with 2 buttons

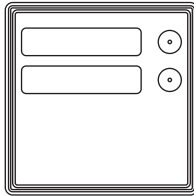

Ref. 1145/12

- with 3 buttons

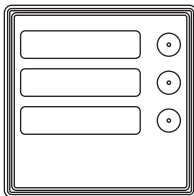

Ref. 1145/13

- with 4 buttons

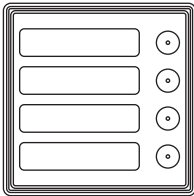

Ref. 1145/14

- with 4 double buttons

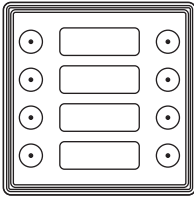

Ref. 1145/18

DESCRIPTION OF TERMINALS

Models Ref. 1145/11, Ref. 1145/12, Ref. 1145/13 and Ref. 1145/14

	~12 } Button and name tag light LED power
	~ 0 }
	U4 Call button 4 (Ref. 1145/14 only)
	U3 Call button 3 (Ref. 1145/13 and Ref. 1145/14 only)
	U2 Call button 2 (Ref. 1145/12, Ref. 1145/13 and Ref. 1145/14 only)
	U1 Call button 1
	G/T Call button common
	G/T2 Button contact 2 (°)
	G/T3 Button contact 3 (°)
	G/T4 Button contact 4 (°)

(°) these terminals are usually short-circuited and may be separated by the installer.

Models Ref. 1145/18

	~12 } Button and name tag light LED power
	~ 0 }
	U8 Call button 8
	U7 Call button 7
	U6 Call button 6
	U5 Call button 5
	U4 Call button 4
	U3 Call button 3
	U2 Call button 2
	U1 Call button 1
	G/T Call button common

CALL BUTTON CONTACT SEPARATION

Proceed as shown below to separate the G/T common contacts in button modules Ref. 1145/12, Ref. 1145/13 and Ref. 1145/14 and in door unit module Ref. 1145/22:

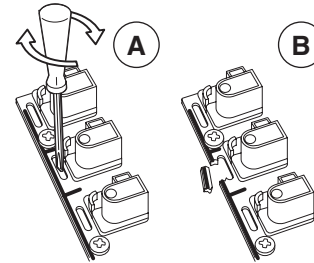

Either groups or buttons or single buttons may be isolated according to the point where the contacts are separated (dotted X in the drawings). Use the specific terminals according to the separation employed to connect the buttons.

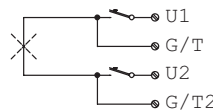

Module with door unit set-up and 2 buttons (Ref. 1145/22)

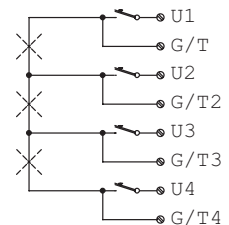

Button modules (Ref. 1145/12-13-14)

Modules with 2 and 3 buttons (Ref. 1145/12 and Ref. 1145/13) will be equipped only with the terminals referred to the buttons on the device. The button separation and connection methods are the same in all cases.

NAME TAG LIGHT

Name tag light bulb uptake is shown in the following table:

Ref.	Description	Power [W]
1145/11	Module with 1 button	1
1145/12	Module with 2 buttons	1
1145/13	Module with 3 buttons	2
1145/14	Module with 4 buttons	2
1145/21	Door unit module with 1 button	1
1145/22	Door unit module with 2 buttons	1
1145/50	Repertory/house number module	2
1745/21	50 Hz camera module with door unit and 1 button (B&W, 5 wires)	1
1745/22	50 Hz camera module with door unit and 2 buttons (B&W, 5 wires)	1
1745/81	50 Hz camera module with door unit and 1 button (B&W, coax)	1
1745/82	50 Hz camera module with door unit and 2 buttons (B&W, coax)	1

NAME TAG REPLACEMENT

There are different types of name tags:

- white: for provisional writing with a felt-tip pen (standard)
- anthracite: for engraving (standard)
- red: for staircase light button (door unit set-up modules only)
- blue: for panel customisation (optional: Ref. 1145/65 consists of blue name tags and frame headers).



Note: The engraving side is marked by the letter **A** on anthracite name tags.

Proceed as follows to insert the name tags in the specific housing:

- 1) Remove the frame (if installed) and remove the extractable front.
- 2) Fit the name tags.
- 3) Reposition the extractable front.

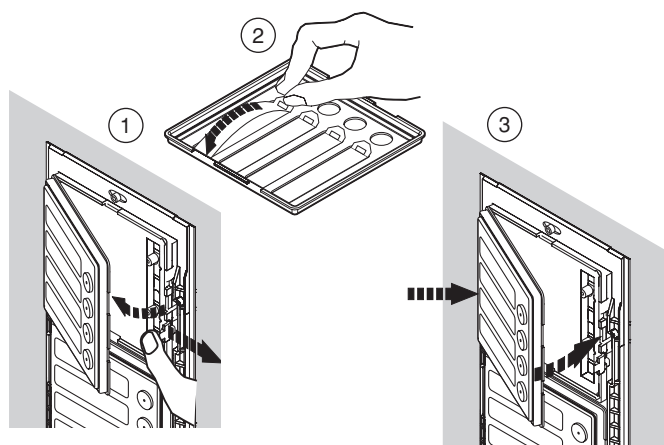

SPECIAL MODULES

There are two types of special modules:

- **repertory modules** Ref. 1145/50
- **blank modules** Ref. 1145/59

REPERTORY MODULES Ref. 1145/50

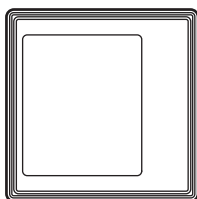

Repertory modules are normally used to indicate the house number or contain other information.

Power terminals ~0 and ~12 to light the unit via LEDs.

The procedure for fitting repertory tags is the same as that for the name tags.

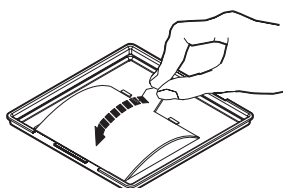

BLANK MODULES Ref. 1145/59

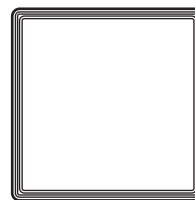

This module is used to fill in spaces which are not used in modular applications as required. The same module can be used for other applications, e.g. burglar alarms and automatic gates.

SINTHESI CAMERA UNIT MODULES

The following camera unit module versions are available:

- Coax system versions:**
- with door unit, B&W, without buttons Ref. 1745/80
 - with door unit, B&W, with 1 button Ref. 1745/81
 - with door unit, B&W, with 2 buttons Ref. 1745/82
 - without door unit, colour, without buttons Ref. 1745/40
 - without door unit, B&W, without buttons Ref. 1745/70
 - without door unit, B&W, without buttons 60 Hz Ref. 1745/79
- 5-wire system versions:**
- with door unit, B&W, without buttons Ref. 1745/20
 - with door unit, B&W, with 1 button Ref. 1745/21
 - with door unit, B&W, with 2 buttons Ref. 1745/22

TECHNICAL SPECIFICATIONS

- Power voltage: 18 Vdc
- Maximum uptake: 250 mAdc
- Image sensor: 1/3" CCD
- Lens: standard
- Shutter: standard
- Focus: fixed
- Minimum light for acceptable pictures: 0.2 lux
- Coax video output: 1 Vpp composite
- 5-wire video output: 1 Vpp differential
- Operating temperature range: from -10 to 50°C

COAX CAMERA UNIT

B&W CAMERA UNIT MODULE WITH DOOR UNIT

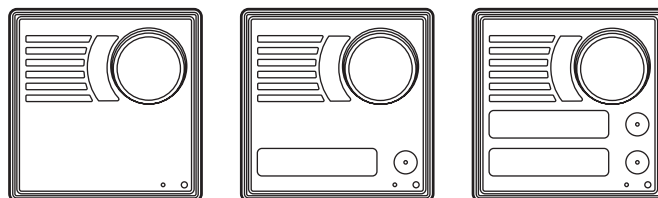

Ref. 1745/80

Ref. 1745/81

Ref. 1745/82

Camera units Ref. 1745/80/81/82 consist of a single Synthesi module with camera, built-in door unit and either 0, 1 or 2 call buttons. These devices provide complete coax video door phone panels for systems with up to two users in the space of a single module. Easy to fit and extract in the flush-mounting box, module features comprise:

- camera with built-in optics and shutter (fixed focus);
- possibility of adjusting camera lens vertically and horizontally;
- set of infrared LEDs for illuminating the subject;
- connection terminals;

- software and door unit;
- button and name tag lighting LEDs (where fitted).

DESCRIPTION OF TERMINALS

- ⊗ R1 Camera power negative
- ⊗ +TC Camera power positive
- ⊗ V3 Video signal
- ⊗ V5 Video signal earth
- ⊗ ~12 } Button and name tag lighting LED power
- ⊗ ~0 } (Ref. 1745/81-/82 versions only)
- ⊗ G/T } Call button common (°)
- ⊗ G/T2 }

- ⊗ U1 Column call button 1 (Ref. 1745/81-/82 only)
- ⊗ U2 Column call button 2 (Ref. 1745/82 only)
- ⊗ + Door unit power positive
- ⊗ L Call feedback LED input
- ⊗ 2 Voice in (from microphone to door phone)
- ⊗ - Door unit power negative
- ⊗ 1 Traditional voice out (from speaker to door phone)
- ⊗ 1A Electronic voice out (from speaker to door phone)

(°) normally short-circuited, can be separated by the installer.

B&W CAMERA UNIT MODULE WITHOUT DOOR UNIT

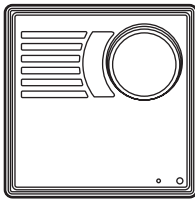

Particularly suitable for retrofitting old Kombi 825 systems. Two types of cameras without door unit are available:

- 50 Hz Ref. 1745/70
- 60 Hz (not available in Italy) Ref. 1745/79

Both models can be fitted in Sinthesi panels and are provided with:

- B&W camera, fixed focus, with built-in optics and shutter;
- possibility of adjusting lens direction;
- infrared LED subject illumination.

This module may also be used in 5-wire systems when a horizontal imaging development is required. Apply adapter Ref. 1742/13A to the camera in this case.

DESCRIPTION OF TERMINALS

- ⊗ R1 Camera power negative
- ⊗ +TC Camera power positive
- ⊗ V3/A Video signal
- ⊗ V5/B Video signal earth
- ⊗ T } Use with digital call module
- ⊗ R2 }

COLOUR CAMERA UNIT MODULE WITHOUT DOOR UNIT Ref. 1745/40

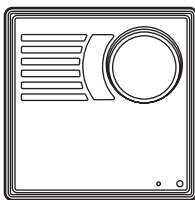

This camera may be fitted either in coax systems or in 5-wire systems with a Ref. 1742/13A adapter. The colour camera unit without door unit provides the modular features of the Sinthesi range.

DESCRIPTION OF TERMINALS

- ⊗ R1 Camera power negative
- ⊗ +TC Camera power positive
- ⊗ V3/A Video signal
- ⊗ V5/B Video signal earth
- ⊗ T } Use with digital call module
- ⊗ R2 }

IMAGING ANGLES

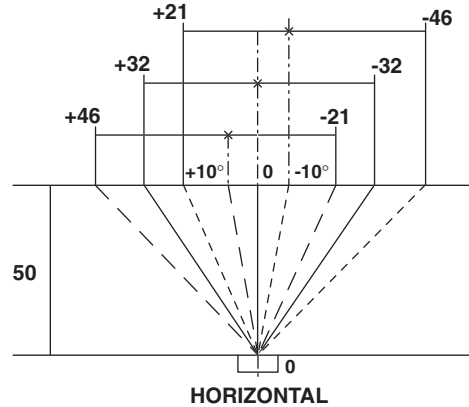

HORIZONTAL

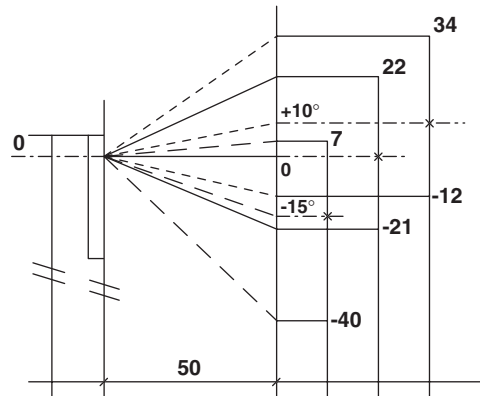

VERTICAL

Measurements in centimetres

Pivoting angles of the camera with respect to central position are:
 VERTICAL + 10 TO -15°
 HORIZONTAL + 10 TO -10°

CAMERA LENS DIRECTION ADJUSTMENT

After installation, the camera direction can be adjusted according to the position of the framed subject. This operation may be carried out manually after removing the frame and the extractable front by adjusting the jointed mount directly from the front. The frame does not need to be tipped and special tools are not required.

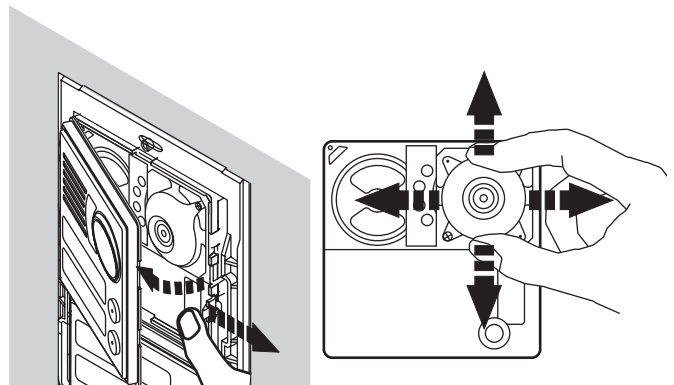

VOLUME ADJUSTMENTS (Models Ref. 1745/80 - Ref. 1745/81 - Ref. 1745/82 only)

Volume can be adjusted both ways (internal and external) by means of two potentiometers which can be accessed after opening the push-button panel frame in modules with door unit.

To adjust external volume:

- turn the EXT. potentiometer clockwise to turn the volume up and anticlockwise to turn it down.

To adjust internal volume:

- turn the INT. potentiometer clockwise to turn the volume up and anticlockwise to turn it down.

Transmission level calibration is optimal. You are advised to adjust the volume only if required to avoid disrupting the acoustic balance using the potentiometer which adjusts the external volume only.

5-WIRE CAMERA UNITS

B&W CAMERA UNIT MODULE WITH DOOR UNIT

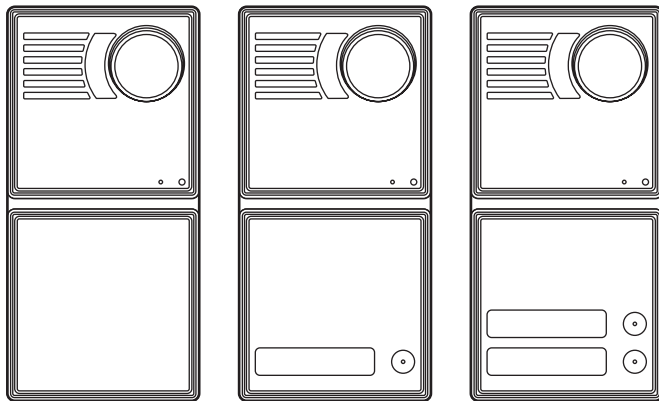

Ref. 1745/20

Ref. 1745/21

Ref. 1745/22

The following three models are available:

- Camera unit without buttons Ref. 1745/20
- Camera unit with 1 button Ref. 1745/21
- Camera unit with 2 buttons Ref. 1745/22

All models are fitted in a two-module Synthesi structure and are provided with:

- solid state CCD image sensor camera with fixed focus not interchangeable optics;
- possibility of adjusting camera lens direction;
- infrared LED subject illumination device;
- software and door unit;
- conversation privacy (for fitted call buttons only);
- name tag illumination LED (not including Ref. 1745/20).

These modules can be made for vertical configurations only.

DESCRIPTION OF TERMINALS

	C2	Call button (Ref. 1745/22 only)
	C1	Call button (Ref. 1745/21 and Ref. 1745/22 only)
	~	Door unit and name tag light power (where fitted)
	1/~	} Power earth
	1/~	
	4	Conversation privacy circuit connection
	F	Voice
	SN	Video power on control signal
	G/T	Call button common
	PS	Tone generator output
	B	Differential video signal output (positive)
	+TC	Camera power positive
	A	Differential video signal output (negative)
	R1	Camera power negative
	5	(electrical lock emergency relay control)
	SE	Electrical lock

IMAGING ANGLES

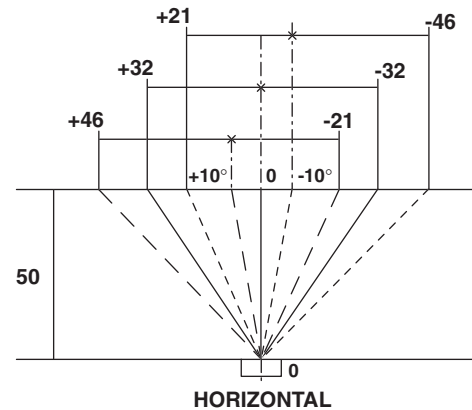

HORIZONTAL

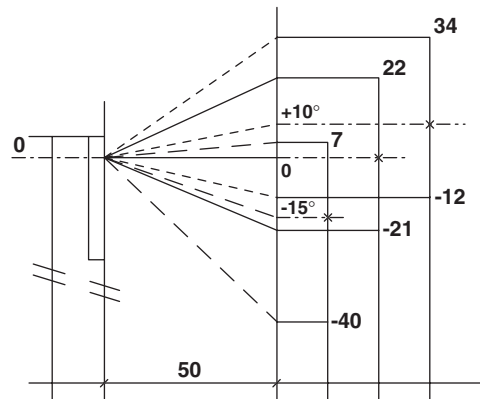

VERTICAL

Measurements in centimetres

Rocking angles of the camera with respect to central position are:
 VERTICAL +10 TO -15°
 HORIZONTAL +10 TO -10°

CONTROLS AND ADJUSTMENTS

Camera direction (A) and volume (B) can be adjusted as coax camera module models.

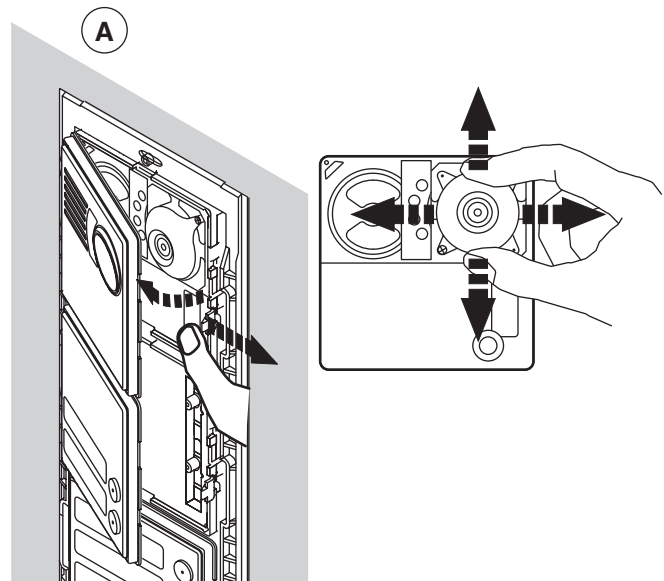

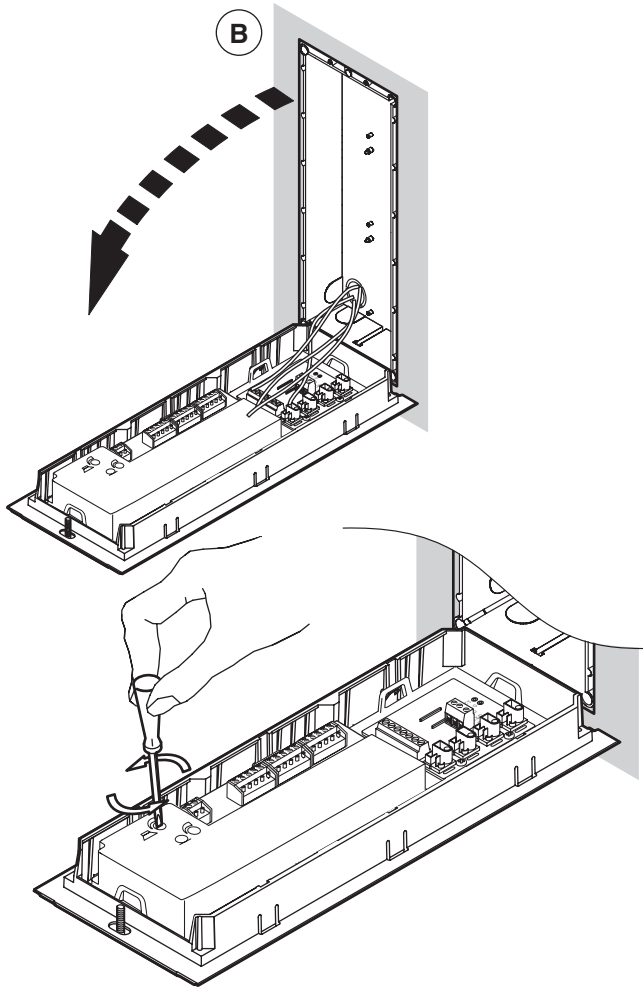

CAMERA ADAPTER Ref. 1742/13A

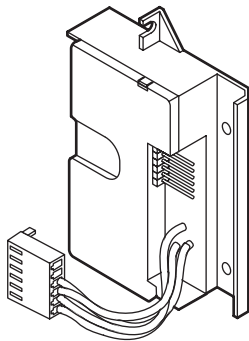

The camera adapter is required for installation in the following types of systems:

- "5-wire" system with colour camera;
- "5-wire" system with horizontal imaging unit development;
- "5-wire" system with 60 Hz camera (not available in Italy);
- Kombi Mod. 825 system retrofits;
- Bibus digital system.

The adapter Ref. 1742/13A must be used in combination with the following camera modules in the cases above:

- colour camera without door unit, without buttons **Ref. 1745/40**
- B&W camera without door unit, without buttons **Ref. 1745/70**
- B&W 60 Hz camera without door unit, without buttons (not available in Italy) **Ref. 1745/79**

The adapter transforms the composite video signal from the camera into two different video signals (A and B).

Adapter installation

1. Fit the adapter by the side of the camera module and fasten it with the screw (Fig. 1).
2. Remove connector A from the camera module (Fig. 2).
3. Plug connector A in the device socket and connector B in the camera socket (Fig. 3).
4. Position the wires inside the groove on the device.

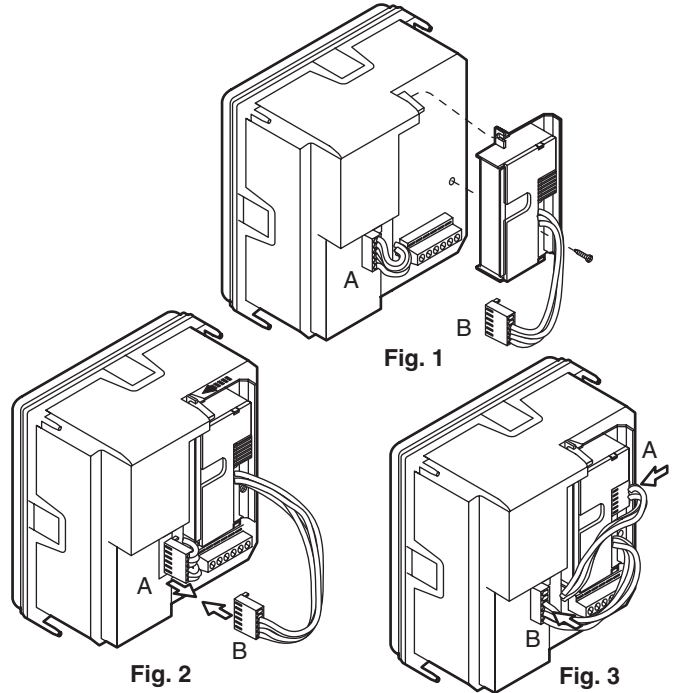

FLUSH-MOUNTING BOXES

For different versions of flush-mounting boxes for Sinthesi range products are provided according to the number of modules to be housed:

- for 1 module: **Ref. 1145/51**
- for 2 modules: **Ref. 1145/52**
- for 3 modules: **Ref. 1145/53**
- for 4 modules: **Ref. 1145/54**

The flushing depth for all boxes is 45 mm.

System wires lead into the boxes through the openings on the sides and bottom of the box.

All openings are shut by removable closures.

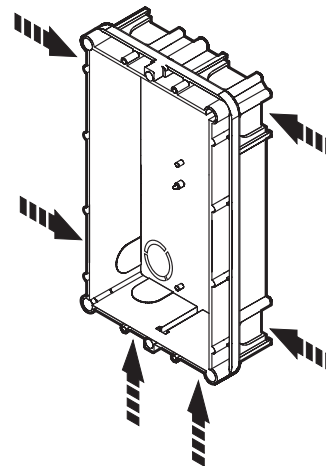

Two fairlead shims for joining the boxes are provided with flush-mounting boxes for 2, 3 and 4 modules.

The flush-mounting box must be turned by 90° for horizontal panel development.

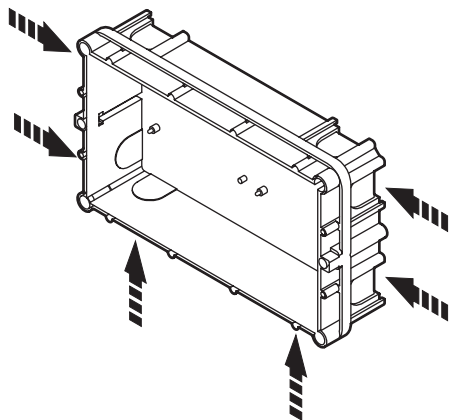

Note: rain hood versions, case and hood versions and gate pillar versions may be applied to vertical panel arrangements only.

JOINING FLUSH-MOUNTING BOXES

Flush-mounting boxes may be joined by means of shims which double as fairleads.

Any number of flush-mounting boxes may be fitted if no accessories are used. In this case, the boxes may be joined either horizontally or vertically by means of fairlead shims. Conversely, up to three boxes can be joined along the longer sides with wall cover frames and rain hoods.

All shims are hollow to allow the passage of wires from one box to the other.

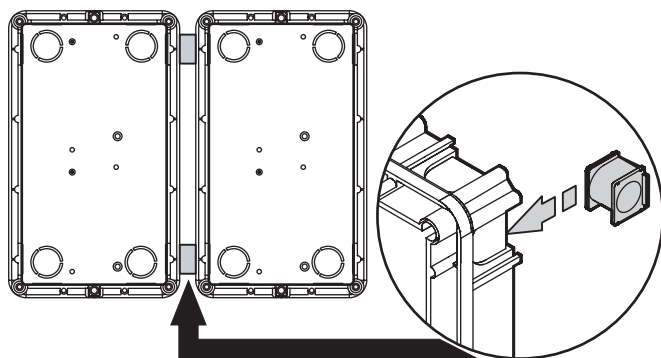

FRAMES AND MODULE HOLDERS

1, 2, 3 and 4 module versions of the module holders and frames are available.

The anodised aluminium frames are required for appearance and protection and must be applied at the end of the installation.

Module holders on the other hand are used for simple, immediate fastening of single and double Synthesi modules.

A hinge is provided in the lower part of the frame to tip the modules and facilitate wiring and adjustments.

Available versions are:

- for 1 module:
- for 2 modules:
- for 3 modules:
- for 4 modules:

Ref. 1145/61
Ref. 1145/62
Ref. 1145/63
Ref. 1145/64

MODULE HOLDER INSTALLATION

Arrange the module holder and fasten the lower screw after flush mounting the box. Raise the frame and fasten the upper screw.

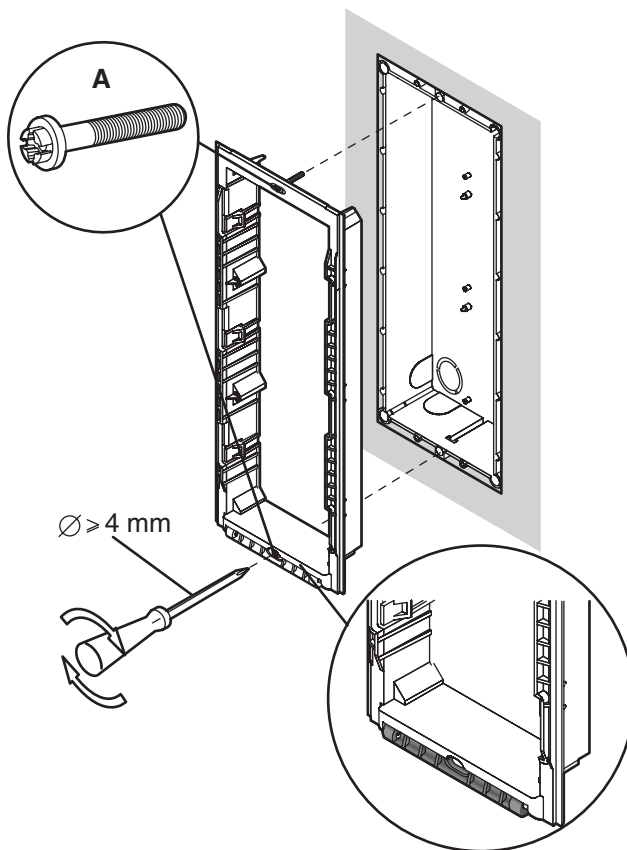

FRAME INSTALLATION

After installation, insert the heads on the frame and arrange the assembly on the module holder.

Adjust correct perpendicularity of the panel by means of the screws **A**. Secure the frame by fastening the screws **B**.

Note: The blue headers Ref. 1145/65 may be used to customise the panel (the kit also comprises blue name tags).

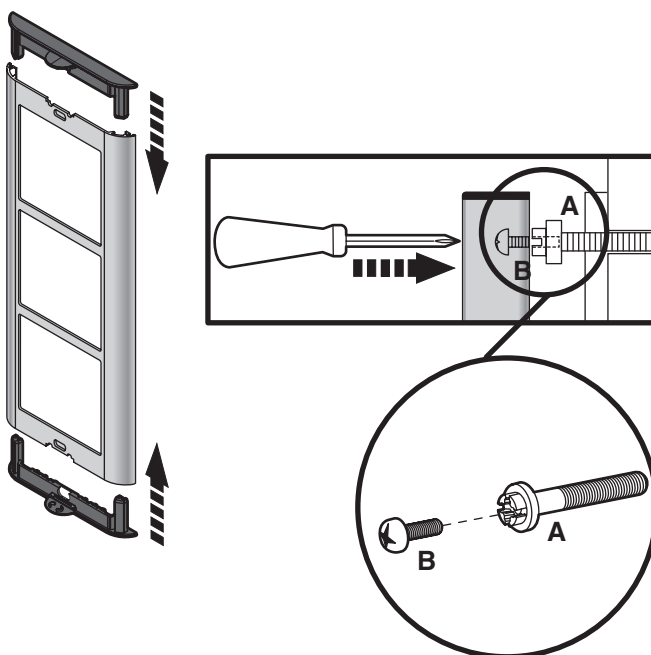

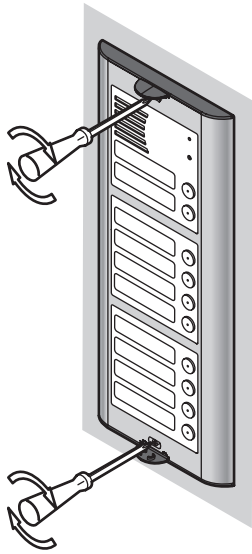

HORIZONTAL HOLDER AND FRAME INSTALLATION

The procedure for horizontal installation of module holders and frames is similar to that described above. The frame hinge will be found on a side instead of on the bottom and will consequently open horizontally. The modules are fastened to the frame in the same way, regardless of the direction of development of the panel.

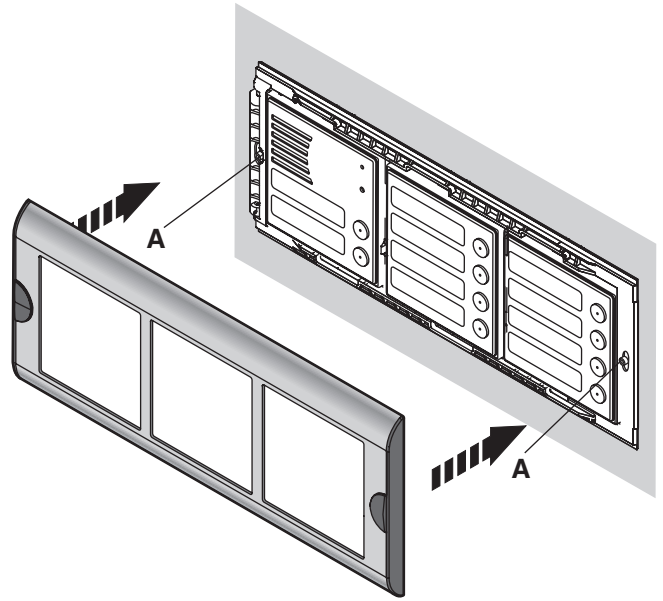
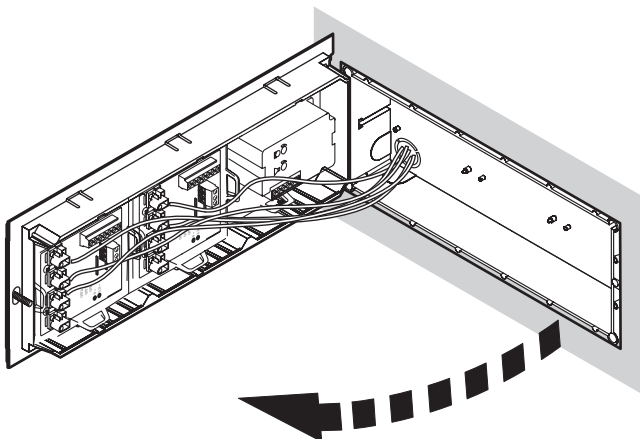
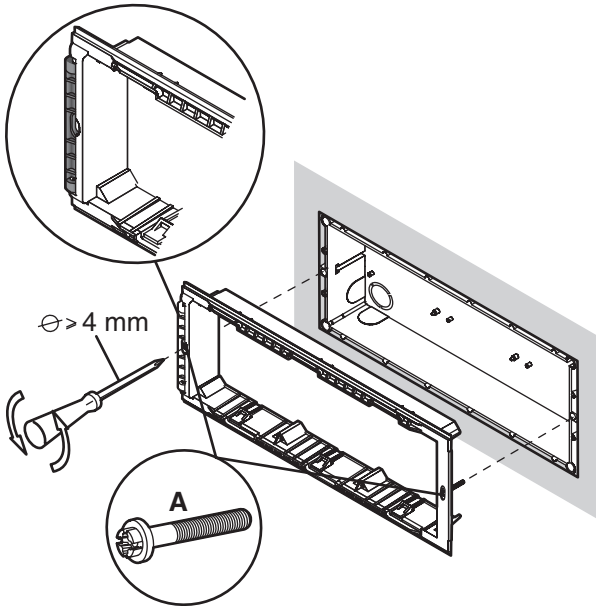

FLUSH-MOUNTED PANEL ACCESSORIES

WALL COVER FRAME

These frames are used to conceal irregularities of the wall in the flush mounting area surrounding the panel; insert the cover frames between modules and wall. Rubber seals prevent water leakage.

The following anodised aluminium frames are provided:

- for 1 module: **Ref. 1145/711**
- for 2 modules: **Ref. 1145/712**
- for 3 modules: **Ref. 1145/713**
- for 4 modules: **Ref. 1145/714**

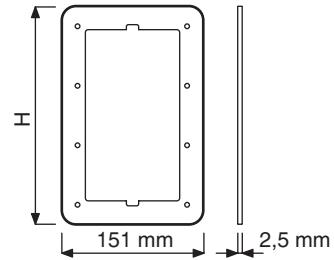

H is 148, 238, 328 and 418 mm for 1, 2, 3 and 4 module versions, respectively.

- for 4 modules (2 frames for 2 joined modules) **Ref. 1145/724**
- for 6 modules (2 frames for 3 joined modules) **Ref. 1145/726**
- for 8 modules (2 frames for 4 joined modules) **Ref. 1145/728**

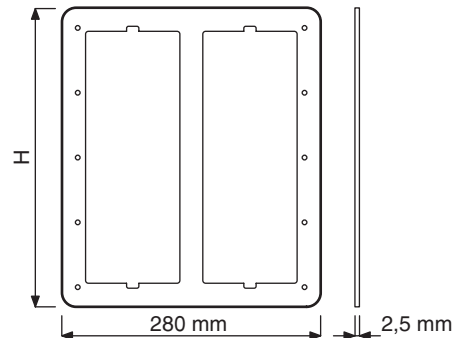

H is 238, 328 and 418 mm for 2, 3 and 4 module versions, respectively.

- for 9 modules (3 frames for 3 joined modules)
- for 12 modules (3 frames for 4 joined modules)

Ref. 1145/739
Ref. 1145/732

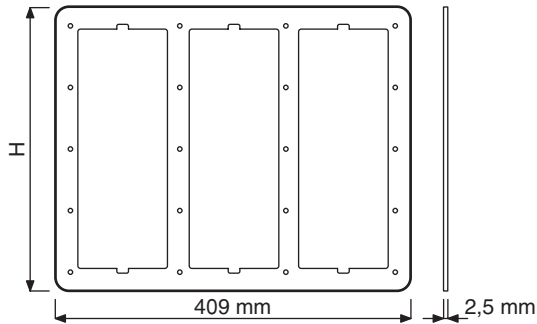

H is 328 and 418 mm for 3 and 4 module versions, respectively.

WALL FRAME COVER INSTALLATION

Embed the flush mounting box in the wall, position the wall cover frame and fasten the module holder lower screw. Frame fastening is completed by tightening the upper frame screw last.

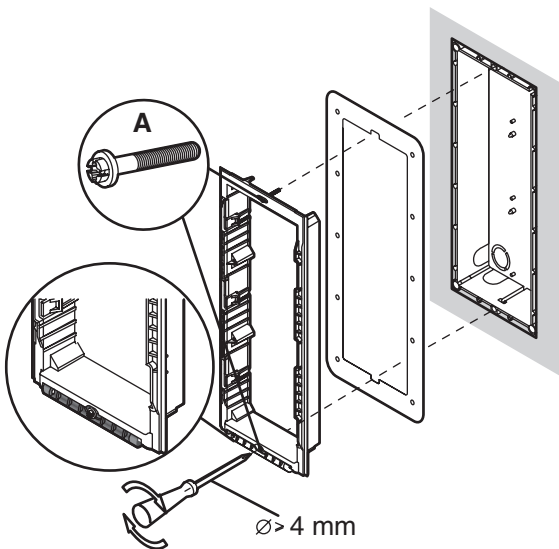

For horizontal development of the panels, simply turn the wall cover frame by 90° to adapt it to the flush-mounting box.

RAIN HOOD WITH WALL COVER FRAME

The rain hoods may be only applied to vertical panels arrangements. They are useful to make the panel installation weatherproof.

The following versions of hoods to be fitted between modules and wall are provided:

- for 1 module:
- for 2 modules:
- for 3 modules:
- for 4 modules:

Ref. 1145/611
Ref. 1145/612
Ref. 1145/613
Ref. 1145/614

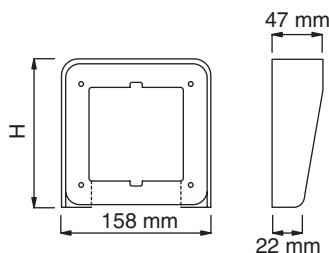

H is 151, 241, 331 and 421 mm for 1, 2, 3 and 4 module versions, respectively.

- for 4 modules (2 frames for 2 joined modules)
- for 6 modules (2 frames for 3 joined modules)
- for 8 modules (2 frames for 4 joined modules)

Ref. 1145/624
Ref. 1145/626
Ref. 1145/628

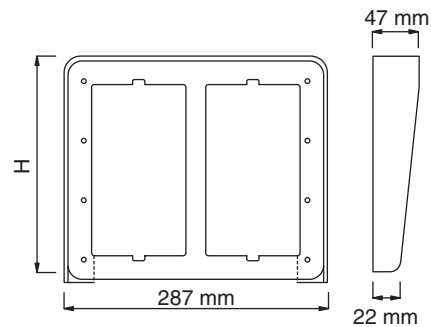

H is 241, 331 and 421 mm for 2, 3 and 4 module versions, respectively.

- for 9 modules (3 frames for 3 joined modules)
- for 12 modules (3 frames for 4 joined modules)

Ref. 1145/639
Ref. 1145/632

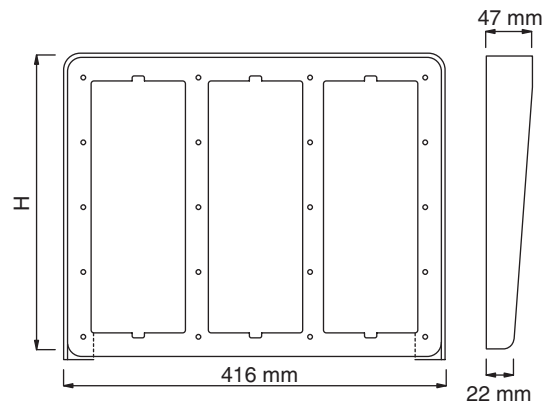

H is 331 and 421 mm for 3 and 4 module versions, respectively.

RAIN HOOD INSTALLATION

Embed the flush mounting box in the wall, position the waterproof hood and fasten the module holder lower screw. Hood fastening is completed by tightening the upper frame screw last.

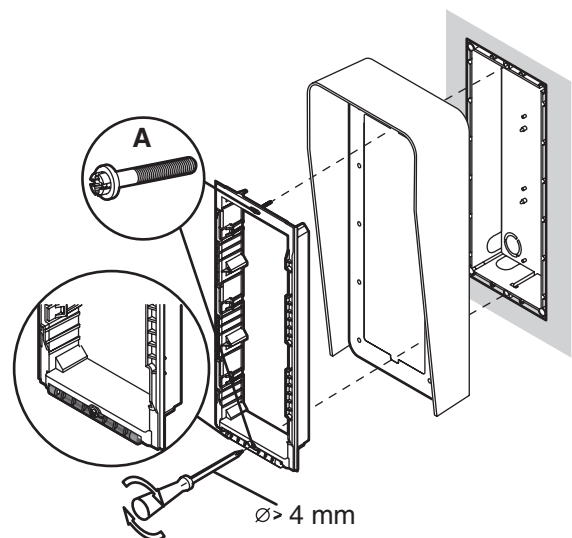

WALL-MOUNTED PANEL ACCESSORIES

CASE AND HOOD WITH FRAME AND MODULE HOLDER

Wall-mounted installation is possible for vertical panels arrangements only.

Cases and hoods protect the panel from the weather and may be used for installation on walls without flush-mounted parts.

The following versions are provided (with frame and module holder):

- for 1 module: **Ref. 1145/311**
- for 2 modules: **Ref. 1145/312**
- for 3 modules: **Ref. 1145/313**
- for 4 modules: **Ref. 1145/314**

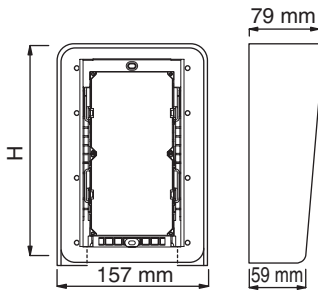

H is 151, 241, 331 and 421 mm for 1, 2, 3 and 4 module versions, respectively.

- for 4 modules (2 frames for 2 joined modules) **Ref. 1145/324**
- for 6 modules (2 frames for 3 joined modules) **Ref. 1145/326**
- for 8 modules (2 frames for 4 joined modules) **Ref. 1145/328**

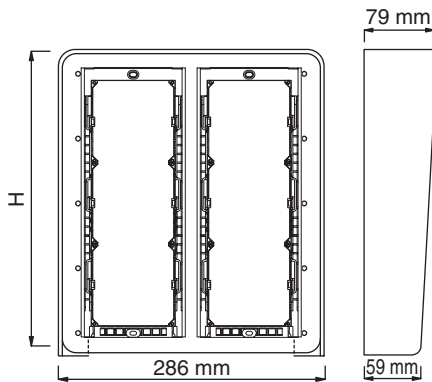

H is 241, 331 and 421 mm for 2, 3 and 4 module versions, respectively.

- for 9 modules (3 frames for 3 joined modules) **Ref. 1145/339**
- for 12 modules (3 frames for 4 joined modules) **Ref. 1145/332**

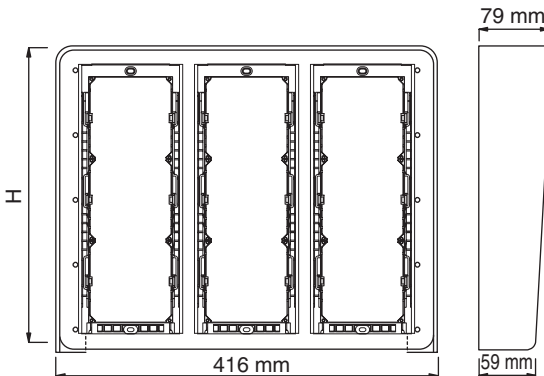

H is 331 and 421 mm for 3 and 4 module versions, respectively.

CASE AND HOOD INSTALLATION

Fasten the hood to the wall by means of four bolts.

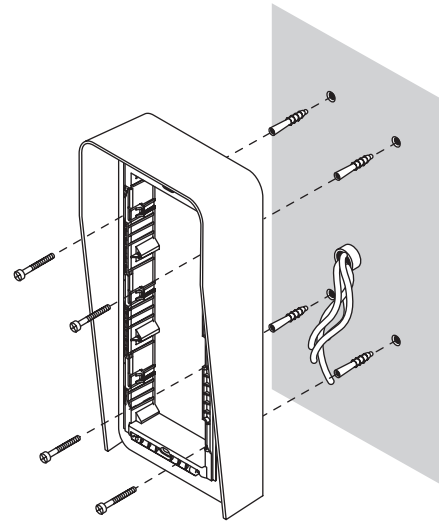

Fit the modules on the frame.

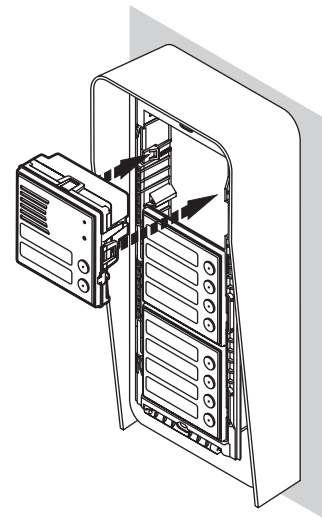

Loosen the upper frame screw, open the box and make the electrical connections.

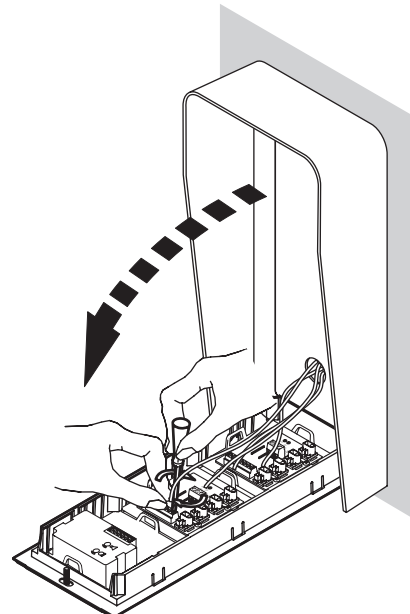

Fit the frame.

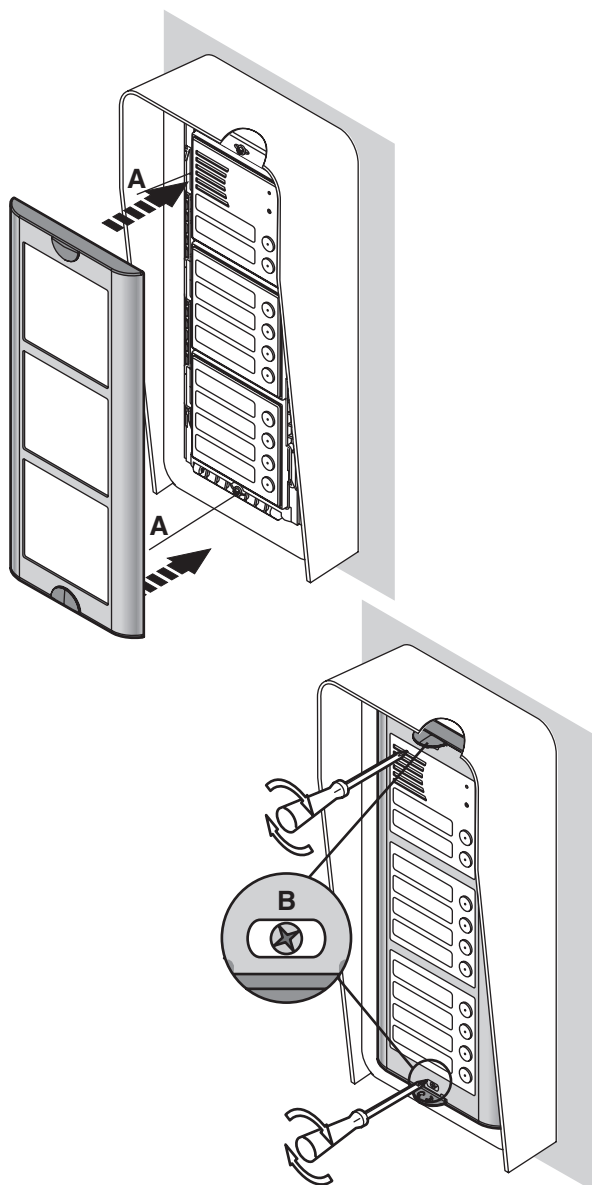

GATE SEMI-FLUSHED PANEL ACCESSORIES

CASE AND HOOD FOR SEMI-FLUSHED GATE INSTALLATION WITH FRAME AND MODULE HOLDER

Cases and hood for gate pillar installation are suitable for vertical installation on a gate pillar.

Semi-flushed cases with module holder and front aluminium frame may be used for this type of installation.

Versions are:

- for 2 modules:
- for 3 modules:

Ref. 1145/342

Ref. 1145/343

Gate pillar installation dimensions are:

2 module semi-flushed box: h 215 x l 104 x d 93.2 mm
 3 module semi-flushed box: h 305.3 x l 104 x d 93.2 mm
 maximum projection from pillar: 76 mm
 flush hole width in pillar: 98 mm

GATE PILLAR INSTALLATION

Drill a hole dimensioned as shown on the provided template in the pillar and arrange the case on the pillar.

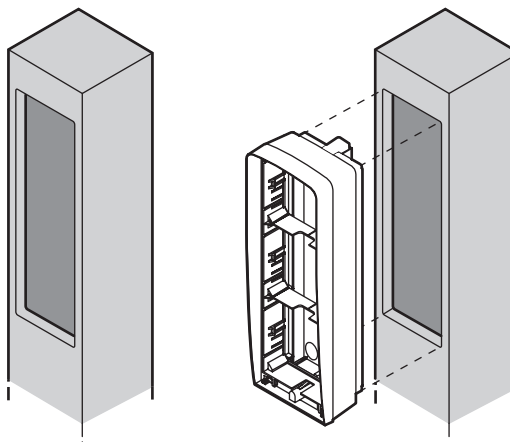

To fasten the case:

- Push the screw to the bottom of the box with a screwdriver.
- Push the screw outwards with a screwdriver.
- Fasten the screw.

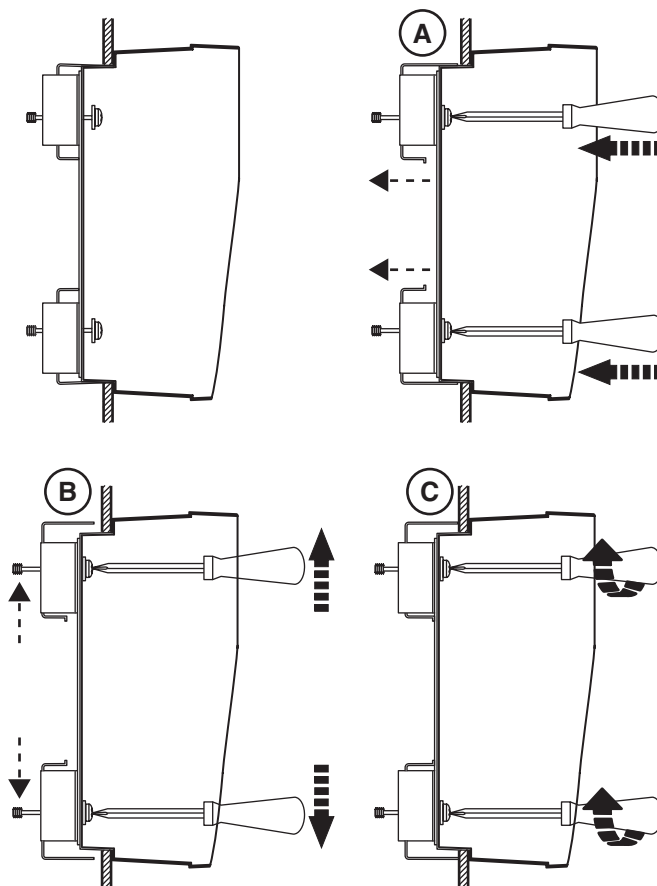

Fit the modules on the frame.
WARNING: Eliminate a crossbar with cutters to fit double modules.

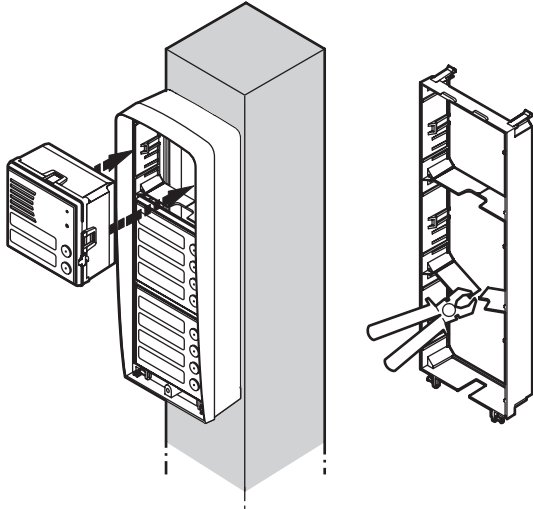

Turn the frame round and connect wires.

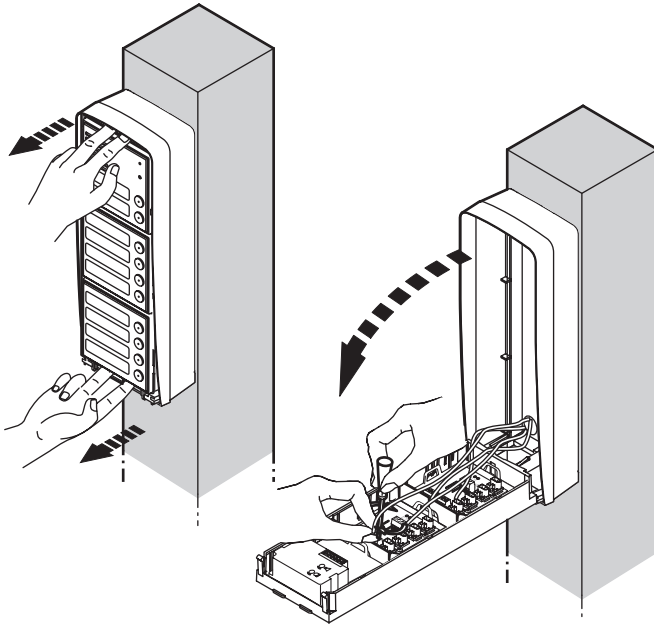

Fit the panel on the frame.

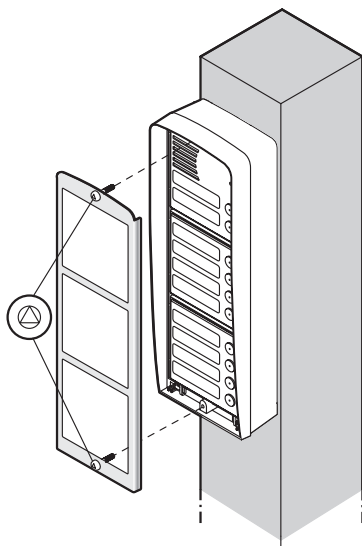

CONVERSATION PRIVACY DEVICE FOR "1+1" WIRE SYSTEMS Ref. 1145/74

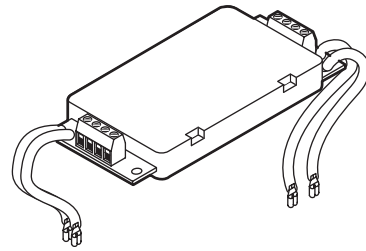

The device is used for conversation privacy function in 1+1 door phone systems and 5-wire video door phone systems only. Each device may be fitted in a 4-button module with the two screws provided as shown below. Connect wires C1, C2, C3 and C4 to terminals U1, U2, U3 and U4 of the button module; use the terminals on the device for connecting to the system. The device will only be partially used in the case of 1, 2 and 3 button modules. The number of boards consequently depends on the number of buttons (from 1 to 4) on the panel. When counting the number of boards required, remember that door unit Ref. 1145/67 and camera modules Ref. 1745/21 and Ref. 1745/22 are already equipped with conversation privacy devices for two users.

CONVERSATION PRIVACY DEVICE INSERTION

Fasten the devices to the two shims with the respective screws.

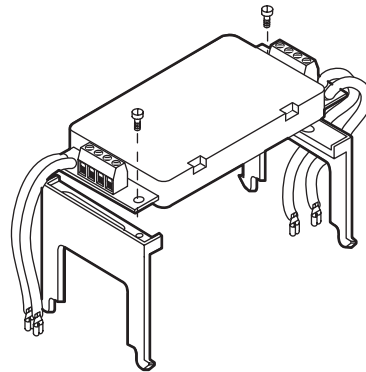

Connect the wires to each call button.

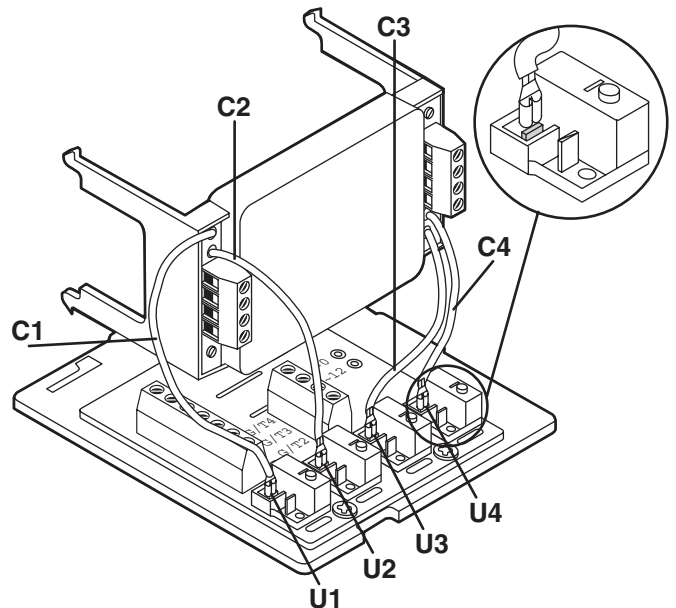

Apply the shims and conversation privacy device to the module.

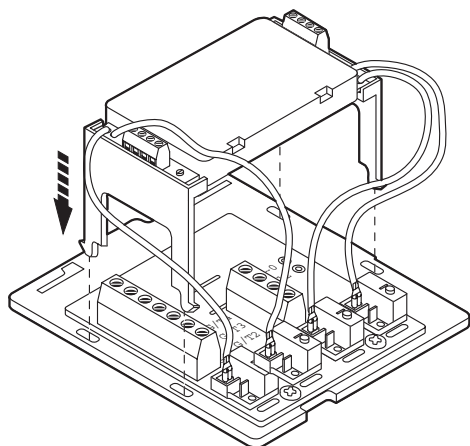

CONVERSATION PRIVACY DEVICE FOR "4+n" WIRE SYSTEMS Ref. 5330/60

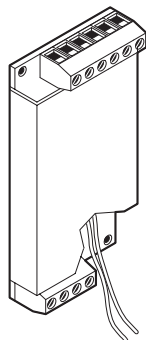

This device is used for conversation privacy function in 4+n door phone systems and coax video door phone systems, only. Fit device Ref. 1131/5 in each 1131 or 1132 door phone for the function; fit the video door phones on the specific conversation privacy bracket (Ref. 1202/95 for Winflat+ or Ref. 1704/95 for Sentry+).

The device shuts down privacy from previous calls and consequently ensures total privacy also if a door phone is forgotten off hook.

All devices are normally deactivated (no conversation is heard when the handset is picked up): only the device called by the panel may start a conversation with the caller; no other device can take or intercept the call.

The device must be fastened to the flush-mounting box or case with hood with two screws. Considering its size, the device must be fitted in button modules or special modules.

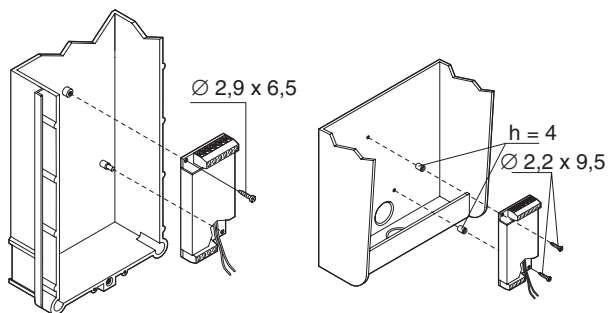

SINTHESI PANEL INSTALLATION

FLUSH-MOUNTED VERSION

You are advised to install the modules at the heights shown below according to the required system configuration.

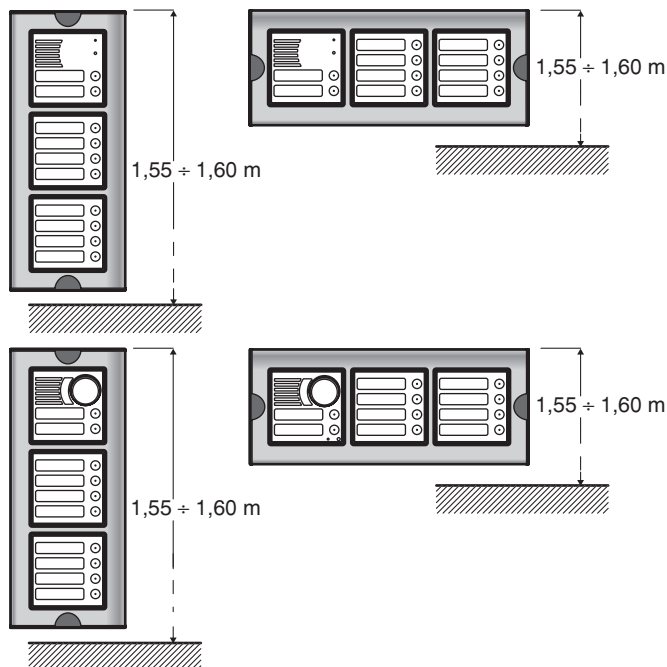

In any case, consider the height shown in the figure for fastening the camera for correct installation of complex arrangement with several modules. The height refers to the door unit in door phone systems. The procedure for horizontal panel development is the same as that shown below for vertical development. Obviously, in this case, the boxes, module holders, modules and frames must be turned by 90°.

Arrange the hole (on the bottom or on the sides) for letting through the connection wires before closing the flush-mounting box (single or joined to other boxes).

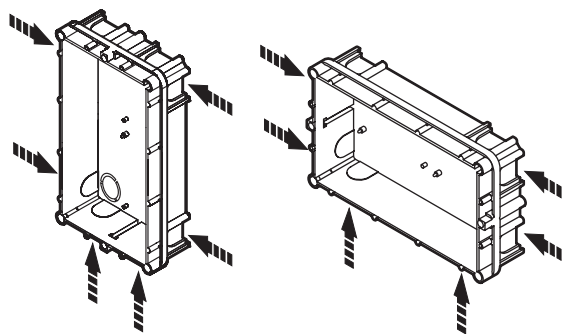

Fit the flush mounting box in line with the wall: it must not project.

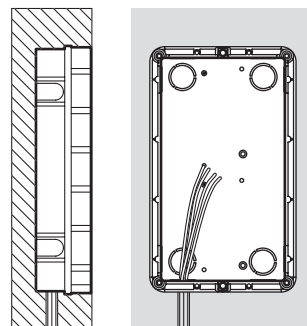

Fit the module holder frame.

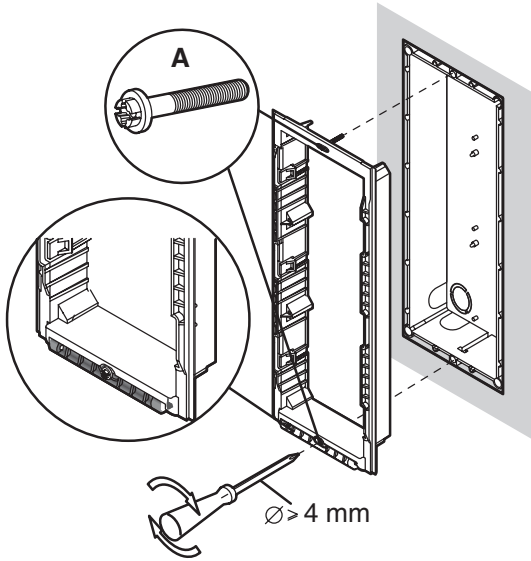

Fit the modules in the frame.

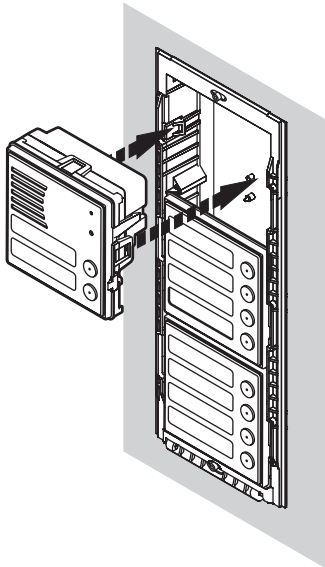

Turn the frame round and connect wires.

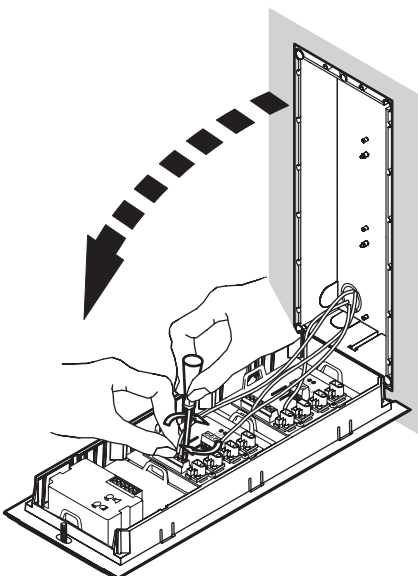

Close the frame and fasten the screws **A** without tightening them.

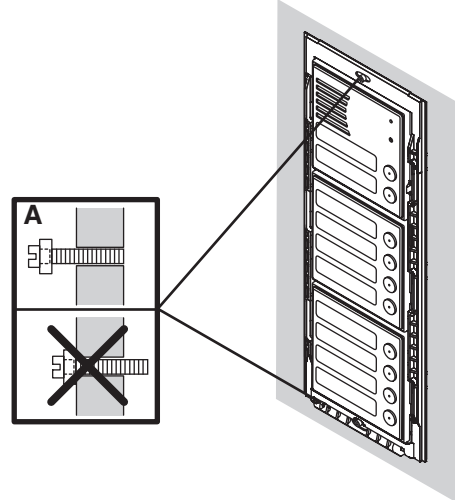

Fit the name tags.

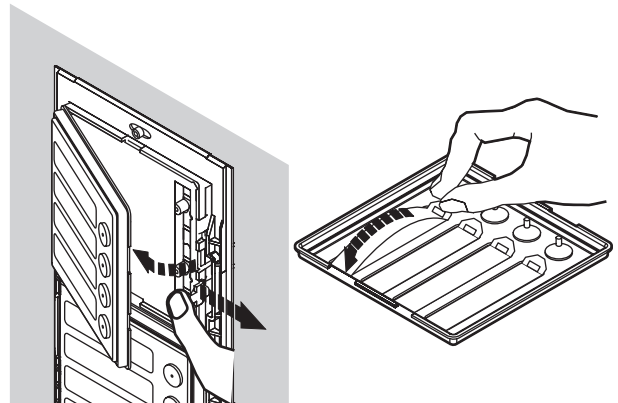

Position the panel on the frame.
Adjust correct perpendicularity of the panel.
Fasten screws **B** on screws **A**.

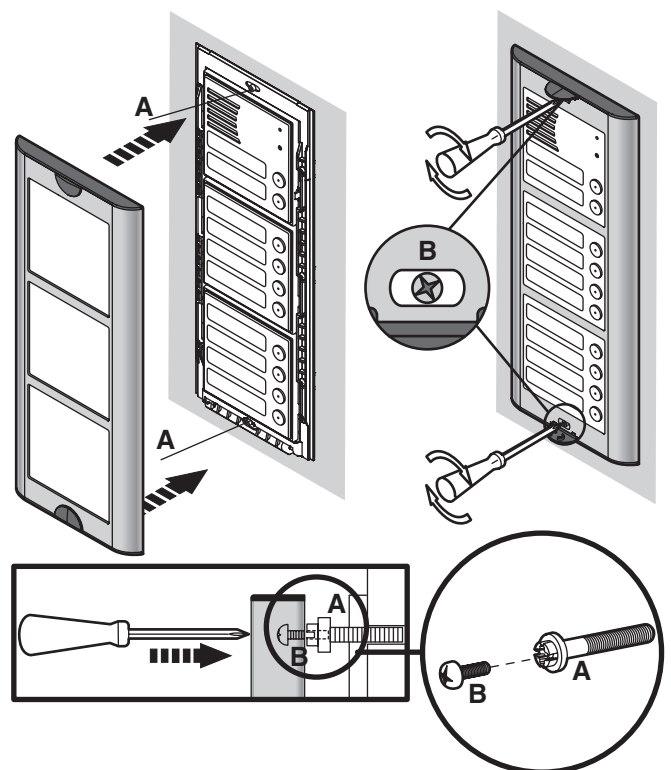

FLUSH-MOUNTED VERSION

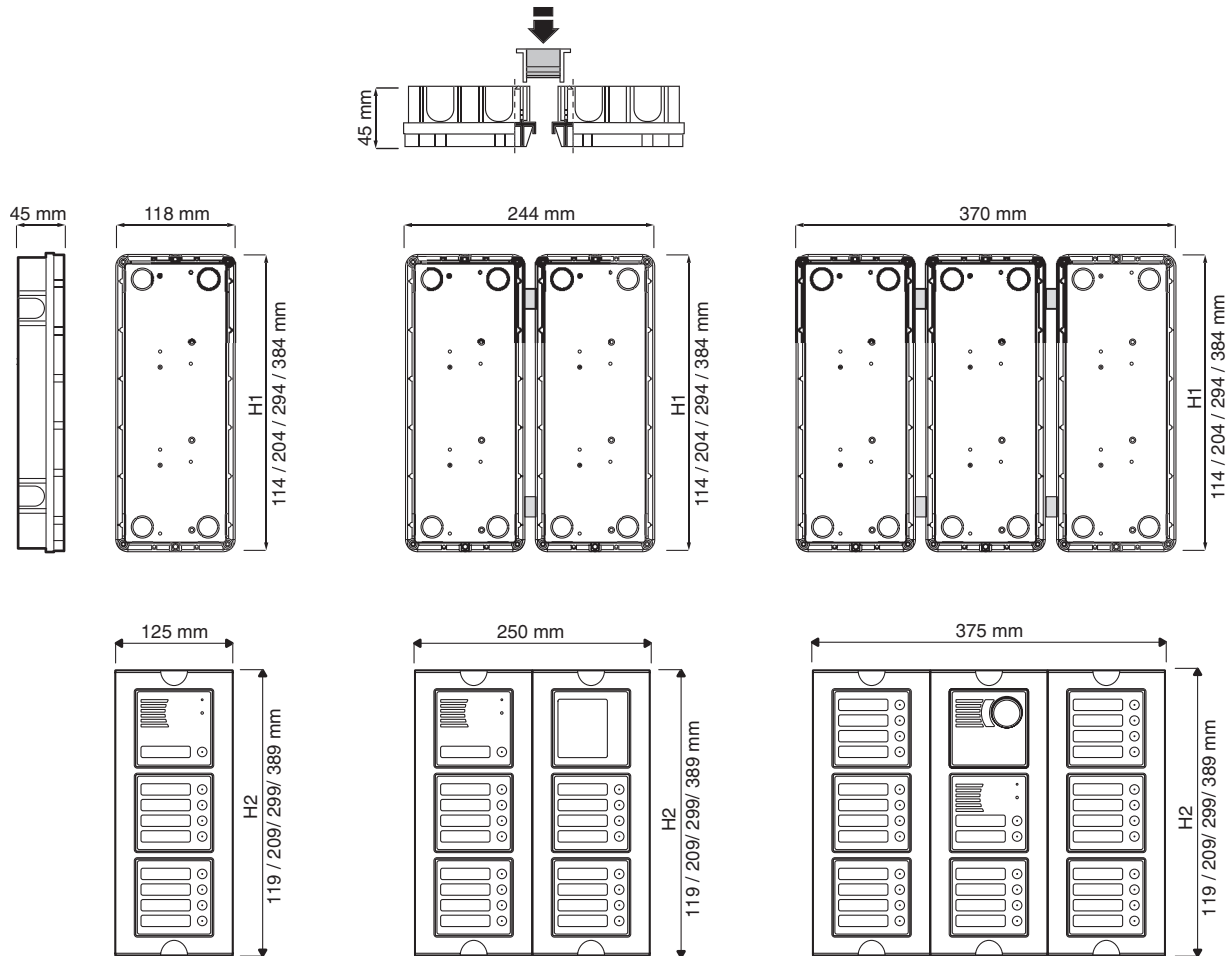

Note: H1= 114, 204, 294, 384 indicates flush mounting height and H2= 119, 209, 299, 389 indicates to total height relative to 1, 2, 3 and 4 module versions.

WALL-MOUNTED VERSION

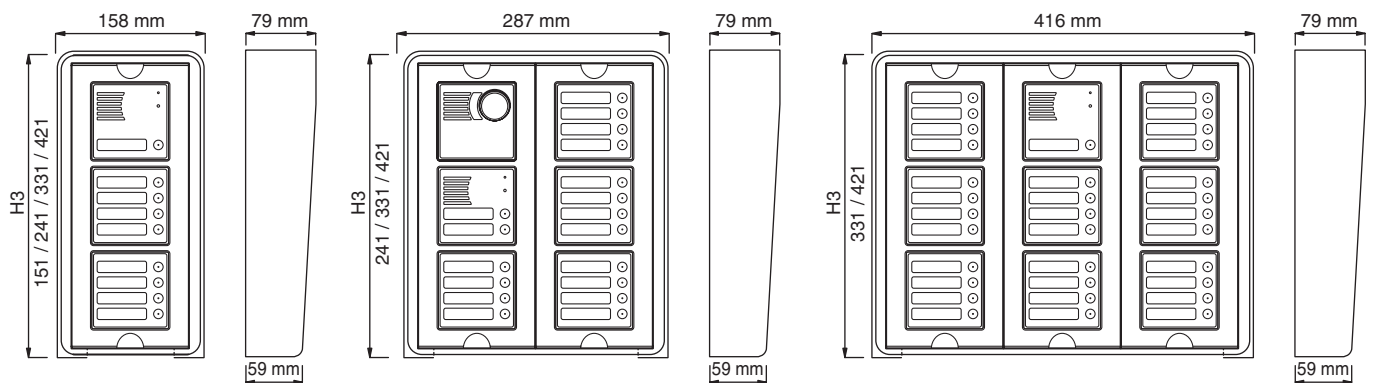

Note: H3 referred to the total height may differ according to the number of modules that the case may contain.

(°) alternatives
(#) alternatives



1



2

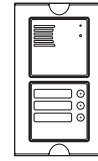

3

	Button modules	Repertory module	-	-	-	-	1145/13	-
	Door unit modules		1145/21		1145/22		1145/20	
	Door unit		1145/500		1145/500		1145/500	
FLUSH MOUNTED (#)	Flush-mounting box		1145/51		1145/51		1145/52	
	Module holders and frames		1145/61		1145/61		1145/62	
FLUSH-MOUNTING ACCESSORIES	Wall cover frame (°)		1145/711		1145/711		1145/712	
	Rain hood with wall cover frame (°)		1145/611		1145/611		1145/612	
WALL MOUNTED(#)	Case with hood, frame and module holders		1145/311		1145/311		1145/312	
GATE PILLAR(#)	Case with hood, frame and module holders		-		-		1145/342	

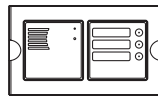

3

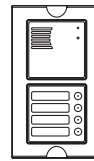

4

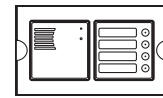

4

	Button modules	Repertory module	1145/13	-	1145/14	-	1145/14	-
	Door unit modules		1145/20		1145/20		1145/20	
	Door unit		1145/500		1145/500		1145/500	
FLUSH MOUNTED (#)	Flush-mounting box		1145/52		1145/52		1145/52	
	Module holders and frames		1145/62		1145/62		1145/62	
FLUSH-MOUNTING ACCESSORIES	Wall cover frame (°)		1145/712		1145/712		1145/712	
	Rain hood with wall cover frame (°)		-		1145/612		-	
WALL MOUNTED(#)	Case with hood, frame and module holders		-		1145/312		-	
GATE PILLAR(#)	Case with hood, frame and module holders		-		1145/342		-	

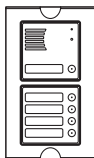

5

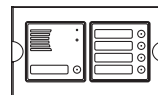

5

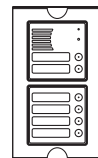

6

	Button modules	Repertory module	1145/14	-	1145/14	-	1145/14	-
	Door unit modules		1145/21		1145/21		1145/22	
	Door unit		1145/500		1145/500		1145/500	
FLUSH MOUNTED (#)	Flush-mounting box		1145/52		1145/52		1145/52	
	Module holders and frames		1145/62		1145/62		1145/62	
FLUSH-MOUNTING ACCESSORIES	Wall cover frame (°)		1145/712		1145/712		1145/712	
	Rain hood with wall cover frame (°)		1145/612		-		1145/612	
WALL MOUNTED(#)	Case with hood, frame and module holders		1145/312		-		1145/312	
GATE PILLAR(#)	Case with hood, frame and module holders		1145/342		-		1145/342	



SINTHESI PANELS
4+n WIRE DOOR PHONE SYSTEMS



EXAMPLES OF MODULAR CONSTRUCTIONS WITH VARIOUS CAPACITIES

(°) alternatives
(#) alternatives

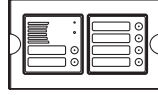

6

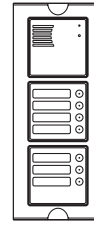

7

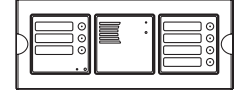

7

	Button modules	Repertory module	1145/14	-	1145/14 + 1145/13	-	1145/13 + 1145/14	-
	Door unit modules		1145/22		1145/20		1145/20	
	Door unit		1145/500		1145/500		1145/500	
FLUSH MOUNTED (#)	Flush-mounting box		1145/52		1145/53		1145/53	
	Module holders and frames		1145/62		1145/63		1145/63	
FLUSH-MOUNTING ACCESSORIES	Wall cover frame (°)		1145/712		1145/713		1145/713	
	Rain hood with wall cover frame (°)		-		1145/613		-	
WALL MOUNTED (#)	Case with hood, frame and module holders		-		1145/313		-	
	GATE PILLAR (#)	Case with hood, frame and module holders	-		1145/343		-	

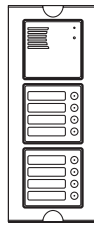

8

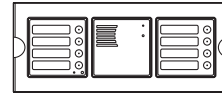

8

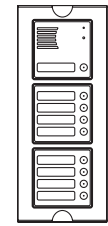

9

	Button modules	Repertory module	2 x 1145/14	-	2 x 1145/14	-	2 x 1145/14	-
	Door unit modules		1145/20		1145/20		1145/21	
	Door unit		1145/500		1145/500		1145/500	
FLUSH MOUNTED (#)	Flush-mounting box		1145/53		1145/53		1145/53	
	Module holders and frames		1145/63		1145/63		1145/63	
FLUSH-MOUNTING ACCESSORIES	Wall cover frame (°)		1145/713		1145/713		1145/713	
	Rain hood with wall cover frame (°)		1145/613		-		1145/613	
WALL MOUNTED (#)	Case with hood, frame and module holders		1145/313		-		1145/313	
	GATE PILLAR (#)	Case with hood, frame and module holders	1145/343		-		1145/343	

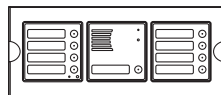

9

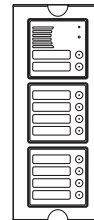

10

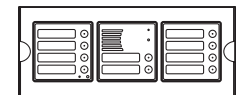

10

	Button modules	Repertory module	2 x 1145/14	-	2 x 1145/14	-	2 x 1145/14	-
	Door unit modules		1145/21		1145/22		1145/22	
	Door unit		1145/500		1145/500		1145/500	
FLUSH MOUNTED (#)	Flush-mounting box		1145/53		1145/53		1145/53	
	Module holders and frames		1145/63		1145/63		1145/63	
FLUSH-MOUNTING ACCESSORIES	Wall cover frame (°)		1145/713		1145/713		1145/713	
	Rain hood with wall cover frame (°)		-		1145/613		-	
WALL MOUNTED (#)	Case with hood, frame and module holders		-		1145/313		-	
	GATE PILLAR (#)	Case with hood, frame and module holders	-		1145/343		-	

(°) alternatives
(#) alternatives

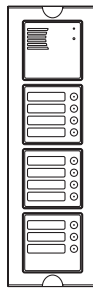

11

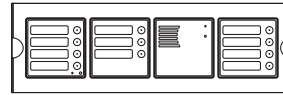

11

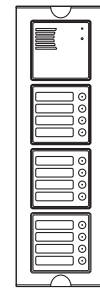

12

	Button modules	Repertory module	1145/13 + 2 x 1145/14	-	1145/13 + 2 x 1145/14	-	3 x 1145/14	-
	Door unit modules		1145/20		1145/20		1145/20	
	Door unit		1145/500		1145/500		1145/500	
FLUSH MOUNTED (#)	Flush-mounting box		1145/54		1145/54		1145/54	
	Module holders and frames		1145/64		1145/64		1145/64	
FLUSH-MOUNTING ACCESSORIES	Wall cover frame (°)		1145/714		1145/714		1145/714	
	Rain hood with wall cover frame (°)		1145/614		-		1145/614	
WALL MOUNTED (#)	Case with hood, frame and module holders		1145/314		-		1145/314	
GATE PILLAR (#)	Case with hood, frame and module holders		-		-		-	

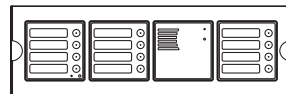

12

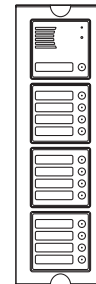

13

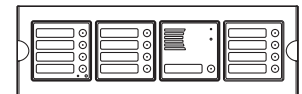

13

	Button modules	Repertory module	3 x 1145/14	-	3 x 1145/14	-	3 x 1145/14	-
	Door unit modules		1145/20		1145/21		1145/21	
	Door unit		1145/500		1145/500		1145/500	
FLUSH MOUNTED (#)	Flush-mounting box		1145/54		1145/54		1145/54	
	Module holders and frames		1145/64		1145/64		1145/64	
FLUSH-MOUNTING ACCESSORIES	Wall cover frame (°)		1145/714		1145/714		1145/714	
	Rain hood with wall cover frame (°)		-		1145/614		-	
WALL MOUNTED (#)	Case with hood, frame and module holders		-		1145/314		-	
GATE PILLAR (#)	Case with hood, frame and module holders		-		-		-	

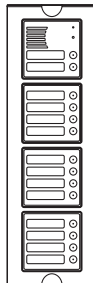

14

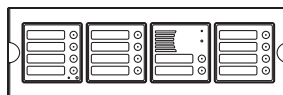

14

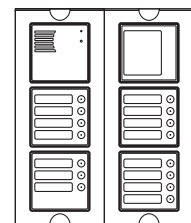

15

	Button modules	Repertory module	3 x 1145/14	-	3 x 1145/14	-	1145/13 + 3 x 1145/14	1145/50
	Door unit modules		1145/22		1145/22		1145/20	
	Door unit		1145/500		1145/500		1145/500	
FLUSH MOUNTED (#)	Flush-mounting box		1145/54		1145/54		2 x 1145/53	
	Module holders and frames		1145/64		1145/64		2 x 1145/63	
FLUSH-MOUNTING ACCESSORIES	Wall cover frame (°)		1145/714		1145/714		1145/726	
	Rain hood with wall cover frame (°)		1145/614		-		1145/626	
WALL MOUNTED (#)	Case with hood, frame and module holders		1145/314		-		1145/326	
GATE PILLAR (#)	Case with hood, frame and module holders		-		-		-	



SINTHESI PANELS 4+n WIRE DOOR PHONE SYSTEMS



EXAMPLES OF MODULAR CONSTRUCTIONS WITH VARIOUS CAPACITIES

(°) alternatives
(#) alternatives

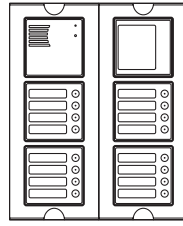

16

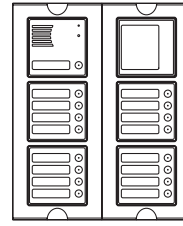

17

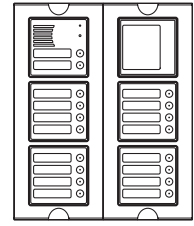

18

	Button modules	Repertory module	4 x 1145/14	1145/50	4 x 1145/14	1145/50	4 x 1145/14	1145/50
	Door unit modules		1145/20		1145/21		1145/22	
	Door unit		1145/500		1145/500		1145/500	
FLUSH MOUNTED (#)	Flush-mounting box		2 x 1145/53		2 x 1145/53		2 x 1145/53	
	Module holders and frames		2 x 1145/63		2 x 1145/63		2 x 1145/63	
FLUSH-MOUNTING ACCESSORIES	Wall cover frame (°)		1145/726		1145/726		1145/726	
	Rain hood with wall cover frame (°)		1145/626		1145/626		1145/626	
WALL MOUNTED(#)	Case with hood, frame and module holders		1145/326		1145/326		1145/326	
GATE PILLAR(#)	Case with hood, frame and module holders		-		-		-	

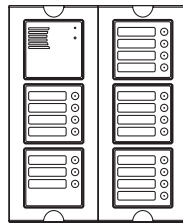

19

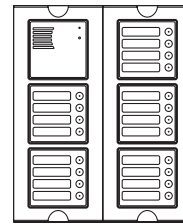

20

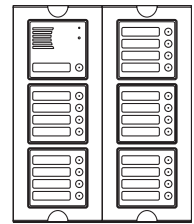

21

	Button modules	Repertory module	4 x 1145/14 + 1145/13	-	5 x 1145/14	-	5 x 1145/14	-
	Door unit modules		1145/20		1145/20		1145/21	
	Door unit		1145/500		1145/500		1145/500	
FLUSH MOUNTED (#)	Flush-mounting box		2 x 1145/53		2 x 1145/53		2 x 1145/53	
	Module holders and frames		2 x 1145/63		2 x 1145/63		2 x 1145/63	
FLUSH-MOUNTING ACCESSORIES	Wall cover frame (°)		1145/726		1145/726		1145/726	
	Rain hood with wall cover frame (°)		1145/626		1145/626		1145/626	
WALL MOUNTED(#)	Case with hood, frame and module holders		1145/326		1145/326		1145/326	
GATE PILLAR(#)	Case with hood, frame and module holders		-		-		-	

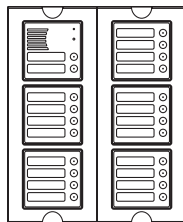

22

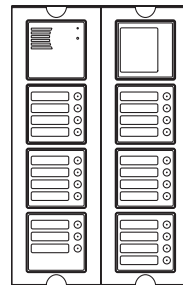

23

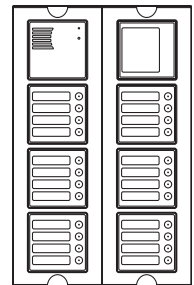

24

	Button modules	Repertory module	5 x 1145/14	-	1145/13 + 5 x 1145/14	1145/50	6 x 1145/14	1145/50
	Door unit modules		1145/22		1145/20		1145/20	
	Door unit		1145/500		1145/500		1145/500	
FLUSH MOUNTED (#)	Flush-mounting box		2 x 1145/53		2 x 1145/54		2 x 1145/54	
	Module holders and frames		2 x 1145/63		2 x 1145/64		2 x 1145/64	
FLUSH-MOUNTING ACCESSORIES	Wall cover frame (°)		1145/726		1145/728		1145/728	
	Rain hood with wall cover frame (°)		1145/626		1145/628		1145/628	
WALL MOUNTED(#)	Case with hood, frame and module holders		1145/326		1145/328		1145/328	
GATE PILLAR(#)	Case with hood, frame and module holders		-		-		-	

(°) alternatives
(#) alternatives

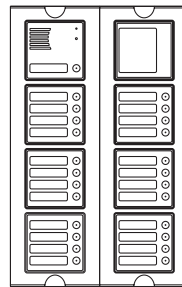

25

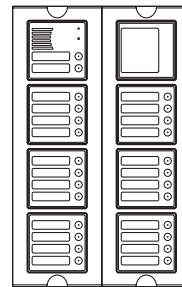

26

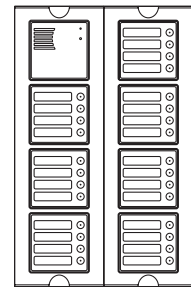

28

	Button modules	Repertory module	6 x 1145/14	1145/50	6 x 1145/14	1145/50	7 x 1145/14	-
	Door unit modules		1145/21		1145/22		1145/20	
	Door unit		1145/500		1145/500		1145/500	
FLUSH MOUNTED (#)	Flush-mounting box		2 x 1145/54		2 x 1145/54		2 x 1145/54	
	Module holders and frames		2 x 1145/64		2 x 1145/64		2 x 1145/64	
FLUSH-MOUNTING ACCESSORIES	Wall cover frame (°)		1145/728		1145/728		1145/728	
	Rain hood with wall cover frame (°)		1145/628		1145/628		1145/628	
WALL MOUNTED(#)	Case with hood, frame and module holders		1145/328		1145/328		1145/328	
GATE PILLAR(#)	Case with hood, frame and module holders		-		-		-	

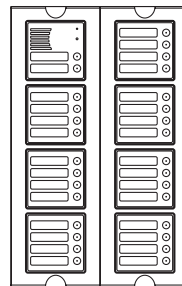

30

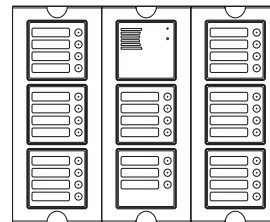

31

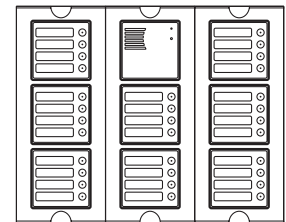

32

	Button modules	Repertory module	7 x 1145/14	-	7 x 1145/14 + 1145/13	-	8 x 1145/14	-
	Door unit modules		1145/22		1145/20		1145/20	
	Door unit		1145/500		1145/500		1145/500	
FLUSH MOUNTED (#)	Flush-mounting box		2 x 1145/54		3 x 1145/53		3 x 1145/53	
	Module holders and frames		2 x 1145/64		3 x 1145/63		3 x 1145/63	
FLUSH-MOUNTING ACCESSORIES	Wall cover frame (°)		1145/728		1145/739		1145/739	
	Rain hood with wall cover frame (°)		1145/628		1145/639		1145/639	
WALL MOUNTED(#)	Case with hood, frame and module holders		1145/328		1145/339		1145/339	
GATE PILLAR(#)	Case with hood, frame and module holders		-		-		-	

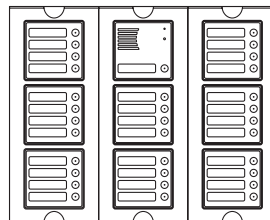

33

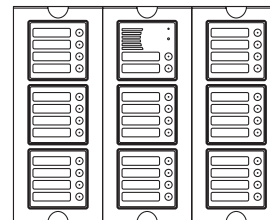

34

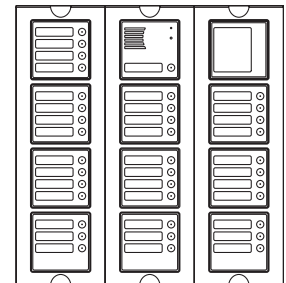

38

	Button modules	Repertory module	8 x 1145/14	-	8 x 1145/14	-	7 x 1145/14 + 3 x 1145/13	1145/50
	Door unit modules		1145/21		1145/22		1145/21	
	Door unit		1145/500		1145/500		1145/500	
FLUSH MOUNTED (#)	Flush-mounting box		3 x 1145/53		3 x 1145/53		3 x 1145/54	
	Module holders and frames		3 x 1145/63		3 x 1145/63		3 x 1145/64	
FLUSH-MOUNTING ACCESSORIES	Wall cover frame (°)		1145/739		1145/739		1145/732	
	Rain hood with wall cover frame (°)		1145/639		1145/639		1145/632	
WALL MOUNTED(#)	Case with hood, frame and module holders		1145/339		1145/339		1145/332	
GATE PILLAR(#)	Case with hood, frame and module holders		-		-		-	



SINTHESI PANELS 4+n WIRE DOOR PHONE SYSTEMS



EXAMPLES OF MODULAR CONSTRUCTIONS WITH VARIOUS CAPACITIES

(°) alternatives
(#) alternatives

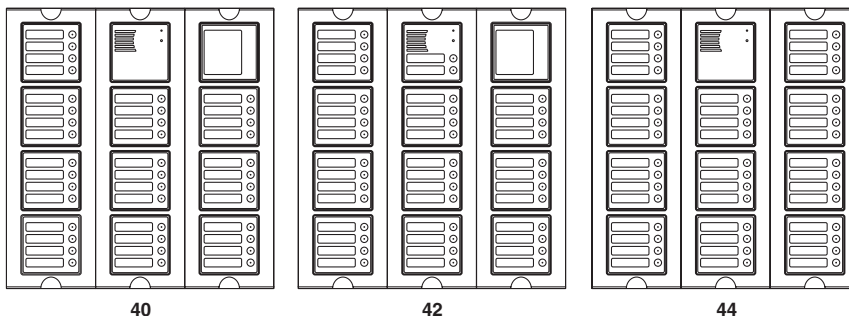

40

42

44

	Button modules	Repertory module	10 x 1145/14	1145/50	10 x 1145/14	1145/50	11 x 1145/14	-
	Door unit modules		1145/20		1145/22		1145/20	
	Door unit		1145/500		1145/500		1145/500	
FLUSH MOUNTED (#)	Flush-mounting box		3 x 1145/54		3 x 1145/54		3 x 1145/54	
	Module holders and frames		3 x 1145/64		3 x 1145/64		3 x 1145/64	
FLUSH-MOUNTING ACCESSORIES	Wall cover frame (°)		1145/732		1145/732		1145/732	
	Rain hood with wall cover frame (°)		1145/632		1145/632		1145/632	
WALL MOUNTED(#)	Case with hood, frame and module holders		1145/332		1145/332		1145/332	
GATE PILLAR(#)	Case with hood, frame and module holders		-		-		-	

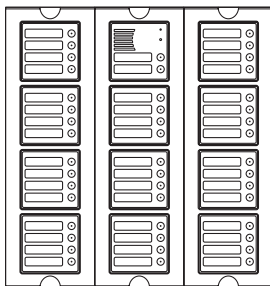

46

	Button modules	Repertory module	11 x 1145/14	-
	Door unit modules		1145/22	
	Door unit		1145/500	
FLUSH MOUNTED (#)	Flush-mounting box		3 x 1145/54	
	Module holders and frames		3 x 1145/64	
FLUSH-MOUNTING ACCESSORIES	Wall cover frame (°)		1145/732	
	Rain hood with wall cover frame (°)		1145/632	
WALL MOUNTED(#)	Case with hood, frame and module holders		1145/332	
GATE PILLAR(#)	Case with hood, frame and module holders		-	

(°) alternatives
(#) alternatives



1

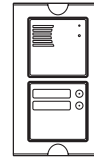

2

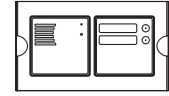

2

	Button modules	Repertory module	-	-	1145/12	-	1145/12	-
	Door unit modules		1145/21		1145/20		1145/20	
	Door unit		1145/67		1145/67		1145/67	
	Conversation privacy device		-		1145/74		1145/74	
FLUSH MOUNTED (#)	Flush-mounting box		1145/51		1145/52		1145/52	
	Module holders and frames		1145/61		1145/62		1145/62	
FLUSH-MOUNTING ACCESSORIES	Wall cover frame (°)		1145/711		1145/712		1145/712	
	Rain hood with wall cover frame (°)		1145/611		1145/612		1145/612	
WALL MOUNTED(#)	Case with hood, frame and module holders		1145/311		1145/312		1145/312	
GATE PILLAR(#)	Case with hood, frame and module holders		-		1145/342		1145/342	

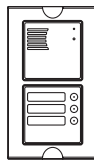

3

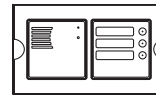

3

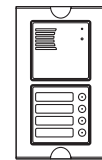

4

	Button modules	Repertory module	1145/13	-	1145/13	-	1145/14	-
	Door unit modules		1145/20		1145/20		1145/20	
	Door unit		1145/67		1145/67		1145/67	
	Conversation privacy device		1145/74		1145/74		1145/74	
FLUSH MOUNTED (#)	Flush-mounting box		1145/52		1145/52		1145/52	
	Module holders and frames		1145/62		1145/62		1145/62	
FLUSH-MOUNTING ACCESSORIES	Wall cover frame (°)		1145/712		1145/712		1145/712	
	Rain hood with wall cover frame (°)		1145/612		-		1145/612	
WALL MOUNTED(#)	Case with hood, frame and module holders		1145/312		-		1145/312	
GATE PILLAR(#)	Case with hood, frame and module holders		1145/342		-		1145/342	

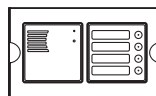

4

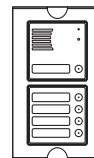

5

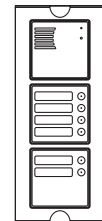

6

	Button modules	Repertory module	1145/14	-	1145/14	-	1145/12 + 1145/14	-
	Door unit modules		1145/20		1145/21		1145/20	
	Door unit		1145/67		1145/67		1145/67	
	Conversation privacy device		1145/74		1145/74		2 x 1145/74	
FLUSH MOUNTED (#)	Flush-mounting box		1145/52		1145/52		1145/53	
	Module holders and frames		1145/62		1145/62		1145/63	
FLUSH-MOUNTING ACCESSORIES	Wall cover frame (°)		1145/712		1145/712		1145/713	
	Rain hood with wall cover frame (°)		-		1145/612		1145/613	
WALL MOUNTED(#)	Case with hood, frame and module holders		-		1145/312		1145/313	
GATE PILLAR(#)	Case with hood, frame and module holders		-		1145/342		1145/343	



SINTHESI PANELS 1+1 WIRE DOOR PHONE SYSTEMS



EXAMPLES OF MODULAR CONSTRUCTIONS WITH VARIOUS CAPACITIES

(°) alternatives
(#) alternatives

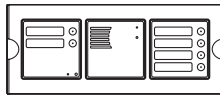

6

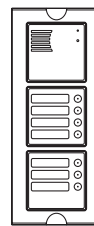

7

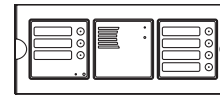

7

	Button modules	Repertory module	1145/12 + 1145/14	-	1145/13 + 1145/14	-	1145/13 + 1145/14	-
	Door unit modules		1145/20		1145/20		1145/20	
	Door unit		1145/67		1145/67		1145/67	
	Conversation privacy device		2 x 1145/74		2 x 1145/74		2 x 1145/74	
FLUSH MOUNTED (#)	Flush-mounting box		1145/53		1145/53		1145/53	
	Module holders and frames		1145/63		1145/63		1145/63	
FLUSH-MOUNTING ACCESSORIES	Wall cover frame (°)		1145/713		1145/713		1145/713	
	Rain hood with wall cover frame (°)		-		1145/613		-	
WALL MOUNTED(#)	Case with hood, frame and module holders		-		1145/313		-	
GATE PILLAR(#)	Case with hood, frame and module holders		-		1145/343		-	

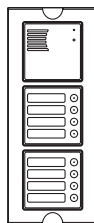

8

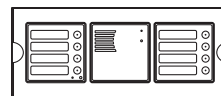

8

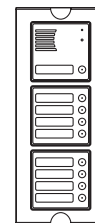

9

	Button modules	Repertory module	2 x 1145/14	-	2 x 1145/14	-	2 x 1145/14	-
	Door unit modules		1145/20		1145/20		1145/21	
	Door unit		1145/67		1145/67		1145/67	
	Conversation privacy device		2 x 1145/74		2 x 1145/74		2 x 1145/74	
FLUSH MOUNTED (#)	Flush-mounting box		1145/53		1145/53		1145/53	
	Module holders and frames		1145/63		1145/63		1145/63	
FLUSH-MOUNTING ACCESSORIES	Wall cover frame (°)		1145/713		1145/713		1145/713	
	Rain hood with wall cover frame (°)		1145/613		-		1145/613	
WALL MOUNTED(#)	Case with hood, frame and module holders		1145/313		-		1145/313	
GATE PILLAR(#)	Case with hood, frame and module holders		1145/343		-		1145/343	

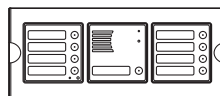

9

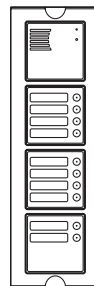

10

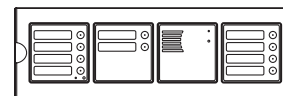

10

	Button modules	Repertory module	2 x 1145/14	-	1145/12 + 2 x 1145/14	-	1145/12 + 2 x 1145/14	-
	Door unit modules		1145/21		1145/20		1145/20	
	Door unit		1145/67		1145/67		1145/67	
	Conversation privacy device		2 x 1145/74		3 x 1145/74		3 x 1145/74	
FLUSH MOUNTED (#)	Flush-mounting box		1145/53		1145/54		1145/54	
	Module holders and frames		1145/63		1145/64		1145/64	
FLUSH-MOUNTING ACCESSORIES	Wall cover frame (°)		1145/713		1145/714		1145/714	
	Rain hood with wall cover frame (°)		-		1145/614		-	
WALL MOUNTED(#)	Case with hood, frame and module holders		-		1145/314		-	
GATE PILLAR(#)	Case with hood, frame and module holders		-		-		-	

(°) alternatives
(#) alternatives

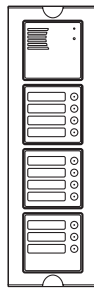

11

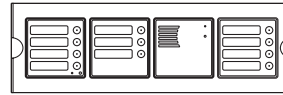

11

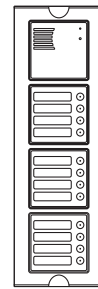

12

	Button modules	Repertory module	1145/13 + 2 x 1145/14	-	1145/13 + 2 x 1145/14	-	3 x 1145/12 + 1145/14	-
	Door unit modules		1145/20		1145/20		1145/20	
	Door unit		1145/67		1145/67		1145/67	
	Conversation privacy device		3 x 1145/74		3 x 1145/74		3 x 1145/74	
FLUSH MOUNTED (#)	Flush-mounting box		1145/54		1145/54		1145/54	
	Module holders and frames		1145/64		1145/64		1145/64	
FLUSH-MOUNTING ACCESSORIES	Wall cover frame (°)		1145/714		1145/714		1145/714	
	Rain hood with wall cover frame (°)		1145/614		-		1145/614	
WALL MOUNTED(#)	Case with hood, frame and module holders		1145/314		-		1145/314	
GATE PILLAR(#)	Case with hood, frame and module holders		-		-		-	

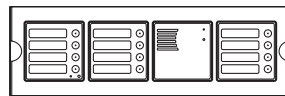

12

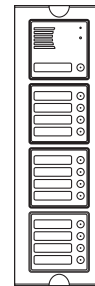

13

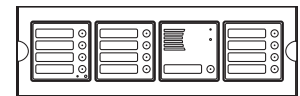

13

	Button modules	Repertory module	3 x 1145/14	-	3 x 1145/14	-	3 x 1145/14	-
	Door unit modules		1145/20		1145/21		1145/21	
	Door unit		1145/67		1145/67		1145/67	
	Conversation privacy device		3 x 1145/74		3 x 1145/74		3 x 1145/74	
FLUSH MOUNTED (#)	Flush-mounting box		1145/54		1145/54		1145/54	
	Module holders and frames		1145/64		1145/64		1145/64	
FLUSH-MOUNTING ACCESSORIES	Wall cover frame (°)		1145/714		1145/714		1145/714	
	Rain hood with wall cover frame (°)		-		1145/614		-	
WALL MOUNTED(#)	Case with hood, frame and module holders		-		1145/314		-	
GATE PILLAR(#)	Case with hood, frame and module holders		-		-		-	

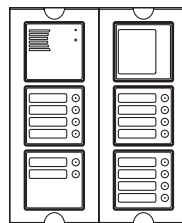

14

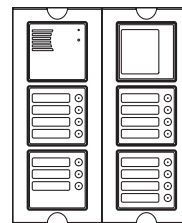

15

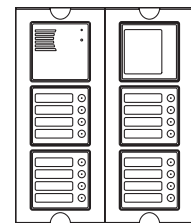

16

	Button modules	Repertory module	3 x 1145/14 + 1145/12	1145/50	3 x 1145/14 + 1145/13	1145/50	4 x 1145/14	1145/50
	Door unit modules		1145/20		1145/20		1145/20	
	Door unit		1145/67		1145/67		1145/67	
	Conversation privacy device		4 x 1145/74		4 x 1145/74		4 x 1145/74	
FLUSH MOUNTED (#)	Flush-mounting box		2 x 1145/53		2 x 1145/53		2 x 1145/53	
	Module holders and frames		2 x 1145/63		2 x 1145/63		2 x 1145/63	
FLUSH-MOUNTING ACCESSORIES	Wall cover frame (°)		1145/726		1145/726		1145/726	
	Rain hood with wall cover frame (°)		1145/626		1145/626		1145/626	
WALL MOUNTED(#)	Case with hood, frame and module holders		1145/326		1145/326		1145/326	
GATE PILLAR(#)	Case with hood, frame and module holders		-		-		-	



SINTHESI PANELS 1+1 WIRE DOOR PHONE SYSTEMS



EXAMPLES OF MODULAR CONSTRUCTIONS WITH VARIOUS CAPACITIES

(°) alternatives
(#) alternatives



17

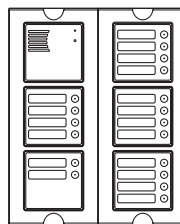

18

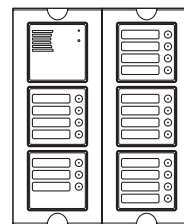

19

	Button modules	Repertory module	4 x 1145/14	1145/50	4 x 1145/14 + 1145/12	-	1145/13 + 1145/14	-
	Door unit modules		1145/21		1145/20		1145/20	
	Door unit		1145/67		1145/67		1145/67	
	Conversation privacy device		4 x 1145/74		5 x 1145/74		5 x 1145/74	
FLUSH MOUNTED (#)	Flush-mounting box		2 x 1145/53		2 x 1145/53		2 x 1145/53	
	Module holders and frames		2 x 1145/63		2 x 1145/63		2 x 1145/63	
FLUSH-MOUNTING ACCESSORIES	Wall cover frame (°)		1145/726		1145/726		1145/726	
	Rain hood with wall cover frame (°)		1145/626		1145/626		1145/626	
WALL MOUNTED(#)	Case with hood, frame and module holders		1145/326		1145/326		1145/326	
GATE PILLAR(#)	Case with hood, frame and module holders		-		-		-	

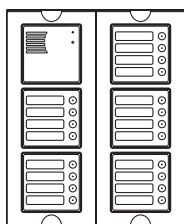

20

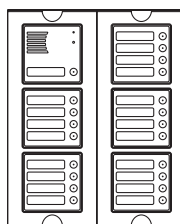

21

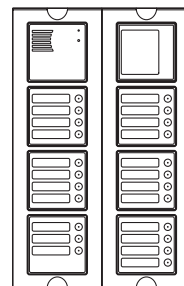

23

	Button modules	Repertory module	5 x 1145/14	-	5 x 1145/14	-	5 x 1145/14 + 1145/13	1145/50
	Door unit modules		145/20		1145/21		1145/20	
	Door unit		1145/67		1145/67		1145/67	
	Conversation privacy device		5 x 1145/74		5 x 1145/74		6 x 1145/74	
FLUSH MOUNTED (#)	Flush-mounting box		2 x 1145/53		2 x 1145/53		2 x 1145/54	
	Module holders and frames		2 x 1145/63		2 x 1145/63		2 x 1145/64	
FLUSH-MOUNTING ACCESSORIES	Wall cover frame (°)		1145/726		1145/726		1145/728	
	Rain hood with wall cover frame (°)		1145/626		1145/626		1145/628	
WALL MOUNTED(#)	Case with hood, frame and module holders		1145/326		1145/326		1145/328	
GATE PILLAR(#)	Case with hood, frame and module holders		-		-		-	

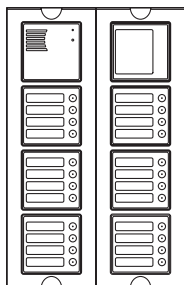

24

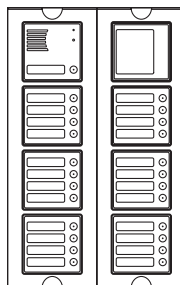

25

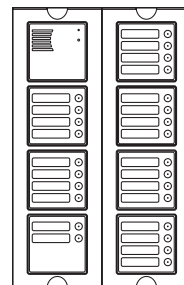

26

	Button modules	Repertory module	6 x 1145/14	1145/50	6 x 1145/14	1145/50	6 x 1145/14 + 1145/12	-
	Door unit modules		145/20		1145/21		1145/20	
	Door unit		1145/67		1145/67		1145/67	
	Conversation privacy device		6 x 1145/74		6 x 1145/74		7 x 1145/74	
FLUSH MOUNTED (#)	Flush-mounting box		2 x 1145/54		2 x 1145/54		2 x 1145/54	
	Module holders and frames		2 x 1145/64		2 x 1145/64		2 x 1145/64	
FLUSH-MOUNTING ACCESSORIES	Wall cover frame (°)		1145/728		1145/728		1145/728	
	Rain hood with wall cover frame (°)		1145/628		1145/628		1145/628	
WALL MOUNTED(#)	Case with hood, frame and module holders		1145/328		1145/328		1145/328	
GATE PILLAR(#)	Case with hood, frame and module holders		-		-		-	

(°) alternatives
(#) alternatives

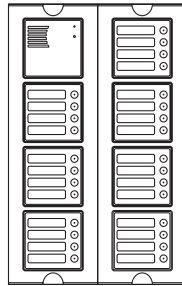

28

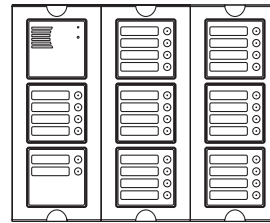

30

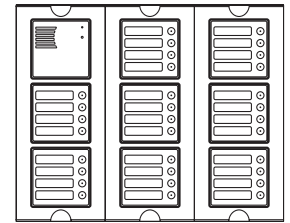

32

	Button modules	Repertory module	7 x 1145/14	-	7 x 1145/14 + 1145/12	-	8 x 1145/14	-
	Door unit modules		1145/20		1145/20		1145/20	
	Door unit		1145/67		1145/67		1145/67	
	Conversation privacy device		7 x 1145/74		8 x 1145/74		8 x 1145/74	
FLUSH MOUNTED (#)	Flush-mounting box		2 x 1145/54		3 x 1145/53		3 x 1145/53	
	Module holders and frames		2 x 1145/64		3 x 1145/63		3 x 1145/63	
FLUSH-MOUNTING ACCESSORIES	Wall cover frame (°)		1145/728		1145/739		1145/739	
	Rain hood with wall cover frame (°)		1145/628		1145/639		1145/639	
WALL MOUNTED(#)	Case with hood, frame and module holders		1145/328		1145/339		1145/339	
GATE PILLAR(#)	Case with hood, frame and module holders		-		-		-	

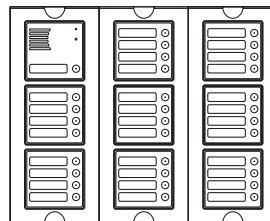

33

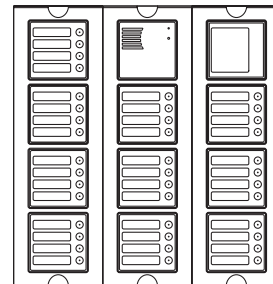

40

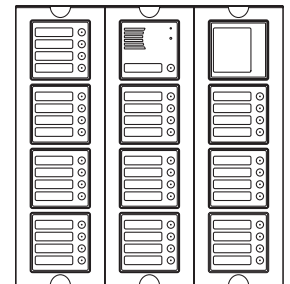

41

	Button modules	Repertory module	8 x 1145/14	-	10 x 1145/14	1145/50	10 x 1145/14	1145/50
	Door unit modules		1145/21		1145/20		1145/21	
	Door unit		1145/67		1145/67		1145/67	
	Conversation privacy device		8 x 1145/74		10 x 1145/74		10 x 1145/74	
FLUSH MOUNTED (#)	Flush-mounting box		3 x 1145/53		3 x 1145/54		3 x 1145/54	
	Module holders and frames		3 x 1145/63		3 x 1145/64		3 x 1145/64	
FLUSH-MOUNTING ACCESSORIES	Wall cover frame (°)		1145/739		1145/732		1145/732	
	Rain hood with wall cover frame (°)		1145/639		1145/632		1145/632	
WALL MOUNTED(#)	Case with hood, frame and module holders		1145/339		1145/332		1145/332	
GATE PILLAR(#)	Case with hood, frame and module holders		-		-		-	

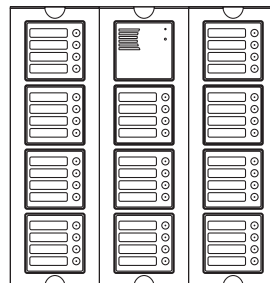

44

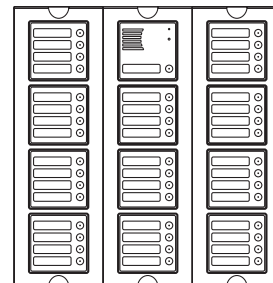

45

	Button modules	Repertory module	11 x 1145/14	-	11 x 1145/14	-		
	Door unit modules		1145/20		1145/21			
	Door unit		1145/67		1145/67			
	Conversation privacy device		11 x 1145/74		11 x 1145/74			
FLUSH MOUNTED (#)	Flush-mounting box		3 x 1145/54		3 x 1145/54			
	Module holders and frames		3 x 1145/64		3 x 1145/64			
FLUSH-MOUNTING ACCESSORIES	Wall cover frame (°)		1145/732		1145/732			
	Rain hood with wall cover frame (°)		1145/632		1145/632			
WALL MOUNTED(#)	Case with hood, frame and module holders		1145/332		1145/332			
GATE PILLAR(#)	Case with hood, frame and module holders		-		-			



**SINTHESI PANELS
B&W COAX VIDEO DOOR PHONE SYSTEMS**



EXAMPLES OF MODULAR CONSTRUCTIONS WITH VARIOUS CAPACITIES

(°) alternatives
(#) alternatives



1



2

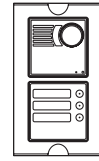

3

	Button modules	Repertory module	-	-	-	-	1145/13	-
	Camera modules and door unit		1745/81		1745/82		1745/80	
FLUSH MOUNTED (#)	Flush-mounting box		1145/51		1145/51		1145/52	
	Module holders and frames		1145/61		1145/61		1145/62	
FLUSH-MOUNTING ACCESSORIES	Wall cover frame (°)		1145/711		1145/711		1145/712	
	Rain hood with wall cover frame (°)		1145/611		1145/611		1145/612	
WALL MOUNTED(#)	Case with hood, frame and module holders		1145/311		1145/311		1145/312	
GATE PILLAR(#)	Case with hood, frame and module holders		-		-		1145/342	

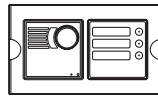

3

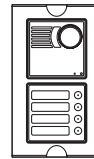

4

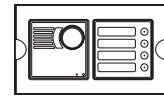

4

	Button modules	Repertory module	1145/13	-	1145/14	-	1145/14	-
	Camera modules and door unit		1745/80		1745/80		1745/80	
FLUSH MOUNTED (#)	Flush-mounting box		1145/52		1145/52		1145/52	
	Module holders and frames		1145/62		1145/62		1145/62	
FLUSH-MOUNTING ACCESSORIES	Wall cover frame (°)		1145/712		1145/712		1145/712	
	Rain hood with wall cover frame (°)		-		1145/612		-	
WALL MOUNTED(#)	Case with hood, frame and module holders		-		1145/312		-	
GATE PILLAR(#)	Case with hood, frame and module holders		-		1145/342		-	

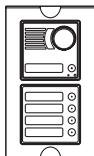

5

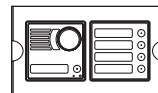

5

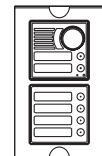

6

	Button modules	Repertory module	1145/14	-	1145/14	-	1145/14	-
	Camera modules and door unit		1745/81		1745/81		1745/82	
FLUSH MOUNTED (#)	Flush-mounting box		1145/52		1145/52		1145/52	
	Module holders and frames		1145/62		1145/62		1145/62	
FLUSH-MOUNTING ACCESSORIES	Wall cover frame (°)		1145/712		1145/712		1145/712	
	Rain hood with wall cover frame (°)		1145/612		-		1145/612	
WALL MOUNTED(#)	Case with hood, frame and module holders		1145/312		-		1145/312	
GATE PILLAR(#)	Case with hood, frame and module holders		1145/342		-		1145/342	

(°) alternatives
(#) alternatives

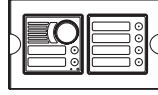

6

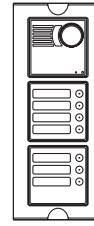

7

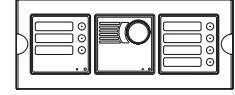

7

	Button modules	Repertory module	1145/14	-	1145/14 + 1145/13	-	1145/14 + 1145/13	-
	Camera modules and door unit		1745/82		1745/80		1745/80	
FLUSH MOUNTED (#)	Flush-mounting box		1145/52		1145/53		1145/53	
	Module holders and frames		1145/62		1145/63		1145/63	
FLUSH-MOUNTING ACCESSORIES	Wall cover frame (°)		1145/712		1145/713		1145/713	
	Rain hood with wall cover frame (°)		-		1145/613		-	
WALL MOUNTED(#)	Case with hood, frame and module holders		-		1145/313		-	
GATE PILLAR(#)	Case with hood, frame and module holders		-		1145/343		-	

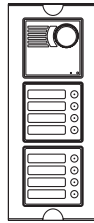

8

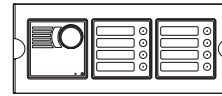

8

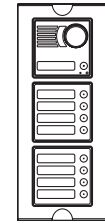

9

	Button modules	Repertory module	2 x 1145/14	-	2 x 1145/14	-	2 x 1145/14	-
	Camera modules and door unit		1745/80		1745/80		1745/81	
FLUSH MOUNTED (#)	Flush-mounting box		1145/53		1145/53		1145/53	
	Module holders and frames		1145/63		1145/63		1145/63	
FLUSH-MOUNTING ACCESSORIES	Wall cover frame (°)		1145/713		1145/713		1145/713	
	Rain hood with wall cover frame (°)		1145/613		-		1145/613	
WALL MOUNTED(#)	Case with hood, frame and module holders		1145/313		-		1145/313	
GATE PILLAR(#)	Case with hood, frame and module holders		1145/343		-		1145/343	

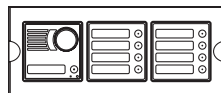

9

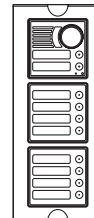

10

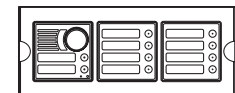

10

	Button modules	Repertory module	2 x 1145/14	-	2 x 1145/14	-	2 x 1145/14	-
	Camera modules and door unit		1745/81		1745/82		1745/82	
FLUSH MOUNTED (#)	Flush-mounting box		1145/53		1145/53		1145/53	
	Module holders and frames		1145/63		1145/63		1145/63	
FLUSH-MOUNTING ACCESSORIES	Wall cover frame (°)		1145/713		1145/713		1145/713	
	Rain hood with wall cover frame (°)		-		1145/613		-	
WALL MOUNTED(#)	Case with hood, frame and module holders		-		1145/313		-	
GATE PILLAR(#)	Case with hood, frame and module holders		-		1145/343		-	



SINTHESI PANELS
B&W COAX VIDEO DOOR PHONE SYSTEMS



EXAMPLES OF MODULAR CONSTRUCTIONS WITH VARIOUS CAPACITIES

(°) alternatives
(#) alternatives

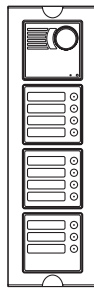

11

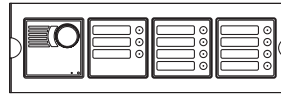

11

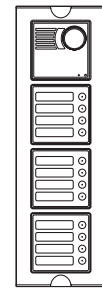

12

	Button modules	Repertory module	2 x 1145/14 + 1145/13	-	2 x 1145/14 + 1145/13	-	3 x 1145/14	-
	Camera modules and door unit		1745/80		1745/80		1745/80	
FLUSH MOUNTED (#)	Flush-mounting box		1145/54		1145/54		1145/54	
	Module holders and frames		1145/64		1145/64		1145/64	
FLUSH-MOUNTING ACCESSORIES	Wall cover frame (°)		1145/714		1145/714		1145/714	
	Rain hood with wall cover frame (°)		1145/614		-		1145/614	
WALL MOUNTED(#)	Case with hood, frame and module holders		1145/314		-		1145/314	
GATE PILLAR(#)	Case with hood, frame and module holders		-		-		-	



12

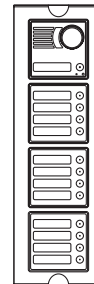

13

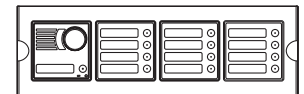

13

	Button modules	Repertory module	3 x 1145/14	-	3 x 1145/14	-	3 x 1145/14	-
	Camera modules and door unit		1745/80		1745/81		1745/81	
FLUSH MOUNTED (#)	Flush-mounting box		1145/54		1145/54		1145/54	
	Module holders and frames		1145/64		1145/64		1145/64	
FLUSH-MOUNTING ACCESSORIES	Wall cover frame (°)		1145/714		1145/714		1145/714	
	Rain hood with wall cover frame (°)		-		1145/614		-	
WALL MOUNTED(#)	Case with hood, frame and module holders		-		1145/314		-	
GATE PILLAR(#)	Case with hood, frame and module holders		-		-		-	

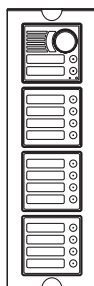

14

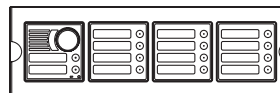

14

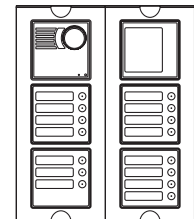

15

	Button modules	Repertory module	3 x 1145/14	-	3 x 1145/14	-	3 x 1145/14 + 1145/13	1145/50
	Camera modules and door unit		1745/82		1745/82		1745/80	
FLUSH MOUNTED (#)	Flush-mounting box		1145/54		1145/54		2 x 1145/53	
	Module holders and frames		1145/64		1145/64		2 x 1145/63	
FLUSH-MOUNTING ACCESSORIES	Wall cover frame (°)		1145/714		1145/714		1145/726	
	Rain hood with wall cover frame (°)		1145/614		-		1145/626	
WALL MOUNTED(#)	Case with hood, frame and module holders		1145/314		-		1145/326	
GATE PILLAR(#)	Case with hood, frame and module holders		-		-		-	

(°) alternatives
(#) alternatives

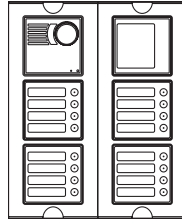

16

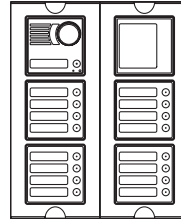

17

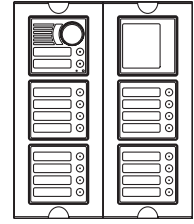

18

	Button modules	Repertory module	4 x 1145/14	1145/50	4 x 1145/14	1145/50	4 x 1145/14	1145/50
	Camera modules and door unit		1745/80		1745/81		1745/82	
FLUSH MOUNTED (#)	Flush-mounting box		2 x 1145/53		2 x 1145/53		2 x 1145/53	
	Module holders and frames		2 x 1145/63		2 x 1145/63		2 x 1145/63	
FLUSH-MOUNTING ACCESSORIES	Wall cover frame (°)		1145/726		1145/726		1145/726	
	Rain hood with wall cover frame (°)		1145/626		1145/626		1145/626	
WALL MOUNTED(#)	Case with hood, frame and module holders		1145/326		1145/326		1145/326	
GATE PILLAR(#)	Case with hood, frame and module holders		-		-		-	

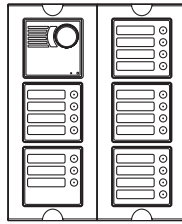

19

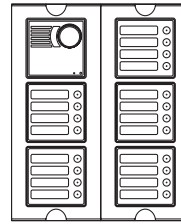

20

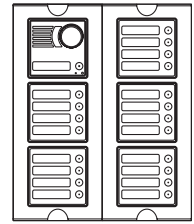

21

	Button modules	Repertory module	4 x 1145/14 + 1145/13	-	5 x 1145/14	-	5 x 1145/14	-
	Camera modules and door unit		1745/80		1745/80		1745/81	
FLUSH MOUNTED (#)	Flush-mounting box		2 x 1145/53		2 x 1145/53		2 x 1145/53	
	Module holders and frames		2 x 1145/63		2 x 1145/63		2 x 1145/63	
FLUSH-MOUNTING ACCESSORIES	Wall cover frame (°)		1145/726		1145/726		1145/726	
	Rain hood with wall cover frame (°)		1145/626		1145/626		1145/626	
WALL MOUNTED(#)	Case with hood, frame and module holders		1145/326		1145/326		1145/326	
GATE PILLAR(#)	Case with hood, frame and module holders		-		-		-	

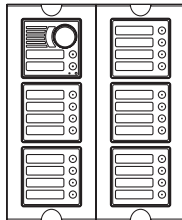

22

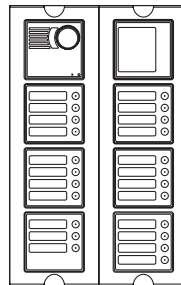

23

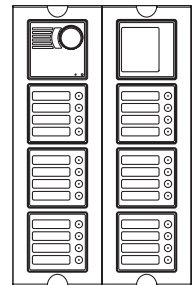

24

	Button modules	Repertory module	5 x 1145/14	-	5 x 1145/14 + 1145/13	1145/50	6 x 1145/14	1145/50
	Camera modules and door unit		1745/82		1745/80		1745/80	
FLUSH MOUNTED (#)	Flush-mounting box		2 x 1145/53		2 x 1145/54		2 x 1145/54	
	Module holders and frames		2 x 1145/63		2 x 1145/64		2 x 1145/64	
FLUSH-MOUNTING ACCESSORIES	Wall cover frame (°)		1145/726		1145/728		1145/728	
	Rain hood with wall cover frame (°)		1145/626		1145/628		1145/628	
WALL MOUNTED(#)	Case with hood, frame and module holders		1145/326		1145/328		1145/328	
GATE PILLAR(#)	Case with hood, frame and module holders		-		-		-	



SINTHESI PANELS B&W COAX VIDEO DOOR PHONE SYSTEMS



EXAMPLES OF MODULAR CONSTRUCTIONS WITH VARIOUS CAPACITIES

(°) alternatives
(#) alternatives

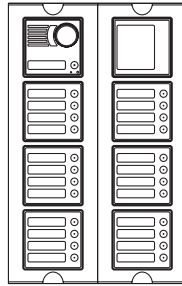

25

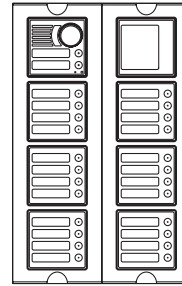

26

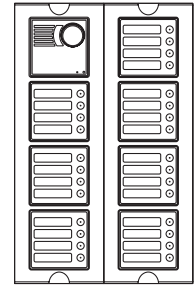

28

	Button modules	Repertory module	6 x 1145/14	1145/50	6 x 1145/14	1145/50	7 x 1145/14	-
	Camera modules and door unit		1745/81		1745/82		1745/80	
FLUSH MOUNTED (#)	Flush-mounting box		2 x 1145/54		2 x 1145/54		2 x 1145/54	
	Module holders and frames		2 x 1145/64		2 x 1145/64		2 x 1145/64	
FLUSH-MOUNTING ACCESSORIES	Wall cover frame (°)		1145/728		1145/728		1145/728	
	Rain hood with wall cover frame (°)		1145/628		1145/628		1145/628	
WALL MOUNTED(#)	Case with hood, frame and module holders		1145/328		1145/328		1145/328	
GATE PILLAR(#)	Case with hood, frame and module holders		-		-		-	

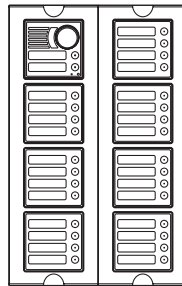

30

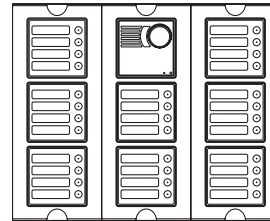

32

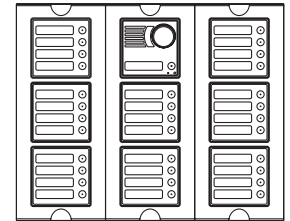

33

	Button modules	Repertory module	7 x 1145/14	-	8 x 1145/14	-	8 x 1145/14	-
	Camera modules and door unit		1745/82		1745/80		1745/81	
FLUSH MOUNTED (#)	Flush-mounting box		2 x 1145/54		3 x 1145/53		3 x 1145/53	
	Module holders and frames		2 x 1145/64		3 x 1145/63		3 x 1145/63	
FLUSH-MOUNTING ACCESSORIES	Wall cover frame (°)		1145/728		1145/739		1145/739	
	Rain hood with wall cover frame (°)		1145/628		1145/639		1145/639	
WALL MOUNTED(#)	Case with hood, frame and module holders		1145/328		1145/339		1145/339	
GATE PILLAR(#)	Case with hood, frame and module holders		-		-		-	

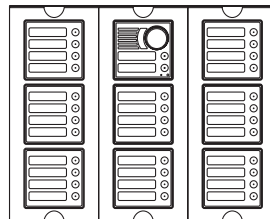

34

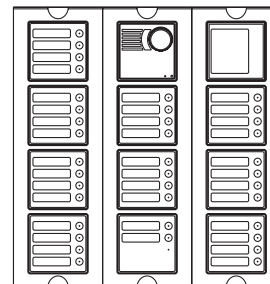

38

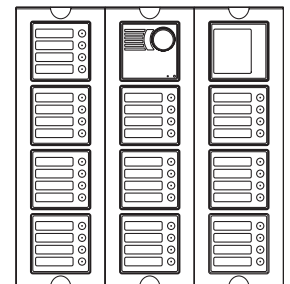

40

	Button modules	Repertory module	8 x 1145/14	-	9 x 1145/14 + 1145/12	1145/50	10 x 1145/14	1145/50
	Camera modules and door unit		1745/82		1745/80		1745/80	
FLUSH MOUNTED (#)	Flush-mounting box		3 x 1145/53		3 x 1145/54		3 x 1145/54	
	Module holders and frames		3 x 1145/63		3 x 1145/64		3 x 1145/64	
FLUSH-MOUNTING ACCESSORIES	Wall cover frame (°)		1145/739		1145/732		1145/732	
	Rain hood with wall cover frame (°)		1145/639		1145/632		1145/632	
WALL MOUNTED(#)	Case with hood, frame and module holders		1145/339		1145/332		1145/332	
GATE PILLAR(#)	Case with hood, frame and module holders		-		-		-	

(°) alternatives
(#) alternatives

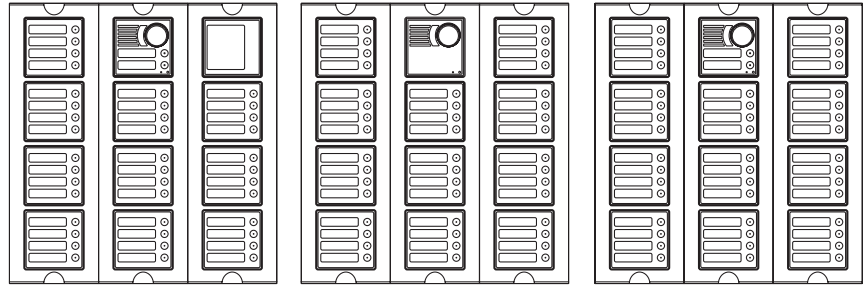

42

44

46

	Button modules	Repertory module	10 x 1145/14	1145/50	11 x 1145/14	-	11 x 1145/14	-
	Camera modules and door unit		1745/82		1745/80		1745/82	
FLUSH MOUNTED (#)	Flush-mounting box		3 x 1145/54		3 x 1145/54		3 x 1145/54	
	Module holders and frames		3 x 1145/64		3 x 1145/64		3 x 1145/64	
FLUSH-MOUNTING ACCESSORIES	Wall cover frame (°)		1145/732		1145/732		1145/732	
	Rain hood with wall cover frame (°)		1145/632		1145/632		1145/632	
WALL MOUNTED(#)	Case with hood, frame and module holders		1145/332		1145/332		1145/332	
GATE PILLAR(#)	Case with hood, frame and module holders		-		-		-	



SINTHESI PANELS B&W 5-WIRE VIDEO DOOR PHONE SYSTEMS



EXAMPLES OF MODULAR CONSTRUCTIONS WITH VARIOUS CAPACITIES

(°) alternatives
(#) alternatives

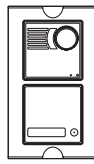

1

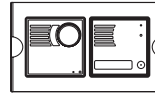

1

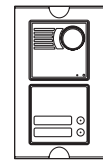

2

	Button modules	Repertory module	-	-	-	-	-
	Camera modules and door unit		1745/21		1745/70		1745/22
	Door unit module		-		1145/21		-
	Door unit		-		1145/67		-
	Conversation privacy device		-		-		-
	Camera adapter		-		1742/13A		-
FLUSH MOUNTED (#)	Flush-mounting box		1145/52		1145/52		1145/52
	Module holders and frames		1145/62		1145/62		1145/62
FLUSH-MOUNTING ACCESSORIES	Wall cover frame (°)		1145/712		1145/712		1145/712
	Rain hood with wall cover frame (°)		1145/612		-		1145/612
WALL MOUNTED(#)	Case with hood, frame and module holders		1145/312		-		1145/312
GATE PILLAR(#)	Case with hood, frame and module holders		1145/342		-		1145/342

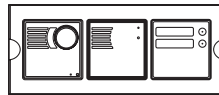

2

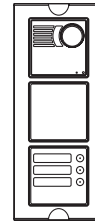

3

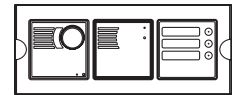

3

	Button modules	Repertory module	1145/12	-	1145/13	-	1145/13	-
	Camera modules and door unit		1745/70		1745/20		1745/70	
	Door unit module		1145/20		-		1145/20	
	Door unit		1145/67		-		1145/67	
	Conversation privacy device		1145/74		1145/74		1145/74	
	Camera adapter		1742/13A		-		1742/13A	
FLUSH MOUNTED (#)	Flush-mounting box		1145/53		1145/53		1145/53	
	Module holders and frames		1145/63		1145/63		1145/63	
FLUSH-MOUNTING ACCESSORIES	Wall cover frame (°)		1145/713		1145/713		1145/713	
	Rain hood with wall cover frame (°)		-		1145/613		-	
WALL MOUNTED(#)	Case with hood, frame and module holders		-		1145/313		-	
GATE PILLAR(#)	Case with hood, frame and module holders		-		1145/343		-	

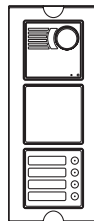

4

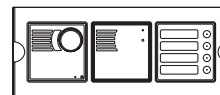

4

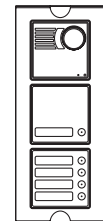

5

	Button modules	Repertory module	1145/14	-	1145/14	-	1145/14	-
	Camera modules and door unit		1745/20		1745/70		1745/21	
	Door unit module		-		1145/20		-	
	Door unit		-		1145/67		-	
	Conversation privacy device		1145/74		1145/74		1145/74	
	Camera adapter		-		1742/13A		-	
FLUSH MOUNTED (#)	Flush-mounting box		1145/53		1145/53		1145/53	
	Module holders and frames		1145/63		1145/63		1145/63	
FLUSH-MOUNTING ACCESSORIES	Wall cover frame (°)		1145/713		1145/713		1145/713	
	Rain hood with wall cover frame (°)		1145/613		-		1145/613	
WALL MOUNTED(#)	Case with hood, frame and module holders		1145/313		-		1145/313	
GATE PILLAR(#)	Case with hood, frame and module holders		1145/343		-		1145/343	

(°) alternatives
(#) alternatives

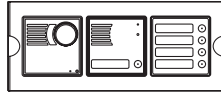

5

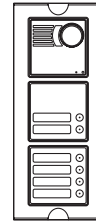

6

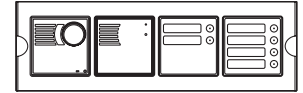

6

	Button modules	Repertory module	1145/14	-	1145/14	-	1145/14 + 1145/12	-
	Camera modules and door unit		1745/70		1745/22		1745/70	
	Door unit module		1145/21		-		1145/20	
	Door unit		1145/67		-		1145/67	
	Conversation privacy device		1145/74		1145/74		2 x 1145/74	
	Camera adapter		1742/13A		-		1742/13A	
FLUSH MOUNTED (#)	Flush-mounting box		1145/53		1145/53		1145/54	
	Module holders and frames		1145/63		1145/63		1145/64	
FLUSH-MOUNTING ACCESSORIES	Wall cover frame (°)		1145/713		1145/713		1145/714	
	Rain hood with wall cover frame (°)		-		1145/613		-	
WALL MOUNTED(#)	Case with hood, frame and module holders		-		1145/313		-	
GATE PILLAR(#)	Case with hood, frame and module holders		-		1145/343		-	

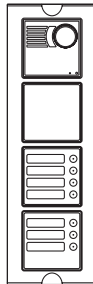

7

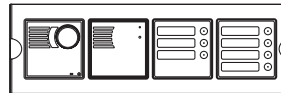

7

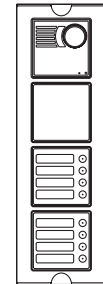

8

	Button modules	Repertory module	1145/14 + 1145/13	-	1145/14 + 1145/13	-	2 x 1145/14	-
	Camera modules and door unit		1745/20		1745/70		1745/20	
	Door unit module		-		1145/20		-	
	Door unit		-		1145/67		-	
	Conversation privacy device		2 x 1145/74		2 x 1145/74		2 x 1145/74	
	Camera adapter		-		1742/13A		-	
FLUSH MOUNTED (#)	Flush-mounting box		1145/54		1145/54		1145/54	
	Module holders and frames		1145/64		1145/64		1145/64	
FLUSH-MOUNTING ACCESSORIES	Wall cover frame (°)		1145/714		1145/714		1145/714	
	Rain hood with wall cover frame (°)		1145/614		-		1145/614	
WALL MOUNTED(#)	Case with hood, frame and module holders		1145/314		-		1145/314	
GATE PILLAR(#)	Case with hood, frame and module holders		-		-		-	



SINTHESI PANELS B&W 5-WIRE VIDEO DOOR PHONE SYSTEMS



EXAMPLES OF MODULAR CONSTRUCTIONS WITH VARIOUS CAPACITIES

(°) alternatives
(#) alternatives

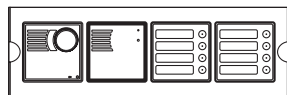

8

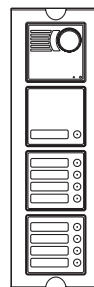

9

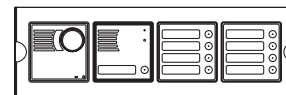

9

	Button modules	Repertory module	2 x 1145/14	-	2 x 1145/14	-	2 x 1145/14	-
	Camera modules and door unit		1745/70		1745/21		1745/70	
	Door unit module		1145/20		-		1145/21	
	Door unit		1145/67		-		1145/67	
	Conversation privacy device		2 x 1145/74		2 x 1145/74		2 x 1145/74	
	Camera adapter		1742/13A		-		1742/13A	
FLUSH MOUNTED (#)	Flush-mounting box		1145/54		1145/54		1145/54	
	Module holders and frames		1145/64		1145/64		1145/64	
FLUSH-MOUNTING ACCESSORIES	Wall cover frame (°)		1145/714		1145/714		1145/714	
	Rain hood with wall cover frame (°)		-		1145/614		-	
WALL MOUNTED(#)	Case with hood, frame and module holders		-		1145/314		-	
GATE PILLAR(#)	Case with hood, frame and module holders		-		-		-	

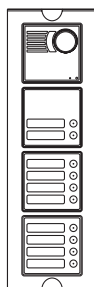

10

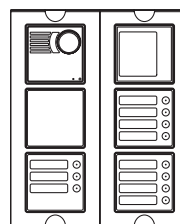

11

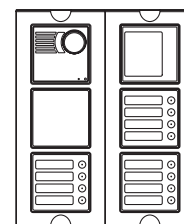

12

	Button modules	Repertory module	2 x 1145/14	-	2 x 1145/14 + 1145/13	1145/50	3 x 1145/14	1145/50
	Camera modules and door unit		1745/22		1745/20		1745/20	
	Door unit module		-		-		-	
	Door unit		-		-		-	
	Conversation privacy device		2 x 1145/74		3 x 1145/74		3 x 1145/74	
	Camera adapter		-		-		-	
FLUSH MOUNTED (#)	Flush-mounting box		1145/54		2 x 1145/53		2 x 1145/53	
	Module holders and frames		1145/64		2 x 1145/63		2 x 1145/63	
FLUSH-MOUNTING ACCESSORIES	Wall cover frame (°)		1145/714		1145/726		1145/726	
	Rain hood with wall cover frame (°)		1145/614		1145/626		1145/626	
WALL MOUNTED(#)	Case with hood, frame and module holders		1145/314		1145/326		1145/326	
GATE PILLAR(#)	Case with hood, frame and module holders		-		-		-	

(°) alternatives
(#) alternatives

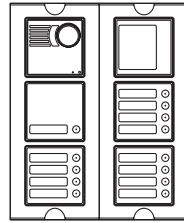

13

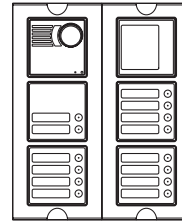

14

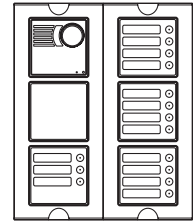

15

	Button modules	Repertory module	3 x 1145/14	1145/50	3 x 1145/14	1145/50	3 x 1145/14 + 1145/13	-
	Camera modules and door unit		1745/21		1745/22		1745/20	
	Door unit module		-		-		-	
	Door unit		-		-		-	
	Conversation privacy device		3 x 1145/74		3 x 1145/74		4 x 1145/74	
	Camera adapter		-		-		-	
FLUSH MOUNTED (#)	Flush-mounting box		1145/53		1145/53		1145/53	
	Module holders and frames		1145/63		1145/63		1145/63	
FLUSH-MOUNTING ACCESSORIES	Wall cover frame (°)		1145/726		1145/726		1145/726	
	Rain hood with wall cover frame (°)		1145/626		1145/626		1145/626	
WALL MOUNTED(#)	Case with hood, frame and module holders		1145/326		1145/326		1145/326	
GATE PILLAR(#)	Case with hood, frame and module holders		-		-		-	

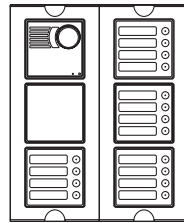

16

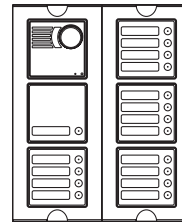

17

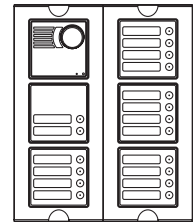

18

	Button modules	Repertory module	4 x 1145/14	-	4 x 1145/14	-	4 x 1145/14	-
	Camera modules and door unit		1745/20		1745/21		1745/22	
	Door unit module		-		-		-	
	Door unit		-		-		-	
	Conversation privacy device		4 x 1145/74		4 x 1145/74		4 x 1145/74	
	Camera adapter		-		-		-	
FLUSH MOUNTED (#)	Flush-mounting box		2 x 1145/53		2 x 1145/53		2 x 1145/53	
	Module holders and frames		2 x 1145/63		2 x 1145/63		2 x 1145/63	
FLUSH-MOUNTING ACCESSORIES	Wall cover frame (°)		1145/726		1145/726		1145/726	
	Rain hood with wall cover frame (°)		1145/626		1145/626		1145/626	
WALL MOUNTED(#)	Case with hood, frame and module holders		1145/326		1145/326		1145/326	
GATE PILLAR(#)	Case with hood, frame and module holders		-		-		-	



SINTHESI PANELS B&W 5-WIRE VIDEO DOOR PHONE SYSTEMS



EXAMPLES OF MODULAR CONSTRUCTIONS WITH VARIOUS CAPACITIES

(°) alternatives
(#) alternatives

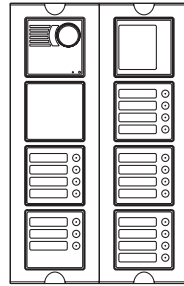

19

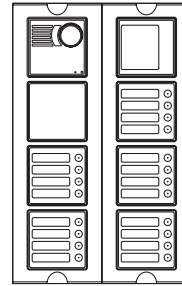

20

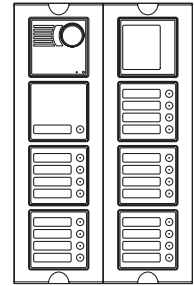

21

	Button modules	Repertory module	4 x 1145/14 + 1145/13	1145/50	5 x 1145/14	1145/50	5 x 1145/14	1145/50
	Camera modules and door unit		1745/20		1745/20		1745/21	
	Door unit module		-		-		-	
	Door unit		-		-		-	
	Conversation privacy device		5 x 1145/74		5 x 1145/74		5 x 1145/74	
	Camera adapter		-		-		-	
FLUSH MOUNTED (#)	Flush-mounting box		2 x 1145/54		2 x 1145/54		2 x 1145/54	
	Module holders and frames		2 x 1145/64		2 x 1145/64		2 x 1145/64	
FLUSH-MOUNTING ACCESSORIES	Wall cover frame (°)		1145/728		1145/728		1145/728	
	Rain hood with wall cover frame (°)		1145/628		1145/628		1145/628	
WALL MOUNTED(#)	Case with hood, frame and module holders		1145/328		1145/328		1145/328	
GATE PILLAR(#)	Case with hood, frame and module holders		-		-		-	

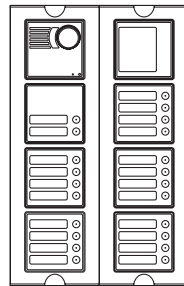

22

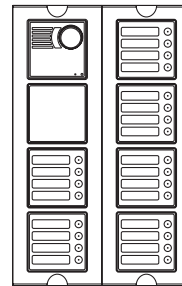

24

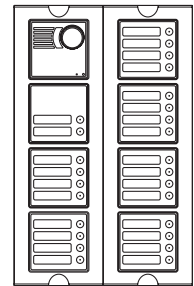

26

	Button modules	Repertory module	5 x 1145/14	1145/50	6 x 1145/14	-	6 x 1145/14	-
	Camera modules and door unit		1745/22		1745/20		1745/22	
	Door unit module		-		-		-	
	Door unit		-		-		-	
	Conversation privacy device		5 x 1145/74		6 x 1145/74		6 x 1145/74	
	Camera adapter		-		-		-	
FLUSH MOUNTED (#)	Flush-mounting box		2 x 1145/54		2 x 1145/54		2 x 1145/54	
	Module holders and frames		2 x 1145/64		2 x 1145/64		2 x 1145/64	
FLUSH-MOUNTING ACCESSORIES	Wall cover frame (°)		1145/728		1145/728		1145/728	
	Rain hood with wall cover frame (°)		1145/628		1145/628		1145/628	
WALL MOUNTED(#)	Case with hood, frame and module holders		1145/328		1145/328		1145/328	
GATE PILLAR(#)	Case with hood, frame and module holders		-		-		-	

(°) alternatives
(#) alternatives

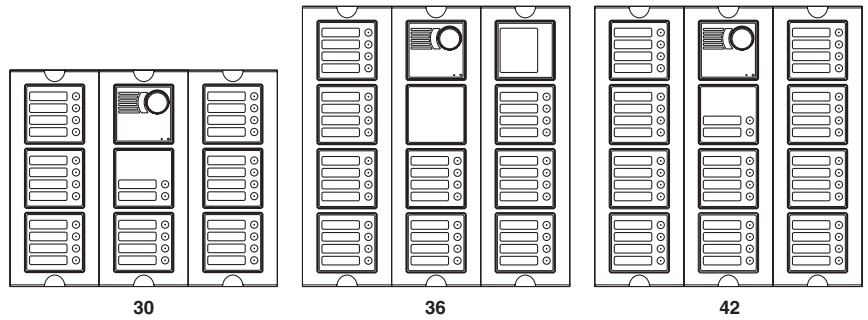

	Button modules	Repertory module	7 x 1145/14	-	9 x 1145/14	1145/50	10 x 1145/14	-
	Camera modules and door unit		1745/22		1745/20		1745/22	
	Door unit module		-		-		-	
	Door unit		-		-		-	
	Conversation privacy device		7 x 1145/74		9 x 1145/74		10 x 1145/74	
	Camera adapter		-		-		-	
FLUSH MOUNTED (#)	Flush-mounting box		3 x 1145/53		3 x 1145/54		3 x 1145/54	
	Module holders and frames		3 x 1145/63		3 x 1145/64		3 x 1145/64	
FLUSH-MOUNTING ACCESSORIES	Wall cover frame (°)		1145/739		1145/732		1145/732	
	Rain hood with wall cover frame (°)		1145/639		1145/632		1145/632	
WALL MOUNTED(#)	Case with hood, frame and module holders		1145/339		1145/332		1145/332	
GATE PILLAR(#)	Case with hood, frame and module holders		-		-		-	



SINTHESI PANELS COLOUR COAX VIDEO DOOR PHONE SYSTEMS



EXAMPLES OF MODULAR CONSTRUCTIONS WITH VARIOUS CAPACITIES

(°) alternatives
(#) alternatives

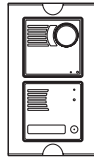

1

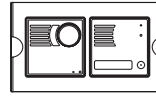

1

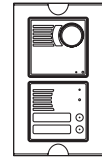

2

	Button modules	Repertory module	-	-	-	-	-
	Door unit module		1145/21		1145/21		1145/22
	Camera unit modules		1745/40		1745/40		1745/40
	Door unit		1145/500		1145/500		1145/500
FLUSH MOUNTED (#)	Flush-mounting box		1145/52		1145/52		1145/52
	Module holders and frames		1145/62		1145/62		1145/62
FLUSH-MOUNTING ACCESSORIES	Wall cover frame (°)		1145/712		1145/712		1145/712
	Rain hood with wall cover frame (°)		1145/612		-		1145/612
WALL MOUNTED(#)	Case with hood, frame and module holders		1145/312		-		1145/312
GATE PILLAR(#)	Case with hood, frame and module holders		1145/342		-		1145/342

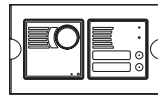

2

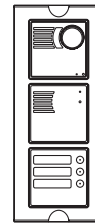

3

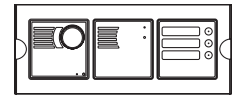

3

	Button modules	Repertory module	-	-	1145/13	-	1145/13
	Door unit module		1145/22		1145/20		1145/20
	Camera unit modules		1745/40		1745/40		1745/40
	Door unit		1145/500		1145/500		1145/500
FLUSH MOUNTED (#)	Flush-mounting box		1145/52		1145/53		1145/53
	Module holders and frames		1145/62		1145/63		1145/63
FLUSH-MOUNTING ACCESSORIES	Wall cover frame (°)		1145/712		1145/713		1145/713
	Rain hood with wall cover frame (°)		-		1145/613		-
WALL MOUNTED(#)	Case with hood, frame and module holders		-		1145/313		-
GATE PILLAR(#)	Case with hood, frame and module holders		-		1145/343		-

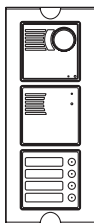

4

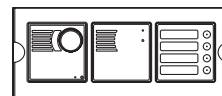

4

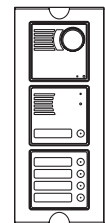

5

	Button modules	Repertory module	1145/14	-	1145/14	-	1145/14
	Door unit module		1145/20		1145/20		1145/21
	Camera unit modules		1745/40		1745/40		1745/40
	Door unit		1145/500		1145/500		1145/500
FLUSH MOUNTED (#)	Flush-mounting box		1145/53		1145/53		1145/53
	Module holders and frames		1145/63		1145/63		1145/63
FLUSH-MOUNTING ACCESSORIES	Wall cover frame (°)		1145/713		1145/713		1145/713
	Rain hood with wall cover frame (°)		1145/613		-		1145/613
WALL MOUNTED(#)	Case with hood, frame and module holders		1145/313		-		1145/313
GATE PILLAR(#)	Case with hood, frame and module holders		1145/343		-		1145/343

(°) alternatives
(#) alternatives

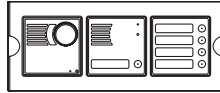

5

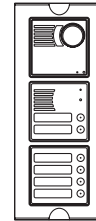

6

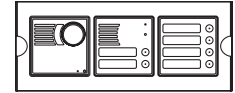

6

	Button modules	Repertory module	1145/14	-	1145/14	-	1145/14	-
	Door unit module		1145/21		1145/22		1145/22	
	Camera unit modules		1745/40		1745/40		1745/40	
	Door unit		1145/500		1145/500		1145/500	
FLUSH MOUNTED (#)	Flush-mounting box		1145/53		1145/53		1145/53	
	Module holders and frames		1145/63		1145/63		1145/63	
FLUSH-MOUNTING ACCESSORIES	Wall cover frame (°)		1145/713		1145/713		1145/713	
	Rain hood with wall cover frame (°)		-		1145/613		-	
WALL MOUNTED(#)	Case with hood, frame and module holders		-		1145/313		-	
GATE PILLAR(#)	Case with hood, frame and module holders		-		1145/343		-	

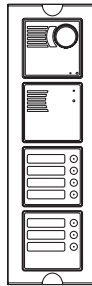

7

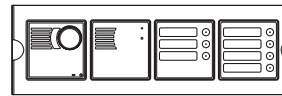

7

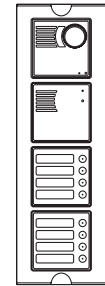

8

	Button modules	Repertory module	1145/14 + 1145/13	-	1145/14 + 1145/13	-	2 x 1145/14	-
	Door unit module		1145/20		1145/20		1145/20	
	Camera unit modules		1745/40		1745/40		1745/40	
	Door unit		1145/500		1145/500		1145/500	
FLUSH MOUNTED (#)	Flush-mounting box		1145/54		1145/54		1145/54	
	Module holders and frames		1145/64		1145/64		1145/64	
FLUSH-MOUNTING ACCESSORIES	Wall cover frame (°)		1145/714		1145/714		1145/714	
	Rain hood with wall cover frame (°)		1145/614		-		1145/614	
WALL MOUNTED(#)	Case with hood, frame and module holders		1145/314		-		1145/314	
GATE PILLAR(#)	Case with hood, frame and module holders		-		-		-	

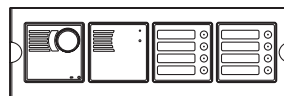

8

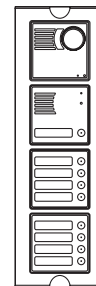

9

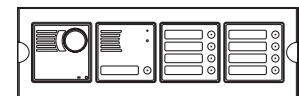

9

	Button modules	Repertory module	2 x 1145/14	-	2 x 1145/14	-	2 x 1145/14	-
	Door unit module		1145/20		1145/21		1145/21	
	Camera unit modules		1745/40		1745/40		1745/40	
	Door unit		1145/500		1145/500		1145/500	
FLUSH MOUNTED (#)	Flush-mounting box		1145/54		1145/54		1145/54	
	Module holders and frames		1145/64		1145/64		1145/64	
FLUSH-MOUNTING ACCESSORIES	Wall cover frame (°)		1145/714		1145/714		1145/714	
	Rain hood with wall cover frame (°)		-		1145/614		-	
WALL MOUNTED(#)	Case with hood, frame and module holders		-		1145/314		-	
GATE PILLAR(#)	Case with hood, frame and module holders		-		-		-	



SINTHESI PANELS COLOUR COAX VIDEO DOOR PHONE SYSTEMS



EXAMPLES OF MODULAR CONSTRUCTIONS WITH VARIOUS CAPACITIES

(°) in alternativa
(#) in alternativa

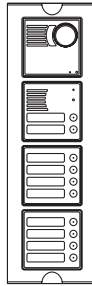

10

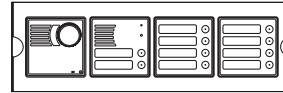

10

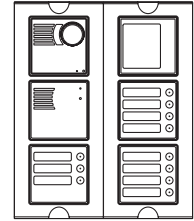

11

	Button modules	Repertory module	2 x 1145/14	-	2 x 1145/14	-	2 x 1145/14 + 1145/13	1145/50
	Door unit module		1145/22		1145/22		1145/20	
	Camera unit modules		1745/40		1745/40		1745/40	
	Door unit		1145/500		1145/500		1145/500	
FLUSH MOUNTED (#)	Flush-mounting box		1145/54		1145/54		2 x 1145/53	
	Module holders and frames		1145/64		1145/64		2 x 1145/63	
FLUSH-MOUNTING ACCESSORIES	Wall cover frame (°)		1145/714		1145/714		1145/726	
	Rain hood with wall cover frame (°)		1145/614		-		1145/626	
WALL MOUNTED(#)	Case with hood, frame and module holders		1145/314		-		1145/326	
GATE PILLAR(#)	Case with hood, frame and module holders		-		-		-	

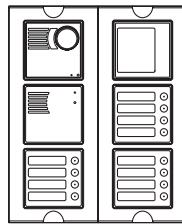

12

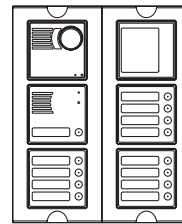

13

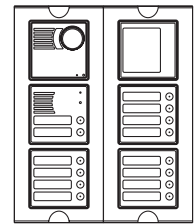

14

	Button modules	Repertory module	3 x 1145/14	1145/50	3 x 1145/14	1145/50	3 x 1145/14	1145/50
	Door unit module		1145/20		1145/21		1145/22	
	Camera unit modules		1745/40		1745/40		1745/40	
	Door unit		1145/500		1145/500		1145/500	
FLUSH MOUNTED (#)	Flush-mounting box		2 x 1145/53		2 x 1145/53		2 x 1145/53	
	Module holders and frames		2 x 1145/63		2 x 1145/63		2 x 1145/63	
FLUSH-MOUNTING ACCESSORIES	Wall cover frame (°)		1145/726		1145/726		1145/726	
	Rain hood with wall cover frame (°)		1145/626		1145/626		1145/626	
WALL MOUNTED(#)	Case with hood, frame and module holders		1145/326		1145/326		1145/326	
GATE PILLAR(#)	Case with hood, frame and module holders		-		-		-	

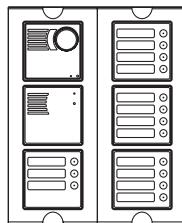

15

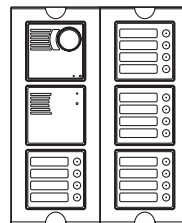

16

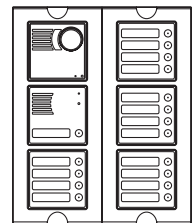

17

	Button modules	Repertory module	3 x 1145/14 + 1145/13	-	4 x 1145/14	-	4 x 1145/14	-
	Door unit module		1145/20		1145/20		1145/21	
	Camera unit modules		1745/40		1745/40		1745/40	
	Door unit		1145/500		1145/500		1145/500	
FLUSH MOUNTED (#)	Flush-mounting box		2 x 1145/53		2 x 1145/53		2 x 1145/53	
	Module holders and frames		2 x 1145/63		2 x 1145/63		2 x 1145/63	
FLUSH-MOUNTING ACCESSORIES	Wall cover frame (°)		1145/726		1145/726		1145/726	
	Rain hood with wall cover frame (°)		1145/626		1145/626		1145/626	
WALL MOUNTED(#)	Case with hood, frame and module holders		1145/326		1145/326		1145/326	
GATE PILLAR(#)	Case with hood, frame and module holders		-		-		-	

(°) alternatives
(#) alternatives

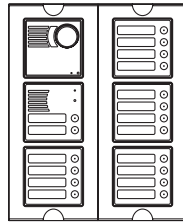

18

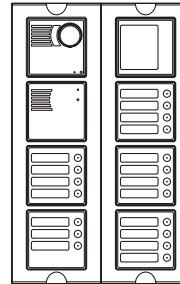

19

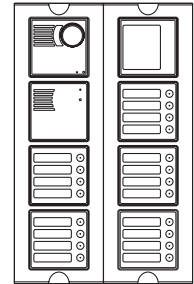

20

	Button modules	Repertory module	4 x 1145/14	-	4 x 1145/14 + 1145/13	1145/50	5 x 1145/14	1145/50
	Door unit module		1145/22		1145/20		1145/20	
	Camera unit modules		1745/40		1745/40		1745/40	
	Door unit		1145/500		1145/500		1145/500	
FLUSH MOUNTED (#)	Flush-mounting box		2 x 1145/53		2 x 1145/54		2 x 1145/54	
	Module holders and frames		2 x 1145/63		2 x 1145/64		2 x 1145/64	
FLUSH-MOUNTING ACCESSORIES	Wall cover frame (°)		1145/726		1145/728		1145/728	
	Rain hood with wall cover frame (°)		1145/626		1145/628		1145/628	
WALL MOUNTED(#)	Case with hood, frame and module holders		1145/326		1145/328		1145/328	
GATE PILLAR(#)	Case with hood, frame and module holders		-		-		-	

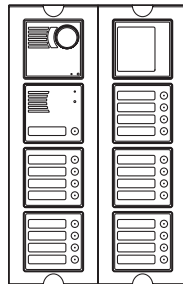

21

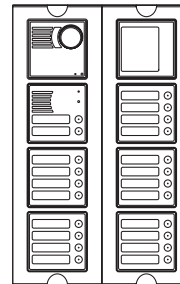

22

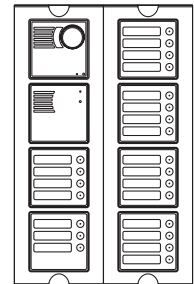

23

	Button modules	Repertory module	5 x 1145/14	1145/50	5 x 1145/14	1145/50	5 x 1145/14 + 1145/13	-
	Door unit module		1145/21		1145/22		1145/20	
	Camera unit modules		1745/40		1745/40		1745/40	
	Door unit		1145/500		1145/500		1145/500	
FLUSH MOUNTED (#)	Flush-mounting box		2 x 1145/54		2 x 1145/54		2 x 1145/54	
	Module holders and frames		2 x 1145/64		2 x 1145/64		2 x 1145/64	
FLUSH-MOUNTING ACCESSORIES	Wall cover frame (°)		1145/728		1145/728		1145/728	
	Rain hood with wall cover frame (°)		1145/628		1145/628		1145/628	
WALL MOUNTED(#)	Case with hood, frame and module holders		1145/328		1145/328		1145/328	
GATE PILLAR(#)	Case with hood, frame and module holders		-		-		-	



SINTHESI PANELS COLOUR COAX VIDEO DOOR PHONE SYSTEMS



EXAMPLES OF MODULAR CONSTRUCTIONS WITH VARIOUS CAPACITIES

(°) alternatives
(#) alternatives

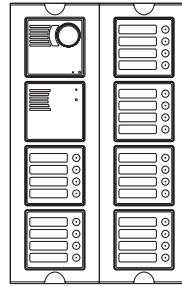

24

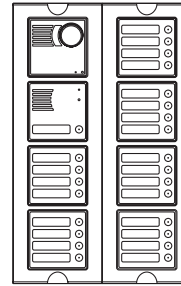

25

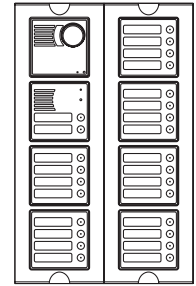

26

	Button modules	Repertory module	6 x 1145/14	-	6 x 1145/14	-	6 x 1145/14	-
	Door unit module		1145/20		1145/21		1145/22	
	Camera unit modules		1745/40		1745/40		1745/40	
	Door unit		1145/500		1145/500		1145/500	
FLUSH MOUNTED (#)	Flush-mounting box		2 x 1145/54		2 x 1145/54		2 x 1145/54	
	Module holders and frames		2 x 1145/64		2 x 1145/64		2 x 1145/64	
FLUSH-MOUNTING ACCESSORIES	Wall cover frame (°)		1145/728		1145/728		1145/728	
	Rain hood with wall cover frame (°)		1145/628		1145/628		1145/628	
WALL MOUNTED(#)	Case with hood, frame and module holders		1145/328		1145/328		1145/328	
GATE PILLAR(#)	Case with hood, frame and module holders		-		-		-	

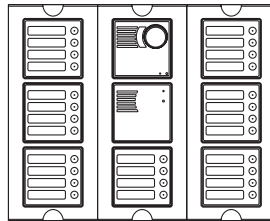

28

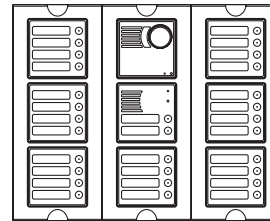

30

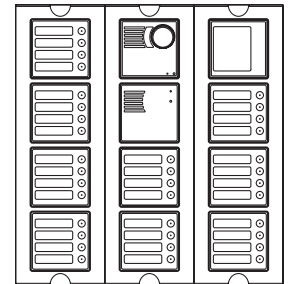

36

	Button modules	Repertory module	7 x 1145/14	-	7 x 1145/14	-	9 x 1145/14	1145/50
	Door unit module		1145/20		1145/22		1145/20	
	Camera unit modules		1745/40		1745/40		1745/40	
	Door unit		1145/500		1145/500		1145/500	
FLUSH MOUNTED (#)	Flush-mounting box		3 x 1145/53		3 x 1145/53		3 x 1145/54	
	Module holders and frames		3 x 1145/63		3 x 1145/63		3 x 1145/64	
FLUSH-MOUNTING ACCESSORIES	Wall cover frame (°)		1145/739		1145/739		1145/732	
	Rain hood with wall cover frame (°)		1145/639		1145/639		1145/632	
WALL MOUNTED(#)	Case with hood, frame and module holders		1145/339		1145/339		1145/332	
GATE PILLAR(#)	Case with hood, frame and module holders		-		-		-	

(°) alternatives
(#) alternatives

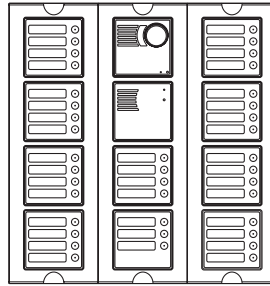

39

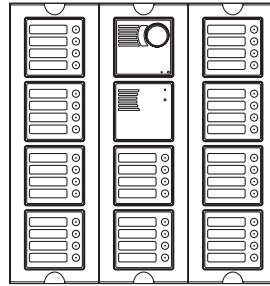

40

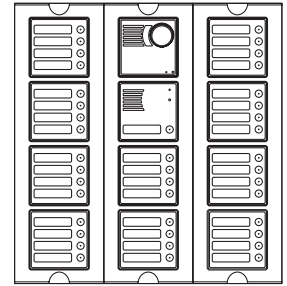

41

	Button modules	Repertory module	9 x 1145/14 + 1145/13	-	10 x 1145/14	-	10 x 1145/14	-
	Door unit module		1145/20		1145/20		1145/21	
	Camera unit modules		1745/40		1745/40		1745/40	
	Door unit		1145/500		1145/500		1145/500	
FLUSH MOUNTED (#)	Flush-mounting box		3 x 1145/54		3 x 1145/54		3 x 1145/54	
	Module holders and frames		3 x 1145/64		3 x 1145/64		3 x 1145/64	
FLUSH-MOUNTING ACCESSORIES	Wall cover frame (°)		1145/732		1145/732		1145/732	
	Rain hood with wall cover frame (°)		1145/632		1145/632		1145/632	
WALL MOUNTED(#)	Case with hood, frame and module holders		1145/332		1145/332		1145/332	
GATE PILLAR(#)	Case with hood, frame and module holders		-		-		-	

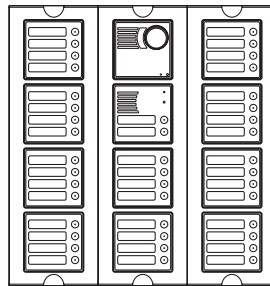

42

	Button modules	Repertory module	10 x 1145/14	-
	Door unit module		1145/22	
	Camera unit modules		1745/40	
	Door unit		1145/500	
FLUSH MOUNTED (#)	Flush-mounting box		3 x 1145/54	
	Module holders and frames		3 x 1145/64	
FLUSH-MOUNTING ACCESSORIES	Wall cover frame (°)		1145/732	
	Rain hood with wall cover frame (°)		1145/632	
WALL MOUNTED(#)	Case with hood, frame and module holders		1145/332	
GATE PILLAR(#)	Case with hood, frame and module holders		-	



SINTHESI PANELS COLOUR COAX VIDEO DOOR PHONE SYSTEMS



EXAMPLES OF MODULAR CONSTRUCTIONS WITH VARIOUS CAPACITIES

(°) alternatives
(#) alternatives

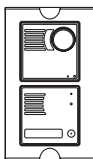

1

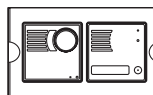

1



2

	Button modules	Repertory module	-	-	-	-	1145/12	-
	Door unit module		1145/21		1145/21		1145/20	
	Camera unit modules		1745/40		1745/40		1745/40	
	Door unit		1145/67		1145/67		1145/67	
	Conversation privacy device		-		-		1145/74	
	Camera adapter		1742/13A		1742/13A		1742/13A	
FLUSH MOUNTED (#)	Flush-mounting box		1145/52		1145/52		1145/53	
	Module holders and frames		1145/62		1145/62		1145/63	
FLUSH-MOUNTING ACCESSORIES	Wall cover frame (°)		1145/712		1145/712		1145/713	
	Rain hood with wall cover frame (°)		1145/612		-		1145/613	
WALL MOUNTED(#)	Case with hood, frame and module holders		1145/312		-		1145/313	
GATE PILLAR(#)	Case with hood, frame and module holders		1145/342		-		1145/343	

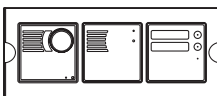

2



3

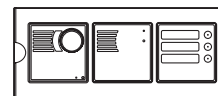

3

	Button modules	Repertory module	1145/12	-	1145/13	-	1145/13	-
	Door unit module		1145/20		1145/20		1145/20	
	Camera unit modules		1745/40		1745/40		1745/40	
	Door unit		1145/67		1145/67		1145/67	
	Conversation privacy device		1145/74		1145/74		1145/74	
	Camera adapter		1742/13A		1742/13A		1742/13A	
FLUSH MOUNTED (#)	Flush-mounting box		1145/53		1145/53		1145/53	
	Module holders and frames		1145/63		1145/63		1145/63	
FLUSH-MOUNTING ACCESSORIES	Wall cover frame (°)		1145/713		1145/713		1145/713	
	Rain hood with wall cover frame (°)		-		1145/613		-	
WALL MOUNTED(#)	Case with hood, frame and module holders		-		1145/313		-	
GATE PILLAR(#)	Case with hood, frame and module holders		-		1145/343		-	

(°) alternatives
(#) alternatives

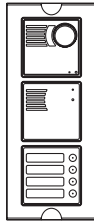

4



4

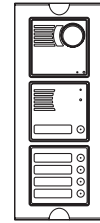

5

	Button modules	Repertory module	1145/14	-	1145/14	-	1145/14	-
	Door unit module		1145/20		1145/20		1145/21	
	Camera unit modules		1745/40		1745/40		1745/40	
	Door unit		1145/67		1145/67		1145/67	
	Conversation privacy device		1145/74		1145/74		1145/74	
	Camera adapter		1742/13A		1742/13A		1742/13A	
FLUSH MOUNTED (#)	Flush-mounting box		1145/53		1145/53		1145/53	
	Module holders and frames		1145/63		1145/63		1145/63	
FLUSH-MOUNTING ACCESSORIES	Wall cover frame (°)		1145/713		1145/713		1145/713	
	Rain hood with wall cover frame (°)		1145/613		-		1145/613	
WALL MOUNTED(#)	Case with hood, frame and module holders		1145/313		-		1145/313	
GATE PILLAR(#)	Case with hood, frame and module holders		1145/343		-		1145/343	

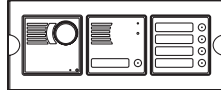

5



6

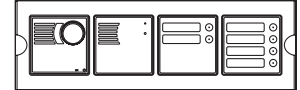

6

	Button modules	Repertory module	1145/14	-	1145/14 + 1145/12	-	1145/14 + 1145/12	-
	Door unit module		1145/21		1145/20		1145/20	
	Camera unit modules		1745/40		1745/40		1745/40	
	Door unit		1145/67		1145/67		1145/67	
	Conversation privacy device		1145/74		2 x 1145/74		2 x 1145/74	
	Camera adapter		1742/13A		1742/13A		1742/13A	
FLUSH MOUNTED (#)	Flush-mounting box		1145/53		1145/54		1145/54	
	Module holders and frames		1145/63		1145/64		1145/64	
FLUSH-MOUNTING ACCESSORIES	Wall cover frame (°)		1145/713		1145/714		1145/714	
	Rain hood with wall cover frame (°)		-		1145/614		-	
WALL MOUNTED(#)	Case with hood, frame and module holders		-		1145/314		-	
GATE PILLAR(#)	Case with hood, frame and module holders		-		-		-	



SINTHESI PANELS COLOUR CAMERA 5-WIRE SYSTEMS



EXAMPLES OF MODULAR CONSTRUCTIONS WITH VARIOUS CAPACITIES

(°) alternatives
(#) alternatives

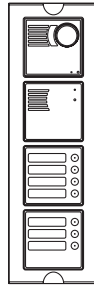

7

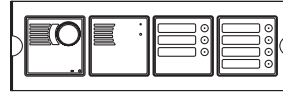

7

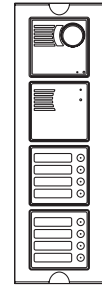

8

	Button modules	Repertory module	1145/14 + 1145/13	-	1145/14 + 1145/13	-	2 x 1145/14	-
	Door unit module		1145/20		1145/20		1145/20	
	Camera unit modules		1745/40		1745/40		1745/40	
	Door unit		1145/67		1145/67		1145/67	
	Conversation privacy device		2 x 1145/74		2 x 1145/74		2 x 1145/74	
	Camera adapter		1742/13A		1742/13A		1742/13A	
FLUSH MOUNTED (#)	Flush-mounting box		1145/54		1145/54		1145/54	
	Module holders and frames		1145/64		1145/64		1145/64	
FLUSH-MOUNTING ACCESSORIES	Wall cover frame (°)		1145/714		1145/714		1145/714	
	Rain hood with wall cover frame (°)		1145/614		-		1145/614	
WALL MOUNTED (#)	Case with hood, frame and module holders		1145/314		-		1145/314	
GATE PILLAR (#)	Case with hood, frame and module holders		-		-		-	

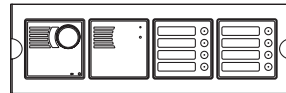

8



9

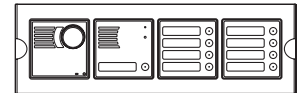

9

	Button modules	Repertory module	2 x 1145/14	-	2 x 1145/14	-	2 x 1145/14	-
	Door unit module		1145/20		1145/21		1145/21	
	Camera unit modules		1745/40		1745/40		1745/40	
	Door unit		1145/67		1145/67		1145/67	
	Conversation privacy device		2 x 1145/74		2 x 1145/74		2 x 1145/74	
	Camera adapter		1742/13A		1742/13A		1742/13A	
FLUSH MOUNTED (#)	Flush-mounting box		1145/54		1145/54		1145/54	
	Module holders and frames		1145/64		1145/64		1145/64	
FLUSH-MOUNTING ACCESSORIES	Wall cover frame (°)		1145/714		1145/714		1145/714	
	Rain hood with wall cover frame (°)		-		1145/614		-	
WALL MOUNTED (#)	Case with hood, frame and module holders		-		1145/314		-	
GATE PILLAR (#)	Case with hood, frame and module holders		-		-		-	

(°) alternatives
(#) alternatives

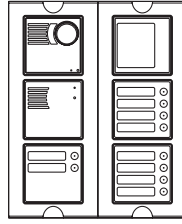

10

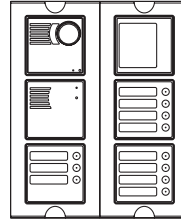

11

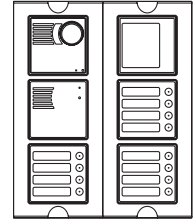

12

	Button modules	Repertory module	2 x 1145/14 + 1145/12	1145/50	2 x 1145/14 + 1145/13	1145/50	3 x 1145/14	1145/50
	Door unit module		1145/20		1145/20		1145/20	
	Camera unit modules		1745/40		1745/40		1745/40	
	Door unit		1145/67		1145/67		1145/67	
	Conversation privacy device		3 x 1145/74		3 x 1145/74		3 x 1145/74	
	Camera adapter		1742/13A		1742/13A		1742/13A	
FLUSH MOUNTED (#)	Flush-mounting box		2 x 1145/53		2 x 1145/53		2 x 1145/53	
	Module holders and frames		2 x 1145/63		2 x 1145/63		2 x 1145/63	
FLUSH-MOUNTING ACCESSORIES	Wall cover frame (°)		1145/726		1145/726		1145/726	
	Rain hood with wall cover frame (°)		1145/626		1145/626		1145/626	
WALL MOUNTED (#)	Case with hood, frame and module holders		1145/326		1145/326		1145/326	
GATE PILLAR (#)	Case with hood, frame and module holders		-		-		-	

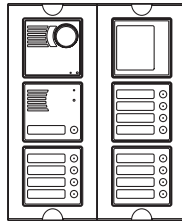

13

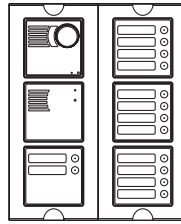

14

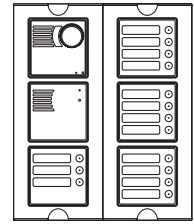

15

	Button modules	Repertory module	3 x 1145/14	1145/50	3 x 1145/14 + 1145/12	-	3 x 1145/14 + 1145/13	-
	Door unit module		1145/21		1145/20		1145/20	
	Camera unit modules		1745/40		1745/40		1745/40	
	Door unit		1145/67		1145/67		1145/67	
	Conversation privacy device		3 x 1145/74		4 x 1145/74		4 x 1145/74	
	Camera adapter		1742/13A		1742/13A		1742/13A	
FLUSH MOUNTED (#)	Flush-mounting box		2 x 1145/53		2 x 1145/53		2 x 1145/53	
	Module holders and frames		2 x 1145/63		2 x 1145/63		2 x 1145/63	
FLUSH-MOUNTING ACCESSORIES	Wall cover frame (°)		1145/726		1145/726		1145/726	
	Rain hood with wall cover frame (°)		1145/626		1145/626		1145/626	
WALL MOUNTED (#)	Case with hood, frame and module holders		1145/326		1145/326		1145/326	
GATE PILLAR (#)	Case with hood, frame and module holders		-		-		-	



SINTHESI PANELS COLOUR CAMERA 5-WIRE SYSTEMS



EXAMPLES OF MODULAR CONSTRUCTIONS WITH VARIOUS CAPACITIES

(°) alternatives
 (#) alternatives

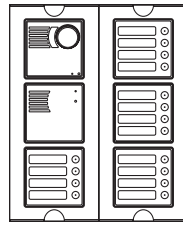

16

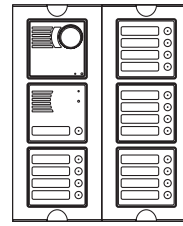

17

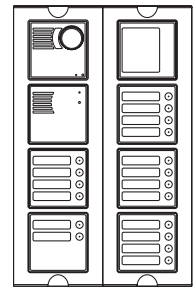

18

	Button modules	Repertory module	4 x 1145/14	-	4 x 1145/14	-	4 x 1145/14 + 1145/12	1145/50
	Door unit module		1145/20		1145/21		1145/20	
	Camera unit modules		1745/40		1745/40		1745/40	
	Door unit		1145/67		1145/67		1145/67	
	Conversation privacy device		4 x 1145/74		4 x 1145/74		5 x 1145/74	
	Camera adapter		1742/13A		1742/13A		1742/13A	
FLUSH MOUNTED (#)	Flush-mounting box		2 x 1145/53		2 x 1145/53		2 x 1145/54	
	Module holders and frames		2 x 1145/63		2 x 1145/63		2 x 1145/64	
FLUSH-MOUNTING ACCESSORIES	Wall cover frame (°)		1145/726		1145/726		1145/728	
	Rain hood with wall cover frame (°)		1145/626		1145/626		1145/628	
WALL MOUNTED (#)	Case with hood, frame and module holders		1145/326		1145/326		1145/328	
GATE PILLAR (#)	Case with hood, frame and module holders		-		-		-	

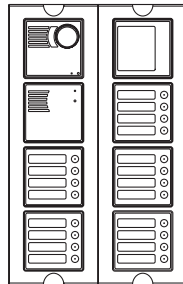

20

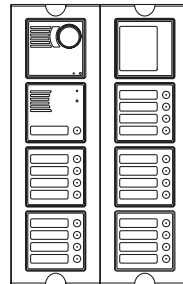

21

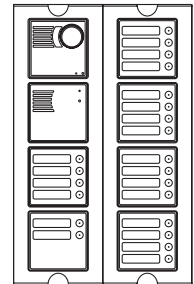

22

	Button modules	Repertory module	5 x 1145/14	1145/50	5 x 1145/14	1145/50	5 x 1145/14 + 1145/12	-
	Door unit module		1145/20		1145/21		1145/20	
	Camera unit modules		1745/40		1745/40		1745/40	
	Door unit		1145/67		1145/67		1145/67	
	Conversation privacy device		5 x 1145/74		5 x 1145/74		6 x 1145/74	
	Camera adapter		1742/13A		1742/13A		1742/13A	
FLUSH MOUNTED (#)	Flush-mounting box		2 x 1145/54		2 x 1145/54		2 x 1145/54	
	Module holders and frames		2 x 1145/64		2 x 1145/64		2 x 1145/64	
FLUSH-MOUNTING ACCESSORIES	Wall cover frame (°)		1145/728		1145/728		1145/728	
	Rain hood with wall cover frame (°)		1145/628		1145/628		1145/628	
WALL MOUNTED (#)	Case with hood, frame and module holders		1145/328		1145/328		1145/328	
GATE PILLAR (#)	Case with hood, frame and module holders		-		-		-	

(°) alternatives
(#) alternatives

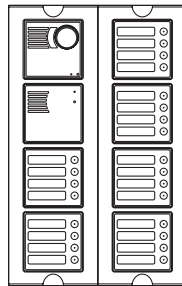

24

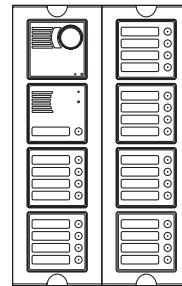

25

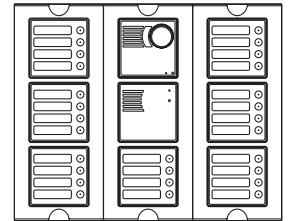

28

	Button modules	Repertory module	6 x 1145/14	-	6 x 1145/14	-	7 x 1145/14	-
	Door unit module		1145/20		1145/21		1145/20	
	Camera unit modules		1745/40		1745/40		1745/40	
	Door unit		1145/67		1145/67		1145/67	
	Conversation privacy device		6 x 1145/74		6 x 1145/74		7 x 1145/74	
	Camera adapter		1742/13A		1742/13A		1742/13A	
FLUSH MOUNTED (#)	Flush-mounting box		2 x 1145/54		2 x 1145/54		3 x 1145/53	
	Module holders and frames		2 x 1145/64		2 x 1145/64		3 x 1145/63	
FLUSH-MOUNTING ACCESSORIES	Wall cover frame (°)		1145/728		1145/728		1145/739	
	Rain hood with wall cover frame (°)		1145/628		1145/628		1145/639	
WALL MOUNTED (#)	Case with hood, frame and module holders		1145/328		1145/326		1145/339	
GATE PILLAR (#)	Case with hood, frame and module holders		-		-		-	

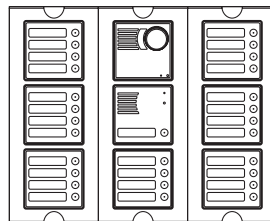

29

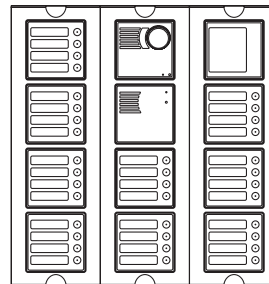

36

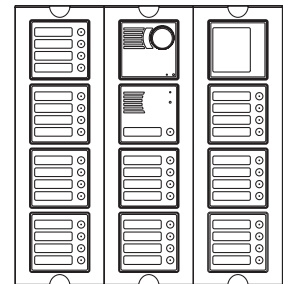

37

	Button modules	Repertory module	7 x 1145/14	-	9 x 1145/14	1145/50	9 x 1145/14	1145/50
	Door unit module		1145/21		1145/20		1145/21	
	Camera unit modules		1745/40		1745/40		1745/40	
	Door unit		1145/67		1145/67		1145/67	
	Conversation privacy device		7 x 1145/74		9 x 1145/74		9 x 1145/74	
	Camera adapter		1742/13A		1742/13A		1742/13A	
FLUSH MOUNTED (#)	Flush-mounting box		3 x 1145/53		3 x 1145/54		3 x 1145/54	
	Module holders and frames		3 x 1145/63		3 x 1145/64		3 x 1145/64	
FLUSH-MOUNTING ACCESSORIES	Wall cover frame (°)		1145/739		1145/732		1145/732	
	Rain hood with wall cover frame (°)		1145/639		1145/632		1145/632	
WALL MOUNTED (#)	Case with hood, frame and module holders		1145/339		1145/332		1145/332	
GATE PILLAR (#)	Case with hood, frame and module holders		-		-		-	



SINTHESI PANELS COLOUR CAMERA 5-WIRE SYSTEMS



EXAMPLES OF MODULAR CONSTRUCTIONS WITH VARIOUS CAPACITIES

(°) alternatives
(#) alternatives

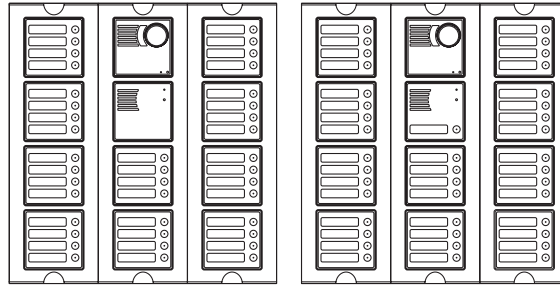

40

41

	Button modules	Repertory module	10 x 1145/14	-	10 x 1145/14	-
	Door unit module		1145/20		1145/21	
	Camera unit modules		1745/40		1745/40	
	Door unit		1145/67		1145/67	
	Conversation privacy device		10 x 1145/74		10 x 1145/74	
	Camera adapter		1742/13A		1742/13A	
FLUSH MOUNTED (#)	Flush-mounting box		3 x 1145/54		3 x 1145/54	
	Module holders and frames		3 x 1145/64		3 x 1145/64	
FLUSH-MOUNTING ACCESSORIES	Wall cover frame (°)		1145/732		1145/732	
	Rain hood with wall cover frame (°)		1145/632		1145/632	
WALL MOUNTED (#)	Case with hood, frame and module holders		1145/332		1145/332	
GATE PILLAR (#)	Case with hood, frame and module holders		-		-	