



General characteristics

Diameter	mm - inch	62 / 2.44 - 70 / 2.75
Colour		Grey

Mechanical features

Weight	g	29
--------	---	----

Dimensions

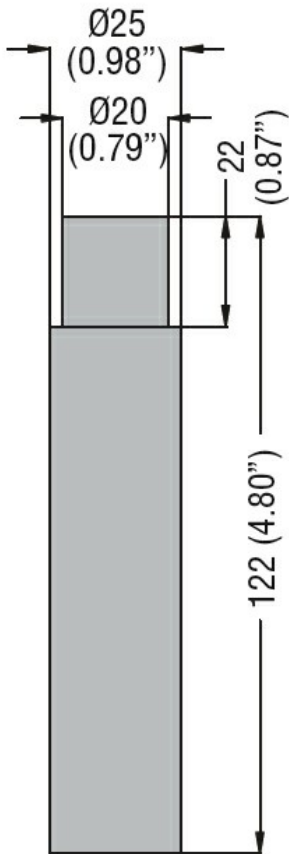

Certifications and compliance

Compliance	/
Certificates	/

ETIM classification

ETIM 8.0	EC001155 - Tube for signal tower
----------	----------------------------------