

General characteristics

Switching diagram	110 - Multi-step 0-1-2-3-4-5 1 pole
N° of elements	3
Mounting form	U - Front mounting with black handle

Contact characteristics

Rated insulation voltage U_i	IEC/EN	V	480
	UL/CSA	V	240
Rated impulse withstand voltage U_{imp}		kV	4
Conventional free air thermal current I_{th}	IEC/EN	A	10
	UL/CSA	A	10
Rated operational voltage		V	480
Rated operational impulse voltage		kV	4
Maximum fuse size for short-circuit protection I_n (gG)	10kA	A	16
Rated short time current I_{cw}	1s	kA	250
Conductivity			10/5 mA/V
Operational current I_e IEC/EN	AC1/AC21A		
		A	10
	AC15		
	110V	A	5
	220/230V	A	3
	380/400V	A	2
Rated operational power in AC	Three-phase AC-3		
	220/230V	kW	1.5
	380/440V	kW	2.2
	Single-phase AC-3		
	110V	kW	0.3
	220/230V	kW	0.55
	380/440V	kW	0.75
	Three-phase AC23A		
	220/230V	kW	1.8
	380/440V	kW	3
	Single-phase AC23A		
	110V	kW	0.7
220/230V	kW	0.75	
380/440V	kW	1.1	
Rated operational current in DC	DC21A		
	48V	A	10
	60V	A	7
	110V	A	2
	220V	A	0.7
	440V	A	0.2
	DC13		

	24V	A	3
	48V	A	3
	60V	A	2
	110V	A	1
	220V	A	0.3
	440V	A	0.1
Power dissipation		W	0.4

Mechanical features

Terminals screw			2.5M
Tightening torque for terminals max		Nm	0.4

Conductor size			
AWG - Rigid cable			
	min	AWG	20
	Max	AWG	14
AWG - Flexible cable			
	min	AWG	20
	Max	AWG	14
Conductor size (IEC) - Flexible cable			
	min	mm ²	0.5
	Max	mm ²	1.5
Conductor size (IEC) - Rigid cable			
	min	mm ²	0.5
	Max	mm ²	1.5

Mechanical life		cycles	1x10 ⁶
-----------------	--	--------	-------------------

UL technical data

Motor power for direct-on-line control			
for three-phase motor			
	240V	HP	2
for single-phase motor			
	240V	HP	0.75

Ambient conditions

Temperature			
Operating temperature			
	min	°C	-25
	max	°C	+55
Storage temperature			
	min	°C	-40
	max	°C	+70

Resistance & Protection

Frontal IP degree		IP40
Terminals IP degree		IP20

Dimensions

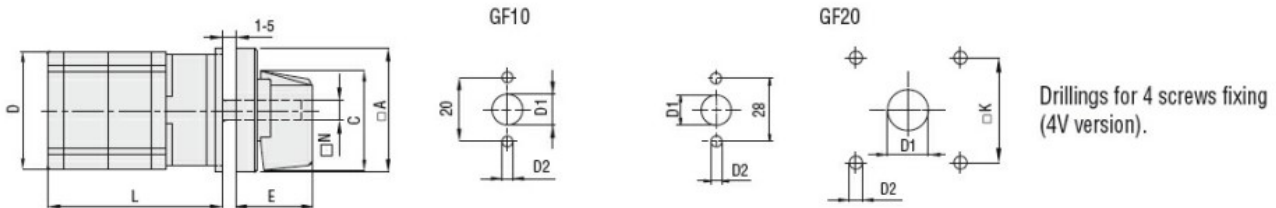

Series	Dimensions								L Number of elements											
	□A	C	D	ØD1	ØD2	E	□K	N	1	2	3	4	5	6	7	8	9	10	11	12
GF10	30	24	29	9	3.2	18.5	-	Ø5	40	52	64	76	88	100	112	124	-	-	-	-
GF20	48	39.5	36	12	5	26.5	36	□6	44	57.5	71	84.5	98	111.5	125	138.5	152	165.5	179	192.5

Wiring diagrams

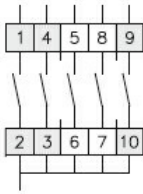

0					
1	X				
2			X		
3					X
4		X			
5				X	

110 —

Certifications and compliance

Compliance

CSA C22.2 n° 14
IEC/EN/BS 60947-1
IEC/EN/BS 60947-3
IEC/EN/BS 60947-5-1
UL60947-4-1

Certificates

cULus
EAC

ETIM classification

ETIM 8.0

EC001029 -
Selector switch,
complete