

**General characteristics**

Switching diagram	26 - 3-phase motor reversing switch with spring return
N° of elements	3
Mounting form	U - Front mounting with black handle

**Contact characteristics**

Rated insulation voltage $U_i$	IEC/EN	V	480
	UL/CSA	V	240
Rated impulse withstand voltage $U_{imp}$		kV	4
Conventional free air thermal current $I_{th}$	IEC/EN	A	10
	UL/CSA	A	10
Rated operational voltage		V	480
Rated operational impulse voltage		kV	4
Maximum fuse size for short-circuit protection $I_n$ (gG)	10kA	A	16
Rated short time current $I_{cw}$	1s	kA	250
Conductivity			10/5 mA/V
Operational current $I_e$ IEC/EN			
AC1/AC21A		A	10
AC15			
	110V	A	5
	220/230V	A	3
	380/400V	A	2
Rated operational power in AC			
Three-phase AC-3			
	220/230V	kW	1.5
	380/440V	kW	2.2
Single-phase AC-3			
	110V	kW	0.3
	220/230V	kW	0.55
	380/440V	kW	0.75
Three-phase AC23A			
	220/230V	kW	1.8
	380/440V	kW	3
Single-phase AC23A			
	110V	kW	0.7
	220/230V	kW	0.75
	380/440V	kW	1.1
Rated operational current in DC			
DC21A			
	48V	A	10
	60V	A	7
	110V	A	2
	220V	A	0.7
	440V	A	0.2

DC13				
	24V	A	3	
	48V	A	3	
	60V	A	2	
	110V	A	1	
	220V	A	0.3	
	440V	A	0.1	
Power dissipation		W	0.4	
<b>Mechanical features</b>				
Terminals screw				2.5M
Tightening torque for terminals max		Nm	0.4	
<b>Conductor size</b>				
AWG - Rigid cable				
	min	AWG	20	
	Max	AWG	14	
AWG - Flexible cable				
	min	AWG	20	
	Max	AWG	14	
Conductor size (IEC) - Flexible cable				
	min	mm <sup>2</sup>	0.5	
	Max	mm <sup>2</sup>	1.5	
Conductor size (IEC) - Rigid cable				
	min	mm <sup>2</sup>	0.5	
	Max	mm <sup>2</sup>	1.5	
Mechanical life		cycles	1x10 <sup>6</sup>	
<b>UL technical data</b>				
Motor power for direct-on-line control				
for three-phase motor				
	240V	HP	2	
for single-phase motor				
	240V	HP	0.75	
<b>Ambient conditions</b>				
Temperature				
Operating temperature				
	min	°C	-25	
	max	°C	+55	
Storage temperature				
	min	°C	-40	
	max	°C	+70	
<b>Resistance &amp; Protection</b>				
Frontal IP degree				IP40
Terminals IP degree				IP20
<b>Dimensions</b>				

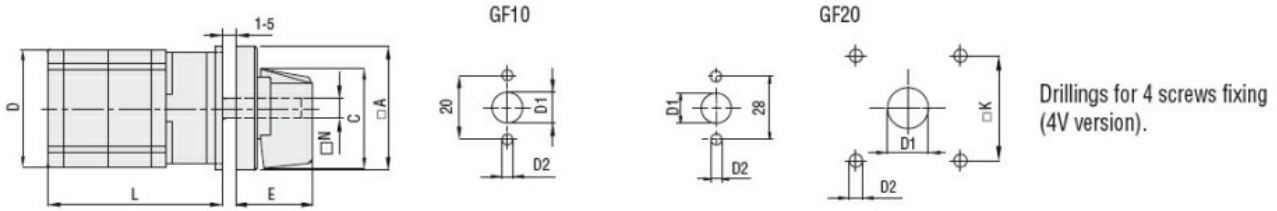

Series	Dimensions								L Number of elements											
	□A	C	D	∅D1	∅D2	E	□K	N	1	2	3	4	5	6	7	8	9	10	11	12
GF10	30	24	29	9	3.2	18.5	-	∅5	40	52	64	76	88	100	112	124	-	-	-	-
GF20	48	39.5	36	12	5	26.5	36	□6	44	57.5	71	84.5	98	111.5	125	138.5	152	165.5	179	192.5

**Wiring diagrams**

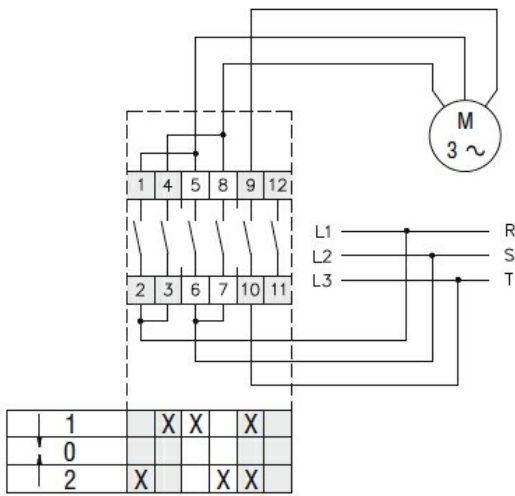

**Certifications and compliance**

**Compliance**

- CSA C22.2 n° 14
- IEC/EN/BS 60947-1
- IEC/EN/BS 60947-3
- IEC/EN/BS 60947-5-1
- UL60947-4-1

**Certificates**

- cULus
- EAC

**ETIM classification**

ETIM 8.0

EC001029 -  
Selector switch,  
complete