

General characteristics

Switching diagram	52 - Changeover switch 2 poles
N° of elements	2
Mounting form	U - Front mounting with black handle

Contact characteristics

Rated insulation voltage U_i	IEC/EN	V	480	
	UL/CSA	V	240	
Rated impulse withstand voltage U_{imp}		kV	4	
Conventional free air thermal current I_{th}	IEC/EN	A	10	
	UL/CSA	A	10	
Rated operational voltage		V	480	
Rated operational impulse voltage		kV	4	
Maximum fuse size for short-circuit protection I_n (gG)	10kA	A	16	
Rated short time current I_{cw}	1s	kA	250	
Conductivity			10/5 mA/V	
Operational current I_e IEC/EN	AC1/AC21A		A	10
	AC15	110V	A	5
		220/230V	A	3
		380/400V	A	2
	Rated operational power in AC	Three-phase AC-3	220/230V	kW
380/440V			kW	2.2
Single-phase AC-3		110V	kW	0.3
		220/230V	kW	0.55
		380/440V	kW	0.75
Three-phase AC23A		220/230V	kW	1.8
		380/440V	kW	3
Single-phase AC23A		110V	kW	0.7
		220/230V	kW	0.75
		380/440V	kW	1.1
Rated operational current in DC		DC21A	48V	A
	60V		A	7
	110V		A	2
	220V		A	0.7
	440V		A	0.2
	DC13	24V	A	3

	48V	A	3
	60V	A	2
	110V	A	1
	220V	A	0.3
	440V	A	0.1
Power dissipation		W	0.4

Mechanical features

Terminals screw			2.5M
Tightening torque for terminals max		Nm	0.4

Conductor size	AWG - Rigid cable		
	min	AWG	20
	Max	AWG	14
	AWG - Flexible cable		
	min	AWG	20
	Max	AWG	14
	Conductor size (IEC) - Flexible cable		
	min	mm ²	0.5
	Max	mm ²	1.5
	Conductor size (IEC) - Rigid cable		
	min	mm ²	0.5
	Max	mm ²	1.5

Mechanical life		cycles	1x10 ⁶
-----------------	--	--------	-------------------

UL technical data

Motor power for direct-on-line control	for three-phase motor		
	240V	HP	2
	for single-phase motor		
	240V	HP	0.75

Ambient conditions

Temperature	Operating temperature		
	min	°C	-25
	max	°C	+55
	Storage temperature		
	min	°C	-40
	max	°C	+70

Resistance & Protection

Frontal IP degree	IP40
Terminals IP degree	IP20

Dimensions

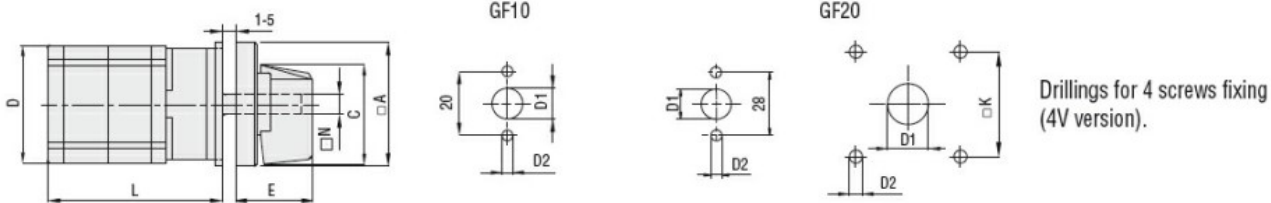

Series	Dimensions								L Number of elements											
	□A	C	D	ØD1	ØD2	E	□K	N	1	2	3	4	5	6	7	8	9	10	11	12
GF10	30	24	29	9	3.2	18.5	-	Ø5	40	52	64	76	88	100	112	124	-	-	-	-
GF20	48	39.5	36	12	5	26.5	36	□6	44	57.5	71	84.5	98	111.5	125	138.5	152	165.5	179	192.5

Wiring diagrams

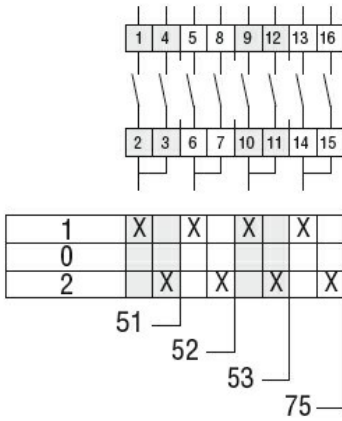

Certifications and compliance

Compliance

- CSA C22.2 n° 14
- IEC/EN/BS 60947-1
- IEC/EN/BS 60947-3
- IEC/EN/BS 60947-5-1
- UL60947-4-1

Certificates

- cULus
- EAC

ETIM classification

ETIM 8.0

EC001029 -
Selector switch,
complete