

### General characteristics

|                   |  |
|-------------------|--|
| Switching diagram | 08 - ON/OFF<br>switch 4 poles              |
| N° of elements    | 2  |
| Mounting form     | U - Front<br>mounting with<br>black handle |

### Contact characteristics

|   |                                 |          |           |      |    |
|---|---------------------------------|----------|-----------|------|----|
| Rated insulation voltage $U_i$                            | IEC/EN                          | V        | 480       |      |    |
|   | UL/CSA                          | V        | 240       |      |    |
| Rated impulse withstand voltage $U_{imp}$                 |                                 | kV       | 4         |      |    |
| Conventional free air thermal current $I_{th}$            | IEC/EN                          | A        | 20        |      |    |
|   | UL/CSA                          | A        | 15        |      |    |
| Rated operational voltage                                 |                                 | V        | 480       |      |    |
| Rated operational impulse voltage                         |                                 | kV       | 4         |      |    |
| Maximum fuse size for short-circuit protection $I_n$ (gG) | 10kA                            | A        | 20        |      |    |
|   | 15kA                            | A        | 20        |      |    |
|   | 25kA                            | A        | 20        |      |    |
| Rated short time current $I_{cw}$                         | 1s                              | kA       | 250       |      |    |
|   |                                 |          | 10/5 mA/V |      |    |
| Conductivity  |                                 |          | 10/5 mA/V |      |    |
| Operational current $I_e$ IEC/EN                          | AC1/AC21A                       | A        | 20        |      |    |
|   | AC15                            |          |           |      |    |
|   | 110V                            | A        | 10        |      |    |
|   | 220/230V                        | A        | 8         |      |    |
|   | 380/400V                        | A        | 6         |      |    |
| Rated operational power in AC                             | Three-phase AC-3                | 220/230V | kW        | 3    |    |
|   |                                 | 380/440V | kW        | 5    |    |
|   | Single-phase AC-3               | 110V     | kW        | 0.5  |    |
|   |                                 | 220/230V | kW        | 1.5  |    |
|   |                                 | 380/440V | kW        | 2    |    |
|   | Three-phase AC23A               | 220/230V | kW        | 4    |    |
|   |                                 | 380/440V | kW        | 7.5  |    |
|   | Single-phase AC23A              | 110V     | kW        | 0.75 |    |
|   |                                 | 220/230V | kW        | 2    |    |
|   |                                 | 380/440V | kW        | 2.5  |    |
|   | Rated operational current in DC | DC21A    | 48V       | A    | 20 |
|   |                                 |          | 60V       | A    | 20 |
| 110V  |                                 |          | A         | 4    |    |
| 220V  |                                 |          | A         | 0.7  |    |
| 440V  |                                 |          | A         | 0.2  |    |
|   |                                 |          |           |      |    |

|  |      |                 |                   |
|--|------|-----------------|-------------------|
| DC13                                   |      |                 |                   |
|  | 24V  | A               | 6                 |
|  | 48V  | A               | 6                 |
|  | 60V  | A               | 3                 |
|  | 110V | A               | 1                 |
|  | 220V | A               | 0.4               |
|  | 440V | A               | 0.15              |
| Power dissipation                      |      | W               | 0.8               |
| <b>Mechanical features</b>             |      |                 |                   |
| Terminals screw                        |      |                 | M3                |
| Tightening torque for terminals max    |      | Nm              | 0.5               |
| Conductor size                         |      |                 |                   |
| AWG - Rigid cable                      |      |                 |                   |
|  | min  | AWG             | 20                |
|  | Max  | AWG             | 12                |
| AWG - Flexible cable                   |      |                 |                   |
|  | min  | AWG             | 20                |
|  | Max  | AWG             | 12                |
| Conductor size (IEC) - Flexible cable  |      |                 |                   |
|  | min  | mm <sup>2</sup> | 0.5               |
|  | Max  | mm <sup>2</sup> | 2.5               |
| Conductor size (IEC) - Rigid cable     |      |                 |                   |
|  | min  | mm <sup>2</sup> | 0.5               |
|  | Max  | mm <sup>2</sup> | 2.5               |
| Mechanical life                        |      | cycles          | 1x10 <sup>6</sup> |
| <b>UL technical data</b>               |      |                 |                   |
| Motor power for direct-on-line control |      |                 |                   |
| for three-phase motor                  |      |                 |                   |
|  | 240V | HP              | 3                 |
| for single-phase motor                 |      |                 |                   |
|  | 240V | HP              | 1                 |
| <b>Ambient conditions</b>              |      |                 |                   |
| Temperature                            |      |                 |                   |
| Operating temperature                  |      |                 |                   |
|  | min  | °C              | -25               |
|  | max  | °C              | +55               |
| Storage temperature                    |      |                 |                   |
|  | min  | °C              | -40               |
|  | max  | °C              | +70               |
| <b>Resistance &amp; Protection</b>     |      |                 |                   |
| Frontal IP degree                      |      |                 | IP40              |
| Terminals IP degree                    |      |                 | IP20              |
| <b>Dimensions</b>                      |      |                 |                   |

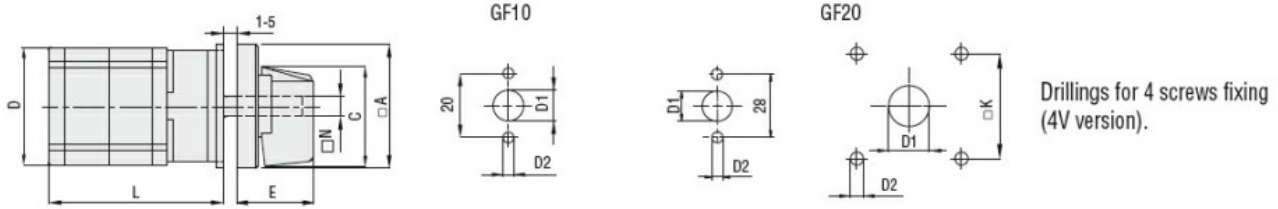

| Series | Dimensions  |      |    |                  |                  |      |             |                 | L Number of elements |      |    |      |    |       |     |       |     |       |     |       |
|--------|-------------|------|----|------------------|------------------|------|-------------|-----------------|----------------------|------|----|------|----|-------|-----|-------|-----|-------|-----|-------|
|        | $\square A$ | C    | D  | $\varnothing D1$ | $\varnothing D2$ | E    | $\square K$ | N               | 1                    | 2    | 3  | 4    | 5  | 6     | 7   | 8     | 9   | 10    | 11  | 12    |
| GF10   | 30          | 24   | 29 | 9                | 3.2              | 18.5 | -           | $\varnothing 5$ | 40                   | 52   | 64 | 76   | 88 | 100   | 112 | 124   | -   | -     | -   | -     |
| GF20   | 48          | 39.5 | 36 | 12               | 5                | 26.5 | 36          | $\square 6$     | 44                   | 57.5 | 71 | 84.5 | 98 | 111.5 | 125 | 138.5 | 152 | 165.5 | 179 | 192.5 |

### Wiring diagrams

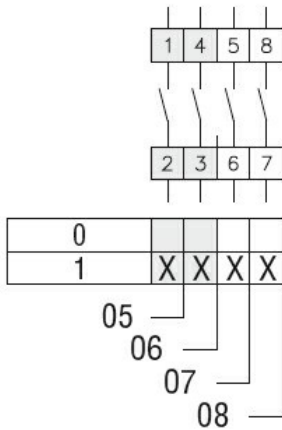

### Certifications and compliance

#### Compliance

CSA C22.2 n° 14  
IEC/EN/BS 60947-1  
IEC/EN/BS 60947-3  
IEC/EN/BS 60947-5-1  
UL60947-4-1

#### Certificates

cULus  
EAC

### ETIM classification

ETIM 8.0

EC001029 -  
Selector switch,  
complete