



### General characteristics

|                   |                                      |
|-------------------|--------------------------------------|
| Switching diagram | 10 - ON/OFF switch 3 poles           |
| N° of elements    | 2                                    |
| Mounting form     | U - Front mounting with black handle |

### Contact characteristics

|                                                           |                   |          |           |     |
|-----------------------------------------------------------|-------------------|----------|-----------|-----|
| Rated insulation voltage $U_i$                            | IEC/EN            | V        | 480       |     |
|                                                           | UL/CSA            | V        | 240       |     |
| Rated impulse withstand voltage $U_{imp}$                 |                   | kV       | 4         |     |
| Conventional free air thermal current $I_{th}$            | IEC/EN            | A        | 20        |     |
|                                                           | UL/CSA            | A        | 15        |     |
| Rated operational voltage                                 |                   | V        | 480       |     |
| Rated operational impulse voltage                         |                   | kV       | 4         |     |
| Maximum fuse size for short-circuit protection $I_n$ (gG) | 10kA              | A        | 20        |     |
|                                                           | 15kA              | A        | 20        |     |
|                                                           | 25kA              | A        | 20        |     |
| Rated short time current $I_{cw}$                         | 1s                | kA       | 250       |     |
|                                                           |                   |          | 10/5 mA/V |     |
| Conductivity                                              |                   |          | 10/5 mA/V |     |
| Operational current $I_e$ IEC/EN                          | AC1/AC21A         |          | A         | 20  |
|                                                           |                   | AC15     | 110V      | A   |
| 220/230V                                                  | A                 |          | 8         |     |
| 380/400V                                                  | A                 |          | 6         |     |
| Rated operational power in AC                             | Three-phase AC-3  |          | 220/230V  | kW  |
|                                                           |                   | 380/440V | kW        | 5   |
|                                                           | Single-phase AC-3 | 110V     | kW        | 0.5 |
|                                                           |                   | 220/230V | kW        | 1.5 |
|                                                           |                   | 380/440V | kW        | 2   |
|                                                           | Three-phase AC23A | 220/230V | kW        | 4   |
| 380/440V                                                  |                   | kW       | 7.5       |     |
| Single-phase AC23A                                        | 110V              | kW       | 0.75      |     |
|                                                           | 220/230V          | kW       | 2         |     |
|                                                           | 380/440V          | kW       | 2.5       |     |

|                                        |      |                 |                   |
|----------------------------------------|------|-----------------|-------------------|
| Rated operational current in DC        |      |                 |                   |
| DC21A                                  |      |                 |                   |
|                                        | 48V  | A               | 20                |
|                                        | 60V  | A               | 20                |
|                                        | 110V | A               | 4                 |
|                                        | 220V | A               | 0.7               |
|                                        | 440V | A               | 0.2               |
| DC13                                   |      |                 |                   |
|                                        | 24V  | A               | 6                 |
|                                        | 48V  | A               | 6                 |
|                                        | 60V  | A               | 3                 |
|                                        | 110V | A               | 1                 |
|                                        | 220V | A               | 0.4               |
|                                        | 440V | A               | 0.15              |
| Power dissipation                      |      | W               | 0.8               |
| <b>Mechanical features</b>             |      |                 |                   |
| Terminals screw                        |      |                 | M3                |
| Tightening torque for terminals max    |      | Nm              | 0.5               |
| Conductor size                         |      |                 |                   |
| AWG - Rigid cable                      |      |                 |                   |
|                                        | min  | AWG             | 20                |
|                                        | Max  | AWG             | 12                |
| AWG - Flexible cable                   |      |                 |                   |
|                                        | min  | AWG             | 20                |
|                                        | Max  | AWG             | 12                |
| Conductor size (IEC) - Flexible cable  |      |                 |                   |
|                                        | min  | mm <sup>2</sup> | 0.5               |
|                                        | Max  | mm <sup>2</sup> | 2.5               |
| Conductor size (IEC) - Rigid cable     |      |                 |                   |
|                                        | min  | mm <sup>2</sup> | 0.5               |
|                                        | Max  | mm <sup>2</sup> | 2.5               |
| Mechanical life                        |      | cycles          | 1x10 <sup>6</sup> |
| <b>UL technical data</b>               |      |                 |                   |
| Motor power for direct-on-line control |      |                 |                   |
| for three-phase motor                  |      |                 |                   |
|                                        | 240V | HP              | 3                 |
| for single-phase motor                 |      |                 |                   |
|                                        | 240V | HP              | 1                 |
| <b>Ambient conditions</b>              |      |                 |                   |
| Temperature                            |      |                 |                   |
| Operating temperature                  |      |                 |                   |
|                                        | min  | °C              | -25               |
|                                        | max  | °C              | +55               |
| Storage temperature                    |      |                 |                   |
|                                        | min  | °C              | -40               |
|                                        | max  | °C              | +70               |
| <b>Resistance &amp; Protection</b>     |      |                 |                   |
| Frontal IP degree                      |      |                 | IP40              |
| Terminals IP degree                    |      |                 | IP20              |
| <b>Dimensions</b>                      |      |                 |                   |

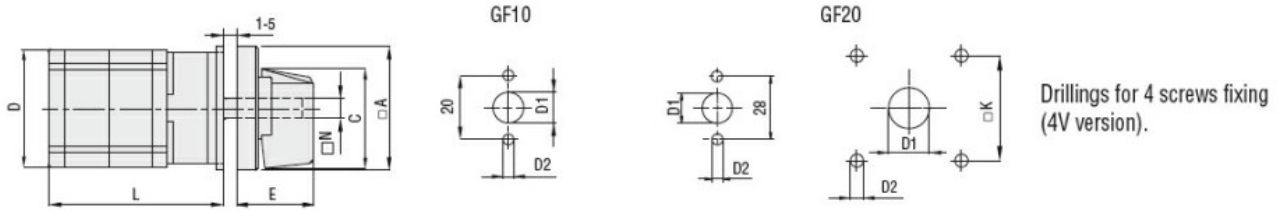

| Series | Dimensions |      |    |     |     |      |    |    | L Number of elements |      |    |      |    |       |     |       |     |       |     |       |
|--------|------------|------|----|-----|-----|------|----|----|----------------------|------|----|------|----|-------|-----|-------|-----|-------|-----|-------|
|        | □A         | C    | D  | ∅D1 | ∅D2 | E    | □K | N  | 1                    | 2    | 3  | 4    | 5  | 6     | 7   | 8     | 9   | 10    | 11  | 12    |
| GF10   | 30         | 24   | 29 | 9   | 3.2 | 18.5 | -  | ∅5 | 40                   | 52   | 64 | 76   | 88 | 100   | 112 | 124   | -   | -     | -   | -     |
| GF20   | 48         | 39.5 | 36 | 12  | 5   | 26.5 | 36 | □6 | 44                   | 57.5 | 71 | 84.5 | 98 | 111.5 | 125 | 138.5 | 152 | 165.5 | 179 | 192.5 |

### Wiring diagrams

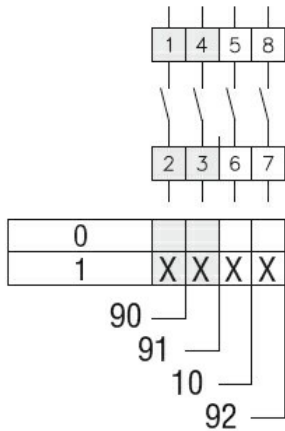

### Certifications and compliance

#### Compliance

CSA C22.2 n° 14  
IEC/EN/BS 60947-1  
IEC/EN/BS 60947-3  
IEC/EN/BS 60947-5-1  
UL60947-4-1

#### Certificates

cULus  
EAC

### ETIM classification

ETIM 8.0

EC001029 -  
Selector switch,  
complete