



### General characteristics

|                   |  |
|-------------------|--|
| Switching diagram | 123 - Multi-step<br>0-1-2 2 poles          |
| N° of elements    | 2  |
| Mounting form     | U - Front<br>mounting with<br>black handle |

### Contact characteristics

|   |                    |    |           |
|---|--------------------|----|-----------|
| Rated insulation voltage $U_i$                            | IEC/EN             | V  | 690       |
|   | UL/CSA             | V  | 600       |
| Rated impulse withstand voltage $U_{imp}$                 |                    | kV | 6         |
| Conventional free air thermal current $I_{th}$            | IEC/EN             | A  | 20        |
|   | UL/CSA             | A  | 15        |
| Rated operational voltage                                 |                    | V  | 440       |
| Rated operational impulse voltage                         |                    | kV | 4         |
| Maximum fuse size for short-circuit protection $I_n$ (gG) | 10kA               | A  | 20        |
|   | 15kA               | A  | 20        |
|   | 25kA               | A  | 20        |
| Rated short time current $I_{cw}$                         | 1s                 | kA | 250       |
|   |                    |    | 10/5 mA/V |
| Conductivity  |                    |    | 10/5 mA/V |
| Operational current $I_e$ IEC/EN                          | AC1/AC21A          | A  | 20        |
|   | AC15               |    |           |
|   | 110V               | A  | 10        |
|   | 220/230V           | A  | 8         |
|   | 380/400V           | A  | 6         |
|   | 660/690V           | A  | 1.5       |
| Rated operational power in AC                             | Three-phase AC-3   |    |           |
|   |                    |    |           |
|   | 220/230V           | kW | 3.7       |
|   | 380/440V           | kW | 5.5       |
|   | 500/690V           | kW | 5.5       |
|   | Single-phase AC-3  |    |           |
|   | 110V               | kW | 0.75      |
|   | 220/230V           | kW | 1.8       |
|   | 380/440V           | kW | 3         |
|   | Three-phase AC23A  |    |           |
|   | 220/230V           | kW | 4         |
|   | 380/440V           | kW | 7.5       |
|   | 500/690V           | kW | 7.5       |
|   | Single-phase AC23A |    |           |

|  |          |                 |                          |
|--|----------|-----------------|--------------------------|
|  | 110V     | kW              | 0.75                     |
|  | 220/230V | kW              | 2.2                      |
|  | 380/440V | kW              | 3.5                      |
| <hr/>                                  |          |                 |                          |
| Rated operational current in DC        |          |                 |                          |
| DC21A                                  |          |                 |                          |
|  | 48V      | A               | 20                       |
|  | 60V      | A               | 20                       |
|  | 110V     | A               | 4                        |
|  | 220V     | A               | 0.6                      |
|  | 440V     | A               | 0.25                     |
| <hr/>                                  |          |                 |                          |
| DC23A (poles in series)                |          |                 |                          |
|  | 24V      | A               | 20 (1)                   |
|  | 48V      | A               | 20 (2)                   |
|  | 60V      | A               | 20 (3)                   |
|  | 110V     | A               | 10 (3)                   |
|  | 220V     | A               | 8 (4)                    |
| <hr/>                                  |          |                 |                          |
| DC13                                   |          |                 |                          |
|  | 24V      | A               | 20                       |
|  | 48V      | A               | 16                       |
|  | 60V      | A               | 12                       |
|  | 110V     | A               | 1                        |
|  | 220V     | A               | 0.4                      |
|  | 440V     | A               | 0.15                     |
| <hr/>                                  |          |                 |                          |
| Power dissipation                      |          | W               | 0.6                      |
| <hr/>                                  |          |                 |                          |
| <b>Mechanical features</b>             |          |                 |                          |
| Terminals screw                        |          |                 | M3                       |
| Tightening torque for terminals max    |          |                 | Nm 0.8                   |
| <hr/>                                  |          |                 |                          |
| Conductor size                         |          |                 |                          |
| AWG - Rigid cable                      |          |                 |                          |
|  | min      | AWG             | 20                       |
|  | Max      | AWG             | 12                       |
| <hr/>                                  |          |                 |                          |
| AWG - Flexible cable                   |          |                 |                          |
|  | min      | AWG             | 20                       |
|  | Max      | AWG             | 12                       |
| <hr/>                                  |          |                 |                          |
| Conductor size (IEC) - Flexible cable  |          |                 |                          |
|  | min      | mm <sup>2</sup> | 0.5                      |
|  | Max      | mm <sup>2</sup> | 2.5                      |
| <hr/>                                  |          |                 |                          |
| Conductor size (IEC) - Rigid cable     |          |                 |                          |
|  | min      | mm <sup>2</sup> | 0.5                      |
|  | Max      | mm <sup>2</sup> | 2.5                      |
| <hr/>                                  |          |                 |                          |
| Mechanical life                        |          |                 | cycles 1X10 <sup>6</sup> |
| <hr/>                                  |          |                 |                          |
| <b>UL technical data</b>               |          |                 |                          |
| Motor power for direct-on-line control |          |                 |                          |
| for three-phase motor                  |          |                 |                          |
|  | 120V     | HP              | 1.5                      |
|  | 240V     | HP              | 3                        |
|  | 480V     | HP              | 5                        |
|  | 600V     | HP              | 5                        |
| <hr/>                                  |          |                 |                          |
| for single-phase motor                 |          |                 |                          |
|  | 120V     | HP              | 0.75                     |
|  | 240V     | HP              | 1.5                      |

**Ambient conditions**

Temperature

Operating temperature

|     |    |     |
|-----|----|-----|
| min | °C | -25 |
| max | °C | +55 |

Storage temperature

|     |    |     |
|-----|----|-----|
| min | °C | -40 |
| max | °C | +70 |

**Resistance & Protection**

|                     |      |
|---------------------|------|
| Frontal IP degree   | IP65 |
| Terminals IP degree | IP20 |

**Dimensions**

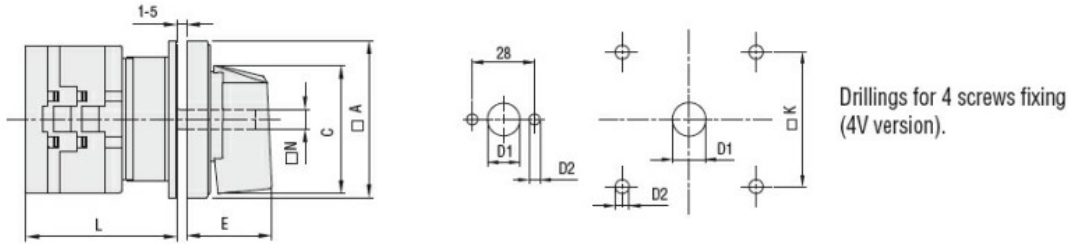

| Series | Dimensions |      |     |     |      |    |    | L Number of elements |      |    |      |    |      |     |       |     |       |     |       |
|--------|------------|------|-----|-----|------|----|----|----------------------|------|----|------|----|------|-----|-------|-----|-------|-----|-------|
|        | □A         | C    | ØD1 | ØD2 | E    | □K | □N | 1                    | 2    | 3  | 4    | 5  | 6    | 7   | 8     | 9   | 10    | 11  | 12    |
| GX16   | 48         | 39.5 | 12  | 5   | 26.5 | 36 | 6  | 43                   | 51.5 | 60 | 68.5 | 77 | 85.5 | 94  | 102.5 | 111 | 119.5 | 128 | 136.5 |
| GX20   | 48         | 39.5 | 12  | 5   | 26.5 | 36 | 6  | 43                   | 51.5 | 60 | 68.5 | 77 | 85.5 | 94  | 102.5 | 111 | 119.5 | 128 | 136.5 |
| GX32   | 65         | 53   | 14  | 5   | 34.5 | 48 | 7  | 51                   | 63   | 75 | 85   | 99 | 111  | 123 | 135   | 147 | 159   | 171 | 183   |
| GX40   | 65         | 53   | 14  | 5   | 34.5 | 48 | 7  | 51                   | 63   | 75 | 85   | 99 | 111  | 123 | 135   | 147 | 159   | 171 | 183   |

**Wiring diagrams**

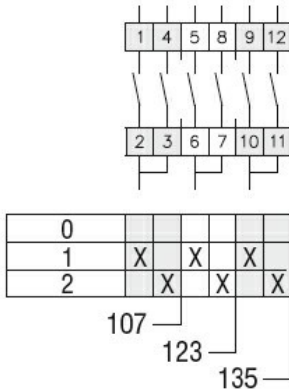

**Certifications and compliance**

Compliance

- CSA C22.2 n° 14
- IEC/EN/BS 60947-1
- IEC/EN/BS 60947-3
- IEC/EN/BS 60947-5-1
- IEC/EN/BS 61058-1
- UL60947-4-1

Certificates

- cULus
- EAC

**ETIM classification**

ETIM 8.0

EC001029 - Selector switch, complete