



**General characteristics**

Diameter	mm - inch	50 / 1.97
Material		Metal

**Mechanical features**

Weight	g	66
--------	---	----

**Ambient conditions**

Temperature	Operating temperature			
		min	°C	-30
		max	°C	+50

**Dimensions**

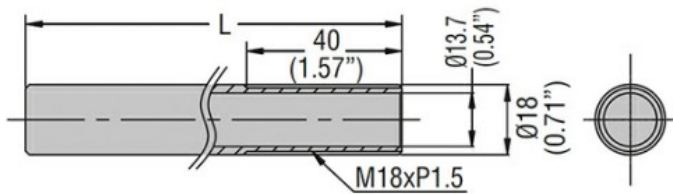

Type	L (mm/in)
LTP50P050T	50 (1.97")
LTP50P100T	100 (3.94")
LTP50P250T	250 (9.84")
LTP50P400T	400 (15.75")

**Certifications and compliance**

Compliance	CSA C22.2 n° 14
	IEC/EN/BS 60947-1
	IEC/EN/BS 60947-5-1
	UL508

Certificates	cULus
--------------	-------

**ETIM classification**

ETIM 8.0	EC001155 - Tube for signal tower
----------	--