



General characteristics

Diameter	mm - inch	70 / 2.75
Colour		White
IEC degree of protection		IP65
Power consumption	VA	1.2

Mechanical features

Weight	g	66
--------	---	----

Ambient conditions

Temperature	Operating temperature	min	°C	-30
		max	°C	+50

Dimensions

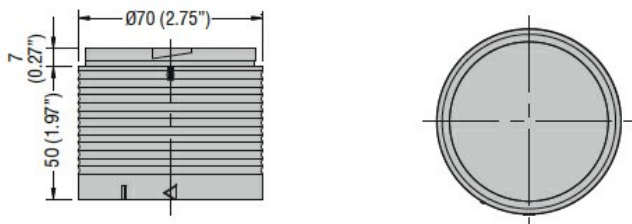

Certifications and compliance

Compliance	CSA C22.2 n° 14
	IEC/EN/BS 60947-1
	IEC/EN/BS 60947-5-1
	UL508

Certificates	cULus
--------------	-------

ETIM classification

ETIM 8.0	EC000232 - Optical module for signal tower
----------	--