



General characteristics

Diameter	mm - inch	70 / 2.75
Supply voltage (AC)	V	110...230
IEC degree of protection		IP65
Power consumption	VA	1

Mechanical features

Terminals screw		Spring terminals
Conductor section		
	AWG/Kcmil	
	min	16
	max	24
	IEC	
	min	mm ² 0.25
	max	mm ² 1.5
Weight	g	277

Ambient conditions

Temperature			
	Operating temperature		
	min	°C	-30
	max	°C	+50

Dimensions

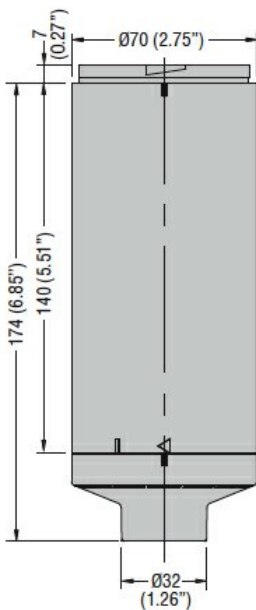

Wiring diagrams

