



General characteristics

Diameter	mm - inch	70 / 2.75
Material		Metal

Mechanical features

Weight	g	39
--------	---	----

Ambient conditions

Temperature	Operating temperature	min	°C	-30
		max	°C	+50

Dimensions

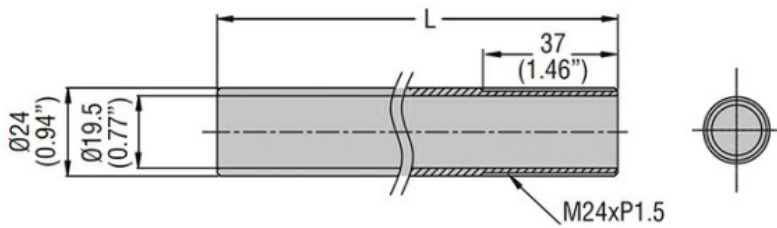

Type	L (mm/in)
LTP70P050T	50 (1.97")
LTP70P100T	100 (3.94")
LTP70P250T	250 (9.84")
LTP70P400T	400 (15.75")

Certifications and compliance

Compliance	CSA C22.2 n° 14
	IEC/EN/BS 60947-1
	IEC/EN/BS 60947-5-1
	UL508

Certificates	cULus
--------------	-------

ETIM classification

ETIM 8.0	EC001155 - Tube for signal tower
----------	-------------------------------------