



Electrical features

Maximum operating current ($\leq 440V$)	A	32
---	---	----

Components

Starter enclosure standard supplied	M2PA
Contactor standard supplied	BF3200A
Thermal relay to purchase separately	RF38...
Auxiliary contact standard supplied	G41810

UL technical data

UL degree of protection	Type 1, 12K, 4, 4X
-------------------------	--------------------

Mechanical features

Weight	g	1162
--------	---	------

Ambient conditions

Operating temperature	min	°C	-25
	max	°C	+60

Storage temperature	min	°C	-40
	max	°C	+70

Resistance & Protection

IEC degree of protection	IP65
--------------------------	------

Dimensions

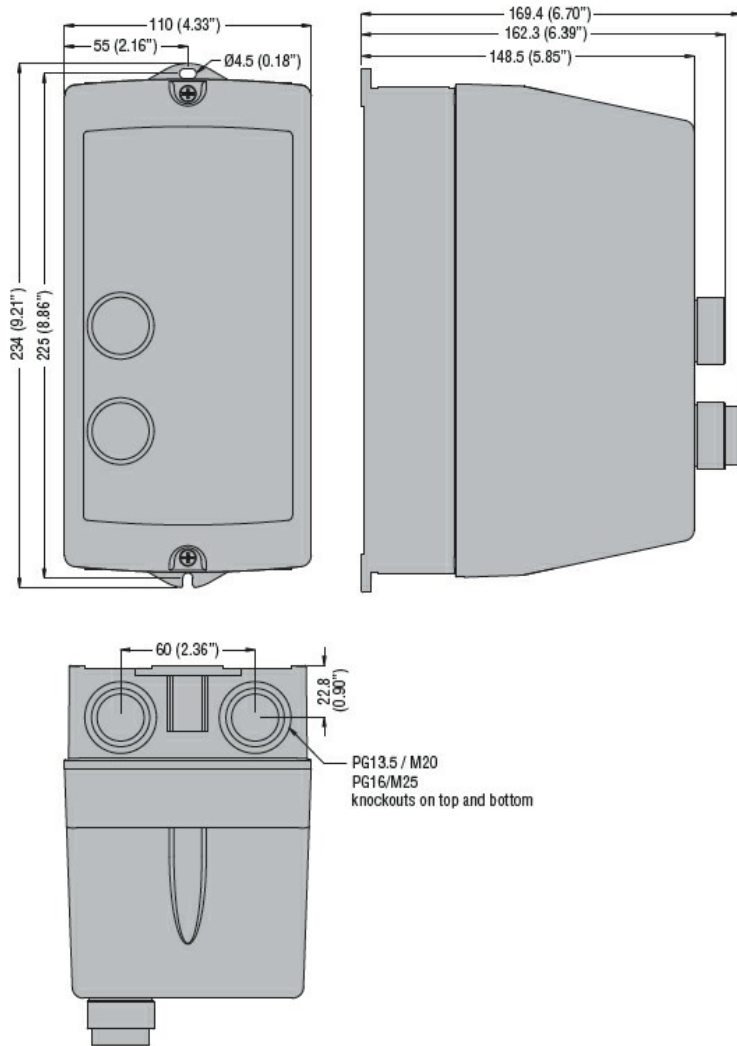

Wiring diagrams



I = Start; O = Stop/Reset

Certifications and compliance

Compliance

IEC/EN 60947-1
IEC/EN 60947-4-1
UL508 CSA C22.2 n° 14

Certificates

CSAus
cULus
EAC

ETIM classification

ETIM 8.0

EC001037 -
Motor
starter/Motor
starter
combination