



Electrical features

| | | |
|---|----|-------|
| Relay adj range | A | 24-32 |
| IEC technical characteristics ($\leq 440V$) | | |
| | le | A |
| | kW | kW |
| | | 32 |
| | | 15 |

Components

| | |
|-------------------------------------|----------|
| Starter enclosure standard supplied | M2PA |
| Contactor standard supplied | BF3200A |
| Thermal relay standard supplied | RF383200 |

UL technical data

| | | | |
|---|-----------|----|--------------------|
| Maximum UL/CSA horsepower ratings single-phase | | | |
| | 110V-120V | HP | 3 |
| | 220V-240V | HP | 7.5 |
| Maximum UL/CSA horsepower ratings three-phase, 3-pole | | | |
| | 200V-208V | HP | 10 |
| | 220V-240V | HP | 10 |
| | 440V-480V | HP | 20 |
| | 550V-600V | HP | 25 |
| UL degree of protection | | | Type 1, 12K, 4, 4X |

Mechanical features

| | | |
|--------|---|------|
| Weight | g | 1300 |
|--------|---|------|

Ambient conditions

| | | | |
|-----------------------|-----|----|-----|
| Operating temperature | | | |
| | min | °C | -25 |
| | max | °C | +60 |
| Storage temperature | | | |
| | min | °C | -40 |
| | max | °C | +70 |

Resistance & Protection

| | |
|--------------------------|------|
| IEC degree of protection | IP65 |
|--------------------------|------|

Dimensions

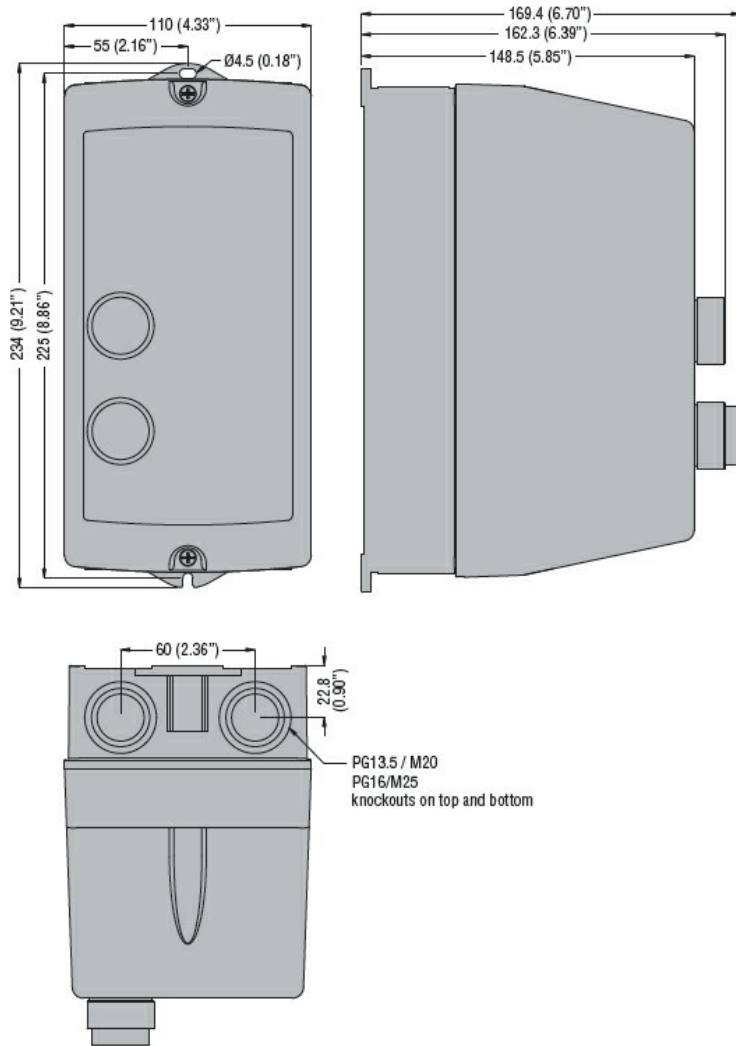

Wiring diagrams

