



Electrical features

Maximum operating current ($\leq 440V$) A 32

Components

Contactor standard supplied BF25A, BF26A, BF32A

Thermal relay to purchase separately RF38

UL technical data

UL degree of protection Type 1, 12K, 4, 4X

Mechanical features

Weight g 715

Ambient conditions

Operating temperature

| | | |
|-----|----|-----|
| min | °C | -25 |
| max | °C | +60 |

Storage temperature

| | | |
|-----|----|-----|
| min | °C | -40 |
| max | °C | +70 |

Resistance & Protection

IEC degree of protection IP65

Dimensions

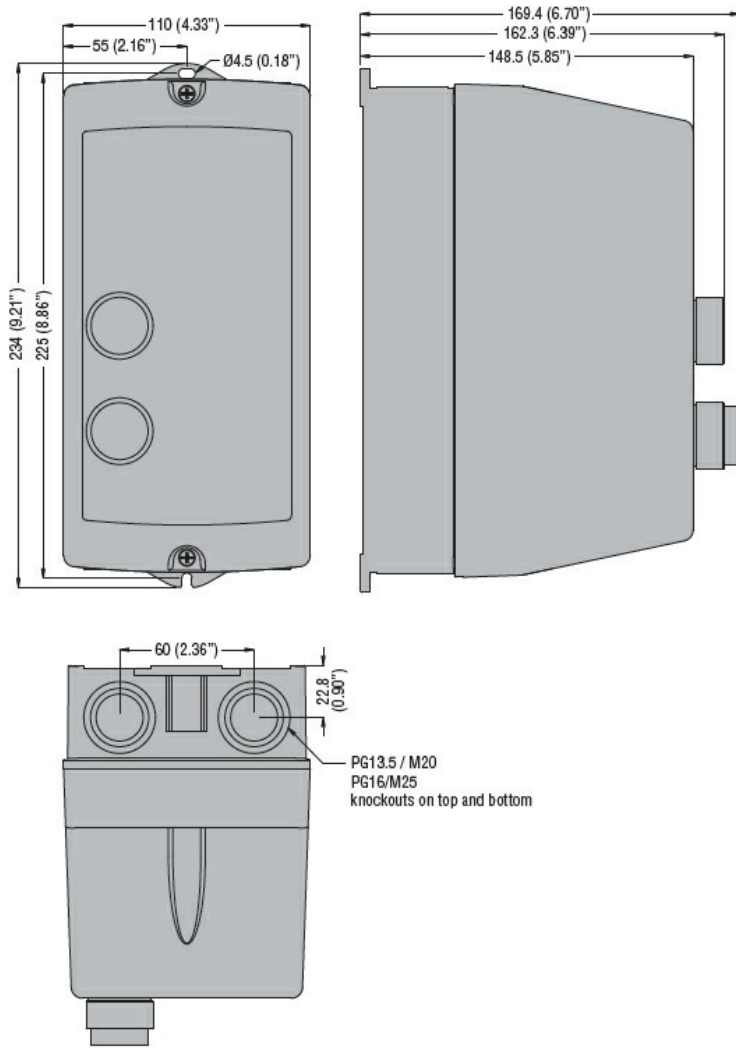

Wiring diagrams



I = Start; O = Stop/Reset

Certifications and compliance

Compliance

CSA C22.2 n° 14
IEC/EN 60947-1
IEC/EN 60947-4-1
UL508

Certificates

cULus

ETIM classification

ETIM 8.0

EC000200 -
Enclosure for
control circuit
devices