



Empty  
enclosures  
M2RA

Product designation

Product type designation

### Electrical features

Maximum operating current ( $\leq 440V$ ) A 32

### Components

Contactor standard supplied BF25A, BF26A, BF32A

Thermal relay to purchase separately RF38

### Mechanical features

Weight g 670

### Ambient conditions

Operating temperature	min	°C	-25
	max	°C	+60

Storage temperature	min	°C	-40
	max	°C	+70

### Resistance & Protection

Frontal IP degree IP65

### Dimensions

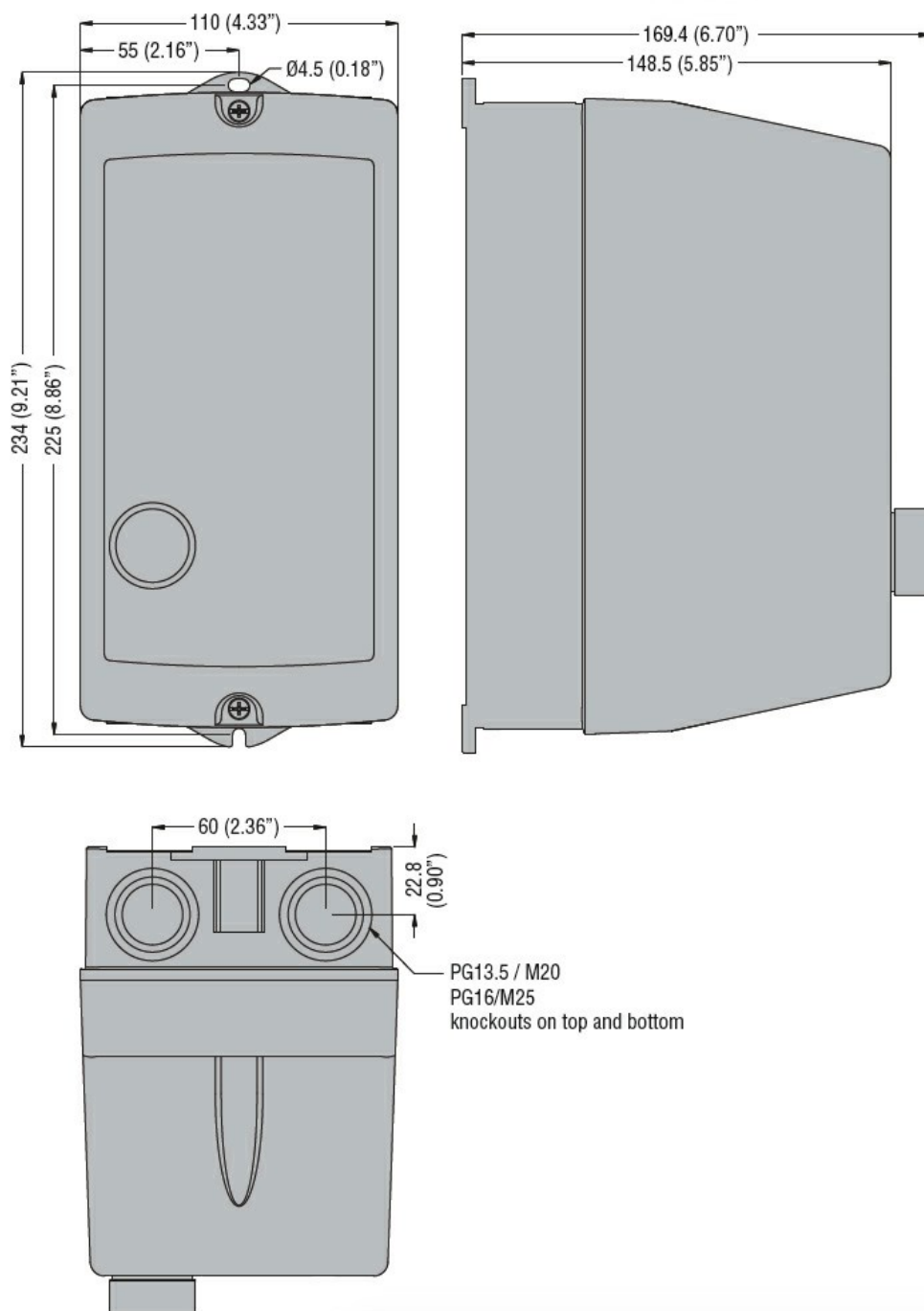

## Wiring diagrams

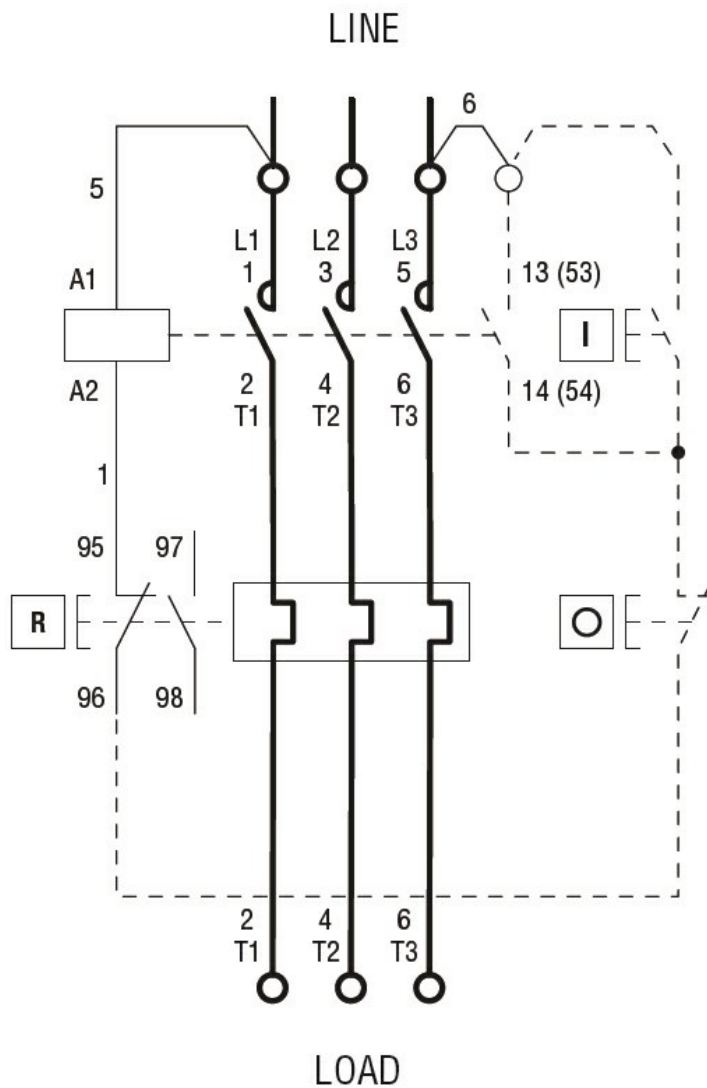

R = Reset; I = Start; O = Stop

#### Certifications and compliance

##### Compliance

CSA C22.2 n° 14  
IEC/EN 60947-1  
IEC/EN 60947-4-1  
UL508

##### Certificates

cULus

#### ETIM classification

ETIM 8.0

EC000200 -  
Enclosure for  
control circuit  
devices